

- (A) DENOTES EASEMENT TO DRAIN WATER, SERVICES & RIGHT OF FOOTWAY 1.5 WIDE
- (B) DENOTES EASEMENT TO DRAIN SEWAGE & RIGHT OF CARRIAGEWAY VAR. WIDTH
- (C) EASEMENT FOR SUPPORT 2 WIDE
- (D) EASEMENT FOR SUPPORT
- (E) RIGHT OF FOOTWAY 1.22 WIDE
- (F) EASEMENT TO DRAIN SEWAGE 1.83 WIDE
- (G) EASEMENT TO DRAIN WATER, RIGHT OF FOOTWAY & EASEMENT FOR SERVICES VARIABLE WIDTH
- (H) EASEMENT TO DRAIN WATER, RIGHT OF FOOTWAY & EASEMENT FOR SERVICES 2.44 WIDE
- (I) RIGHT OF CARRIAGEWAY

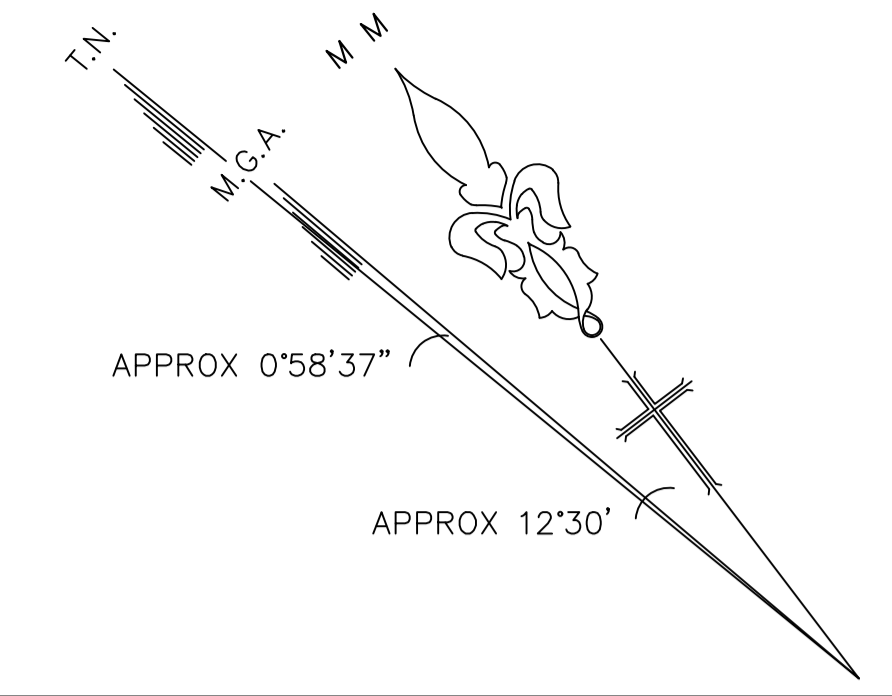

DATE	ISSUE	AMENDMENTS
21/04/17	'A'	FIRST ISSUE
10/08/20	'B'	GENERAL UPDATES
30/11/21	'C'	GENERAL UPDATES

MIDDLE HARBOUR

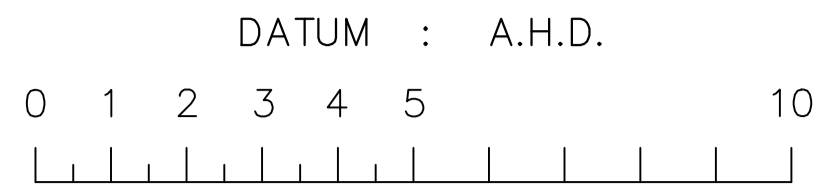
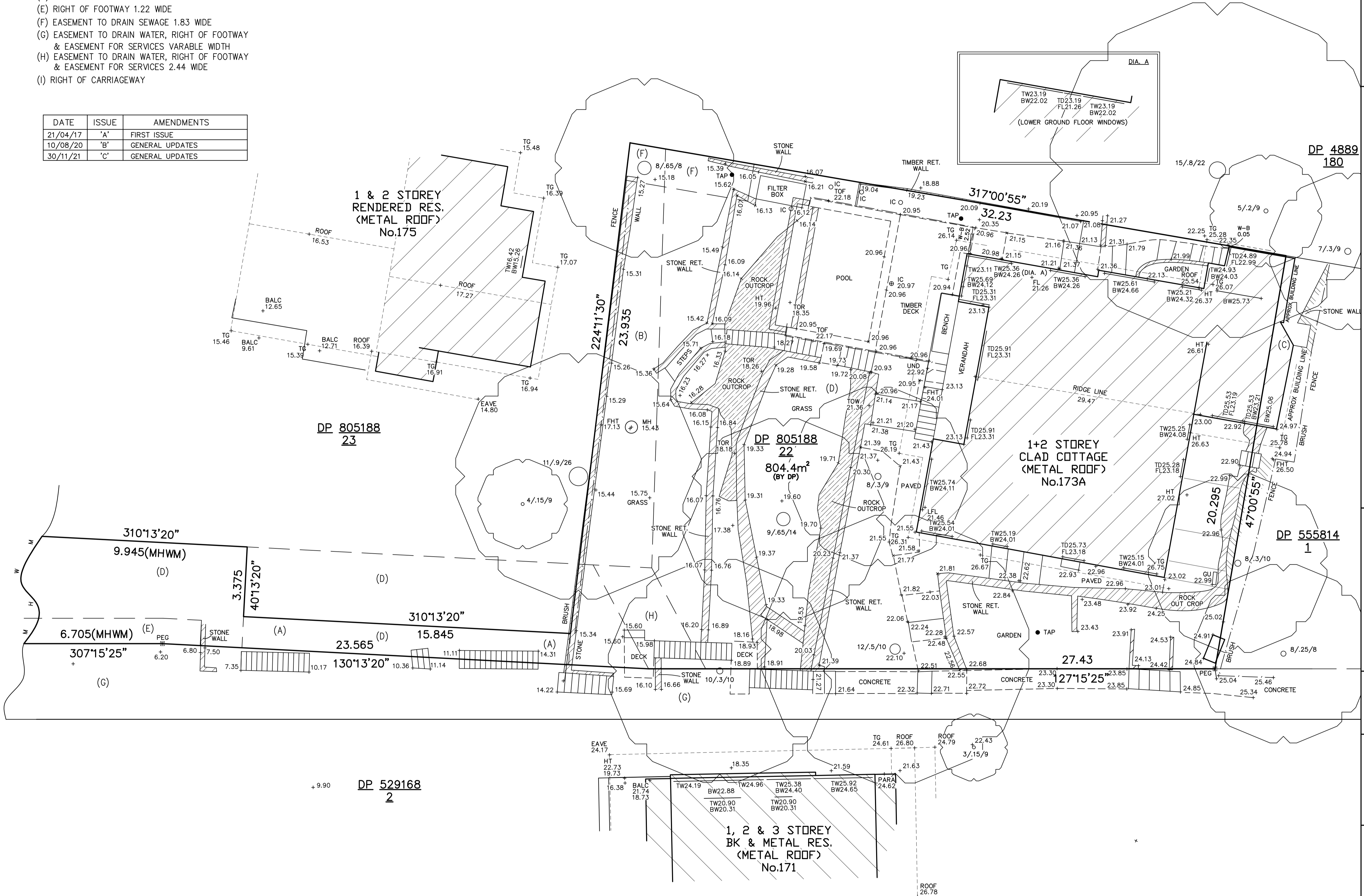

LEGEND

	Building		Balc Height
	Walls		BOLL
	Kerb Bottom		Beam Height
	Concrete edge		Bus Stop
	Barrier		Bottom of Window
	Hedge		Celling Height
	Fence		Window Sill Height
	Overhead Powerline		Chimney Height
	Manholes		Earth Rod
	Survey Station & Name		Fire Hydrant
	Bench Mark		Floor Level
	Sapping		Gully
	Tree, 12/0.5/10		Ground Floor Level
	(Spread/Trunk/Height)		Gas Meter
	Inspection chamber		Gas Valve
	Cover level		Window Head Height
	Invert level		Height
	Pipe invert (diameter)		Inspection Cover
	Back Gully		Lower Floor Level
	Manhole		Manhole
	Beam		Parapet Height
	Walls		Power Pole
	Door		Retaining
	Window		Second Floor Level
			Sill Height
			Stop Top
			Sign Post
			Stop Valve
			Sewer Vent Pipe
			Top of Door
			Top of Door/Window
			Telstra
			Top of Gutter
			Traffic Light
			Top of Window
			Top of Fence
			Top of Wall
			Underside Height
			Water Meter
			Wall to Boundary

NOTES:

- ALL DIMENSIONS AND LEVELS SHOULD BE CHECKED ON SITE PRIOR TO DESIGN AND CONSTRUCTION.
- THE INFORMATION ON THIS SURVEY IS TO BE USED FOR DA PURPOSES ONLY.
- IF THERE IS ANY POINT OR FEATURE (e.g. FLOOR LEVEL, WALL POSITION, ROOF OR RIDGE HEIGHT ETC) CRITICAL TO THE PREPARATION OF DESIGN PLANS OR CONSTRUCTION, THAT POINT OR FEATURE SHOULD BE MADE KNOWN TO US SO ITS ACCURACY CAN BE CONFIRMED PRIOR TO THE COMPLETION OF DESIGN PLANS OR COMMENCEMENT OF CONSTRUCTION.
- SOME STRUCTURES AND FEATURES ARE APPROXIMATE ONLY. IF USED FOR DESIGN CONFIRMATION OF ACCURACY SHOULD BE CONFIRMED.
- FENCES ARE APPROXIMATE ONLY UNLESS SPECIFICALLY DIMENSIONED TO BOUNDARY.
- SURVEY MARKS MUST BE PLACED PRIOR TO CONSTRUCTION OR ERECTION OF FENCES.
- TREE INFORMATION HAS BEEN SURVEYED FROM GROUND LEVEL AND THEREFORE SHOULD BE TREATED AS APPROXIMATE ONLY. THE EXTENT OF THE CANOPY IS APPROXIMATE AND DIAGRAMMATIC ONLY.
- STAR RISERS, STEPS AND LANDINGS HAVE NOT BEEN INDIVIDUALLY LOCATED AND ARE DIAGRAMMATIC ONLY.
- THE RECORDS OF THE SERVICE PROVIDERS HAVE NOT BEEN INVESTIGATED. ONLY THOSE SERVICES THAT ARE VISIBLE AND ACCESSIBLE AT THE DATE OF SURVEY HAVE BEEN SHOWN.
- SERVICES SHOWN ARE INDICATIVE ONLY. OTHER SERVICES MAY EXIST THAT ARE NOT SHOWN. THEREFORE FIELD CONFIRMATION SERVICE LOCATORS SHOULD BE OBTAINED TO CONFIRM EXACT POSITION AND DEPTH.
- THE SITE AREA SHOWN HAS BEEN CALCULATED BY SURVEY.
- A SITE AND BOUNDARY SURVEY HAS BEEN CARRIED OUT.
- ORIGIN OF LEVELS IS F.M. 1193, R.L. 38.636
- BEARINGS ARE ON MAGNETIC MERIDIAN.

COPYRIGHT:

THE INFORMATION SHOWN/CONTAINED IN THIS DRAWING/FILE IS COPYRIGHT. THE INFORMATION MAY ONLY BE USED FOR THE PURPOSE FOR WHICH IT WAS PRODUCED. NO PART OF THIS DRAWING/FILE MAY BE USED OR REPRODUCED IN PART OR WHOLE, FOR ANY OTHER CLIENT, PERSON OR COMPANY WITHOUT THE PRIOR WRITTEN PERMISSION OF HILL & BLUME PTY. LTD.

Hill & Blume
CONSULTING SURVEYORS
ACN 000 721 004
surveys@hillandblume.com.au

Hill & Blume Pty Ltd
102 Crown Street
Woolloomooloo
NSW 2011
Tel (02) 9332 4888
Fax (02) 9331 6422

PROJECT

D SHOWING SELECTED LEVELS & DETAIL & BOUNDARY IDENTIFICATION SURVEY OVER LOT 22 IN DP 805188 BEING 173A SEAFORTH CRESCENT, SEAFORTH

NORTHERN BEACHES	REGISTERED SURVEYOR
757	PAUL CECHELLERO
CLIENT NAME	SIGNATURE
ANDREW CHARLTON HILL	<i>Paul Cechellero</i>
SCALE	DRAWN/PAPER SIZE
1:100	CH/A1
SURVEY DATE	DRAWING No.
21/04/17	59381001C