

PROPOSED DEVELOPMENT

No.27 -29 NORTH AVALON ROAD, AVALON BEACH

EROSION & SEDIMENT CONTROL PLANS

GENERAL INSTRUCTIONS

- THIS SOIL AND WATER MANAGEMENT PLAN IS TO BE READ IN CONJUNCTION WITH OTHER ENGINEERING PLANS RELATING TO THIS DEVELOPMENT.
- CONTRACTORS WILL ENSURE THAT ALL SOIL AND WATER MANAGEMENT WORKS ARE UNDERTAKEN AS INSTRUCTED IN THIS SPECIFICATION AND CONSTRUCTED FOLLOWING THE GUIDELINES OF "MANAGING URBAN STORMWATER SOILS AND CONSTRUCTION", DEPT OF HOUSING, 1998 (BLUE BOOK).
- ALL SUBCONTRACTORS WILL BE INFORMED OF THEIR RESPONSIBILITIES IN REDUCING THE POTENTIAL FOR SOIL EROSION AND POLLUTION TO DOWNSLOPE AREAS.

LAND DISTURBANCE INSTRUCTIONS

- DISTURBANCE TO BE NO FURTHER THAN 5 (PREFERABLY 2) METRES FROM THE EDGE OF ANY ESSENTIAL ENGINEERING ACTIVITY AS SHOWN ON APPROVED PLANS. ALL SITE WORKERS WILL CLEARLY RECOGNISE THESE ZONES THAT, WHERE APPROPRIATE, ARE IDENTIFIED WITH BARRIER FENCING (UPSLOPE) AND SEDIMENT FENCING (DOWNSLOPE) OR SIMILAR MATERIALS.
- ACCESS AREAS ARE TO BE LIMITED TO A MAXIMUM WIDTH OF 10 METRES THE SITE MANAGER WILL DETERMINE AND MARK THE LOCATION OF THESE ZONES ON-SITE. ALL SITE WORKERS WILL CLEARLY RECOGNISE THESE BOUNDARIES THAT, WHERE APPROPRIATE, ARE IDENTIFIED WITH BARRIER FENCING (UPSLOPE) AND SEDIMENT FENCING (DOWNSLOPE) OR SIMILAR MATERIALS.
- ENTRY TO LANDS NOT REQUIRED FOR CONSTRUCTION OR ACCESS IS PROHIBITED EXCEPT FOR ESSENTIAL THINKING OF PLANT GROWTH.
- WORKS ARE TO PROCEED IN THE FOLLOWING SEQUENCE:
 - INSTALL ALL BARRIER AND SEDIMENT FENCING WHERE SHOWN ON THE PLAN.
 - CONSTRUCT THE STABILISED SITE ACCESS.
 - CONSTRUCT DIVERSION DRAINS AS REQUIRED.
 - INSTALL MESH AND GRAVEL INLETS FOR ANY ADJACENT KERB INLETS.
 - INSTALL GEOTEXTILE INLET FILTERS AROUND ANY ON-SITE DROP INLET PITS.
 - CLEAR SITE AND STRIP AND STOCKPILE TOPSOIL IN LOCATIONS SHOWN ON THE PLAN.
 - UNDERTAKE ALL ESSENTIAL CONSTRUCTION WORKS ENSURING THAT ROOF AND/OR PAVED AREA STORMWATER SYSTEMS ARE CONNECTED TO PERMANENT DRAINAGE AS SOON AS PRACTICABLE.
 - GRADE LOT AREAS TO FINAL GRADES AND APPLY PERMANENT STABILISATION (LANDSCAPING) WITHIN 20 DAYS OF COMPLETION OF CONSTRUCTION WORKS.
 - REMOVE TEMPORARY EROSION CONTROL MEASURES AFTER THE PERMANENT LANDSCAPING HAS BEEN COMPLETED.
- ENSURE THAT SLOPE LENGTHS DO NOT EXCEED 80 METRES WHERE PRACTICABLE. SLOPE LENGTHS ARE DETERMINED BY SILTATION FENCING AND CATCH DRAIN SPACING.
- ON COMPLETION OF MAJOR WORKS LEAVE DISTURBED LANDS WITH A SCARIFIED SURFACE TO ENCOURAGE WATER INFILTRATION AND ASSIST WITH KEYING TOPSOIL LATER.

SITE MAINTENANCE INSTRUCTIONS

- THE SITE SUPERINTENDENT WILL INSPECT THE SITE AT LEAST WEEKLY AND AT THE CONCLUSION OF EVERY STORM EVENT TO:
 - ENSURE THAT DRAINS OPERATE PROPERLY AND TO EFFECT ANY NECESSARY REPAIRS.
 - REMOVE SPILLED SAND OR OTHER MATERIALS FROM HAZARD AREAS, INCLUDING LANDS CLOSER THAN 5 METRES FROM AREAS OF LIKELY CONCENTRATED OR HIGH VELOCITY FLOWS ESPECIALLY WATERWAYS AND PAVED AREAS.
 - REMOVE TRAPPED SEDIMENT WHENEVER THE DESIGN CAPACITY OF THAT STRUCTURE HAS BEEN EXCEEDED.
 - ENSURE REHABILITATED LANDS HAVE EFFECTIVELY REDUCED THE EROSION HAZARD AND TO INITIATE UPGRADING OR REPAIR AS NECESSARY.
 - CONSTRUCT ADDITIONAL EROSION AND/OR SEDIMENT CONTROL WORKS AS MIGHT BECOME NECESSARY TO ENSURE THE DESIRED PROTECTION IS GIVEN TO DOWNSLOPE LANDS AND WATERWAYS. MAKE ONGOING CHANGES TO THE PLAN WHERE IT PROVES INADEQUATE IN PRACTICE OR IS SUBJECTED TO CHANGES IN CONDITIONS ON THE WORK-SITE OR ELSEWHERE IN THE CATCHMENT.
 - MAINTAIN EROSION AND SEDIMENT CONTROL STRUCTURES IN A FULLY FUNCTIONING CONDITION UNTIL ALL EARTHWORK ACTIVITIES ARE COMPLETED AND THE SITE IS REHABILITATED.
- THE SITE SUPERINTENDENT WILL KEEP A LOGBOOK MAKING ENTRIES AT LEAST WEEKLY, IMMEDIATELY BEFORE FORECAST RAIN AND AFTER RAINFALL. ENTRIES WILL INCLUDE:
 - THE VOLUME AND INTENSITY OF ANY RAINFALL EVENTS.
 - THE CONDITION OF ANY SOIL AND WATER MANAGEMENT WORKS.
 - THE CONDITION OF VEGETATION AND ANY NEED TO IRRIGATE.
 - THE NEED FOR DUST PREVENTION STRATEGIES.
 - ANY REMEDIAL WORKS TO BE UNDERTAKEN.
 THE LOGBOOK WILL BE KEPT ON-SITE AND MADE AVAILABLE TO ANY AUTHORISED PERSON UPON REQUEST. IT WILL BE GIVEN TO THE PROJECT MANAGER AT THE CONCLUSION OF THE WORKS.

SEDIMENT CONTROL INSTRUCTIONS

- SEDIMENT FENCES WILL BE INSTALLED AS SHOWN ON THE PLAN AND ELSEWHERE AT THE DISCRETION OF THE SITE SUPERINTENDENT TO CONTAIN SOIL AS NEAR AS POSSIBLE TO THEIR SOURCE.
- SEDIMENT FENCES WILL NOT HAVE CATCHMENT AREAS EXCEEDING 900 SQUARE METRES AND HAVE A STORAGE DEPTH OF AT LEAST 0.6 METRES.
- SEDIMENT REMOVED FROM ANY TRAPPING DEVICES WILL BE RELOCATED WHERE FURTHER POLLUTION TO DOWNSLOPE LANDS AND WATERWAYS CANNOT OCCUR.
- STOCKPILES ARE NOT TO BE LOCATED WITHIN 5 METRES OF HAZARD AREAS INCLUDING AREAS OF HIGH VELOCITY FLOWS SUCH AS WATERWAYS, PAVED AREAS AND DRIVEWAYS.
- WATER WILL BE PREVENTED FROM DIRECTLY ENTERING THE PERMANENT DRAINAGE SYSTEM UNLESS THE CATCHMENT AREA HAS BEEN PERMANENTLY LANDSCAPED AND/OR WATER HAS BEEN TREATED BY AN APPROVED DEVICE.
- TEMPORARY SEDIMENT TRAPS WILL REMAIN IN PLACE UNTIL AFTER THE LANDS THEY ARE PROTECTING ARE COMPLETELY REHABILITATED.
- ACCESS TO SITES SHOULD BE STABILISED TO REDUCE THE LIKELIHOOD OF VEHICLES TRACKING SOIL MATERIALS ONTO PUBLIC ROADS AND ENSURE ALL-WEATHER ENTRY/EXIT.

SOIL EROSION CONTROL INSTRUCTIONS

- EARTH BATTERS WILL BE CONSTRUCTED WITH AS LOW A GRADIENT AS PRACTICABLE BUT NO STEEPER, UNLESS OTHERWISE NOTED, THAN:
 - 2(H):1(V) WHERE SLOPE LENGTH LESS THAN 12 METRES
 - 2.5(H):1(V) WHERE SLOPE LENGTH BETWEEN 12 AND 16 METRES.
 - 3(H):1(V) WHERE SLOPE LENGTH BETWEEN 16 AND 20 METRES.
 - 4(H):1(V) WHERE SLOPE LENGTH GREATER THAN 20 METRES.
- ALL WATERWAYS, DRAINS, SPILLWAYS AND THEIR OUTLETS WILL BE CONSTRUCTED TO BE STABLE IN AT LEAST THE 1:20 YEAR ARI, TIME OF CONCENTRATION STORM EVENT.
- WATERWAYS AND OTHER AREAS SUBJECT TO CONCENTRATED FLOWS AFTER CONSTRUCTION ARE TO HAVE A MAXIMUM GROUND COVER C-FACTOR OF 0.05 (70% GROUND COVER) WITHIN 10 WORKING DAYS FROM COMPLETION OF FORMATION. FLOW VELOCITIES ARE TO BE LIMITED TO THOSE SHOWN IN TABLE 5-1 OF "MANAGING URBAN STORMWATER - SOILS AND CONSTRUCTION", DEPT OF HOUSING 1998 (BLUE BOOK). FOOT AND VEHICULAR TRAFFIC WILL BE PROHIBITED IN THESE AREAS.
- STOCKPILES AFTER CONSTRUCTION ARE TO HAVE A MAXIMUM GROUND-COVER C-FACTOR OF 0.1 (60% GROUND-COVER) WITHIN 10 WORKING DAYS FROM COMPLETION OF FORMATION.
- ALL LANDS, INCLUDING WATERWAYS AND STOCKPILES, DURING CONSTRUCTION ARE TO HAVE A MAXIMUM GROUND-COVER C-FACTOR OF 0.15 (50% GROUND COVER) WITHIN 20 WORKING DAYS FROM INACTIVITY EVEN THOUGH WORKS MAY CONTINUE LATER.

SOIL EROSION CONTROL INSTRUCTIONS cont.

- EARTH BATTERS WILL BE CONSTRUCTED WITH AS LOW A FOR AREAS OF SHEET FLOW USE THE FOLLOWING GROUND COVER PLANT SPECIES FOR TEMPORARY COVER: JAPANESE MILLET 20 KG/HA AND OATS 20 KG/HA.
- PERMANENT REHABILITATION OF LANDS AFTER CONSTRUCTION WILL ACHIEVE A GROUND-COVER C-FACTOR OF LESS THAN 0.1 AND LESS THAN 0.05 WITHIN 60 DAYS. NEWLY PLANTED LANDS WILL BE WATERED REGULARLY UNTIL AN EFFECTIVE COVER IS ESTABLISHED AND PLANTS ARE GROWING VIGOROUSLY. FOLLOW-UP SEED AND FERTILISER WILL BE APPLIED AS NECESSARY.
- REVEGETATION SHOULD BE AIMED AT RE-ESTABLISHING NATURAL SPECIES. NATURAL SURFACE SOILS SHOULD BE REPLACED AND NON-PERSISTANT ANNUAL COVER CROPS SHOULD BE USED.

WASTE CONTROL INSTRUCTIONS

- ACCEPTABLE BINS WILL BE PROVIDED FOR ANY CONCRETE AND MORTAR SLURRIES, PAINTS, ACID WASHING, LIGHTWEIGHT WASTE MATERIALS AND LITTER. CLEARANCE SERVICES WILL BE PROVIDED AT LEAST WEEKLY. DISPOSAL OF WASTE WILL BE IN A MANNER APPROVED BY THE SITE SUPERINTENDENT.
- ALL POSSIBLE POLLUTANT MATERIALS ARE TO BE STORED WELL CLEAR OF ANY POORLY DRAINED AREAS, FLOOD PRONE AREAS, STREAMBANKS, CHANNELS AND STORMWATER DRAINAGE AREAS. STORE SUCH MATERIALS IN A DESIGNATED AREA UNDER COVER WHERE POSSIBLE AND WITHIN CONTAINMENT BUNDS. ALL SITE STAFF AND SUB-CONTACTORS ARE TO BE INFORMED OF THEIR OBLIGATION TO USE WASTE CONTROL FACILITIES PROVIDED.
- ANY DE-WATERING ACTIVITIES ARE TO BE CLOSELY MONITORED TO ENSURE THAT WATER IS NOT POLLUTED BY SEDIMENT, TOXIC MATERIALS OR PETROLEUM PRODUCTS.
- PROVIDE DESIGNATED VEHICULAR WASHDOWN AND MAINTENANCE AREAS WHICH ARE TO HAVE CONTAINMENT BUNDS.

PROCEDURE FOR DE-WATERING

- ENSURE PERMISSION FOR DE-WATERING IS RECEIVED FROM AUTHORITIES BEFORE PUMPING OUT.
- AN ON-SITE TREATMENT PROCESS DISCHARGING TO THE STORMWATER SYSTEM WILL BE IMPLEMENTED. ALL SITE WATERS DURING CONSTRUCTION WILL BE CONTAINED ON SITE AND RELEASED ONLY WHEN pH IS BETWEEN 8.5 & 6.5, SUSPENDED SOLIDS ARE LESS THAN 50mg/L, TURBIDITY LESS THAN 100 NTU'S, OIL AND GREASE LESS THAN 10mg/L AND BIOCHEMICAL OXYGEN DEMAND (BOD5) LESS THAN 30mg/L (FOR STORMS LESS INTENSE THAN 1 IN 5 YEAR EVENTS).
- METHODS OF SAMPLING AND ANALYSIS OF WATER QUALITY WILL BE IN ACCORDANCE WITH THE APPLICABLE METHOD LISTED IN THE EPA PUBLISHED APPROVED METHODS FOR THE SAMPLING ANALYSIS OF WATER POLLUTANTS IN NEW SOUTH WALES.
- WHERE LABORATORY ANALYSIS IS REQUIRED AS INDICATED BY IN-SITU TESTING, APPROPRIATE SAMPLE BOTTLES AND PRESERVATIVES WILL BE USED AND GUIDANCE FOR THE SAMPLING METHOD OBTAINED FROM APPLICABLE PARTS OF ASS667.1 AND ASS667.6. ANALYSIS WILL BE UNDERTAKEN WHERE PRACTICAL BY A NATA REGISTERED LABORATORY CERTIFIED TO PERFORM THE APPLICABLE ANALYSIS.
- A FURTHER INSPECTION WILL BE CARRIED OUT DURING A STORM EVENT (DURING WORK HOURS WHERE POSSIBLE) TO ENSURE CONTROLS ARE COPING WITH THE EVENT. THIS APPLIES TO ANY RAIN EVENT AS WELL.
- AS EXCAVATION TO TOP SOIL PROGRESSES, ANY WATER COLLECTED AT THE BOTTOM OF EXCAVATIONS WILL BE DIVERTED TO A TEMPORARY SEDIMENTATION BASIN OR SETTLEMENT TANK. IF THE WATER CONTAINS ONLY SEDIMENTS, IT WILL BE FILTERED AND PUMPED TO STORMWATER. BEFORE THIS CAN HAPPEN IT MUST CONTAIN LESS THAN 50mg/L TOTAL SUSPENDED SOLIDS.
- POLLUTED WATER MUST NOT ENTER THE STORMWATER SYSTEM. IN SOME CIRCUMSTANCES, A LIQUID WASTE COMPANY MAY BE REQUIRED TO COLLECT CONTAMINATED WATER FOR DISPOSAL AT A LICENSED TREATMENT FACILITY

SHEET INDEX

COVER SHEET & NOTES	SHEET E1
EROSION & SEDIMENT CONTROL PLAN	SHEET E2
EROSION & SEDIMENT CONTROL DETAILS	SHEET E3

© COPYRIGHT of this design and plan is the property of ACOR Consultants (CC) Pty Ltd, ACN 127 012 104 ATF The ACOR (CC) Unit Trust ABN 81 392 991 647, all rights reserved. It must not be used, modified, reproduced or copied wholly or in part without written permission from ACOR Consultants (CC) Pty Ltd. ACOR Consultants is a trademark licensed to ACOR Consultants (CC) Pty Ltd by ACOR Consultants Pty Ltd.

This drawing has been assigned an electronic code that signifies the drawing has been checked and approved by: MR MICHAEL GOODWIN MIEAust CPEng NER		North
A	ISSUED FOR COUNCIL APPROVAL	23.09.20 SJ BK
Issue	Description	Date Drawn Approved

ARMADA AVALON PTY LTD

ENVIRONA STUDIO



ACOR Consultants (CC) Pty Ltd
Platinum Building, Suite 2.01, 4 Ilya Avenue
ERINA NSW 2250, Australia
T +61 2 4324 3499



PROPOSED RESIDENTIAL DEVELOPMENT
No.27 - 29
NORTH AVALON ROAD
AVALON BEACH

COVER SHEET & NOTES

Drawn	Date	Scale	A1	Q.A. Check	Date
SJ	18.09.20	AS NOTED		-	-
Designed	Project No.	Dwg. No.		Issue	
BK	CC200310	E1		A	

EROSION & SEDIMENT LEGEND

- 1 INSTALL SEDIMENT FENCING REFER DETAIL SD 6-8, SHEET E3. WHERE UNDER CANOPY AREAS OF TREES TO BE RETAINED, FENCING NOT TO BE DUG INTO THE GROUND BUT INSTEAD ATTACHED TO GROUND BY TIGHTLY PACKED SANDBAGS.
- 2 NOTE: PROVIDE PROTECTION TO DRAINAGE PITS FOLLOWING PIT INSTALLATION. REFER DETAIL SD6-12 ON SHEET E3
- 3 SITE ACCESS PROVIDE LARGE COARSE DIA AGGREGATE OR RECYCLED CONCRETE. IN ACCORDANCE WITH DETAIL SD 6-14, SHEET E3
- 4 STOCKPILE IN ACCORDANCE WITH DETAIL SD 4-1, REFER TO SHEET E3. LOCATION MAY VARY PENDING CONSTRUCTION STAGING
- 5 WASTE STORAGE AREA PROVIDE SOLID AND LIQUID WASTE RECEPTACLE BINS. LOCATION TO BE ADJUSTED TO SUIT CONSTRUCTION STAGING.
- 6 BARRIER FENCING OR UTILISE EXISTING BOUNDARY FENCE
- 7 PROPOSED DISTURBED AREA
- 8 PROVIDE TYPE 'D' SEDIMENT RETENTION BASIN. NOMINAL SIZE: 4.0m x 4.0m x 0.5m DEEP VOLUME = 8.0m³ TO BE CONFIRMED AT CC STAGE DISCHARGE TO BE CONTROLLED PUMP OUT FOLLOWING FLOCCULATION
- 9 PROVIDE TEMPORARY PUMP OUT AND RISING MAIN TO OUTLET.
- 10 TRUCK WASH DOWN AREA. PROVIDE RAILWAY LINE SHAKER ON LARGE COARSE DIA. AGGREGATE OR RECYCLED CONCRETE IN ACCORDANCE WITH DETAIL SD 10-1 ON SHEET E3
- 11 PROVIDE TREE PROTECTION MEASURES IN ACCORDANCE WITH ARBORIST REPORT OR COUNCIL SPECIFICATIONS.

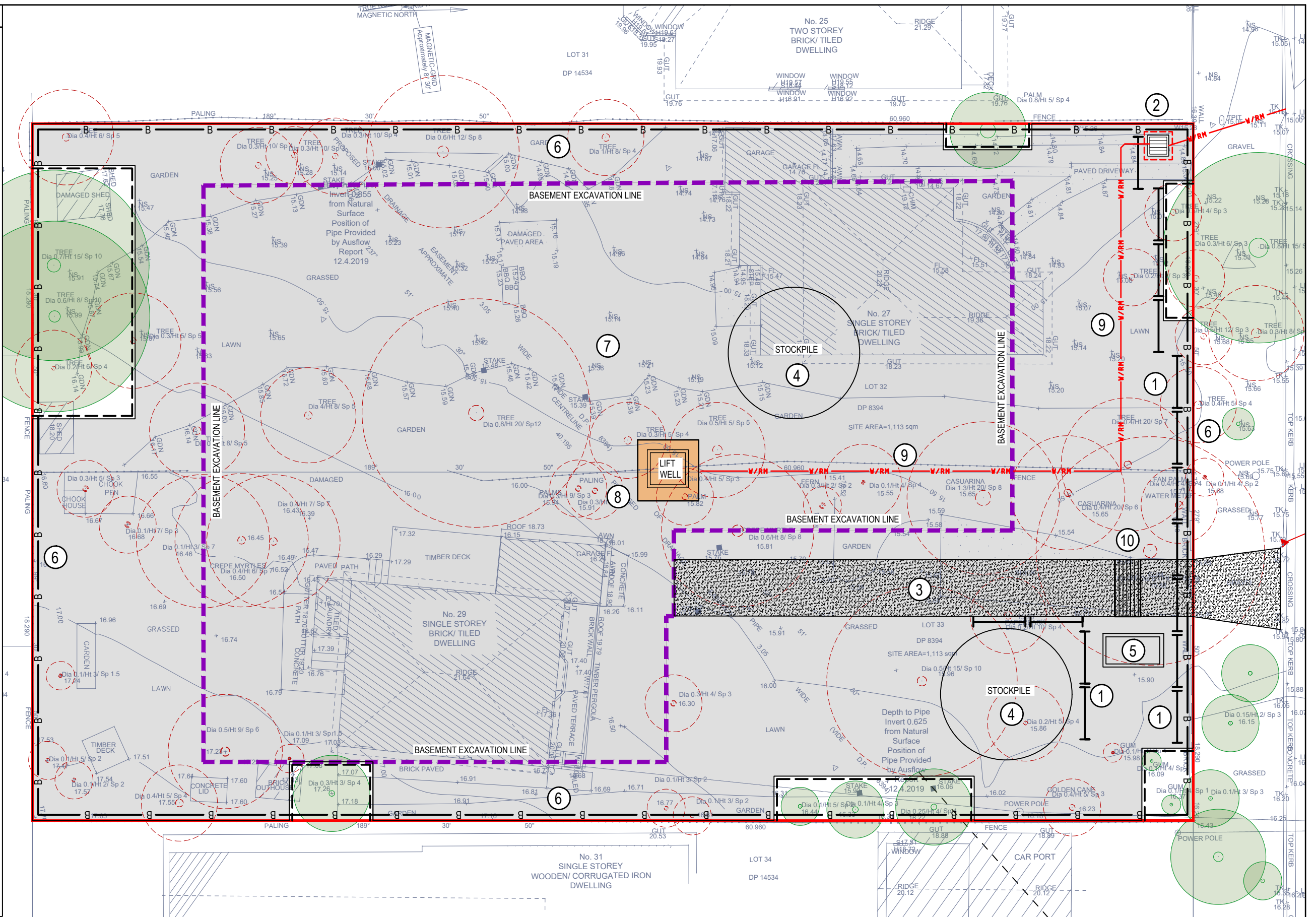

EROSION & SEDIMENT CONTROL PLAN

SCALE - 1:100/A1, 1:200/A3

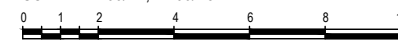

© COPYRIGHT of this design and plan is the property of ACOR Consultants (CC) Pty Ltd, ACN 127 012 104 ATF The ACOR (CC) Unit Trust ABN 81 392 991 647, all rights reserved. It must not be used, modified, reproduced or copied wholly or in part without written permission from ACOR Consultants (CC) Pty Ltd. ACOR Consultants is a trademark licensed to ACOR Consultants (CC) Pty Ltd by ACOR Consultants Pty Ltd.

This drawing has been assigned an electronic code that signifies the drawing has been checked and approved by: MR MICHAEL GOODWIN MIEAust CPEng NER

Issue	Description	Date	Drawn	Approved
A	ISSUED FOR COUNCIL APPROVAL	23.09.20	SJ	BK

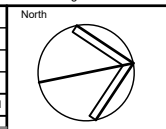

Client
ARMADA AVALON PTY LTD

Architect
ENVIRONA STUDIO

ACOR Consultants (CC) Pty Ltd
Platinum Building, Suite 2.01, 4 Ilya Avenue
ERINA NSW 2250, Australia
T +61 2 4324 3499

ENGINEERS | MANAGERS | INFRASTRUCTURE PLANNERS | DEVELOPMENT CONSULTANTS

Project
PROPOSED RESIDENTIAL DEVELOPMENT
No. 27 - 29
NORTH AVALON ROAD
AVALON BEACH

Drawing Title				
EROSION & SEDIMENT CONTROL PLAN				
Drawn	Date	Scale	A1	Q.A. Check
SJ	18.09.20	AS NOTED	-	-
Designed	Project No.	Dwg. No.	Issue	
BK	CC200310	E2	A	

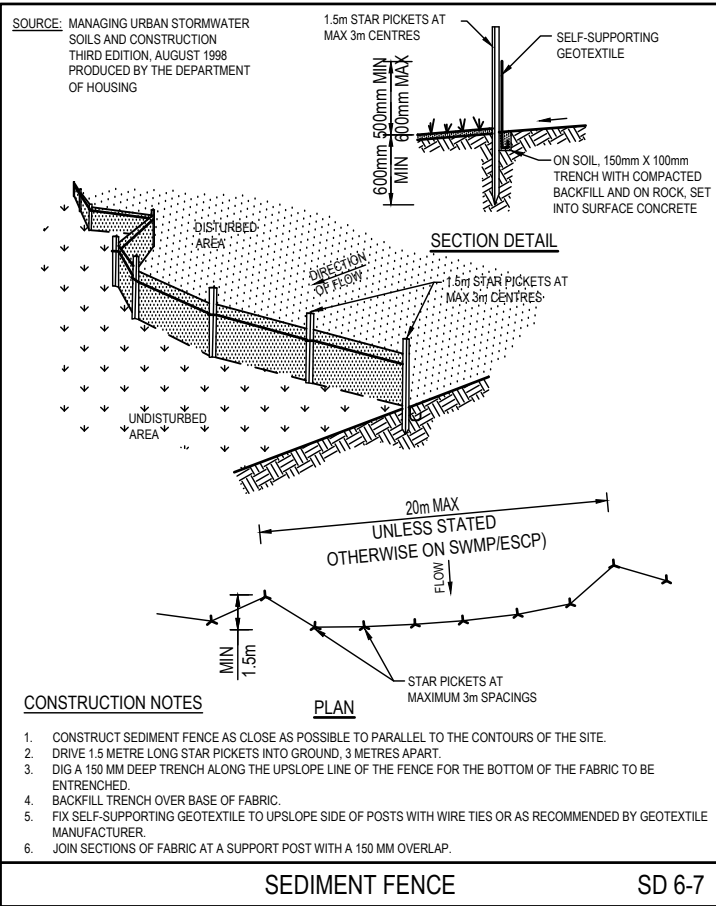

SEDIMENT FENCE

SD 6-7

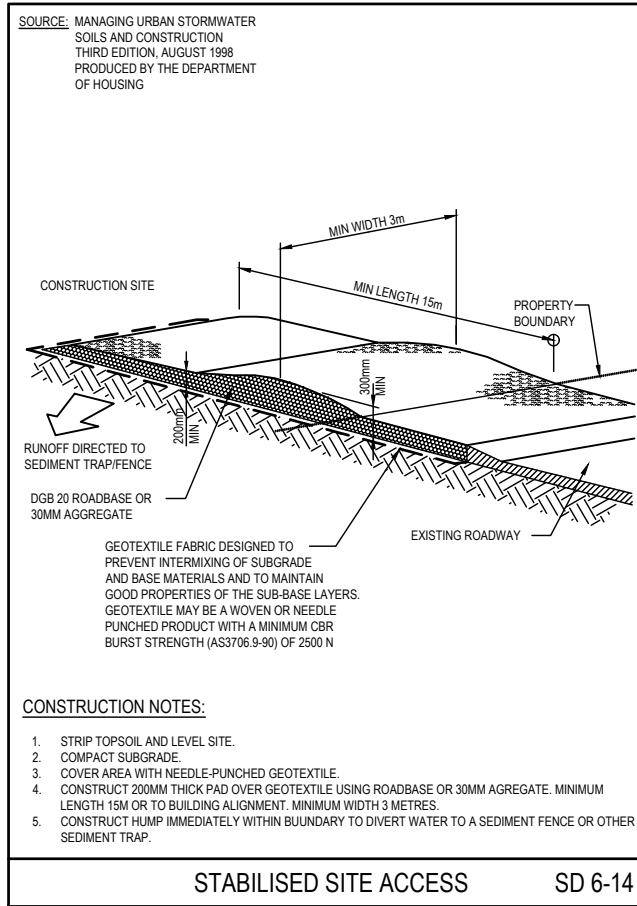

STABILISED SITE ACCESS

SD 6-14

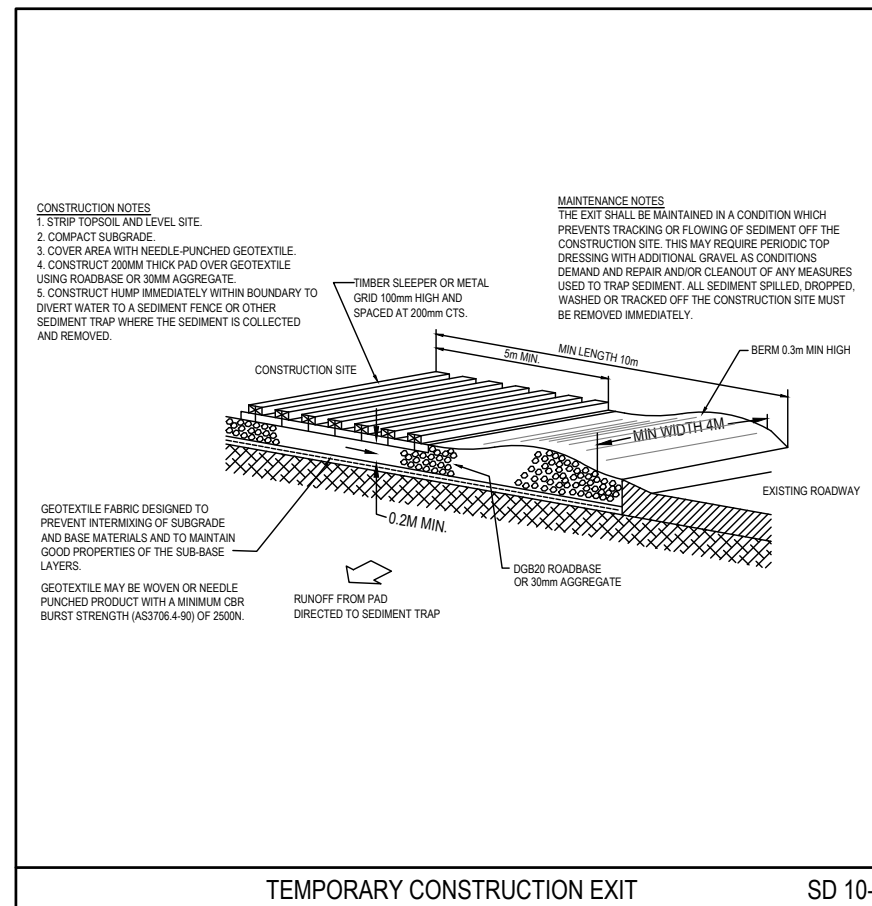

TEMPORARY CONSTRUCTION EXIT

SD 10-1

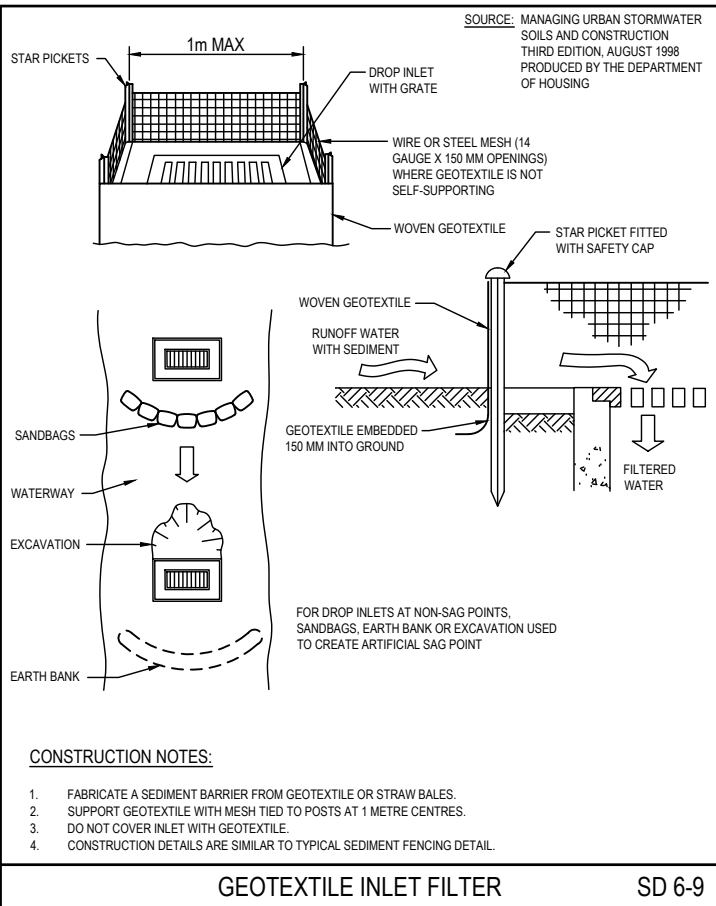

GEOTEXTILE INLET FILTER

SD 6-9

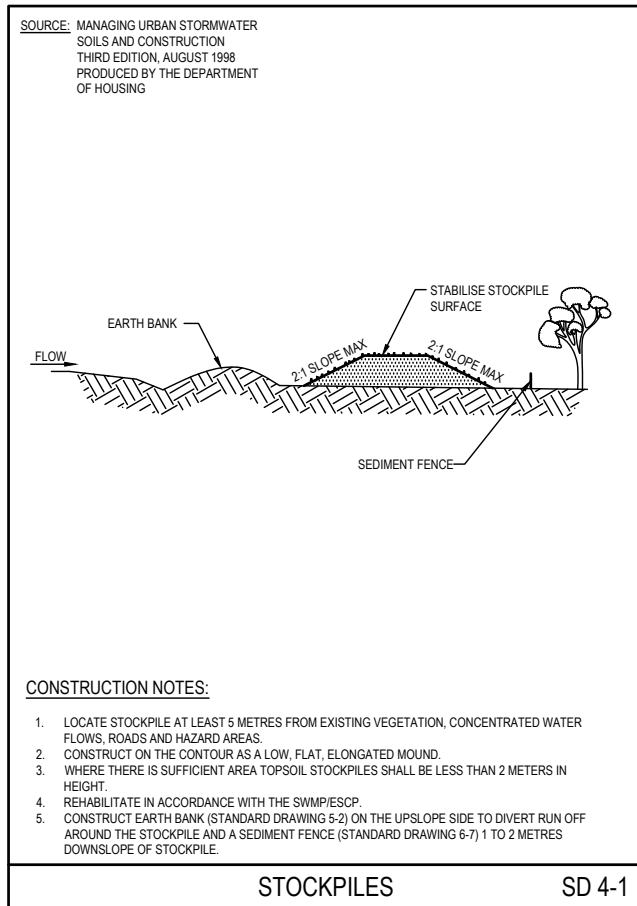

STOCKPILES

SD 4-1

© COPYRIGHT of this design and plan is the property of ACOR Consultants (CC) Pty Ltd, ACN 127 012 104 ATF The ACOR (CC) Unit Trust ABN 81 392 991 647, all rights reserved. It must not be used, modified, reproduced or copied wholly or in part without written permission from ACOR Consultants (CC) Pty Ltd. ACOR Consultants is a trademark licensed to ACOR Consultants (CC) Pty Ltd by ACOR Consultants Pty Ltd.

This drawing has been assigned an electronic code that signifies the drawing has been checked and approved by: MR MICHAEL GOODWIN MIEAust CPEng NER

Issue	Description	Date	Drawn	Approved
A	ISSUED FOR COUNCIL APPROVAL	23.09.20	SJ	BK

Client
ARMADA AVALON PTY LTD

Architect
ENVIRONA STUDIO

ACOR Consultants (CC) Pty Ltd
Platinum Building, Suite 2.01, 4 Ilya Avenue
ERINA NSW 2250, Australia
T +61 2 4324 3499

ENGINEERS | MANAGERS | INFRASTRUCTURE PLANNERS | DEVELOPMENT CONSULTANTS

Project
PROPOSED RESIDENTIAL DEVELOPMENT
No.27 - 29
NORTH AVALON ROAD
AVALON BEACH

Drawing Title EROSION & SEDIMENT CONTROL NOTES					
Drawn	Date	Scale	A1	Q.A. Check	Date
SJ	18.09.20	AS NOTED	-	-	-
Designed	Project No.	Dwg. No.	Issue		
BK	CC200310	E3	A		