

LAYOUT STORMWATER DRAINAGE PLAN

SCALE 1:100

CALCULATION:
 SITE AREA = 1160 sqm
 IMPERVIOUS AREA = 585sqm
 IMPERVIOUS AREA = 50.4% OF SITE AREA

ROOF AREA = 410 SQM
 STORMWATER RUNOFF FROM ROOF AREA
 COLLECTED BY RWT = 410 SQM = 100% OF
 ROOF AREA

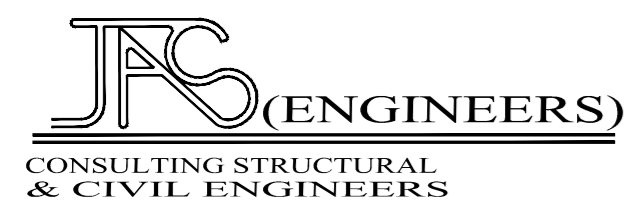
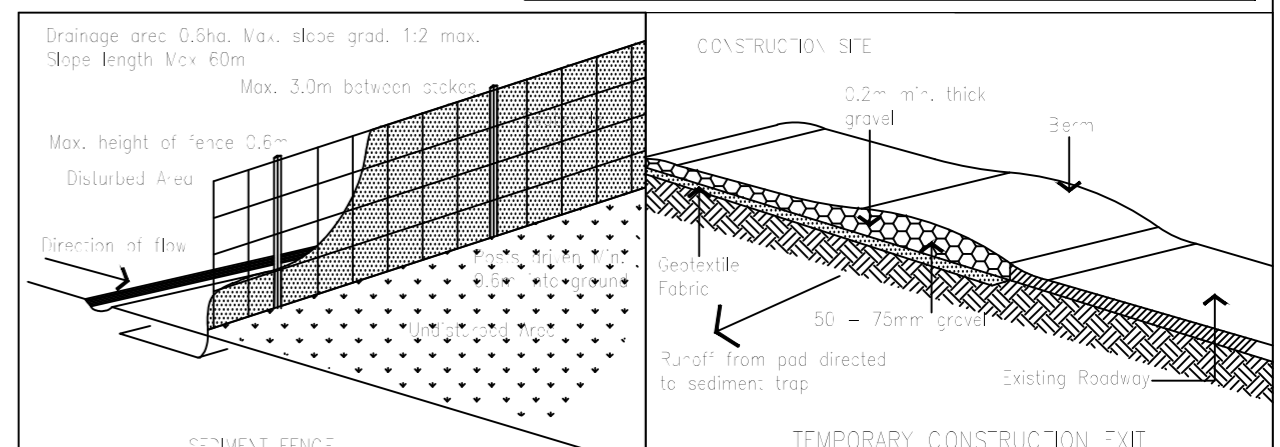

54 WATER STREET
 BELFIELD NSW 2191
 Phone (02) 9718 7783
 Fax (02) 8971 9813
 Mob: 0425 305 433
 Email jas_sydney@hotmail.com

TITLE: LAYOUT STORMWATER DRAINAGE PLAN AND SECTION DETAILS	DRAWN BY: F.J.SALAME	DESIGNED BY: J.A.SALAME	CLIENT NAME: SAHARA CONSTRUCTIONS
DATE: AMENDMENTS	REV.	APPROVED: [Signature]	PROJECT DESCRIPTION: PROPOSED NEW DWELLING
		SHEET No: 1/2	PROJECT ADDRESS: 2177 PIT WATER RD, CHURCH POINT NSW
		ISSUE DATE: 21-06-16	JOB REF: J390615
		SCALES: PLAN 1:100, SECTIONS 1:20	DRAWING No: J393015/SWD

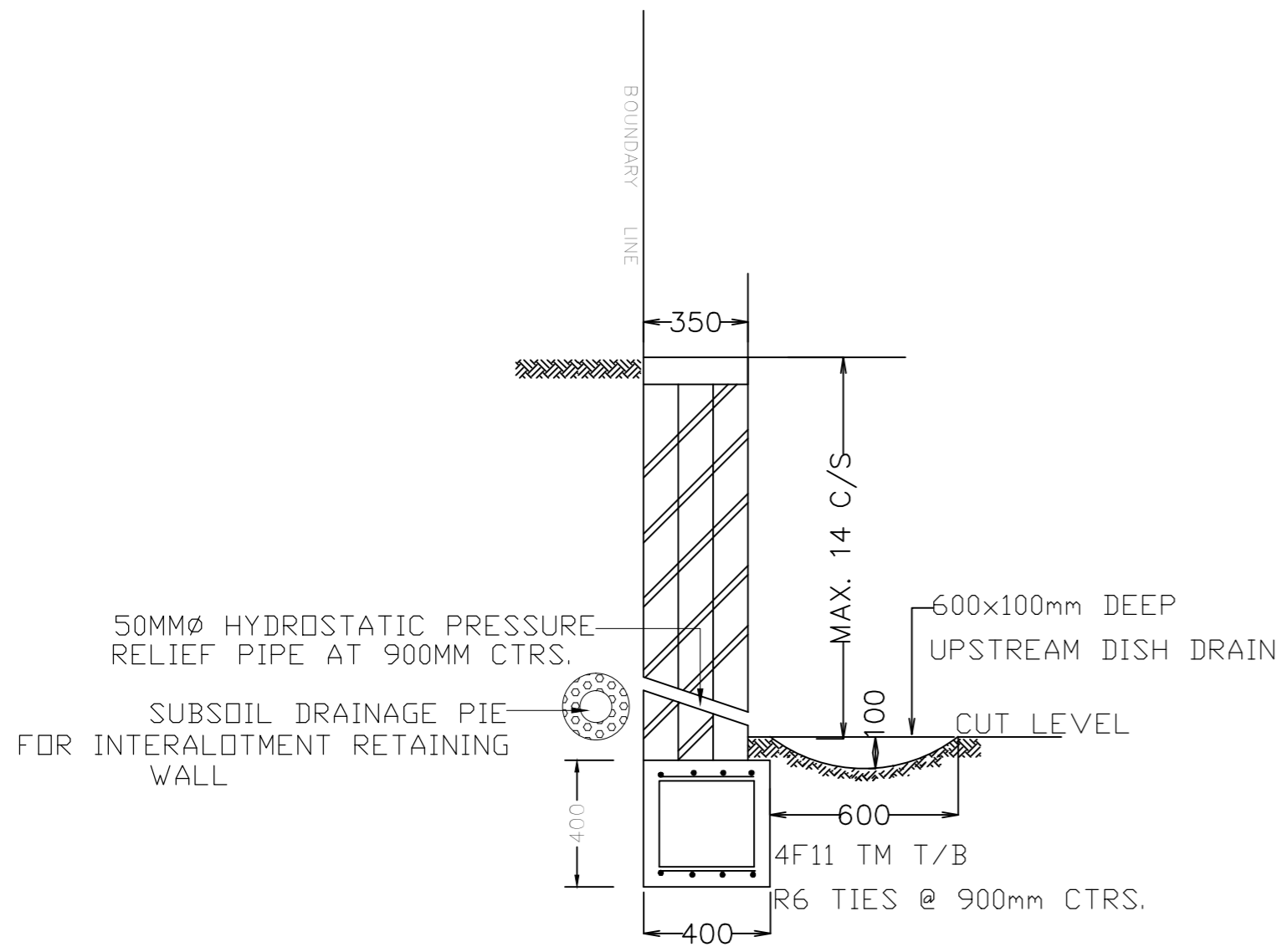

TYPICAL BOUNDARY RETAINING WALL SECTION DETAILS FOR MAX. 14C/S

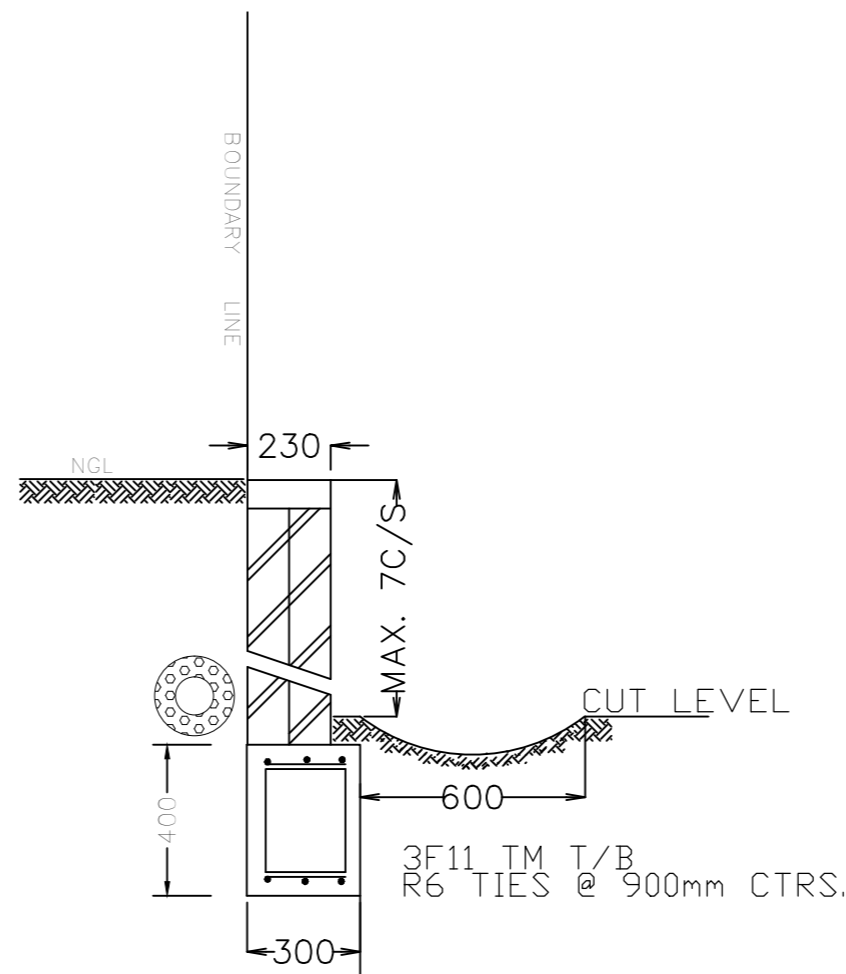

TYPICAL BOUNDARY RETAINING WALL AND DISH DRAIN SECTION DETAIL FOR MAXIMUM 7 C/S

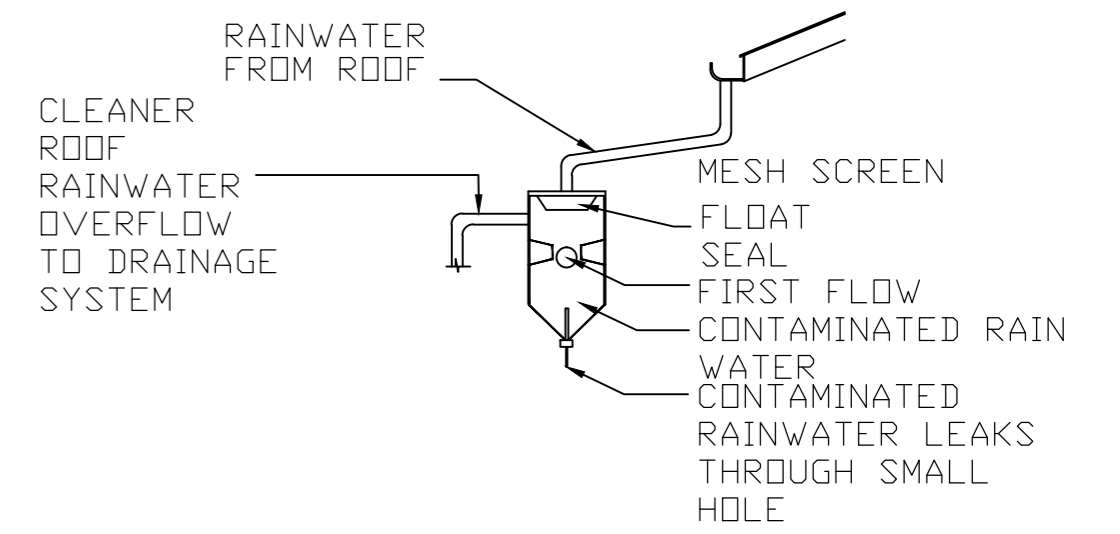

FIRST - FLUSH DEVICE

NTS

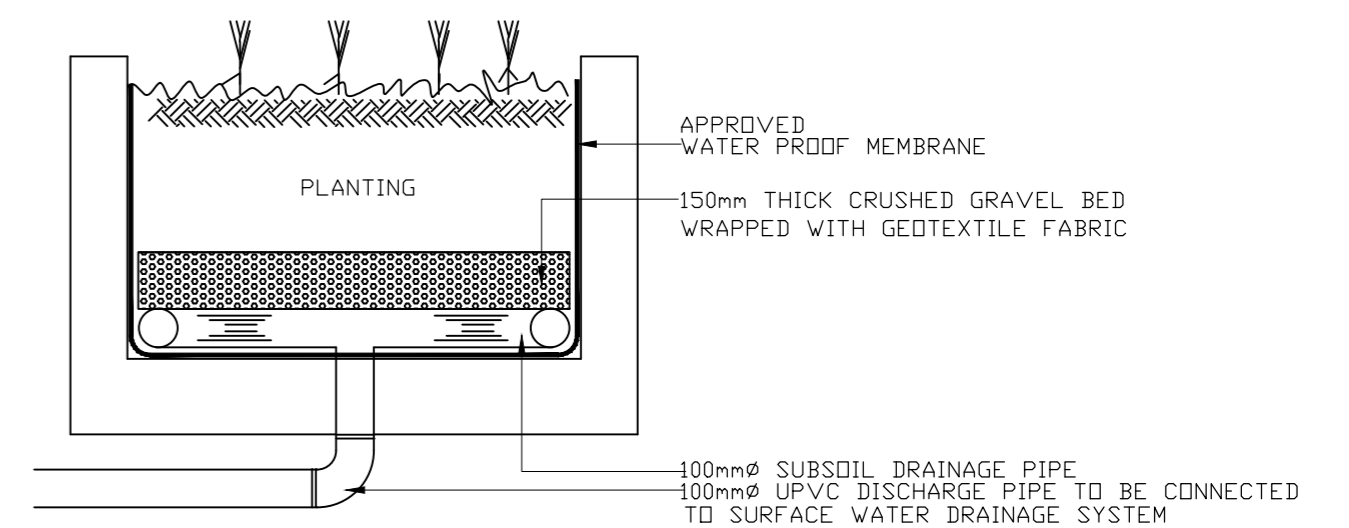

TYPICAL PLANTER BOX DRAINAGE DETAIL

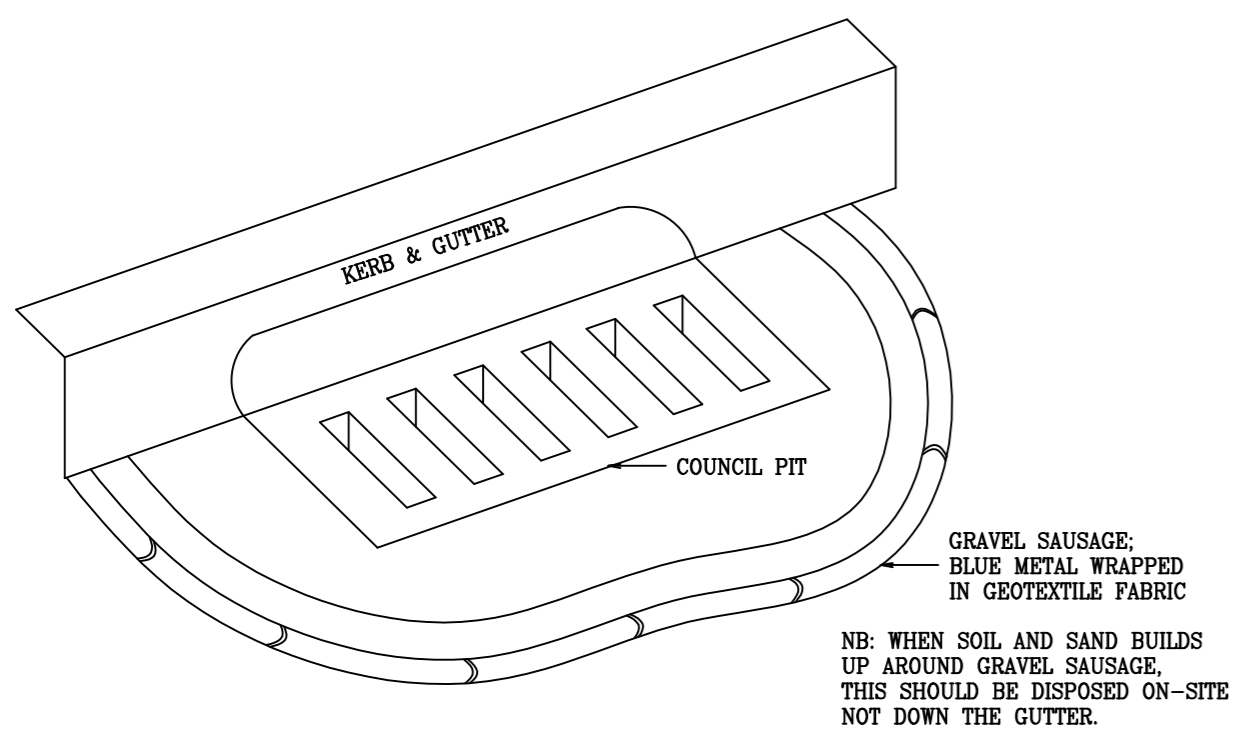

GRAVEL SAUSAGE - GUTTER PROTECTION

N.T.S.

GENERAL NOTES

ALL WORK TO BE DONE TO THE SATISFACTION OF PIT WATER COUNCIL

SILT FENCE TO BE CONSTRUCTED AS PER DETAIL SHOWN OR BY USING AN APPROVED EQUIVALENT MEASURE. THE SILT FENCE IS TO BE CONSTRUCTED PRIOR TO ANY OTHER CONSTRUCTION ACTIVITIES. IT IS TO BE KEPT IN GOOD WORKING ORDER AT ALL TIMES. WHEN APPROXIMATELY 30% FULL OR AS DIRECTED BY COUNCIL'S REPRESENTATIVE, THE SILT FENCES ARE TO BE CLEARED OF SILT AND OR OTHER BUILT UP MATERIALS. SEE DETAILS ON SHEET No.2.

ALL DOWNPIPES AND GROUND PIPES TO BE UPVC WITH ALL JOINS GLUE SEALED UNLESS NOTED OTHERWISE
ALL DOWNPIPES TO BE 100x50 RHS OR 100mm Ø UPVC (UNO)
ALL PLASTIC PIPES SHALL BE SEWER EXTRA HEAVY GRADE.

PROPOSED CONCRETE DRIVEWAY TO BE CONSTRUCTED IN ACCORDANCE WITH PLANS, SPECIFICATIONS, AND LEVELS ISSUED SEPARATELY BY COUNCIL.

STORMWATER DRAINAGE ELEMENTS OUTSIDE THE PROPERTY BOUNDARY SHALL BE CONSTRUCTED UNDER SATISFACTION OF COUNCIL.

FINISHED CROSSING AND DRIVEWAY LEVELS ARE BASED ON SURFACE LEVELS OF THE EXISTING LAYBACK AND STREET BOUNDARY LEVELS.

BEFORE COMMENCING CONSTRUCTION OF THE CROSSING AND DRIVEWAY, COUNCIL'S DESIGNED STREET BOUNDARY LEVELS MUST BE OBTAINED AND USED FOR CONSTRUCTION.

THE DESIGN FINISHED SURFACE LEVELS OF THE STREET BOUNDARY MUST BE OBTAINED BY APPLICATION TO COUNCIL AND PAYMENT OF THE APPROPRIATE FEE TO COUNCIL.

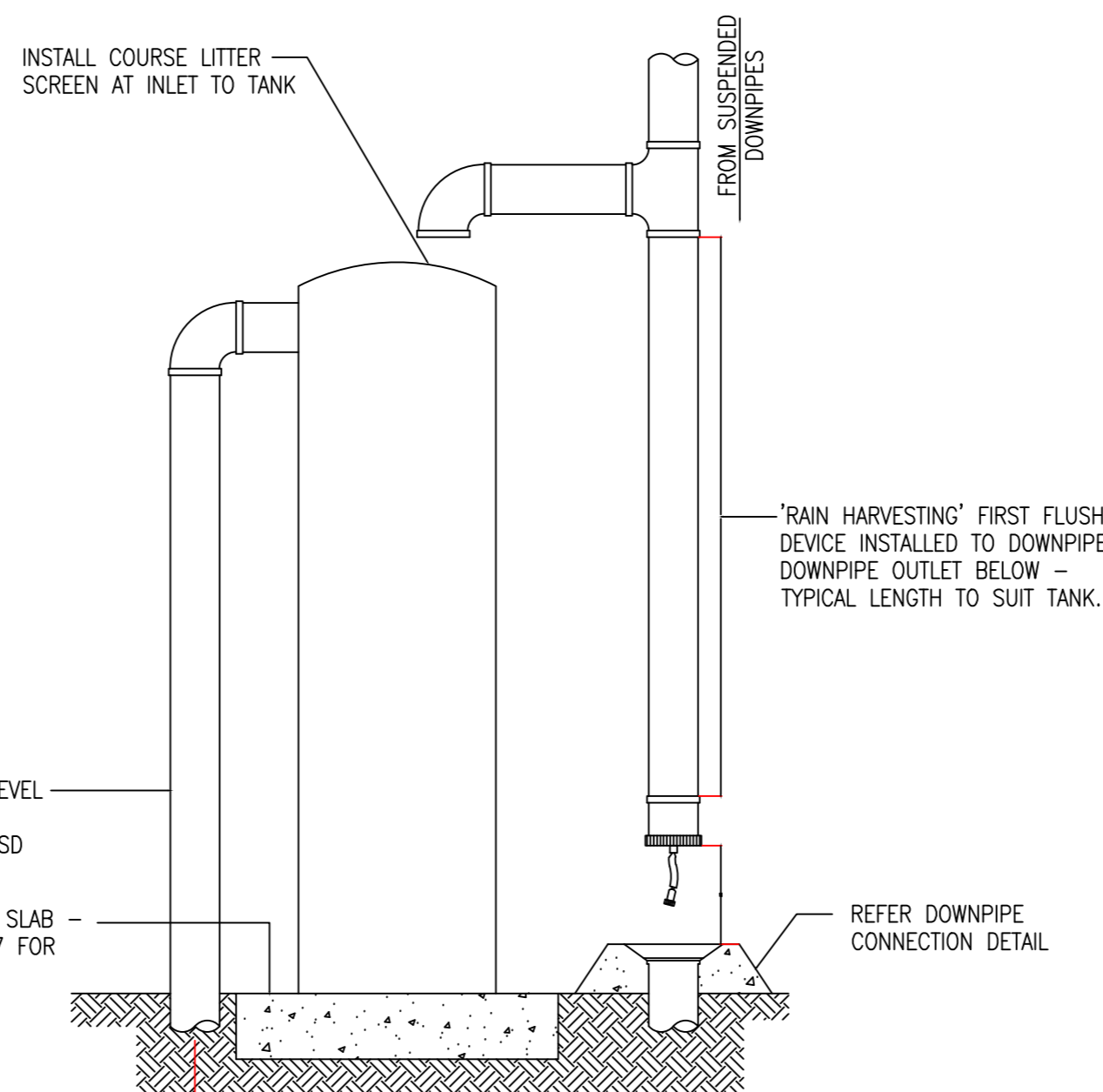

RAINWATER RE-USE TANK DETAIL

SCALE 1:20

NOTES:

1. PROVIDE RAINWATER RE-USE SYSTEM TO SUPPLY WATER FOR GRAVITY FED IRRIGATION & TOILET FLUSHING.
2. PROVIDE TAP TO RAINWATER TANK TO HYDRAULIC ENGINEERS SPECIFICATION.
3. A PERMANENT SIGN IS TO BE LOCATED IN THE VICINITY OF THE TANK STATING: "WATER IS NOT SUITABLE FOR DRINKING".
4. A FIRST FLUSH DEVICE IS TO BE PROVIDED.
5. PROVIDE BI-DIRECTIONAL FLAP VALVES AND/OR INSECT SCREENS TO ALL OPENINGS TO RAINWATER TANK.

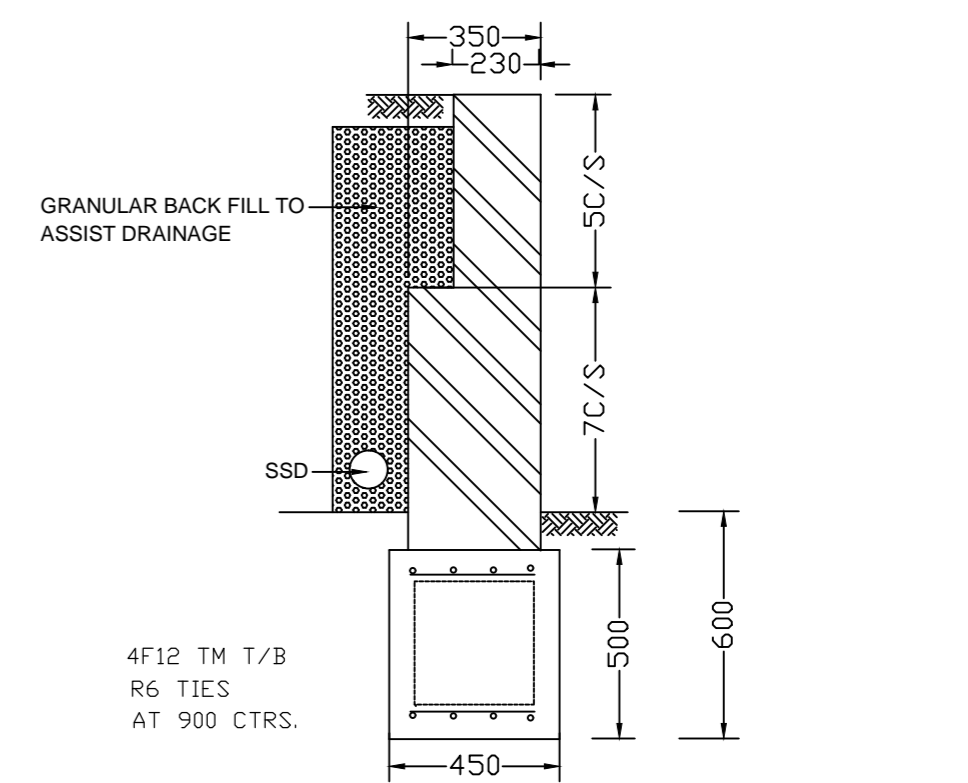

TYPICAL BRICK RETAINING WALL ON CALY

NTS

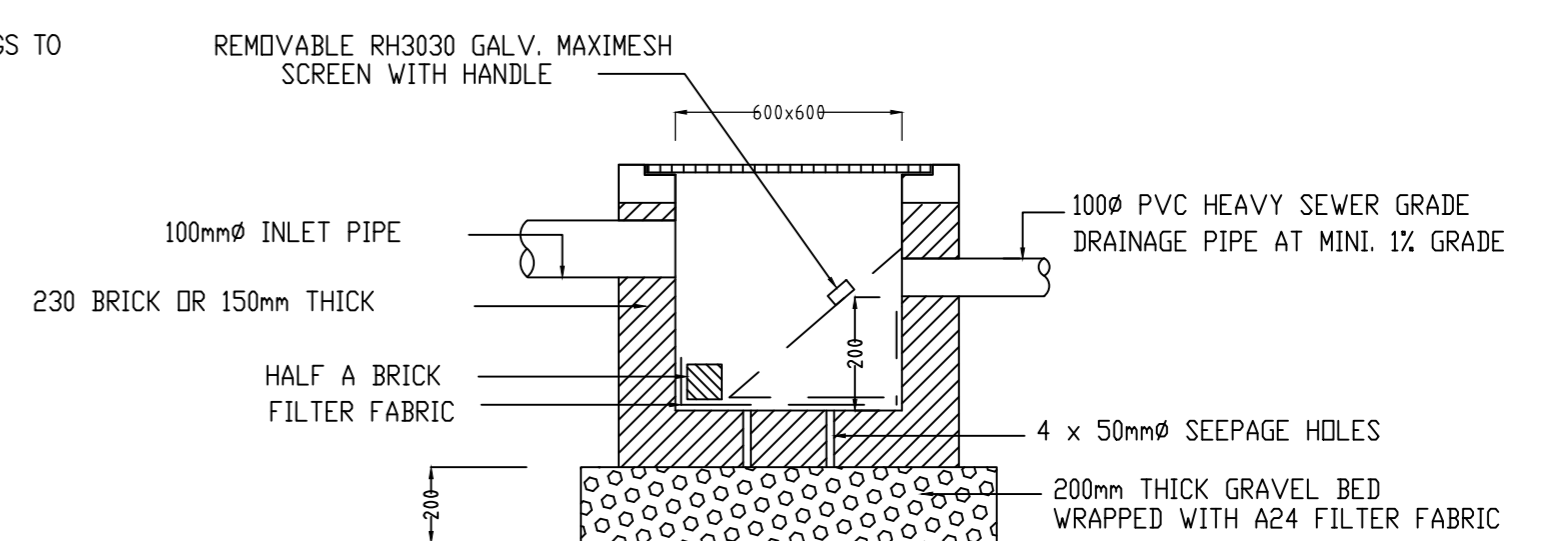

SILT ARRESTOR PIT SECTION DETAILS

NTS

LEGEND

- SDP SPREADER DOWN PIPE
- D.P DOWN PIPE
- F.FL FLOOR LEVEL
- TK TOP OF KERB
- SL SURFACE LEVEL
- IL INVERT LEVEL
- G.D. GRATED DRAIN
- + 17.06 EXISTING LEVELS
- + 17.06 DESIGN LEVELS
- FW 150mm Ø FLOOR WASTE TO BE CONNECTED TO SEWER SYSTEM
- IE INSPECTION EYE

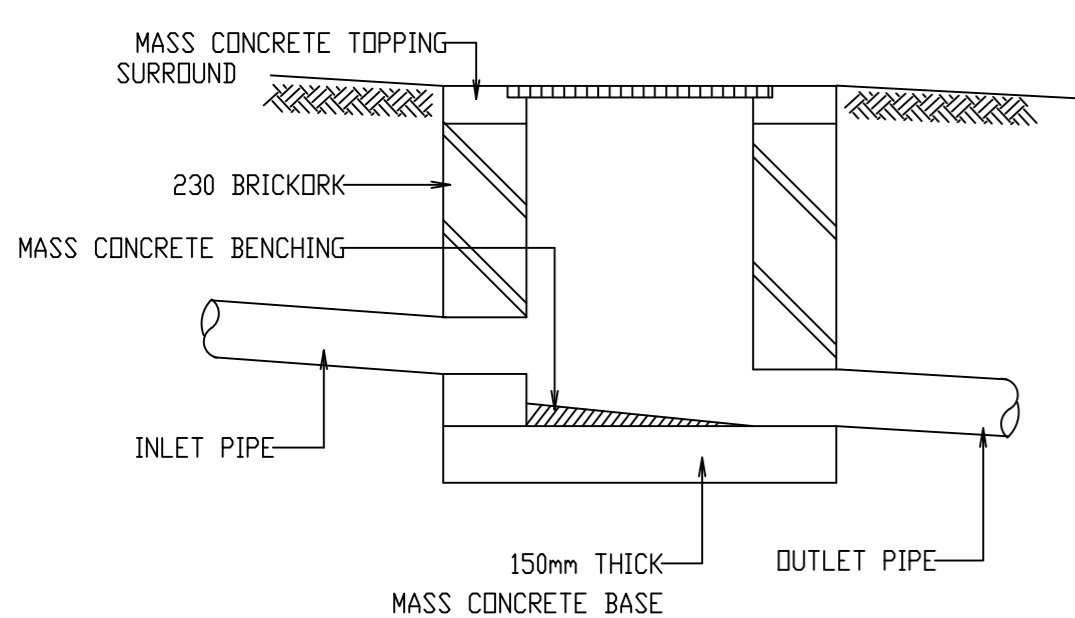

TYPICAL GIP SECTION DETAIL

NTS

