



10 May 2021

Michael Fountain Architects PTY LTD
Unit 2
5 Narabang Way
Belrose NSW 2085
mfa@mfa.com.au

Dear Mr Fountain

Re: Development application for proposed replacement of existing structures including timber jetty, concrete jetty, ramp, steps, slip rail and boatshed at 316 Hudson Parade Clareville DA2020/1762

Encl: Signed/dated plans

I refer to your email to Transport for NSW Maritime dated 4 May 2021 regarding assessment of the above proposal.

We advise that an inspection/assessment has been conducted by the local Boating Safety Officer and there are no navigational concerns regarding the designated proposal.

Yours sincerely

A handwritten signature in black ink, consisting of a stylized 'R' followed by a long horizontal stroke.

Manager Operations
Hawkesbury River Broken Bay
Transport for NSW
Maritime Division



4th May 2021

Transport for NSW – Maritime
Att. Anita Schulze
Boating Safety Officer Pittwater East

Anita,

RE: DA2020/1762 - 316 Hudson Parade, Clareville

The above-mentioned development application is currently being assessed by Northern Beaches Council.

Our client enjoys a licence, LI 559856 from DPI – Lands, over 205.9sqm of water space at Refuge Cove, Pittwater.

The Northern Beaches Council assessing officer, Jordan Davies,
Jordan.Davies@northernbeaches.nsw.gov.au has made the following request:

4. *Supporting Letter from Transport for NSW (Formally RMS) – A supporting letter from Transport for NSW (Formally RMS) is required for the proposed works, being development within the waterway.*

The maritime structures on the subject water space have existed since at least 1947.

Our client was in the process of replacing the structures under the terms of a complying development certificate when Northern Beaches Council determined that there was a legal flaw in the certificate and stopped the works pending the lodgement of a development application.

We are seeking your support to replace the structures as described in the following images and attached drawing.



Previous Structures



Current Works

Anita Schulze

6/5/2021

Micheal Fountain
Architects Pty Ltd.

Unit 2, No. 5
Narabang Way
Belrose, NSW 2085.

T: (02)9450 2070
M: 0418 869 621
E: mfa@mfa.com.au

This drawing illustrates the existing proposal overlaid with an outline of the previous structures in green.

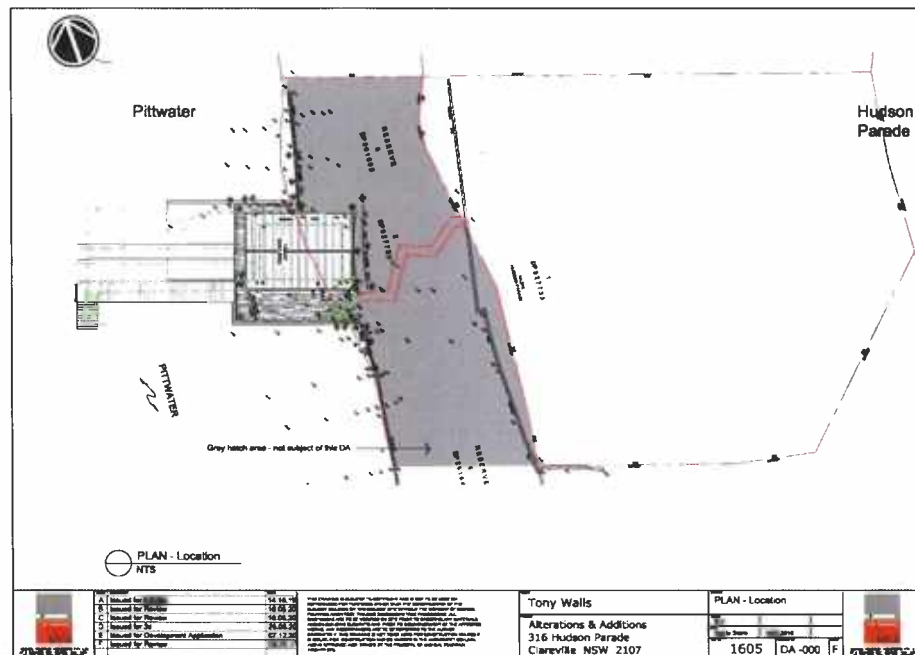

The structures include a timber jetty, concrete jetty, ramp, steps, slip rails and boatshed all of which are to be in approximately the same position as they once were or in the case of the outer jetty piles, still are.

The jetty and steps are slightly wider, longer and squared up compared to the original, the jetty extends between 0.6m and 1.1m further seaward, however these structures do not extend beyond the existing slipway rails.

The previous isolated pile, that was used for berthing, will not be replaced.

The proposed works will not affect navigation of vessels in the area beyond that which had existed for many years.

We trust the following documents adequately describe the proposal however should you have any queries please do not hesitate to call or email us on the contacts detailed above.

Regards,

Micheal Fountain Architects Pty Ltd.
Micheal Fountain.