

UNDERGROUND SERVICES, WHERE SHOWN, ARE BASED UPON SURFACE INSPECTION OR SERVICE DIAGRAMS SUPPLIED BY RELEVANT AUTHORITIES. CONTRACTORS MUST MAKE THEIR OWN ENQUIRIES.

**LEGEND**

- Power pole
- Hydrant
- Tap
- Drainage pit
- Street sign
- Telecomms pit
- Electricity
- Gas line
- Water line
- Telecomms
- Water
- IL. Invert Level
- SL. Surface Level
- TW. Top of Wall
- BW. Bottom of Wall
- TR. Top of Rock
- KB. Top of Kerb
- G. Gutter Invert
- FL. Floor Level
- LG. Lip of Roof Gutter



1  
D.P.1083731  
MATER MARIA  
CATHOLIC COLLEGE

S.P.79867

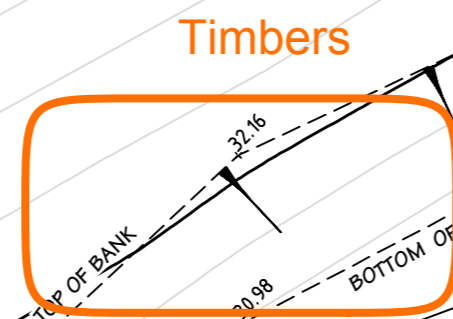
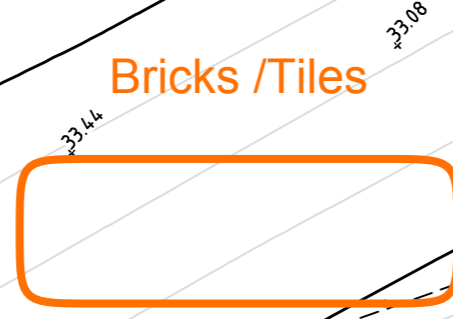
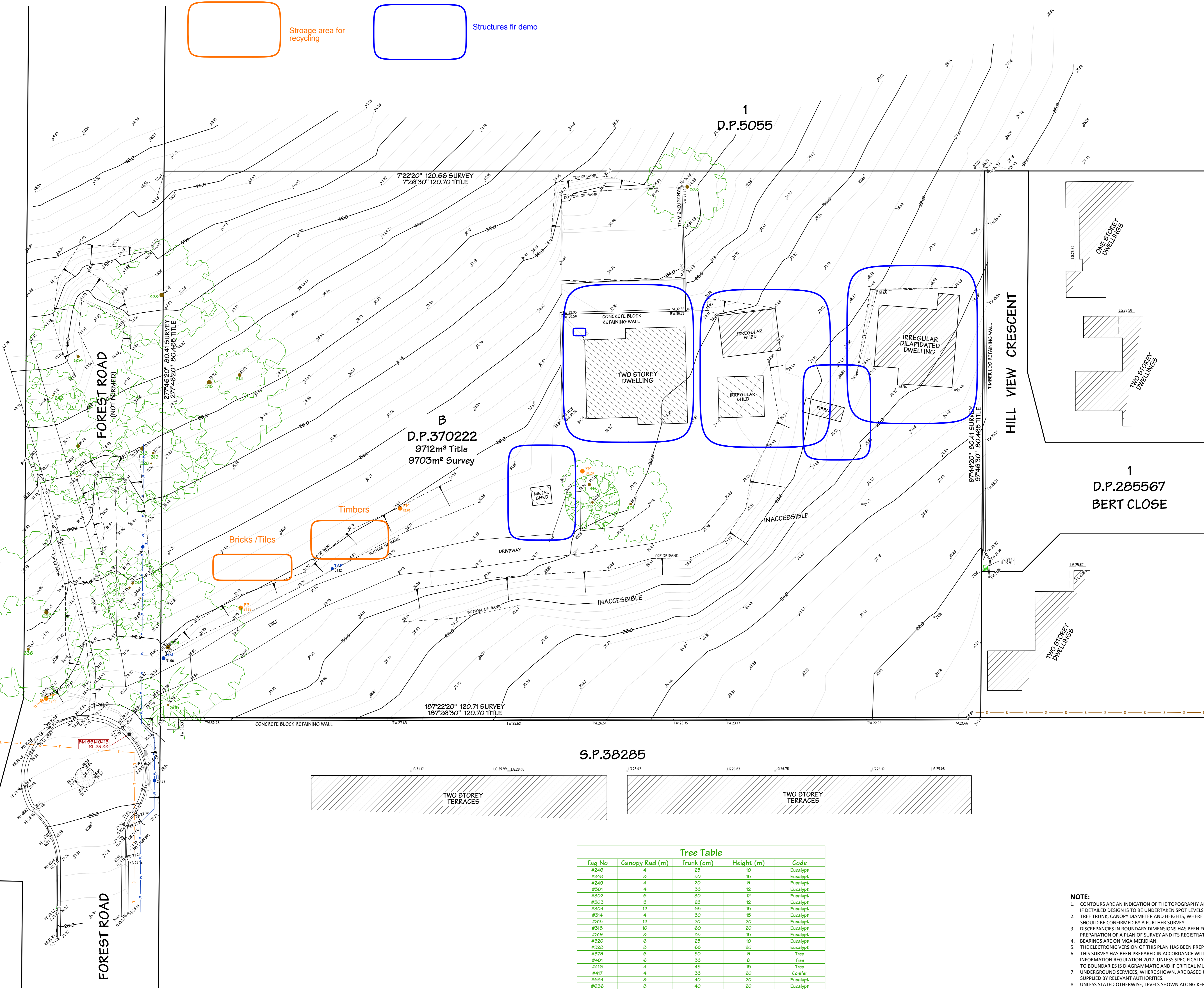

**Tree Table**

| Tag No | Canopy Rad (m) | Trunk (cm) | Height (m) | Code     |
|--------|----------------|------------|------------|----------|
| #246   | 4              | 25         | 10         | Eucalypt |
| #248   | 8              | 50         | 15         | Eucalypt |
| #249   | 4              | 20         | 8          | Eucalypt |
| #301   | 4              | 35         | 12         | Eucalypt |
| #302   | 6              | 30         | 12         | Eucalypt |
| #303   | 5              | 25         | 12         | Eucalypt |
| #304   | 12             | 65         | 15         | Eucalypt |
| #314   | 4              | 50         | 15         | Eucalypt |
| #315   | 12             | 70         | 20         | Eucalypt |
| #316   | 10             | 60         | 20         | Eucalypt |
| #319   | 8              | 35         | 15         | Eucalypt |
| #320   | 6              | 25         | 10         | Eucalypt |
| #328   | 8              | 65         | 20         | Eucalypt |
| #378   | 6              | 50         | 8          | Tree     |
| #401   | 6              | 35         | 8          | Tree     |
| #415   | 4              | 45         | 15         | Tree     |
| #417   | 4              | 35         | 20         | Conifer  |
| #834   | 8              | 40         | 20         | Eucalypt |
| #836   | 8              | 40         | 20         | Eucalypt |
| #637   | 12             | 60         | 25         | Eucalypt |

**NOTE:**

- CONTOURS ARE AN INDICATION OF THE TOPOGRAPHY AND SHOULD ONLY BE USED FOR PLANNING PURPOSES. IF DETAILED DESIGN IS TO BE UNDERTAKEN SPOT LEVELS SHOULD BE USED.
- TREE TRUNK, CANOPY DIAMETER AND HEIGHTS, WHERE SHOWN, ARE INDICATIVE ONLY AND IF CRITICAL SHOULD BE CONFIRMED BY A FURTHER SURVEY.
- DISCREPANCIES IN BOUNDARY DIMENSIONS HAS BEEN FOUND. THE DIMENSIONS NOTED ARE SUBJECT TO THE PREPARATION OF A PLAN OF SURVEY AND ITS REGISTRATION AT NSW LAND REGISTRY SERVICES.
- BEARINGS ARE ON MGA MERIDIAN.
- THE ELECTRONIC VERSION OF THIS PLAN HAS BEEN PREPARED TO APPROXIMATE MGA2020 COORDINATES.
- THIS SURVEY HAS BEEN PREPARED IN ACCORDANCE WITH CLAUSE 9(1) OF THE SURVEYING AND SPATIAL INFORMATION REGULATION 2017. UNLESS SPECIFICALLY DIMENSIONED, THE RELATIONSHIP OF IMPROVEMENTS TO BOUNDARIES IS DIAGRAMMATIC AND IF CRITICAL MUST BE CONFIRMED BY A FURTHER SURVEY.
- UNDERGROUND SERVICES, WHERE SHOWN, ARE BASED UPON SURFACE INSPECTION OR SERVICE DIAGRAMS SUPPLIED BY RELEVANT AUTHORITIES.
- UNLESS STATED OTHERWISE, LEVELS SHOWN ALONG KERB & GUTTER ARE GUTTER INVERT LEVELS.
- ORIGIN OF DATUM: S5149528 - RL19.921 A.H.D. ACC-B (SOURCE: SCIMS 26/05/2021)
- ORIGIN OF COORDINATE: S5149413 - E.341094.741, N.6271699.799 ACC-C (SOURCE: SCIMS 26/05/2021)

|       |          |  |     |
|-------|----------|--|-----|
| 02    | 07/09/21 | ADDITIONAL LEVELS WITHIN FOREST RD & ALONG WESTERN B'DY. | JMI |
| ISSUE | DATE     | AMENDMENT  | BY  |

CLIENT:  
**BMN PROPERTIES PTY LTD**

NOTES:

TITLE:  
**PLAN SHOWING DETAIL AND LEVELS OF LOT B D.P.370222. 4 FOREST ROAD, WARRIEWOOD**

**INFOCUS SURVEYORS**  
7/1 Maitland Place, Norwest Ph: 02 9659-7222 E: admin@infocusurveyors.com.au

REDUCTION RATIO  
 PLAN: A0: 1:200 LONG SECT.: H: 1: V: 1: CROSS SECT.: H: 1: V: 1:  
 A2: \_\_\_\_\_

|                                      |  |                  |                 |
|--------------------------------------|--|------------------|-----------------|
| SHEET 1 OF 1 SHEETS                  |  |                  |                 |
| DATE:<br>07-JUNE-2021                | DWG No.:<br>13935.02.DWG                   | REF:<br>13935.02 |                 |
| SURVEY:<br>JMI/ALK                   | DESIGN:<br>----                            | DRAWN:<br>JMI    | CHECKED:<br>JMI |
| PROJECTION / DATUM:<br>MGA2020 / AHD | CONTOUR INTERVAL:<br>MAJOR: 2m MINOR: 0.5m | ISSUE:<br>02     | <b>A0</b>       |