

NOTES: SOIL & WATER MANAGEMENT PLAN

1. ALL EROSION AND SEDIMENT CONTROL MEASURES TO BE INSPECTED AND MAINTAINED DAILY BY SITE MANAGER.
2. MINIMISE DISTURBED AREAS
3. ALL STOCKPILES TO BE CLEARED FROM DRAINS, GUTTERS AND FOOTPATHS.
4. DRAINAGE TO BE CONNECTED TO STORMWATER SYSTEM AS SOON AS POSSIBLE.
5. ROAD AND FOOTPATH TO BE SWEEPED DAILY.
6. NO MATERIAL TO BE STORED ON FOOTPATH.
7. IF YOU DO NOT COMPLY YOU MAY BE LIABLE TO A FINE.

1 Stormwater Drainage Plan 1 : 200

Cad Draft P/L

ABN 27 083 288 153
SUITE 4, 670 DARLING STREET,
ROZELLE, NSW
P.O BOX 446 GLADESVILLE 2111
PH: 9555 8545
info@caddraftnsw.com.au

No.	Description	Date

DA - APPLICATION
No.3 DRUMCLIFF AVE
KILLARNEY HEIGHTS
SEC.2 LOT 74 DP 758566
CLIENT: ANDREW SJOQUIST +
JASMINE KOSTA

Stormwater Drainage Plan

Project number	19-62	A117
Date	18-2-20	
Drawn by	KP	
Checked by	JD	
Scale		1 : 200

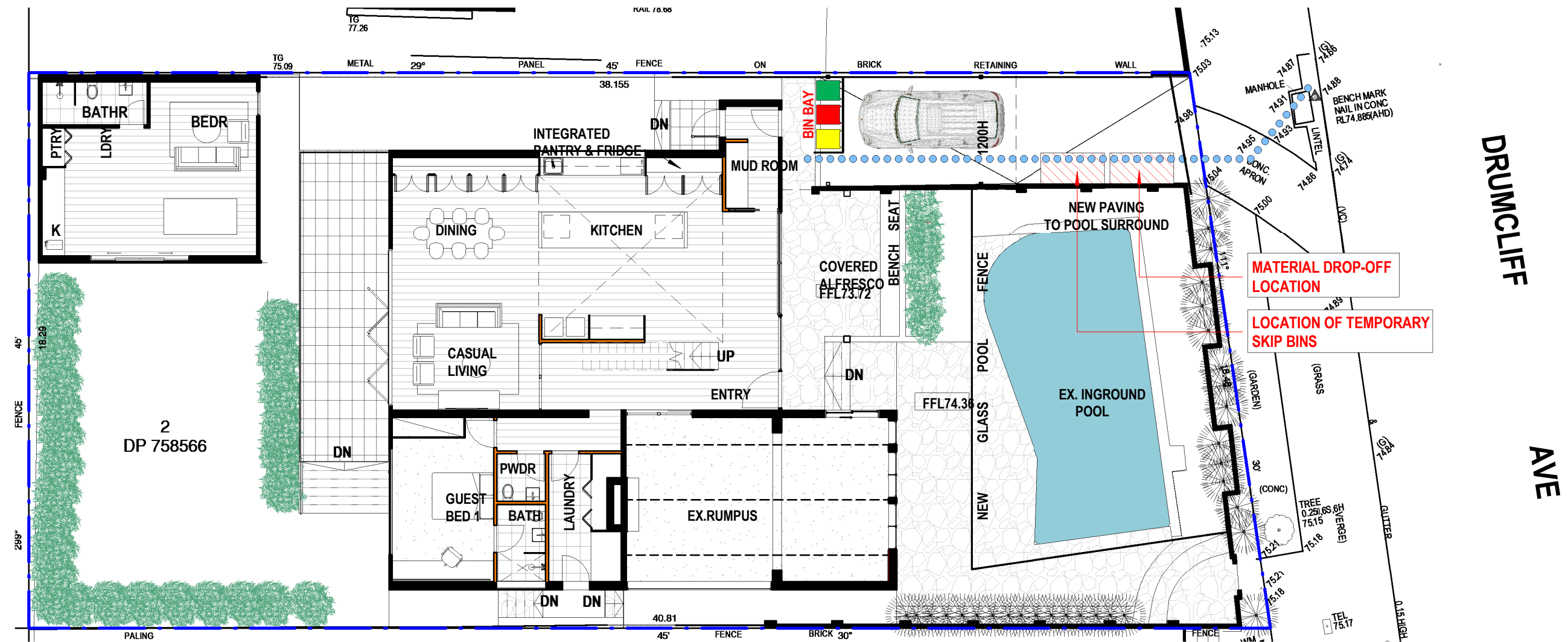

1 Waste Management Plan
1 : 150

NOTES: SITE / WASTE MANAGEMENT

1. ALL EROSION AND SEDIMENT CONTROL MEASURES TO BE INSPECTED AND MAINTAINED DAILY BY SITE MANAGER
2. MINIMISE DISTURBED AREAS
3. ALL STOCKPILES TO BE CLEAR FROM DRAINS, GUTTERS AND FOOTPATHS
4. DRAINAGE IS TO BE CONNECTED TO STORMWATER SYSTEM AS SOON AS POSSIBLE
5. ROADS AND FOOTPATHS TO BE SWEEPED DAILY
6. NO MATERIAL TO BE STORED ON FOOTPATH
7. IF YOU DO NOT COMPLY YOU MAY BE LIABLE TO A FINE

Cad Draft P/L

ABN 27 083 288 153
SUITE 4, 670 DARLING STREET,
ROZELLE, NSW
P.O BOX 446 GLADESVILLE 2111

PH: 9555 8545
info@caddraftnsw.com.au

No.	Description	Date

DA - APPLICATION
No.3 DRUMCLIFF AVE
KILLARNEY HEIGHTS
SEC.2 LOT 74 DP 758566
CLIENT: ANDREW SJOQUIST +
JASMINE KOSTA

Waste Management Plan

Project number	19-62	A118
Date	18-2-20	
Drawn by	KP	
Checked by	JD	
Scale		1 : 150