

Drawing List

Sheet No.	Sheet Name	Sheet Size	Rev. No.	Rev. Date	Project No.
L-01	SITE PLAN	A3	A	19/11/21	1392
L-02	SITE /SEDIMENT/WASTE/STORMWATER PLAN	A3	A	19/11/21	1392
L-03	SITE CALCULATION PLAN	A3	A	19/11/21	1392
L-04	POOL PLAN	A3	A	19/11/21	1392
L-05	REAR YARD LANDSCAPE PLAN	A3	A	19/11/21	1392
L-06	SECTION A & B	A3	A	19/11/21	1392
L-07	SECTION C	A3	A	19/11/21	1392



THIS PLAN IS TO BE READ IN
CONJUNCTION WITH
THE CONDITIONS OF DEVELOPMENT
CONSENT

DA2021/2579

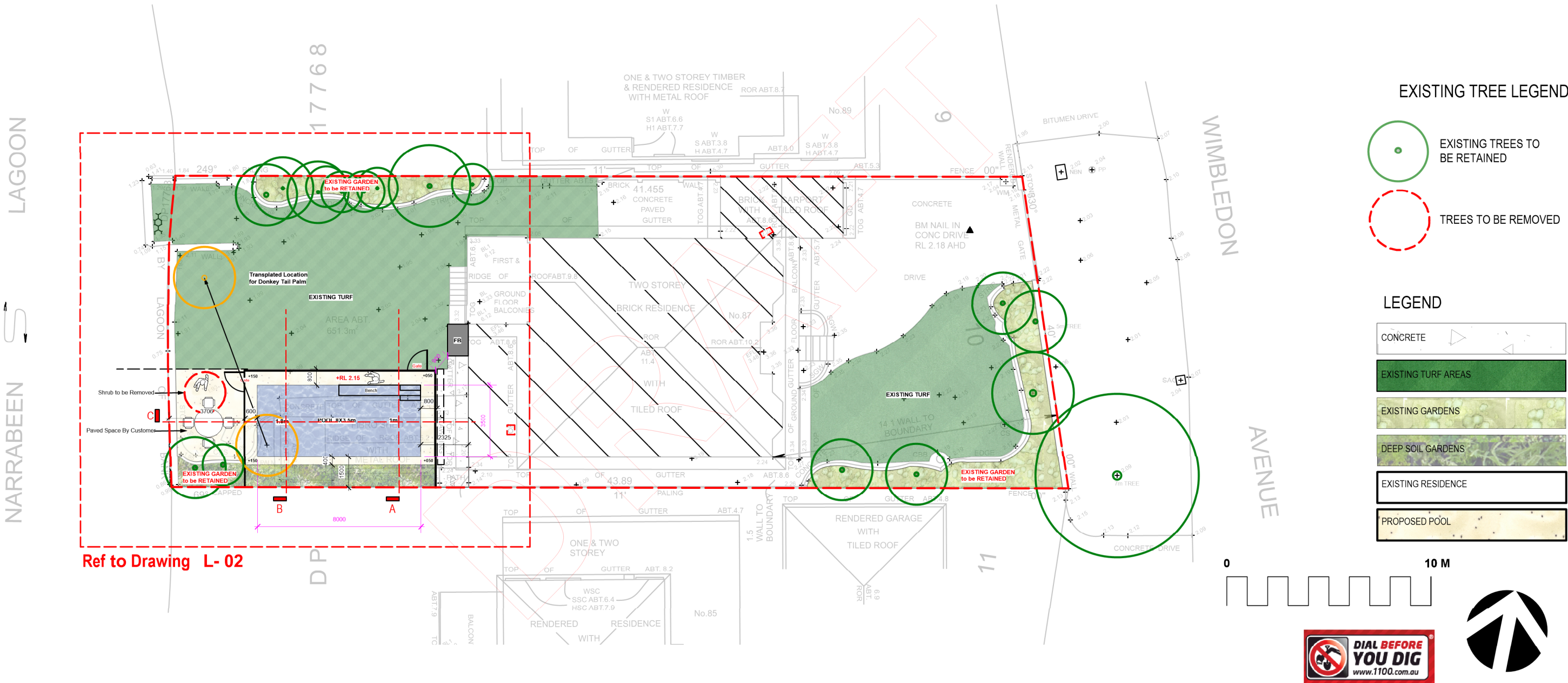

GENERAL NOTES
All work to be carried out in accordance with the Building Code of Australia, all Local and State Government Ordinances, relevant Australian Standards, Local Authorities Regulations and all other relevant Authorities concerned.
All structural work and site drainage to be subject to Engineer's details or certification where required by Council. This shall include r.c. slabs and footings, r.c. and steel beams & columns, wind bracing to AS 1170 and AS4055, anchor rods or bolts, tie downs, fixings etc., driveway slabs and drainage to Council's satisfaction. All timbers to be in accordance with SAA Timber Structure Code AS1720 and SAA Timber Framing Code AS 1684. All work to be carried out in a professional and workman- shiplike manner according to the plans and specification.
NOTE:
Do not scale off the drawings unless otherwise stated and use figured dimensions in preference.
All dimensions are to be checked and verified on site before the commencement of any work, all dimensions and levels are subject to final survey and set-out. No responsibility will be accepted by Sitedesign for any variations in design, builder's method of construction or materials used, deviation from specification without permission or accepted work practices resulting in inferior construction. Locate and protect all services prior to construction.
COPYRIGHT CLAUSE
This drawing and design is the property of Sitedesign and should not be reproduced either in part or whole without the written consent of this firm.

**SITEDESIGN
+STUDIOS**
creating places to live in and enjoy

SYDNEY NORTH STUDIO
PO Box 265
SEAFORTH NSW 2092
0417685846
p 1300 22 44 55
info@sdstudios.com.au
www.sdstudios.com.au

Project	PROPOSED SWIMMING POOL		
Address	LOT 10, NO.87 WIMBLEDON AVENUE, NORTH NARRABEEN	Date	19/11/2021
Drawing Title	SITE PLAN	Scale	1:200@A3
Drawing No. 1392			

A	19/11/21	FOR REVIEW
ISSUE	DATE	COMMENT
AMENDMENTS		

Page
L-01





northern
beaches
council

THIS PLAN IS TO BE READ IN
CONJUNCTION WITH
THE CONDITIONS OF DEVELOPMENT
CONSENT

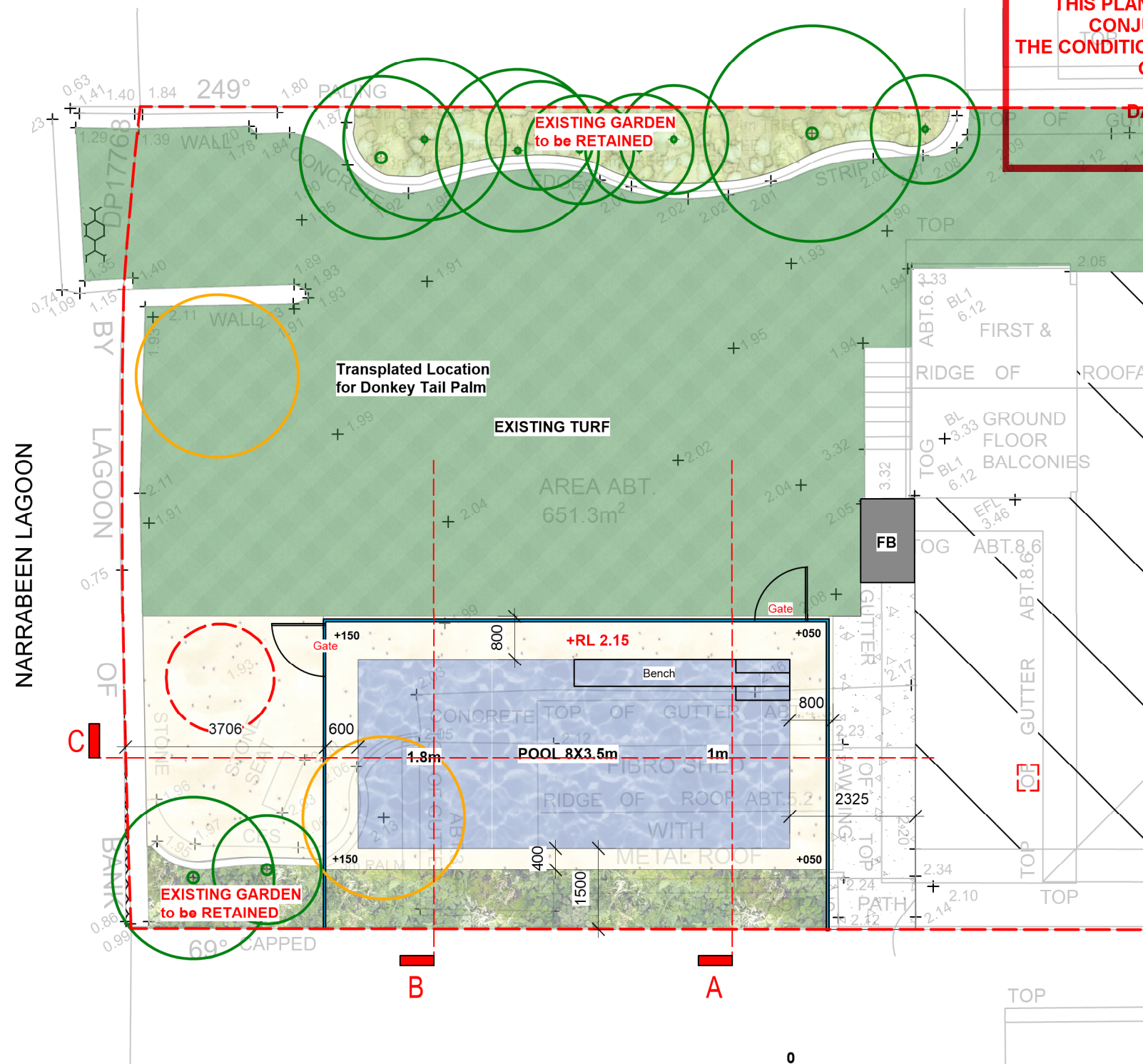

DA2021/2579



EXISTING TREE LEGEND

- EXISTING TREES TO BE RETAINED
- TREES TO BE REMOVED

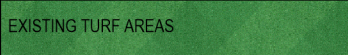
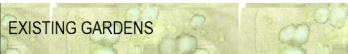
LEGEND

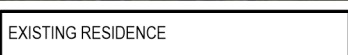
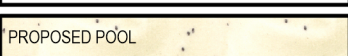
- CONCRETE
- EXISTING TURF AREAS
- EXISTING GARDENS
- DEEP SOIL GARDENS
- EXISTING RESIDENCE
- PROPOSED POOL



A 19/11/21 FOR REVIEW
ISSUE DATE COMMENT
AMENDMENTS

GENERAL NOTES
All work to be carried out in accordance with the Building Code of Australia, all Local and State Government Ordinances, relevant Australian Standards, Local Authorities Regulations and all other relevant Authorities concerned.
All structural work and site drainage to be subject to Engineer's details or certification where required by Council. This shall include r.c. slabs and footings, r.c. and steel beams & columns, wind bracing to AS 1170 and AS4055, anchor rods or bolts, tie downs, fixings etc., driveway slabs and drainage to Council's satisfaction. All timbers to be in accordance with SAA Timber Structure Code AS1720 and SAA Timber Framing Code AS 1684. All work to be carried out in a professional and workman- shiplike manner according to the plans and specification.
NOTE:
Do not scale off the drawings unless otherwise stated and use figured dimensions in preference.
All dimensions are to be checked and verified on site before the commencement of any work, all dimensions and levels are subject to final survey and set-out. No responsibility will be accepted by Sitedesign for any variations in design, builder's method of construction or materials used, deviation from specification without permission or accepted work practices resulting in inferior construction. Locate and protect all services prior to construction.
COPYRIGHT CLAUSE
This drawing and design is the property of Sitedesign and should not be reproduced either in part or whole without the written consent of this firm.

**SITEDESIGN
+STUDIOS**
creating places to live in and enjoy

SYDNEY NORTH STUDIO
PO Box 265
SEAFORTH NSW 2092
0417685846
p 1300 22 44 55
info@sdstudios.com.au
www.sdstudios.com.au

Project	PROPOSED SWIMMING POOL		
Address	LOT 10, NO.87 WIMBLEDON AVENUE, NORTH NARRABEEN	Date	19/11/2021
Drawing Title	POOL PLAN	Scale	1:100@A3
		Drawing No.	1392

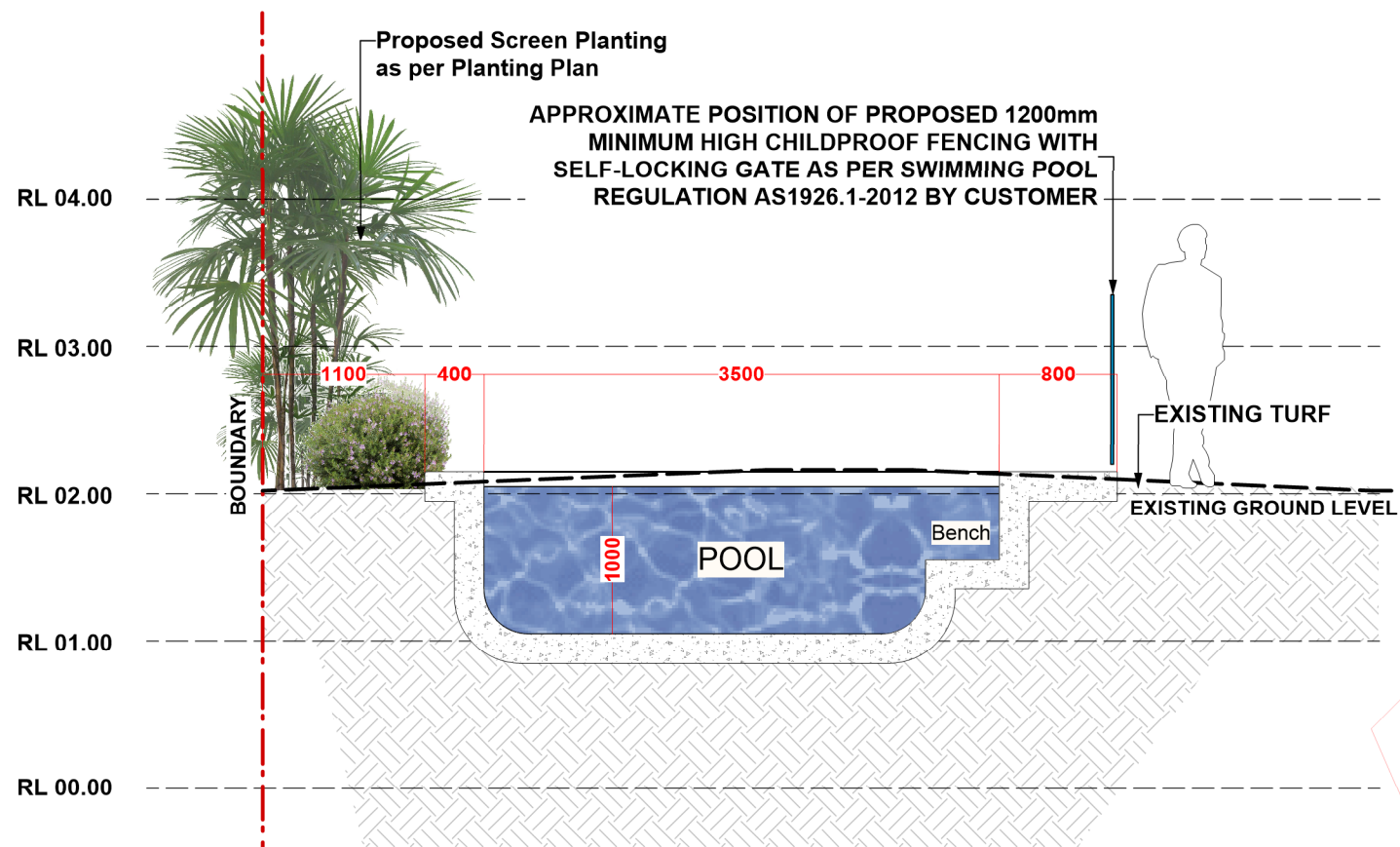

1 SECTION A
Scale: 1:50

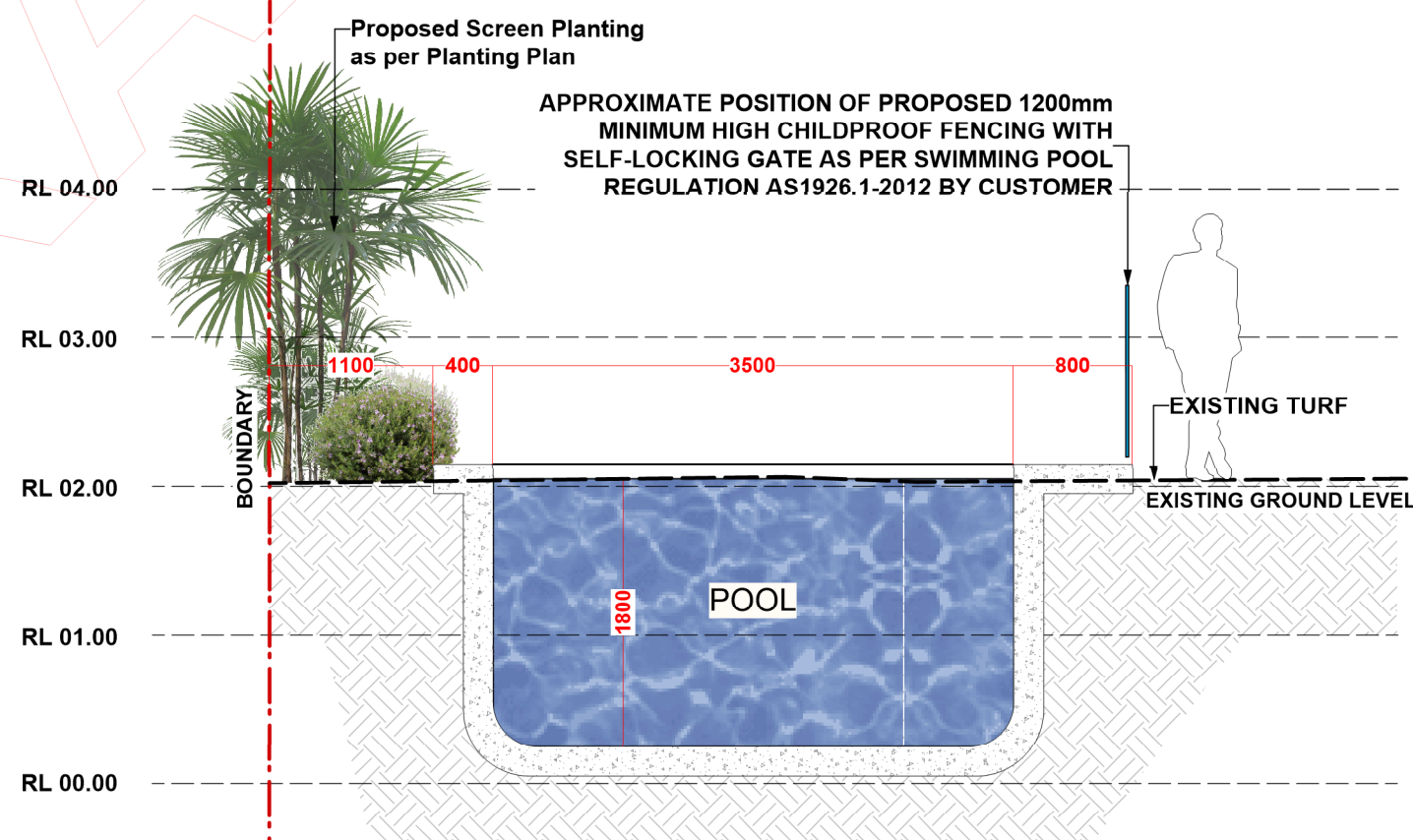

2 SECTION B
Scale: 1:50

northern beaches council

THIS PLAN IS TO BE READ IN CONJUNCTION WITH THE CONDITIONS OF DEVELOPMENT CONSENT

DA2021/2579

GENERAL NOTES
All work to be carried out in accordance with the Building Code of Australia, all Local and State Government Ordinances, relevant Australian Standards, Local Authorities Regulations and all other relevant Authorities concerned.
All structural work and site drainage to be subject to Engineer's details or certification where required by Council. This shall include r.c. slabs and footings, r.c. and steel beams & columns, wind bracing to AS 1170 and AS4055, anchor rods or bolts, tie downs, fixings etc., driveway slabs and drainage to Council's satisfaction. All timbers to be in accordance with SAA Timber Structure Code AS1720 and SAA Timber Framing Code AS 1684. All work to be carried out in a professional and workman- shiplike manner according to the plans and specification.
NOTE:
Do not scale off the drawings unless otherwise stated and use figured dimensions in preference.
All dimensions are to be checked and verified on site before the commencement of any work, all dimensions and levels are subject to final survey and set-out. No responsibility will be accepted by Sitedesign for any variations in design, builder's method of construction or materials used, deviation from specification without permission or accepted work practices resulting in inferior construction. Locate and protect all services prior to construction.
COPYRIGHT CLAUSE
This drawing and design is the property of Sitedesign and should not be reproduced either in part or whole without the written consent of this firm.

SITEDESIGN + STUDIOS
creating places to live in and enjoy

SYDNEY NORTH STUDIO
PO Box 265
SEAFORTH NSW 2092
0417685846
p 1300 22 44 55
info@sdstudios.com.au
www.sdstudios.com.au

Project	PROPOSED SWIMMING POOL		
Address	LOT 10, NO.87 WIMBLEDON AVENUE, NORTH NARRABEEN	Date	19/11/2021
Drawing Title	SECTION A & B	Scale	1:50@A3
		Drawing No.	1392

A	19/11/21	FOR REVIEW
ISSUE	DATE	COMMENT
AMENDMENTS		

Page
L-06



northern
beaches
council

THIS PLAN IS TO BE READ IN
CONJUNCTION WITH
THE CONDITIONS OF DEVELOPMENT
CONSENT

DA2021/2579

The diagram is a cross-section of a swimming pool. On the left, a vertical dashed line marks the 'BOUNDARY'. To its right is an 'EXISTING STONE RETAINING WALL'. Further right is 'EXISTING TURF' and 'EXISTING GROUND LEVEL'. The pool itself is a blue-filled area with a 'WATER LEVEL' line. Dimensions are given in red: 3706 from the boundary to the start of the pool, 600 from the retaining wall to the pool edge, 8000 for the pool length, 800 from the pool edge to the building line, and 1525 from the pool edge to the building line. A person silhouette is shown near the building line. The pool has a depth of 1800 and a width of 1000. Two points are marked 'RL 2.15' at the pool edges. On the right, a vertical line marks the 'BUILDING LINE'. The vertical axis on the left shows levels from RL 00.00 to RL 04.00 in increments of 1.00.

3

SECTION C
Scale: 1:50

GENERAL NOTES
All work to be carried out in accordance with the Building Code of Australia, all Local and State Government Ordinances, relevant Australian Standards, Local Authorities Regulations and all other relevant Authorities concerned.
All structural work and site drainage to be subject to Engineer's details or certification where required by Council. This shall include r.c. slabs and footings, r.c. and steel beams & columns, wind bracing to AS 1170 and AS4055, anchor rods or bolts, tie downs, fixings etc., driveway slabs and drainage to Council's satisfaction. All timbers to be in accordance with SAA Timber Structure Code AS1720 and SAA Timber Framing Code AS 1684. All work to be carried out in a professional and workman- shiplike manner according to the plans and specification.
NOTE:
Do not scale off the drawings unless otherwise stated and use figured dimensions in preference.
All dimensions are to be checked and verified on site before the commencement of any work, all dimensions and levels are subject to final survey and set-out. No responsibility will be accepted by Sitedesign for any variations in design, builder's method of construction or materials used, deviation from specification without permission or accepted work practices resulting in inferior construction. Locate and protect all services prior to construction.
COPYRIGHT CLAUSE
This drawing and design is the property of Sitedesign and should not be reproduced either in part or whole without the written consent of this firm.

SITEDESIGN
+STUDIOS

creating places to live in and enjoy

SYDNEY NORTH STUDIO
PO Box 265
SEAFORTH NSW 2092
0417685846
p 1300 22 44 55
info@sdstudios.com.au
www.sdstudios.com.au

Project	PROPOSED SWIMMING POOL		
Address	LOT 10, NO.87 WIMBLEDON AVENUE, NORTH NARRABEEN	Date	19/11/2021
Drawing Title	SECTION C	Scale	1:50@A3
		Drawing No.	1392

A	19/11/21	FOR REVIEW
ISSUE	DATE	COMMENT
AMENDMENTS		

Page

L-07