

Contact Us	
The General Manager, 725 Pittwater Road, Dee Why NSW 2099 or Customer Service Centre, Northern Beaches Council DX9118 Dee Why	
Email	council@warringah.nsw.gov.au
Fax	9942 2606
If you need help lodging your application call Customer Service on (02) 9942 2111 or come in and talk to us at the Civic Centre, Dee Why.	

Office Use Only									

Part 1: Declaration

1. DECLARATION	
I hereby certify that the shadow diagrams submitted with the proposal at	
Address	12 CRESCENT STREET FAIRLIGHT 2094
For the erection of Description of development	ALTERATIONS & FIRST FLOOR ADDITION
<ul style="list-style-type: none"> In accordance with the survey (prepared by a registered surveyor) which is required to be submitted with the application Drawn to true north Indicate shadow cast by the proposal at 9am, noon, 3pm, 21 June To indicate the shadow cast by existing buildings and structures on the site and in the surrounding area 	

Part 2: Certification

2. CERTIFIER			
Title	<input checked="" type="radio"/> Mr <input type="radio"/> Mrs <input type="radio"/> Ms <input type="radio"/> Other		
Full family name (no initials) (or Company)	HARVEY		
Full given names (no initials) (or A.C.N)	NEIL		
Phone		Alternate	
Mobile	0403 505 322	Fax	
Qualification (i.e. Architect, Planner, Computer Technician, Surveyor)	ARCHITECT B.Arch		

Part 3: Signature

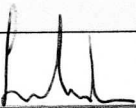
3. APPLICANT(S) SIGNATURE	
Signature	
Date	09.08.19

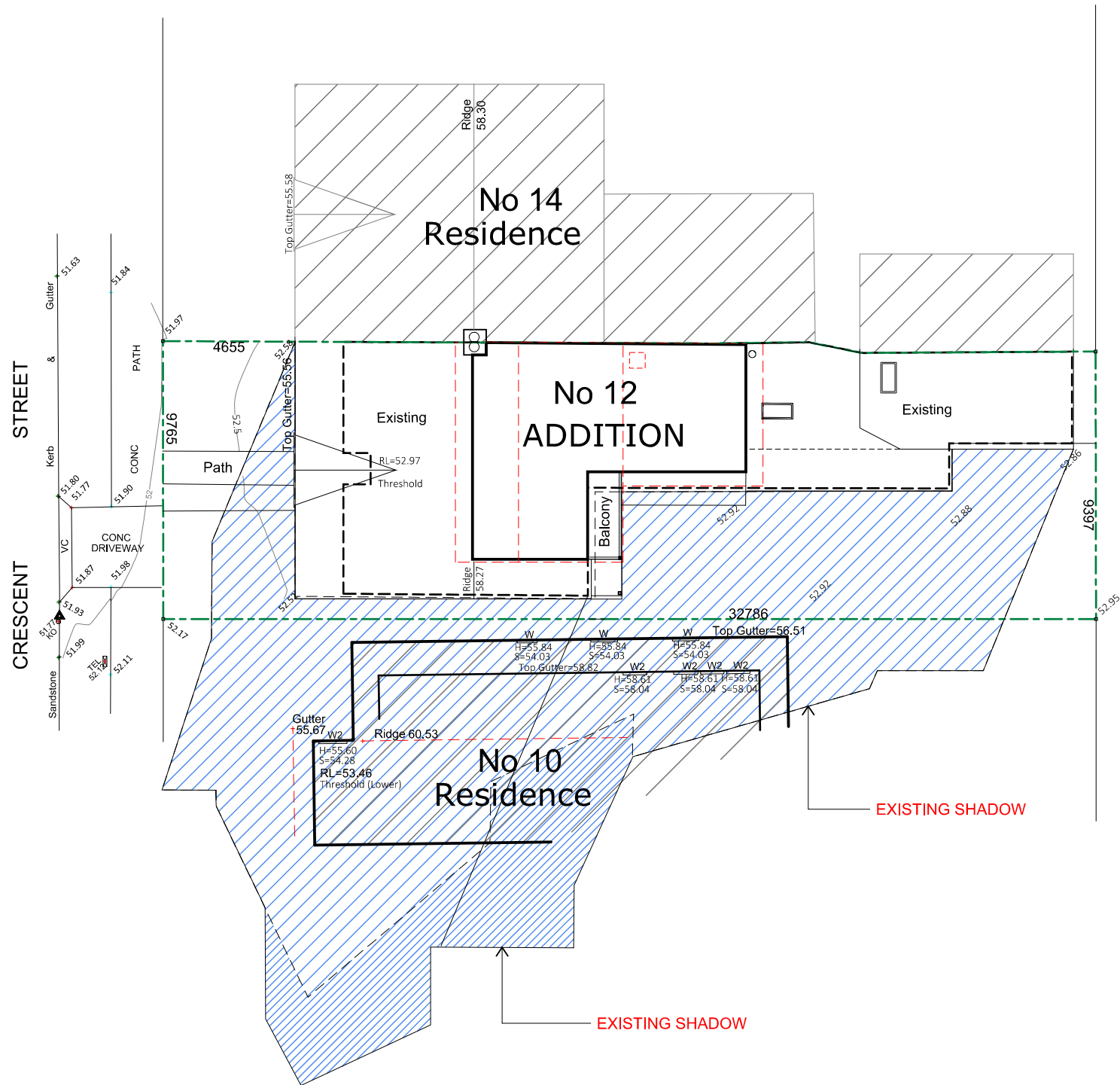

9am June 21

Note:
Shadows were cast to true north at the winter solstice.
The shadows projected at 9am from the proposed first floor addition, provide an additional shadow to one ground floor window at No 10 -leaving one clear.
Generally minimal overshadowing to the neighbouring residence.

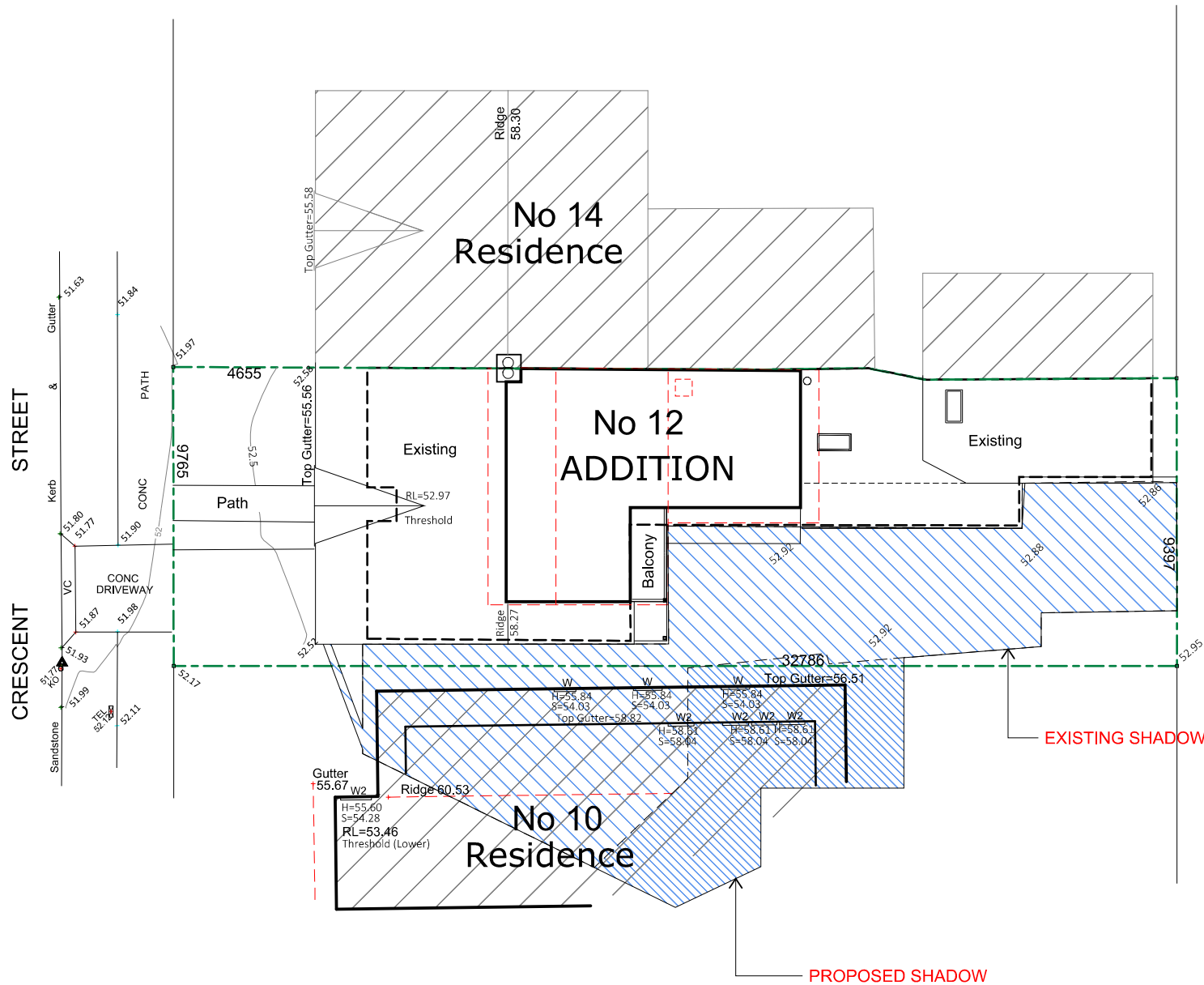

12noon June 21

Note:
Shadows were cast to true north at the winter solstice.
The shadows projected at 12pm from the proposed first floor addition, provide an additional shadow to one ground floor window at No 10. Generally minimal overshadowing to the neighbouring residence.

DATE	Amdt.
Neil Harvey - B.Arch 14 Farrer Place, Frenchs Forest NSW 2086	
Ph: 0403 505 322 Email: nharvey@bigpond.com	

Alterations & Additions
Mr & Mrs S.Holmes
12 Crescent Street, Fairlight NSW 2094

SHADOWS 1

SCALE:	1:200
DRAWN:	JOB No: 2040
DATE: 9 August 2019	LOT REF: Lot 1 DP 815149
DWG SIZE: A3	SHEET: DA-SH-1

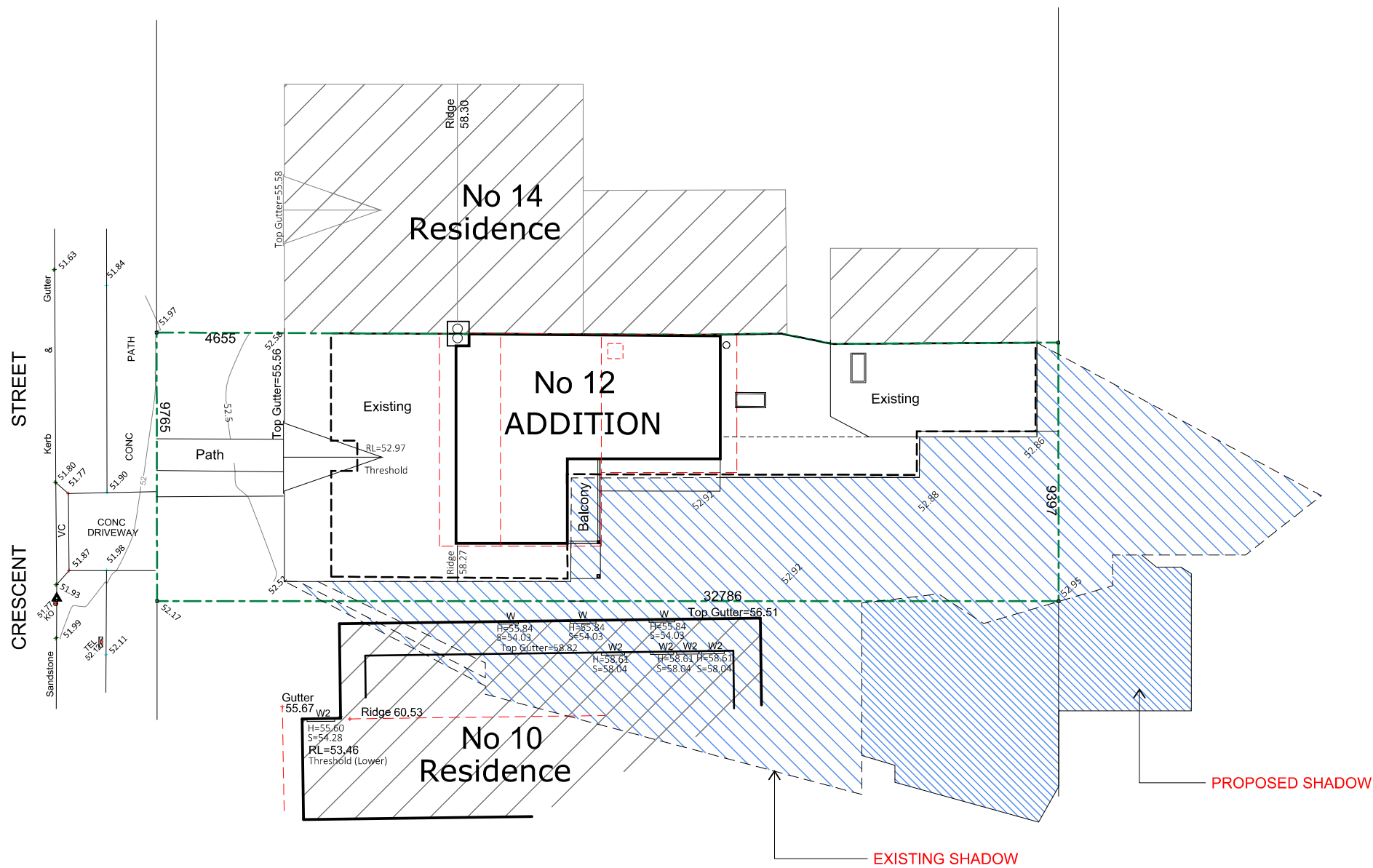

3pm June 21



Note:
Shadows were cast to true north at the winter solstice.
The shadows projected from the proposed first floor
addition provide no additional overshadowing to the
ground floor windows to residence at No 10.

DATE	Amdt.
Neil Harvey - B.Arch 14 Farrer Place, Frenchs Forest NSW 2086	
Ph: 0403 505 322 Email: nfh Harvey@bigpond.com	

Alterations & Additions
Mr & Mrs S.Holmes
12 Crescent Street, Fairlight NSW 2094

SHADOWS 2

SCALE:	1:200
DRAWN:	JOB No: 2040
DATE: 9 August 2019	LOT REF: Lot 1 DP 815149
DWG SIZE: A3	SHEET: DA-SH-2