

---

**Sent:** 15/04/2024 8:17:59 AM  
**Subject:** DA2023/832 Objections  
**Attachments:** Leplatrier 15-04-24.pdf;

Please find attached the result of further investigation into the proposed position of the EMA on Lot 5.  
Thank you for your time.  
Robert Story and Susan Duncan Story

OBJECTIONS TO DA AMENDMENT 12-04-24

From Robert Story and Susan Duncan Story

- 1) The EMA is located between 2 existing sandstone walls. This fixes position.
- 2) There is an existing surveyor's peg on the property boundary of Lot 3 and Lot 5.
- 3) Site measurements were taken as depicted on DRG 1.3 and location of section on DRG 1.1. See below.
- 4) The setback of the EMA to Lot 3 is 4.84 metres and not the 6.2 metres as indicated by Broadcrest.
- 5) The EMA is a pressurized system so any pipe breakage would result in effluent flowing down to Lot 3.
- 6) There is an underlying clay layer in the area so effluent would reach this layer and permeate to Lot 3.

CONCLUSION:

From this investigation, the EMA as depicted on Broadcrest's report cannot be located in this position. If it is approved in this position, there will be no choice but to take further action.

See drawings attached below.

DRG-1.1 15-04-24  
LEPLASTRIER HOUSE  
GENERAL PLAN

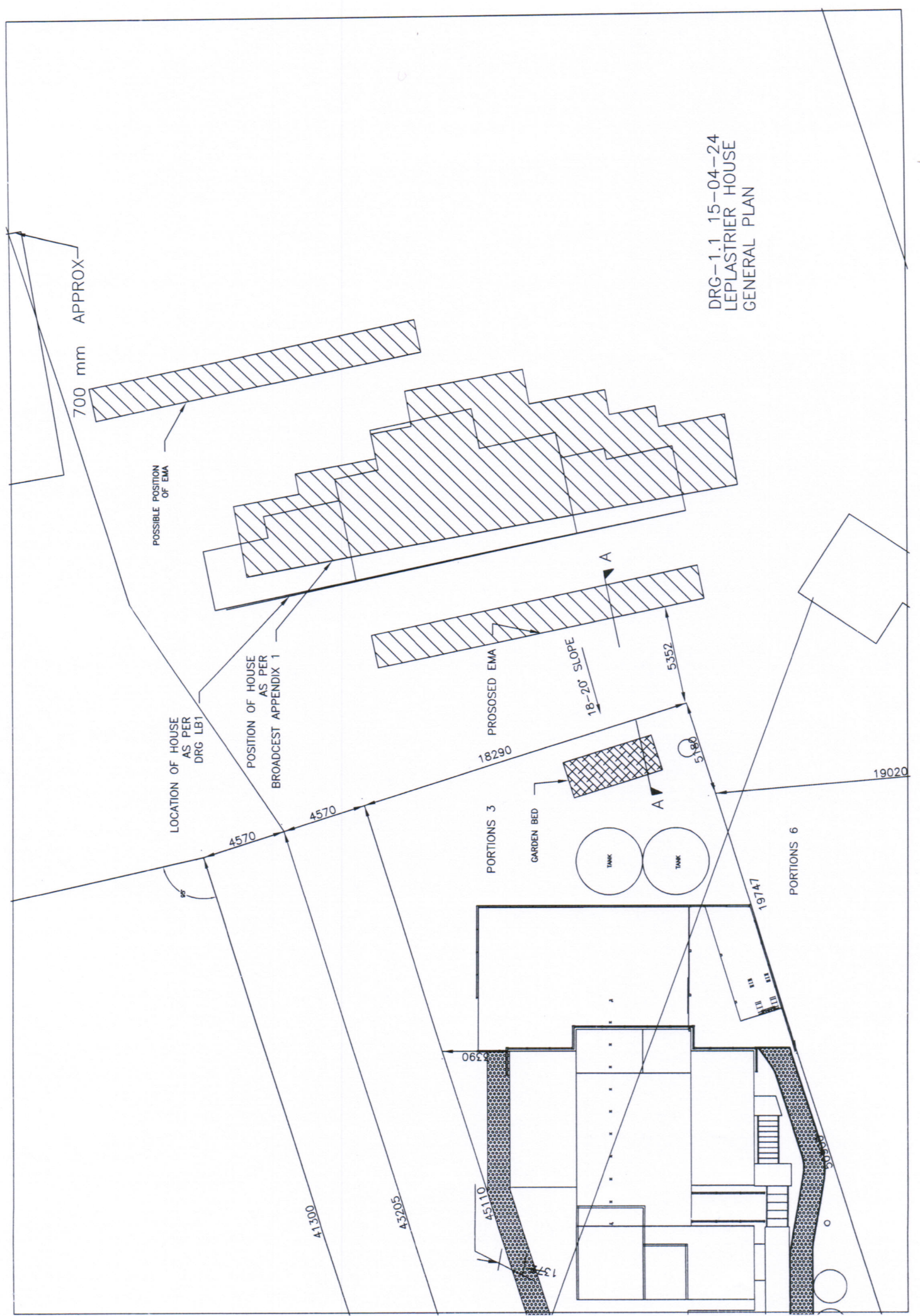

700 mm APPROX

POSSIBLE POSITION OF EMA

LOCATION OF HOUSE AS PER DRG LB1

POSITION OF HOUSE AS PER BROADCAST APPENDIX 1

PORTIONS 3

GARDEN BED

TANK

TANK

1370

45110

18290

18-20° SLOPE

5352

5180

19747

PORTIONS 6

19020

30300

41300

43205

4570

4570

28°

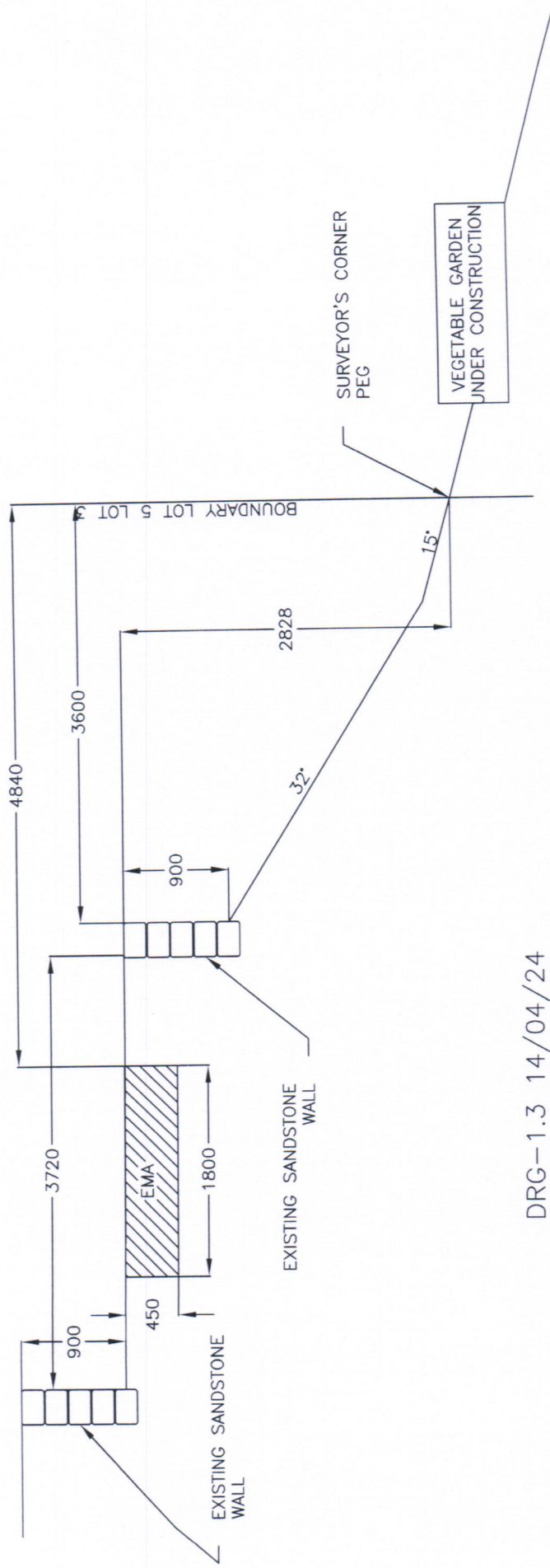

DRG-1.3 14/04/24  
 LEPLASTRIER HOUSE  
 SITE MEASUREMENTS EMA TO BOUNDARY  
 SECTION AA DRG-1.1