

1 WINTER 9AM
1 : 400

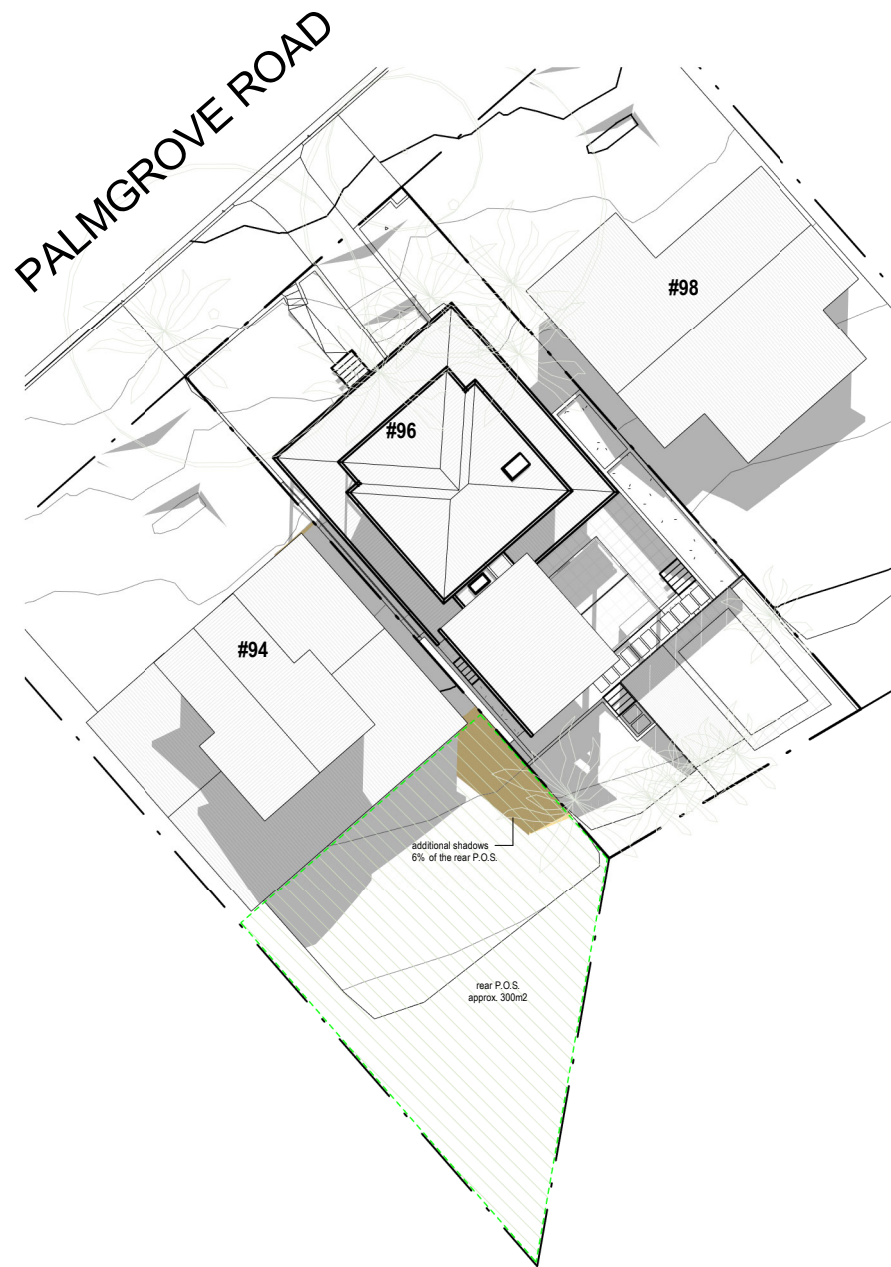

2 WINTER 12PM
1 : 400

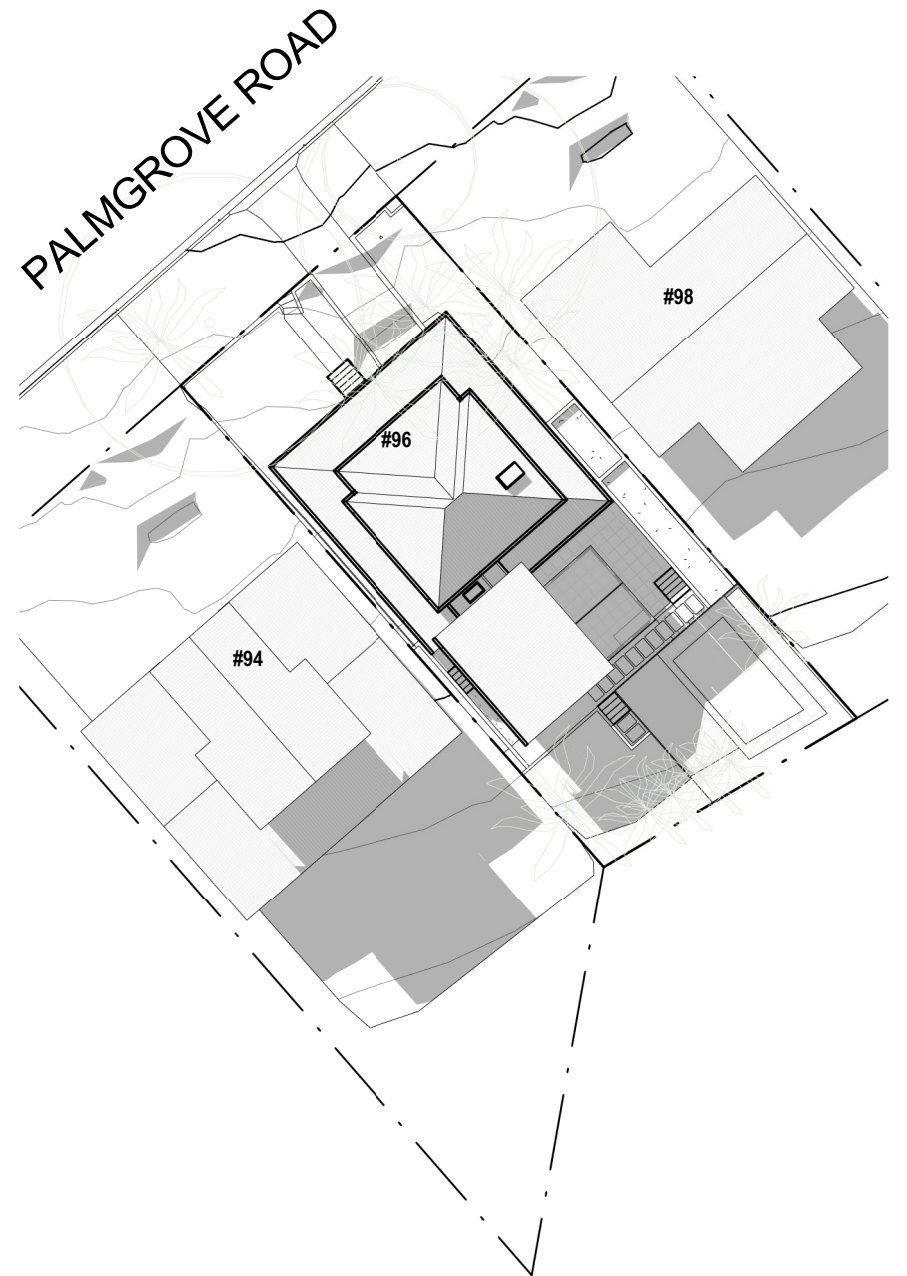

3 WINTER 3PM
1 : 400

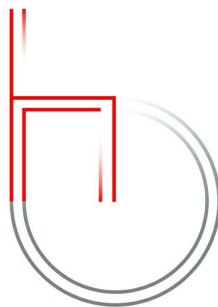

m: 0433 775 490
p.o. box 26 newport nsw 2106
info@hthousestudio.com
abn: 355 0579 1074

Nominated Architect: Wade Stewart Cogle
NSW ARB Registration # 10971

Hot House Studio

NOTES:	PRINT DATE: 18/08/2020 9:45:50 AM	PRINT SIZE: A3
	Builder is to examine the site and verify conditions and dimensions. Any discrepancies must be brought to the architect's attention. Use figured dimensions only. Do not scale drawings. All work shall comply with the Building Code of Australia and relevant Australian standards.	
	This drawing is copyright and remains the property of Hot House Studio HOT HOUSE PROJECTS PTY LTD TA& HOT HOUSE STUDIO	

ISSUE	DESCRIPTION	DATE
A	Development Application	14-08-20

CLIENT:	J. Kennedy & J. Horn	SHADOW DIAGRAMS		
PROJECT:	Alterations & Additions	PROJECT NO.	200520	DA800
ADDRESS:	96 PALMGROVE ROAD, AVALON BEACH	DATE	14-08-20	
		LOT:	432	
		DP:	16902	SCALE: 1 : 400
		DRAWN BY:	ms	
		CHECKED BY:	wc	