

NO.	DESCRIPTION	DATE	NOTES	MICHAEL KING DESIGN m: 0407 975 335 e: king.m@bigpond.com	PROJECT PROPOSED SECONDARY DWELLING AT 61 DOLPHIN CRESCENT AVALON BEACH NSW 2107 for MR & MRS M.DENIT	JOB NUMBER SCALE ON A3 1:200 DATE 17-12-15	DRAWG. NUMBER DA-01
			- DRAWINGS MADE TO A LARGER SCALE AND WORKS SHALL BE PRESENTED OVER A LARGER SCALE FOR THE PUBLIC TO VIEW - USE FIGURED DIMENSION IN PREFERENCE TO SCALED DIMENSIONS TO BE CHECKED AND VERIFIED ON SITE - BEFORE CARRYING OUT ANY WORK ENSURE LATEST AMENDMENT NO.10 CARRY THE				
			- CONSENT DOCUMENTS AND ANY WORKS EXECUTED AS A RESULT OF THESE DOCUMENTS SHALL BE THE PROPERTY OF THE DESIGNER AND NOT BE REPRODUCED OR USED IN ANY MANNER WITHOUT THE WRITTEN CONSENT OF THE DESIGNER - THE DESIGNER SHALL NOT BE RESPONSIBLE FOR THE CONSTRUCTION OF THE WORKS OR THE CONDITION OF THE WORKS AFTER THE COMMENCEMENT OF THE WORKS				

SITE AND ROOF PLAN

DOLPHIN CRESCENT

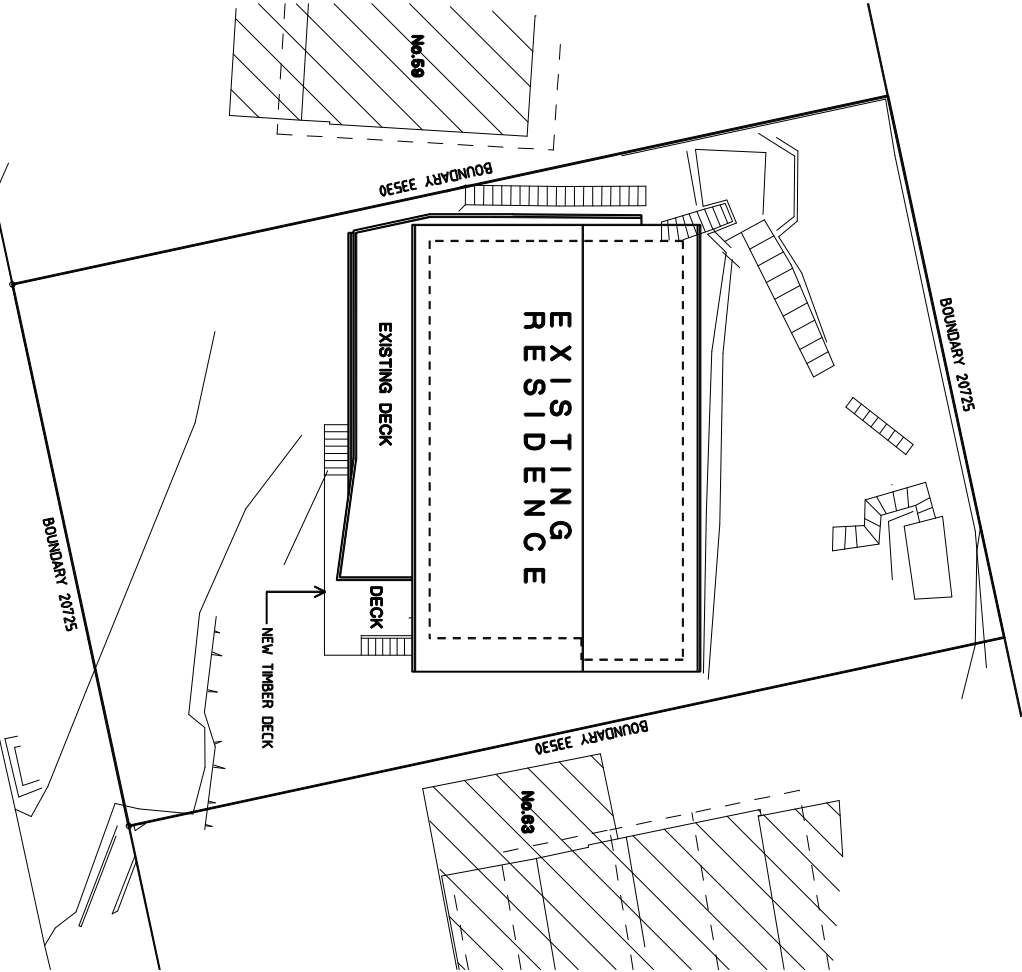

BASIC NOTES:
THE APPLICANT MUST PLANT INDIGENOUS OR LOW WATER USE SPECIES OF VEGETATION THROUGHOUT 10 SQUARE METRES OF THE SITE.
THE APPLICANT MUST UNSTALL THE FOLLOWING HOT WATER SYSTEM IN THE DEVELOPMENT, OR A SYSTEM WITH A HIGHER ENERGY RATING, DURING THE CONSTRUCTION OF THE DEVELOPMENT WITH A PERFORMANCE OF 5 STARS.