

CONVERSION TABLE ADDED BY REGISTRAR GENERAL'S DEPARTMENT
STRATA PLAN 1754

FEET INCHES	METRES
1 0	0.305
1 6	0.488
2 0	0.610
2 6	0.793
3 0	0.914
3 6	1.097
4 0	1.220
4 6	1.403
5 0	1.524
5 6	1.707
6 0	1.829
6 6	2.012
7 0	2.134
7 6	2.317
8 0	2.438
8 6	2.621
9 0	2.743
9 6	2.926
10 0	3.048
10 6	3.231
11 0	3.353
11 6	3.536
12 0	3.658
12 6	3.841
13 0	3.963
13 6	4.146
14 0	4.268
14 6	4.451
15 0	4.573
15 6	4.756
16 0	4.878
16 6	5.061
17 0	5.183
17 6	5.366
18 0	5.488
18 6	5.671
19 0	5.793
19 6	5.976
20 0	6.098
20 6	6.281
21 0	6.403
21 6	6.586
22 0	6.708
22 6	6.891
23 0	7.013
23 6	7.196
24 0	7.318
24 6	7.501
25 0	7.623
25 6	7.806
26 0	7.928
26 6	8.111
27 0	8.233
27 6	8.416
28 0	8.538
28 6	8.721
29 0	8.843
29 6	9.026
30 0	9.148
30 6	9.331
31 0	9.453
31 6	9.636
32 0	9.758
32 6	9.941
33 0	10.063
33 6	10.246
34 0	10.368
34 6	10.551
35 0	10.673
35 6	10.856
36 0	10.978
36 6	11.161
37 0	11.283
37 6	11.466
38 0	11.588
38 6	11.771
39 0	11.893
39 6	12.076
40 0	12.198
40 6	12.381
41 0	12.503
41 6	12.686
42 0	12.808
42 6	12.991
43 0	13.113
43 6	13.296
44 0	13.418
44 6	13.601
45 0	13.723
45 6	13.906
46 0	14.028
46 6	14.211
47 0	14.333
47 6	14.516
48 0	14.638
48 6	14.821
49 0	14.943
49 6	15.126
50 0	15.248
50 6	15.431
51 0	15.553
51 6	15.736
52 0	15.858
52 6	16.041
53 0	16.163
53 6	16.346
54 0	16.468
54 6	16.671
55 0	16.793
55 6	16.996
56 0	17.118
56 6	17.321
57 0	17.443
57 6	17.646
58 0	17.768
58 6	17.971
59 0	18.093
59 6	18.296
60 0	18.418
60 6	18.621
61 0	18.743
61 6	18.946
62 0	19.068
62 6	19.271
63 0	19.393
63 6	19.596
64 0	19.718
64 6	19.921
65 0	20.043
65 6	20.246
66 0	20.368
66 6	20.571
67 0	20.693
67 6	20.896
68 0	21.018
68 6	21.221
69 0	21.343
69 6	21.546
70 0	21.668
70 6	21.871
71 0	21.993
71 6	22.196
72 0	22.318
72 6	22.521
73 0	22.643
73 6	22.846
74 0	22.968
74 6	23.161
75 0	23.283
75 6	23.486
76 0	23.608
76 6	23.811
77 0	23.933
77 6	24.136
78 0	24.258
78 6	24.461
79 0	24.583
79 6	24.786
80 0	24.908
80 6	25.121
81 0	25.243
81 6	25.446
82 0	25.568
82 6	25.771
83 0	25.893
83 6	26.196
84 0	26.318
84 6	26.521
85 0	26.643
85 6	26.846
86 0	26.968
86 6	27.161
87 0	27.283
87 6	27.486
88 0	27.608
88 6	27.811
89 0	27.933
89 6	28.136
90 0	28.258
90 6	28.461
91 0	28.583
91 6	28.786
92 0	28.908
92 6	29.111
93 0	29.233
93 6	29.436
94 0	29.558
94 6	29.761
95 0	29.883
95 6	30.086
96 0	30.208
96 6	30.521
97 0	30.643
97 6	30.846
98 0	30.968
98 6	31.171
99 0	31.293
99 6	31.596
100 0	31.718
100 6	32.041

Final existing whole Lot 64 Sec. A D.P. 6195. STRATA PLAN 1754

Reference to this Vol. 2820 Pt. 115
 Municipality Warringham
 Locality Mona Vale
 Parish Narrabeen County Cumberland
 Scale 50 Ft. to an inch.

Registered 23.10.65
 C.A. 12/65 of 11-13-1965
 Ref Map: 776(L)
 Last Plan: D.P. 6195

Appn. 10630 Pt. 700ac (Pt. 17 Ph.) gtd. to Robert Campbell on 31st August, 1819 of Vol. 2820 Pt. 115

Schedule of Unit Entitlements		OFFICE USE ONLY		LEONARD HALL FRANK & MOORE 147 MACQUARIE ST. SYDNEY. A former registered under the Strata Act, 1928, as Leonard, Henry Realty Co.
Lot No.	Unit Entitlement	Vol.	Fol.	
				(1) The building erected on the parcel situated above is erected for the general purposes of the parcel and is used as an office (2) of the premises. (2) The building erected on the parcel situated above is erected for the general purposes of the parcel and is used as an office (2) of the premises. (3) The building erected on the parcel situated above is erected for the general purposes of the parcel and is used as an office (2) of the premises. (4) The building erected on the parcel situated above is erected for the general purposes of the parcel and is used as an office (2) of the premises. (5) The building erected on the parcel situated above is erected for the general purposes of the parcel and is used as an office (2) of the premises. (6) The building erected on the parcel situated above is erected for the general purposes of the parcel and is used as an office (2) of the premises. (7) The building erected on the parcel situated above is erected for the general purposes of the parcel and is used as an office (2) of the premises. (8) The building erected on the parcel situated above is erected for the general purposes of the parcel and is used as an office (2) of the premises. (9) The building erected on the parcel situated above is erected for the general purposes of the parcel and is used as an office (2) of the premises. (10) The building erected on the parcel situated above is erected for the general purposes of the parcel and is used as an office (2) of the premises.
AGGREGATE				Dated 12.10.1965 Signature <i>[Signature]</i> Approved by the Council for the purposes of the Corporation Ordinance 1965. Date 12.10.1965 Johnstone M. <i>[Signature]</i> Council Clerk

The address for service of notices on the body corporate is—
 The proprietor of Strata Plan No. 1754
 115 Surfview Rd. Mona Vale.

Surveyor's Reference: 7513

STRATA PLAN No. 1754
 First Floor
 Scale 20 Ft. to an inch.

The balconies of Lots 1-7 inclusive are covered.
 Areas are in square feet shown in, and include balconies.

Council Clerk *[Signature]*

AMENDMENTS AND/OR ADDITIONS NOTED ON PLAN IN REGISTRAR GENERAL'S OFFICE.

This negative is a photograph made as a permanent record of a document in the custody of the Registrar General this day. 2nd April, 1989

[Stamp]

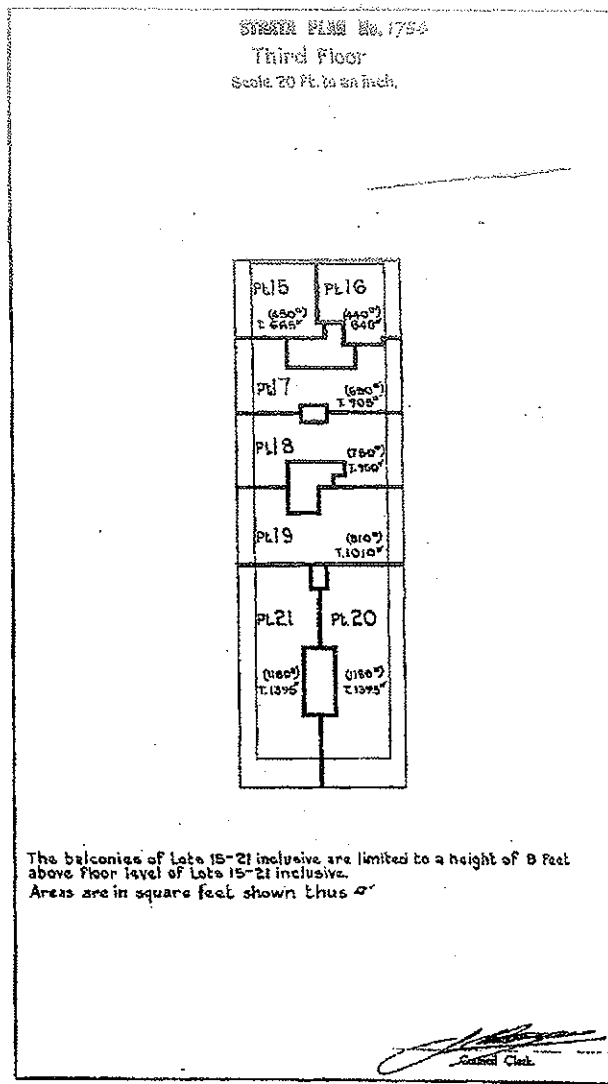
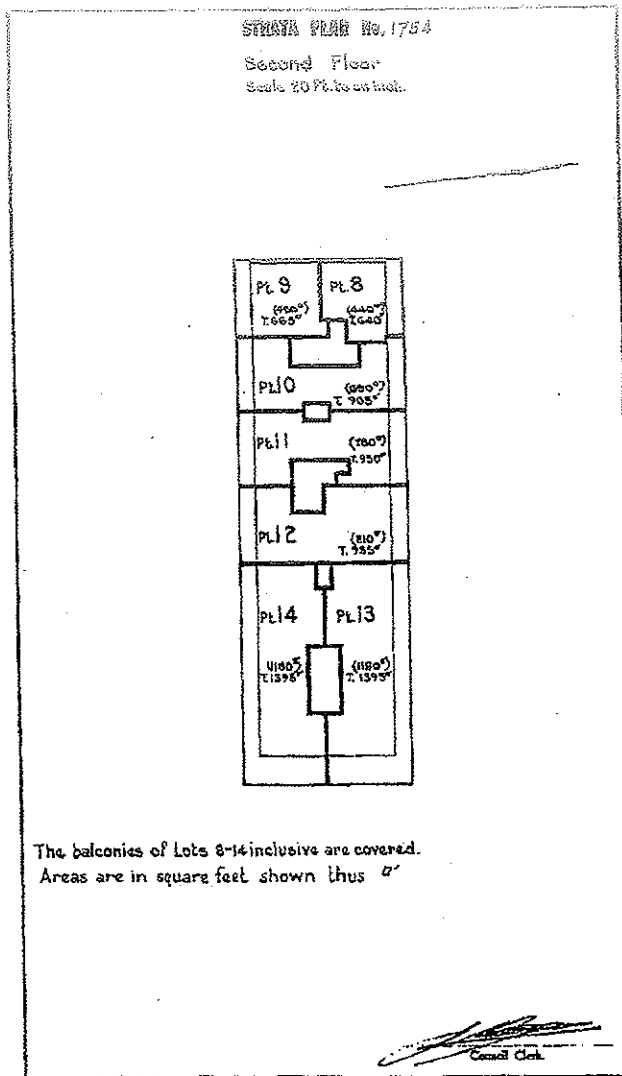

AMENDMENTS AND/OR ADDITIONS NOTED ON
PLAN IN REGISTRAR GENERAL'S OFFICE.

This negative is a photograph made as a permanent
record of a document in the custody of the
Registrar General this day, 2nd April, 1985.



2

17-57
 19 Surfview Rd Merrivale - B.P.

SHEET No. 2 OF 2 SHEETS

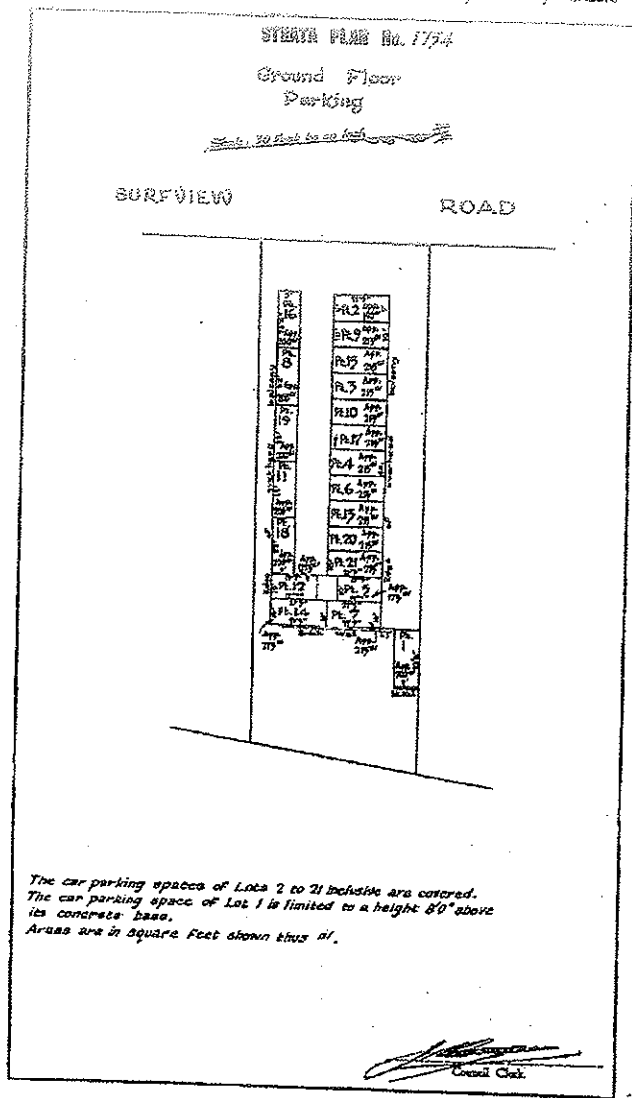

The car parking spaces of Lots 2 to 21 inclusive are colored.
 The car parking space of Lot 1 is limited to a height 80' above
 its concrete base.
 Areas are in square feet shown thus \square .

SHEET No. 1 OF 2 SHEETS

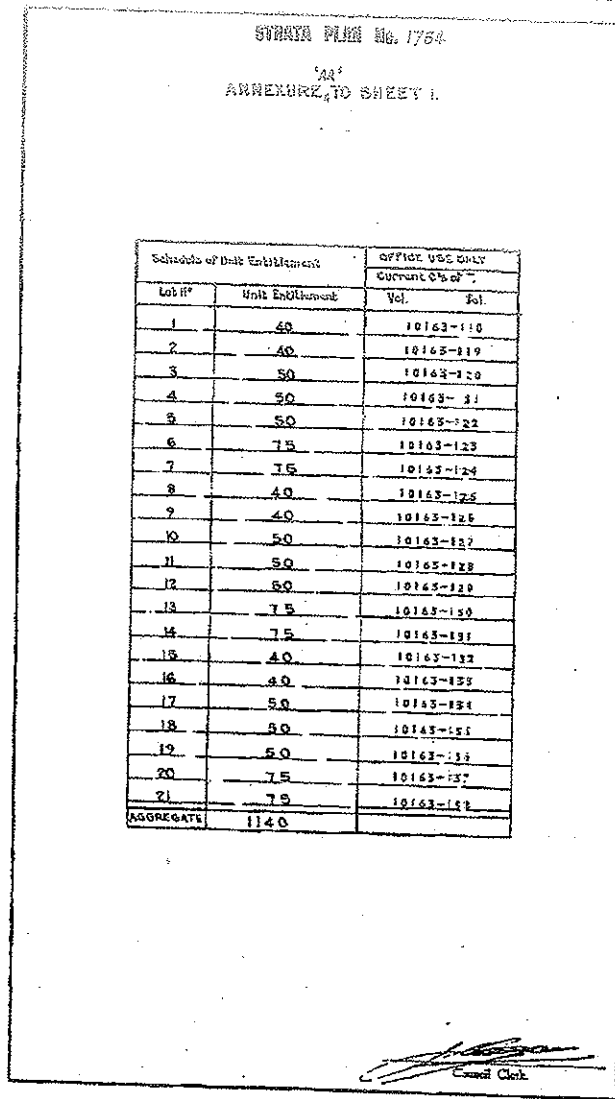

AMENDMENTS AND/OR ADDITIONS NOTED ON
 PLAN IN REGISTRAR GENERAL'S OFFICE.

This negative is a photograph made as a permanent
 record of a document in the custody of the
 Registrar General this day, 2nd April, 1965



3