

ACCREDITED

AFFORDABLE

ASSURANCE

# AAA TRAFFIC — CONTROL —

## Traffic Management Plan



Transport  
for NSW

JAS-ANZ



[WWW.JAS-ANZ.ORG/REGISTER](http://WWW.JAS-ANZ.ORG/REGISTER)



(creditor)watch  
member

**AAA Traffic Control Pty Ltd**

ABN 53 648 829 994

10 Coventry Pl, Mount Druitt NSW 2770

(02) 9675 7731

[info@aaatrafficcontrol.com.au](mailto:info@aaatrafficcontrol.com.au)

# Traffic Management Plan

## Site Location:

949 Barrenjoey Rd, Palm Beach

## Client:

Cre8ive Building Projects

## Document Number:

11905

## RMS Prepare a Work Zone Traffic Management Plan

## Certificate#:

TCT1028313

## Date:

09/10/2023

## Prepared by:

Tyrone Pritchard



ABN 53 648 829 994

Ph. 02 9675 7731 | f 02 9675 7744

E. [info@aaatraficcontrol.com.au](mailto:info@aaatraficcontrol.com.au) | w [www.aaatraficcontrol.com.au](http://www.aaatraficcontrol.com.au)

A. 10 Coventry Place | Mount Druitt NSW 2770

Po. PO Box 1113 | St Marys NSW 1790

**ACCREDITED**  
**AFFORDABLE**  
**ASSURANCE**

ACCREDITED BY:



Transport  
for NSW



# Table of Contents

---

<b>1. Introduction</b>	<b>3</b>
1.1 Site Description	3
1.2 Road(s) Conditions	4
1.3 Major Features of the Area	4
1.4 Public Transport Facilities	4
<b>2. Project Details</b>	<b>5</b>
2.1 Project Summary	5
2.2 Revisions	5
<b>3. Proposed Traffic Management</b>	<b>6</b>
3.1 General	6
A. Site Vehicles	6
B. Road Occupancy	6
C. Parking for Site Workers	6
D. Surrounding Roads	6
3.2 Construction Vehicle Routes	7
A. Vehicle Entry / Exit Routes	7
B. Vehicle Entry / Exit Routes Map	8
3.3 Loading/Unloading Vehicles	8
3.4 Pedestrian Management	8
<b>4. Project Impact and Conclusion</b>	<b>9</b>
4.1 Residents / Surrounding Property Owners	9
4.2 Pedestrians & Cyclists	9
4.3 Emergency Services	9
4.4 Local Traffic	9
4.5 Public Transport	9
4.6 Impact on Community & Businesses	9
<b>5. Appendix A – TCPs</b>	<b>10</b>
<b>6. Appendix B – Drivers Code of Conduct</b>	<b>11</b>

# 1. Introduction

---

AAA Traffic Control Pty Ltd has been engaged by Cre8tive Building Projects to design and implement a Traffic Management Plan at the subject site. This document is prepared to provide a safe work procedure regarding local traffic, pedestrian and neighbouring residents or business which might be affected by this project.

## 1.1 Site Description

The site Location is 949 Barrenjoey Rd, Palm Beach. The site is located within the jurisdiction of the Northern Beaches Council and the Mona Vale Police Area Command.



## 1.2 Road(s) Conditions

Barrenjoey Rd is a local road with 2 lanes (1 in each direction) with limited parking available within the kerb lanes on either side of the road. It is to be advised that work vehicles park within the site or the kerb lane of Barrenjoey Rd if possible.

## 1.3 Major Features of the Area

The site location is surrounded by residential areas as well as businesses around the area. Delivery and work vehicles are to follow the guidelines in this document to minimise the impact on local communities and the required permits are to be obtained from all involved authorities for use of anything relating to the site.

## 1.4 Public Transport Facilities

Public transport will not be affected by the works. Delivery trucks are to be scheduled to minimise traffic throughout Barrenjoey Rd and the roads surrounding the area.



## 2. Project Details

### 2.1 Project Summary

**Project:** Property Upgrades

**Hours of Operations:**

Monday – Friday: 7:00 am – 5:00 pm

Saturday: 8:00 am – 1:00 pm

Sunday: No Works

**Scope of works:** Cre8tive Building Projects will be undertaking property upgrades at the subject site including relocation of previously approved carport, formalisation of front pedestrian and vehicular entry gate, modification to existing driveway, modification of the entry stairs etc.

### 2.2 Revisions

Rev	Date	Description
0	10.10.2023	Initial Submission
1		
2		

## 3. Proposed Traffic Management

### 3.1 General

#### A. Site Vehicles

- Site vehicles are to enter and exit the site area in a forward-facing direction.
- All drivers will be made aware of the approved routes prior to commencing work at the site as part of the site induction. All reverse movements to be supervised by traffic controllers.
- Vehicles will be scheduled in such a manner as to not require queuing on the road network surrounding the site. Drivers to follow the drivers code of conduct.

#### B. Road Occupancy

- Approval from Transport NSW is required for these works.
- All Traffic Guidance Schemes (TGS) associated within this TMP will comply with relevant Australian Standards and Transport for NSW Traffic Control at Worksites Manual

#### C. Parking for site workers

- Site workers and contractors are strictly advised to park within the property or within the kerb lane of Barrenjoey Rd if parking is available.

#### D. Surrounding Roads

- Site vehicles are to use approved routes only for access to and from the site
- Construction traffic to be scheduled where possible outside of peak times to minimise impact to existing traffic increases.
- All vehicular movements associated with this work to avoid school hours.

## 3.2 Construction Vehicle Routes

Access to/from the site will take place at one location, this will be via Barrenjoey Rd.

Vehicles will approach site using state/regional roads unless otherwise stated in this document.

### A. Vehicle Entry / Exit Routes

Barrenjoey Rd is the closest state/regional road to site. The site location is on the south side of Barrenjoey Rd.

#### **Entry Routes**

Vehicles traveling on Barrenjoey Rd are to follow the road and either turn left (if travelling west bound) or right (if travelling east bound) once reaching the site.

#### **Exit Route**

From Site, vehicles are to either turn left (if travelling west bound) or right (if travelling east bound) out of the site, and the proceed to follow Barrenjoey Rd.







### 3.3 Loading/Unloading Vehicles

- All vehicle loading / unloading to be contained within site.

### 3.4 Pedestrian Management

- The Site is located in a residential area with moderate high pedestrian traffic.
- Traffic controllers will be in place to conduct pedestrian management if necessary.
- Pedestrian access to be maintained throughout the works.



## 4. Project Impact and Conclusion

### 4.1 Residents / Surrounding Property Owners.

- There are residents / property owners / businesses within the vicinity of site.
- Notification letters to be distributed prior to the works.

### 4.2 Pedestrian & Cyclists

- Existing Pedestrian and Cyclist's access through the site are to be maintained throughout the works. Pedestrian and cyclist's access to be maintained via onsite traffic controllers managing activity were required.

### 4.3 Emergency Services

- Access along Barrenjoey Rd, and all the surrounding roads will be maintained throughout the works. Priority will be given to emergency vehicles as per normal procedure.

### 4.4 Local Traffic

- Access on Barrenjoey Rd and the surrounding roads around the area will not be severely affected by the works. Site vehicles are to exit/enter site using normally occurring gaps in traffic to reduce impact to traffic flows.
- Construction traffic to be scheduled outside peak traffic times such as school zone hours. This is done in order to minimise impact to existing traffic increases.
- Traffic controllers to manage traffic during all stages of the works if traffic is affected.

### 4.5 Public Transport

- There will be no impact on public transport as there is no bus stops located within the road. Bus Approval is not needed for these works

### 4.6 Impact on Community & Businesses

- There will be a minimal impact to the community and businesses due to the works. All the control measures listed in this document is to ensure that there is no major impact.



# Appendix A – Traffic Control Plan

## TP1165

### Legend

- TRUCK ENTRY ROUTE
- TRUCK EXIT ROUTE
- TRUCK REVERSE ROUTE

PLEASE NOTE:



SIGN LOCATIONS MAY DIFFER TO WHAT IS REPRESENTED ON THE TRAFFIC GUIDANCE SCHEME. THIS MAY BE DUE TO BUS STOPS, DRIVEWAYS AND OTHER VARIOUS PERMANENT FIXTURES.

TRAFFIC CONTROLLERS TO MANAGE PEDESTRIANS

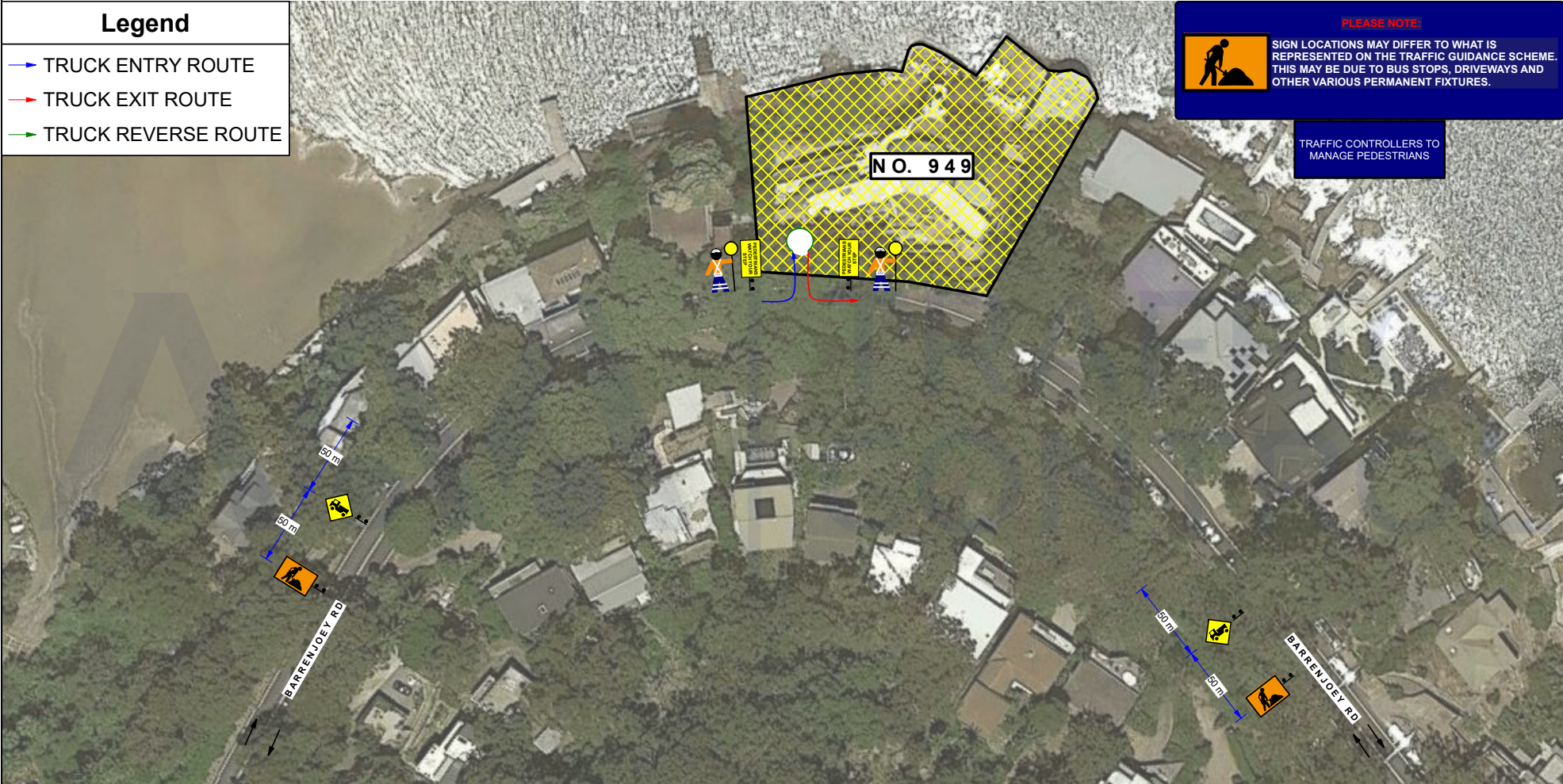



**TRAFFIC CONTROL**

PH: 02 9675 7731 F: 02 9675 7744  
 10 Coventry Place  
 Mount Druitt NSW 2770  
 www.aaatraficcontrol.com.au  
 info@aaatc.com.au  
 A.B.N. 53 648 829 994

**NOTES:**

- All Traffic Control works; signs and devices to comply with Australian Standard AS 1742.3.
- Adjustments to TGS may be only made by persons holding an TfNSW "Prepare a Work Zone TMP" certification.
- All traffic control devices may only be set out by persons holding an TfNSW "Implement Traffic Control Plans" ticket or higher.
- Traffic control personnel must hold an TfNSW "Traffic Controller" ticket or higher.
- Signs to be erected so they are visible to motorists and not a hazard to pedestrians.
- Traffic controllers to escort pedestrians past the work area.
- Traffic Controllers who are on constant Stop-Go, must be relieved for a minimum period of 15 minutes every two hours. As per the Australian Standards and the WH&S Act.
- Site ganger is to conduct a 'tool box talk' and complete the adequate paperwork to support the discussion.
- A 'risk assessment' to be conducted on site, prior setup to determine the queue length and site distance to the active TCP.
- If an incident occurs on site, an 'Incident report form' MUST be completed immediately. Upon completion of the incident report form, site Ganger is to notify AAA head office.

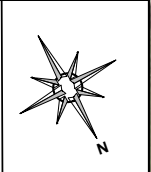
This TGS has been prepared as a guide for Traffic Management purposes only and is not to scale. The positions of the signs, traffic controllers and equipment are only suggested locations. Amendments to the locations may be required on site. AAA Traffic Control Pty Ltd accepts no liability for the implementation or execution of this TGS unless undertaken by authorized AAA Traffic Control personnel.



CLIENT: CREBTIVE BUILDING PROJECTS
CONTACT: MARK PH: 0413 587 256
PROJECT: TRUCK ENTRY/EXIT
LOCATION: 949 BARRENJOEY RD, PALM BEACH
PO: 949 BARRENJOEY RD, PALM BEACH

<b>MANAGEMENT</b> <input type="radio"/> STOP / SLOW <input type="radio"/> LANE MERGE <input type="radio"/> CONTRA FLOW <input type="radio"/> DETOUR <input type="radio"/> ROAD CLOSURE <input type="radio"/> SHOULDER WORKS	<input checked="" type="radio"/> PEDESTRIAN MGMT. <input type="radio"/> TRUCK ENTRY/EXIT
	<b>ROAD CLASSIFICATION</b> <input checked="" type="radio"/> STATE (RTA/RMS) <input type="radio"/> REGIONAL (COUNCIL & RTA/RMS) <input type="radio"/> LOCAL (COUNCIL)

JOB NO. 11905	PLAN NO: TP1165
<input checked="" type="radio"/> TGS <input type="radio"/> TMP <input type="radio"/> CTMP	AUTHOR: TYRONE PRITCHARD
REV DATE	CERT: TCT1028313
SCALE N.T.S	DATE: 10/10/2023
	SIGN: <i>Tyrone TP</i>

PURPOSE OF USAGE	APPROACH SPEED (km/h)	MAX SPACING (m)	RECOMMENDED TAPER LENGTHS			
			TRAFFIC CONTROL AT START	LATERAL TAPER	MERGE TAPER	REVERSE TAPER
All purposes on residential or commercial streets	<= 50	4	< 45	15	15	15
Center-line on approach to Traffic Controller position	All cases	4	46 - 55	15	15	30
Outer edge of traffic line - i.e. working on shoulder	55</55-75/>75	4/12/18	56 - 65	30	30	60
Separating opposing traffic on 2 lane 2 way road	55</55-75/>75	4/12/18	66 - 75	N/A	70	115
Separating opposing traffic on multilane undivided road	55</55-75/>75	4/12/18	66 - 75	N/A	70	115
Adjacent to a closed lane on a multilane road	55</55-75/>75	4/12/18	66 - 75	N/A	70	115
Merge tapers	55-75 / > 75	9 / 12	76 - 85	N/A	80	130
Lateral shift tapers	55-75 / > 75	12 / 18	86 - 95	N/A	90	145
Protecting freshly painted lines	55-75 / > 75	24 / 60	96 - 105	N/A	100	160
FIGURES EXTRACTED FROM RTA TCWS MANUAL v6.1 (TABLE 6 - 2). REFER TO MANUAL FOR FURTHER INFO.			> 105	N/A	110	180

# Appendix B – Drivers Code of Conduct

## - Driver Code of Conduct -

### Objectives of the Drivers Code of conduct

- To minimise the impact of the construction on the local and regional road network;
- Minimise conflict with other road users;
- Minimise road traffic noise; and
- Ensure truck drivers use specified routes

### Code of Conduct

#### All vehicle drivers must:

- Take care for his or her own personal health and safety.
- Consider the impact on the health and safety of other persons.
- Notify their employer if they are not fit for work prior to commencing their shift.
- Obey all applicable road rules and laws at all times.
- In the event an emergency vehicle behind your vehicle, pull over and allow the emergency vehicle to pass immediately.
- Obey the applicable driving hours in accordance with legislation and take all reasonable steps to manage their fatigue and not drive with high levels of drowsiness.
- Obey all on-site signposted speed limits and comply with directions of traffic control supervisors in relation to movements in and around temporary or fixed work areas.
- Ensure all loads are safely restrained, as necessary.
- Operate their vehicles in a safe and professional manner, with consideration for all other road users.
- Hold a current Australian State or Territory issued driver's licence.
- Notify their employer or operator immediately should the status or conditions of their driver's license change in any way.
- Comply with other applicable workplace policies, including a zero tolerance of driving while under the influence of alcohol and/or illicit drugs.
- Not use mobile phones when driving a vehicle or operating equipment.
- Drinking or eating is not allowed while operating the vehicle.
- Advise management of any situations in which you know, or think may, present a threat to workplace health and safety.
- Drive according to prevailing conditions (such as during inclement weather) and reduce speed, if necessary.
- Have necessary identification documentation at hand and ready to present to security staff on entry and departure from the site.

## Crash or incident Procedure

- Stop your vehicle as close to it as possible to the scene, making sure you are not hindering traffic. Ensure your own safety first, then help any injured people and seek assistance immediately if required.
- Ensure the following information is noted:
  - Details of the other vehicles and registration numbers
  - Names and addresses of the other vehicle drivers
  - Names and addresses of witnesses
  - Insurers details
- Give the following information to the involved parties:
  - Name, address and company details
  - If the damaged vehicle is not occupied, provide a note with your contact details for the owner to contact the company.
- Ensure that the police are contacted should the following circumstances occur:
  - If there is a disagreement over the cause of the crash.
  - If there are injuries.
  - If you damage property other than your own.
- As soon as reasonably practical, report all details gathered to your manager.