

ALL PAVED AREAS AND COPING SHALL FALL TOWARDS GARDEN, LAWN AREAS & PROPOSED DRAINS

SWIMMING POOL OVERFLOW SYSTEM SHALL BE CONNECTED TO THE EXISTING SEWER SYSTEM

PROPOSED STRIP DRAIN TO BE CONNECTED TO EXISTING STORMWATER SYSTEM

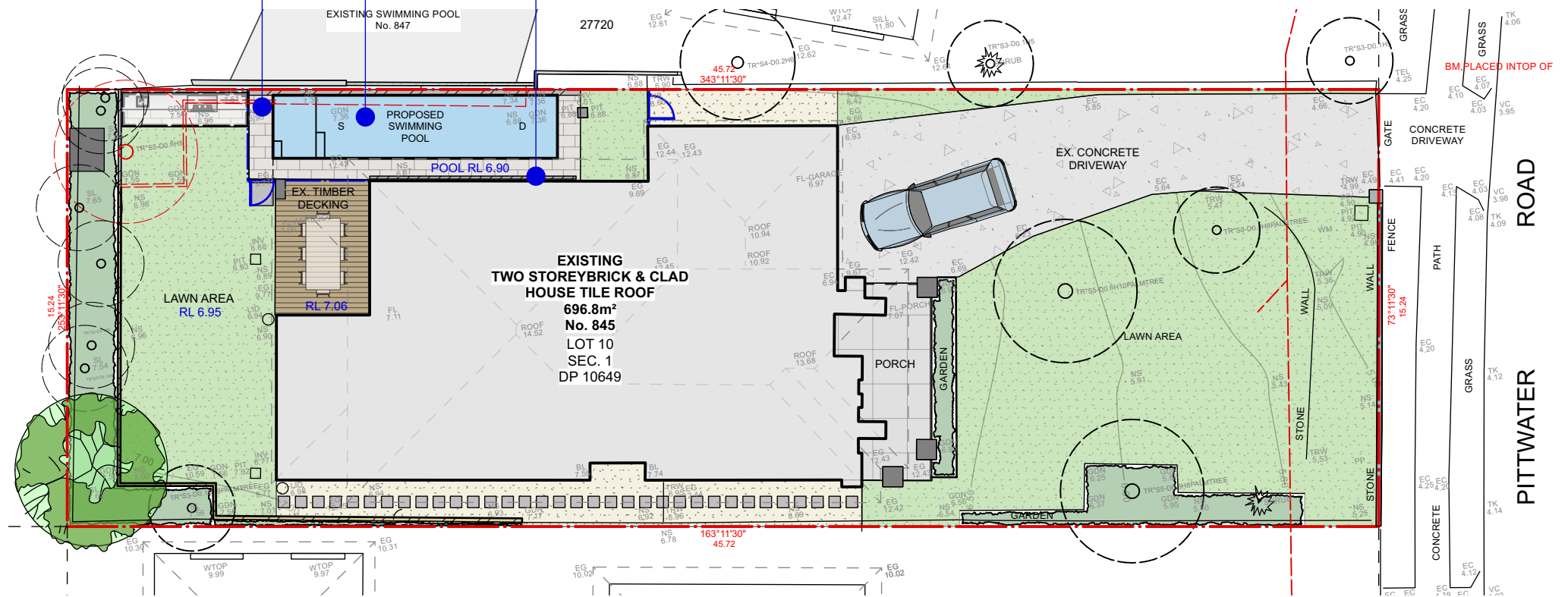

## STORMWATER DRAINAGE PLAN

scale 1:200

**CONTOUR**  
LANDSCAPE ARCHITECTURE

PO Box 698 MONA VALE NSW 1660  
Tel: 0434 500 705 - AIDLM

PROJECT:  
**Eoghan Kavanagh**  
845 Pittwater Rd, Collaroy,  
NSW 2097

### NOTES

- All works shall comply with building code of Australia and all relevant Australian standards.
- All works shall be in accordance with development application and construction certificate conditions of consent all levels to shd.
- Refer to survey information relating to existing site data.
- Verify all dimensions prior to works.
- Do not scale from drawings.
- Use figured dimensions in preference to scaling.
- Refer all discrepancies to landscape architect for determination.
- This drawing is copyright and must not be retained, copied, used or reproduced in any way without prior written permission of contour landscape architects.

DATE	REV.	ISSUE
23/02/24	A	DRAFT
04/03/24	B	REV.
03/05/24	C	DA.
14/06/24	D	DA.
25/06/24	E	DA.

DATE: 25/06/2024

SCALE: 1:200@A3

DRAWN: CC

DRAWING  
**STORMWATER  
DRAINAGE PLAN**  
DRAWING NO: C-5

REV: E

