

1x Angophora costata Canopy tree x 75ltr MUST be staked with 4 hardwood stakes and hessian webbing ..remove all weed vegetation in local area. Final location to be site determined /generally in the lower boundary corner

Stormwater dispersion spreader see Nitma Consulting hydraulic plan 1.7.24 Issue B

See Architects plans 14.6.24

Ex Eucalyptus scias Red Mahogany to be counted as canopy tree to front /DCP

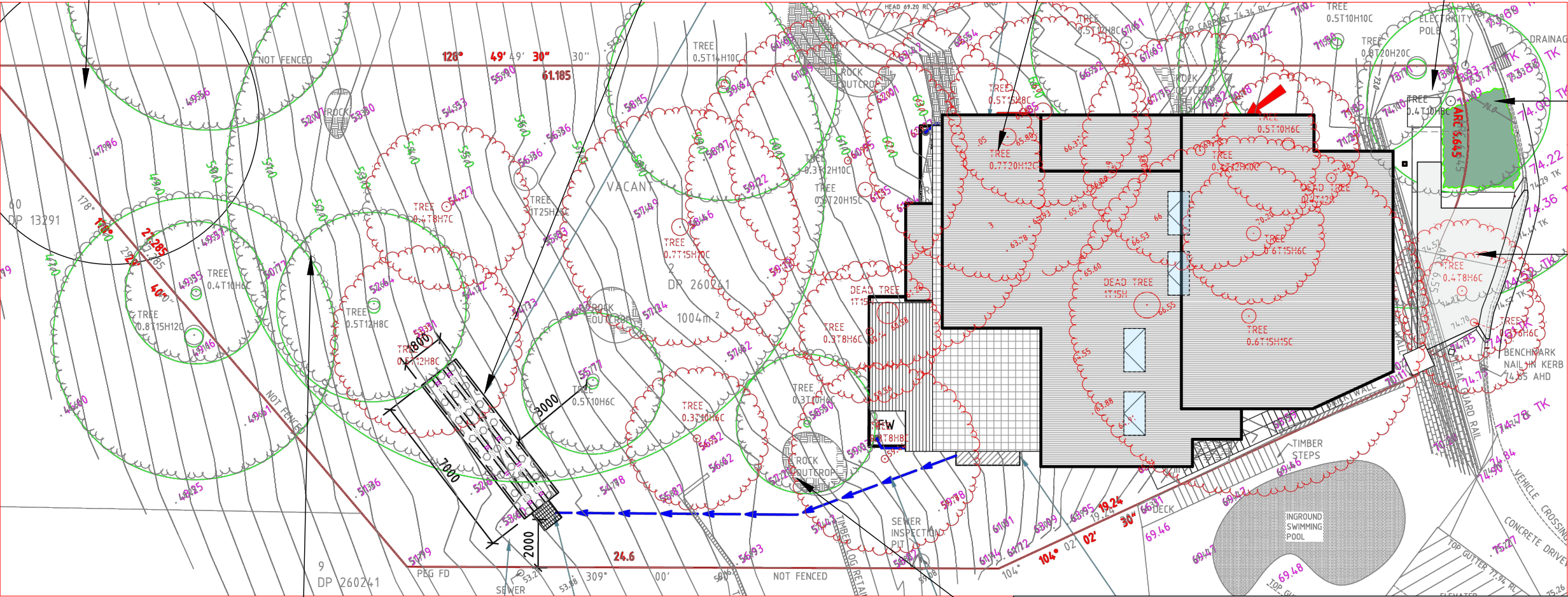

50x Lomandra filiformis x140mm pot

New driveway and crossover to NBC specification

Lower garden area to be treated as a bushland regeneration area: Minimum two year activity for plant replacement and on going weed management. Ideally a local bushcare group is to be contracted to perform : Initial and on going weed removal along with site management for removal of large plants/privet etc as identified by NBC council web site www.pittwater.nsw.gov.au/environment/noxious_weeds/a-z_list_of_weeds.

See Arborlogix Arboricultural Impact Assesment 6.6.24 for trees to be retained and trees to be removed.

To be read in conjunction with Bushfire Planning and Design consulting report.

Master Plan

Landscape plan
100 Hill Top road Avalon

Issue: A client DRAFT
Issue: B Council issue
Issue: C REV plan and Eco Rev
Issue: D REV plant Sch Lomandra filiformis

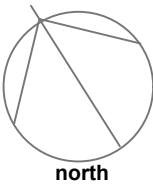

Andrew Davies
landscape designer
27 Turimetta Street, Mona Vale NSW 2103
design.bdg@gmail.com
alm - 17 986 316 620
www.banksiadesigngroup.com.au 0414 2900 57

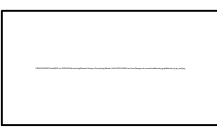

Landscape DA Plan	
Drawing: AD/TT	Checked by: AD
Andrew Davies	Job: R09 220527
Date: 14.2.25	Issue: D
Scale: 1to 200 A3	
Approx:	

2

3

Plant Schedule

Botanical Name	Common Name	Pot size mm	Dimensions WxH in metres	Qty.
Angophora costata	Argle apple tree	75ltr	20x20plus	1
Lomandra filiformis	Lomandra	140	.4x.7	50

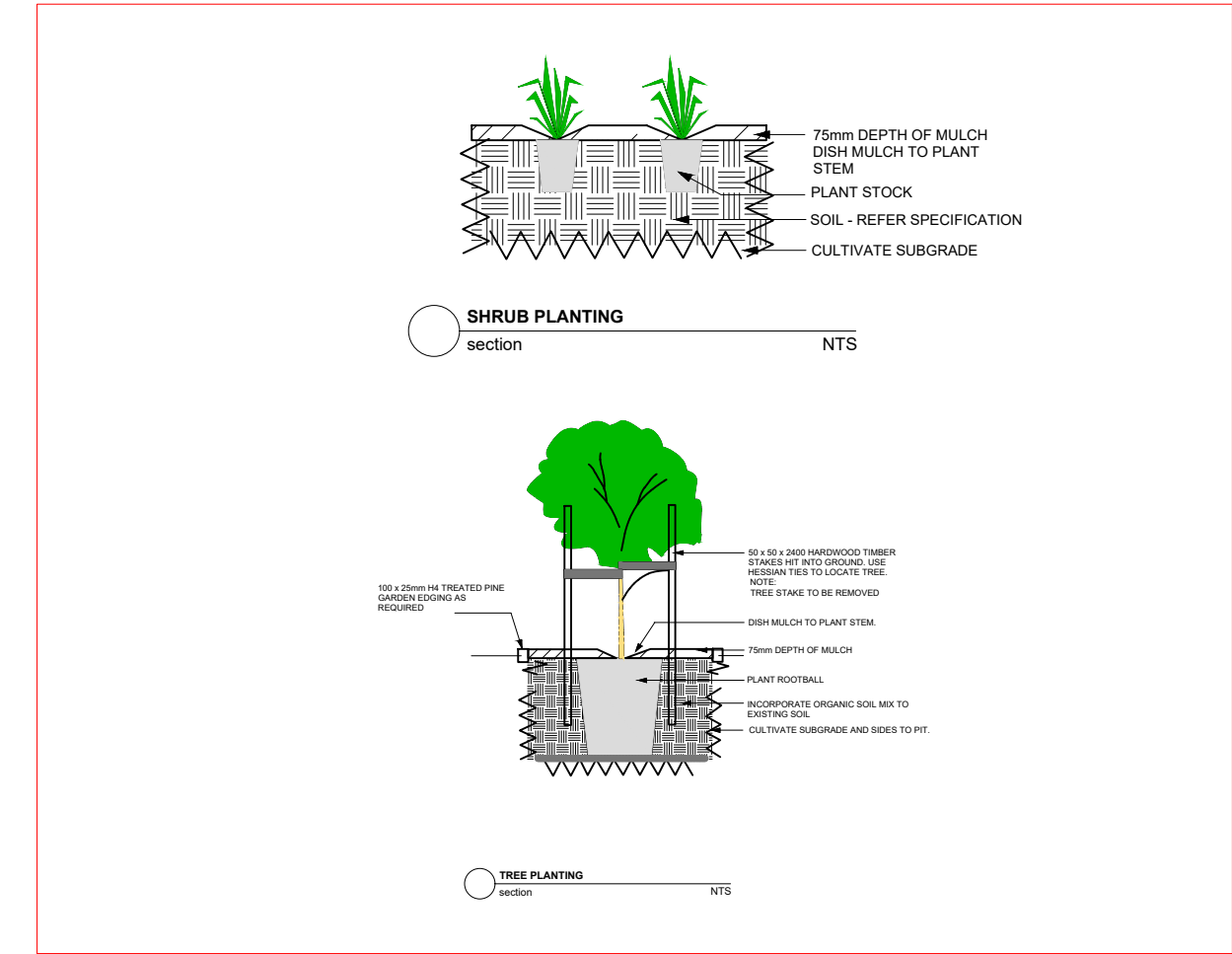

Plant Schedule and notes

Landscape plan
100 Hill Top road Avalon

Issue: A client DRAFT
Issue: B Council issue
Issue: C REV plan and Eco Rev
Issue: D REV plant Sch Lomandra filiformis

LANDSCAPE GENERAL
SPECIFICATION AND NOTES

All landscape works and material supply, to be in accordance with AS 4000, LCA guidelines and Occupational Health & Safety standards.

All landscape works to comply with relevant Australian Standards and relevant Building Codes of Australia

All dimensions and locations to be checked on site and confirmed by landscape site supervisor before commencement of works

Do not scale from drawings. Dimensions take preference

Plant schedule and quantities to be used as guide only and to be confirmed by contractor before final purchase of plants

Final plant positions to be determined on site (by Landscape Supervisor).

DESIGN LIABILITY NOTE: No liability is accepted by these plans. Contractors are required to check ALL construction facts, figures and relevant information pertaining to the soft and hard scape works to be performed. Should anomalies occur, the designer or a representative of Banksia Design Group must be contacted and given due notice and sufficient documentation and, if required, due compensation to allow for adjustment/s to plans, documentation etc

REMOVAL OF NOXIOUS WEEDS: As a duty of care exists for all contractors: if a noxious weed exists onsite it should be removed after discussion with the owner or site supervisor.

ENVIRONMENTAL MANAGEMENT AND SEDIMENT CONTROL: All Landscape works to adhere with Environmental Legislation outlined in the *Protection of the environment operations act 1997*, by the EPA NSW.

It is highly recommended to use Dial Before You Dig services – contact for information at www.dialbeforeyoudig.com.au or call 1100.

TREES: All trees to be staked: use 2 x hardwood 50x50mm stakes and hessian webbing. See detail

TURF: 1. Install turf rolls diagonal to the fall of the land. Roll turf following installation, and water as required . Use soft leaf Buffalo sp

2. 50 - 70mm topsoil underlay to be used in ground preparation .Note check ph after construction and before laying turf, adjust as required for optimum plant growth

SOIL:

1. Contractor is to check soil pH levels, two weeks prior to planting, and allow for reasonable adjustments, using lime or similar to ensure plant viability

2. Break up existing ground surface using mattock, rotary hoe or tractor tine as required

3. Topsoil sandy loam 50mm depth to turf areas.

4. Where necessary mound soil to assist in soil drainage to avoid root rot and poor plant growth

5. Incorporate ¼ tonne organic soil mix into holes where trees are planted, using recycled leaf litter as mulch

6. Soil Quality to be Australian Native Landscape Standard

7. Supply and Install ‘Garden Mix’ to all garden beds incorporated into the top 300mm of existing site profile. Note use rotary hoe as required do not just place on top of ground

MULCH: Mulch to be installed to all planter beds to a depth of 75mm. Mulch type to be Recycled Leaf Litter ideally from local tree company based on more native plants than general exotics.

EDGING: See plan for locations. Top edge higher than lawn to allow garden beds to be aerated & mounded

DRAINAGE: fall paving to lawn area

LIGHTING: to future plans TBA

MAINTENANCE: New plants to receive regular deep irrigation for a minimum 12 weeks establishment period. Seasonal pruning, fertilising and pest and disease checks to be carried out. Advice by qualified horticulturalist recommended

IRRIGATION: Drip irrigation TBA

Andrew Davies
landscape designer
27 Turimetta Street, Mona Vale NSW 2103
design.bdg@gmail.com
albn : 17 986 316 620
www.banksiadesigngroup.com.au 0414 2900 57

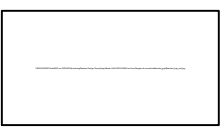

Landscape DA Plan	
Drawing: AD/TT	Checked by: AD
Andrew Davies	Job: R09 220527
Date 14.2.25	Issue : D
Scale: 1to 200 A3	
Approx	