

Applicant and Project Details

Complete this page and the relevant Sections that apply to your proposed development.

Applicants' Details

Name: (must be the same as the DA form)	LOOK DESIGN GROUP P/L
Address: (must be the same as the DA form)	100 BANTRY BAY ROAD FRENCHS FOREST NSW 2086
Phone Number:	0438 699 949
Email Address:	natalie@lookdesigngroup.com.au

Property Details

Lot No: Deposited Plan (DP) No: or Strata Plan (SP) No:	LOT 2 DEPOSITED PLAN DP431749
Unit No: House No: Street: Suburb: Postcode:	17A HUDSON PARADE CLAREVILLE NSW 2107

Project Details

Description of proposed development:	ALTERATIONS + ADDITIONS TO FREE STANDING DWELLING
Structures to be demolished:	ROOF, AWNING + SMALL AMOUNT OF WALL CLADDING, MOST OF WHICH IS TO BE RE-USED FOR NEW WORKS.

Applicant Declaration

I declare that:

1. This plan has been completed in accordance with the Waste Management Guidelines
2. To the best of my knowledge, the details on this form are accurate and correct

I understand that:

1. All records demonstrating lawful disposal of waste will be retained and kept readily accessible for inspection by regulatory authorities such as Council, NSW Environment Protection Authority or WorkCover NSW.
2. A bond in accordance with Council's fees and charges may apply to this development and must be paid to Council prior to any works commencing.
3. The bond will only be refunded when Council is satisfied that all waste outlined in this plan has been managed as per the plan, and evidence such as photos, receipts and statutory declarations must be supplied where appropriate.

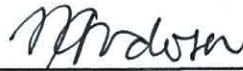
Signature of Applicant:  Date: 6/09/21
NATALIE ANDERSEN
DIRECTOR
LOOK DESIGN GROUP P/L

Section 1 – Demolition

This section must be completed in accordance with 'Chapter 1 – Demolition' of the Waste Management Guidelines

MATERIALS ON SITE	DESTINATION <i>Evidence such as weighbridge dockets and invoices for waste disposal or recycling must be retained on site for inspection</i>					
	REUSE AND RECYCLING (MOST FAVOURABLE)				DISPOSAL (LEAST FAVOURABLE)	
Types of Waste Material	Estimated Volume (m ³) or Weight (t)	ONSITE RE-USE ✓ Specify how material will be reused on site	OFFSITE RECYCLING ✓ Recycling Outlet (RO) ✓ Waste Transport Contractor (WTC)		OFFSITE DISPOSAL ✓ Specify landfill site (LS) ✓ Specify Waste Transport Contractor (WTC)	
			WTC	RO	WTC	LS
Excavated Material	0	—	—	—	—	—
Garden Organics	0	—	—	—	—	—
Bricks	0	—	—	—	OPTION NOT AVAILABLE These materials must be re-used on site and sent for recycling.	
Tiles	0	—	—	—		
Concrete	0	—	—	—		
Timber	5 m ³	handrails gentry profiles	—	1.5 m ³		
Plasterboard	1/2 m ³	—	1/2 m ³			
Metals	1.0 m ³	—	—	1.0 m ³		
Asbestos	0	—	—	—		
Other waste (please specify)						
Estimated Total % Recovered	6.5 m ³					

Refer to the estimation tables in 'Chapter 1 – Demolition' of the Guidelines for assistance in completing this table.

The applicant must submit a Site Plan showing the structures to be demolished and storage areas for waste and construction materials (if the development also includes construction).

WMP Checklist

Have you included the following:	Applicant Tick
A site plan showing: <ul style="list-style-type: none"> • The structures to be demolished. • Storage areas for waste to be reused, recycled, or disposed of. • Materials storage (if the development also includes construction) 	<input checked="" type="checkbox"/>
The table on the previous page, completed in accordance with 'Chapter 1 – Demolition' in the guidelines.	<input checked="" type="checkbox"/>

Section 2 – Construction

This section must be completed in accordance with 'Chapter 2 – Construction' of the Waste Management Guidelines

MATERIALS ON SITE	DESTINATION <i>Evidence such as weighbridge dockets and invoices for waste disposal or recycling must be retained on site for inspection</i>					
	REUSE AND RECYCLING (MOST FAVOURABLE)				DISPOSAL (LEAST FAVOURABLE)	
Types of Waste Material	Estimated Volume (m ³) or Weight (t)	ONSITE RE-USE ✓ Specify how material will be reused on site	OFFSITE RECYCLING ✓ Specify recycling outlet (RO) ✓ Specify Waste Transport Contractor (WTC)		OFFSITE DISPOSAL ✓ Specify landfill site (LS) ✓ Specify Waste Transport Contractor (WTC)	
* Please specify			WTC	RO	WTC	LS
Excavated Material	0	—	—	—		
Garden Organics	0	—	—	—		
Bricks	0	—	—	—	OPTION NOT AVAILABLE These materials must be re-used or separated on or off site and sent for recycling	
Tiles	0	—	—	—		
Concrete	0	—	—	—		
Timber*	3 m ³	0.5	2.5 m ³	—		
Plasterboard	0.5 m ³	—	0.5 m ³	—		
Metals*	0	—	—	—		
Asbestos	—	—	—	—		
Other waste*	1.5 m ³	—	1.5 m ³			
Estimated Total % Recovered	5 m ³					

Refer to the estimation tables in 'Chapter 2 – Construction' of the Guidelines for assistance in completing this table.

The applicant must submit a Site Plan showing the structures to be demolished and storage areas for waste and construction materials (if the development also includes construction).

WMP Checklist

Have you included the following:	Applicant Tick
<p>A site plan showing:</p> <ul style="list-style-type: none"> • The structures to be demolished. • Potential storage areas for waste to be reused, recycled, or disposed of. • Materials storage 	<input checked="" type="checkbox"/>
<p>The table on the previous page, completed in accordance with 'Chapter 2 – Construction' in the guidelines.</p>	<input checked="" type="checkbox"/>

Section 3 – On-going waste management for one or two dwellings

This section is to be completed in accordance with 'Chapter 3 – On-going waste management for one or two dwellings' of the Waste Management Guidelines.

Type of development: ALTERATIONS + ADDITIONS

Number of dwellings: SINGLE FREE STANDING DWELLING

WMP Checklist

Do your architectural and landscape plans include the following:	Applicant Tick
Waste Storage Area design requirements (Chapter 3.2.)	<input checked="" type="checkbox"/>
Waste Storage Area location requirements (Chapter 3.3.)	<input checked="" type="checkbox"/>

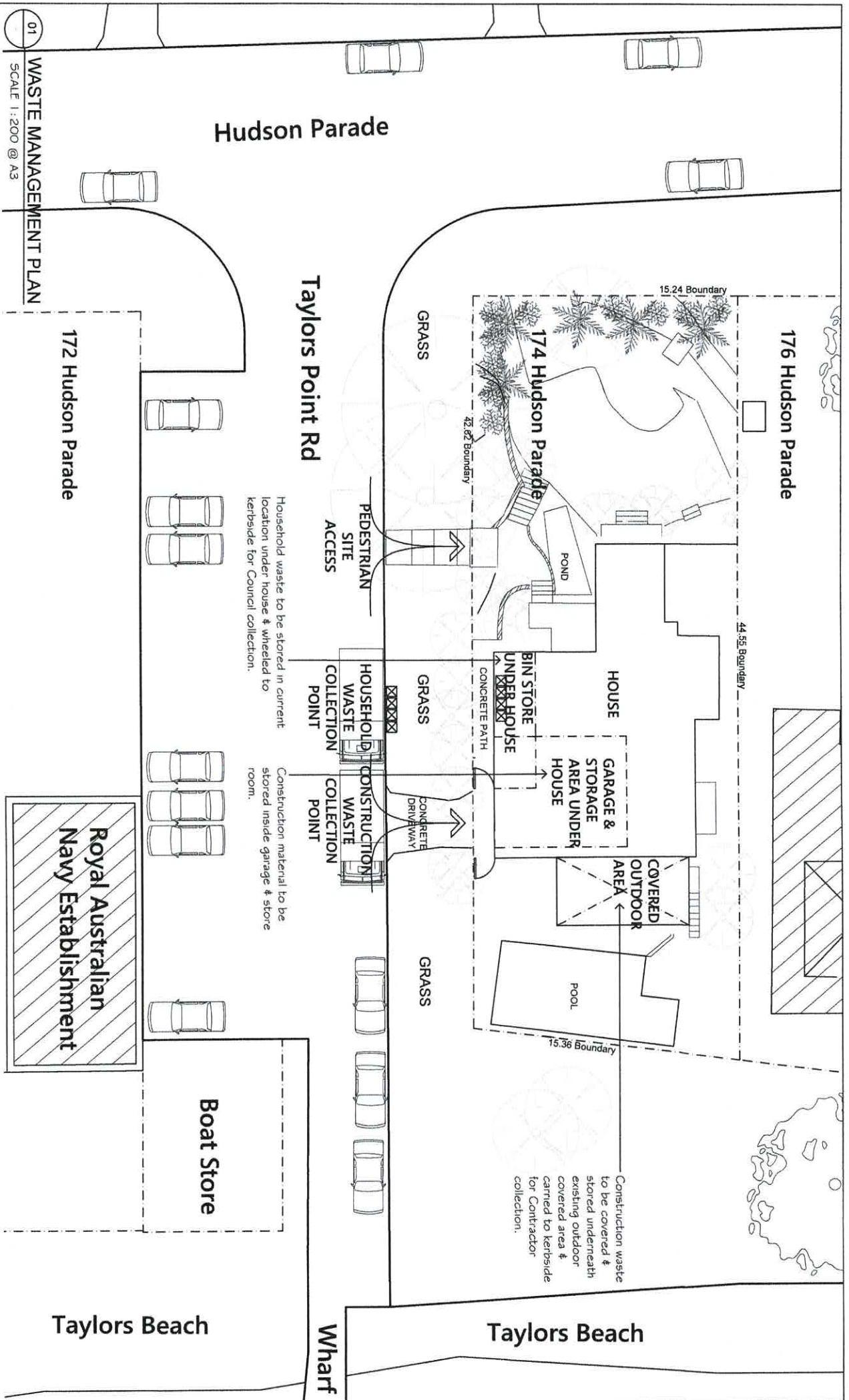

01 WASTE MANAGEMENT PLAN
SCALE 1:200 @ A3

NOTES:
All dimensions to be checked on site. Do not obtain dimensions by scaling drawings. These drawings are to be read in conjunction with all other consultants drawings & specifications. All workmanship & materials shall be in accordance with requirements of current editions including amendments of current relevant S44 Codes of Practice & the Building Code of Australia.

look DESIGN GROUP

am: 0438699949
a: PO Box 570
Forestville, NSW, 2087
e: natalie@lookdesigngroup.com.au

Amendments:

DATE	REV. NO	REVISION
18.08.21	A	Review for discussion.

174 Hudson Parade,
Clareville NSW 2107



Waste Management Plan

Project number
1200

Date:	18.08.21	Drawing No.	Rev. No.
Drawn by	EC	DA20	A

Scale 1:200 @ A3