

Sketch to accompany my field investigation survey completed on Wednesday 5th March 2025.  
RE: EXISTING GRADIENTS - 7 COOLEENA ROAD, ELANORA HEIGHTS

Reference No.: 2491-2-C

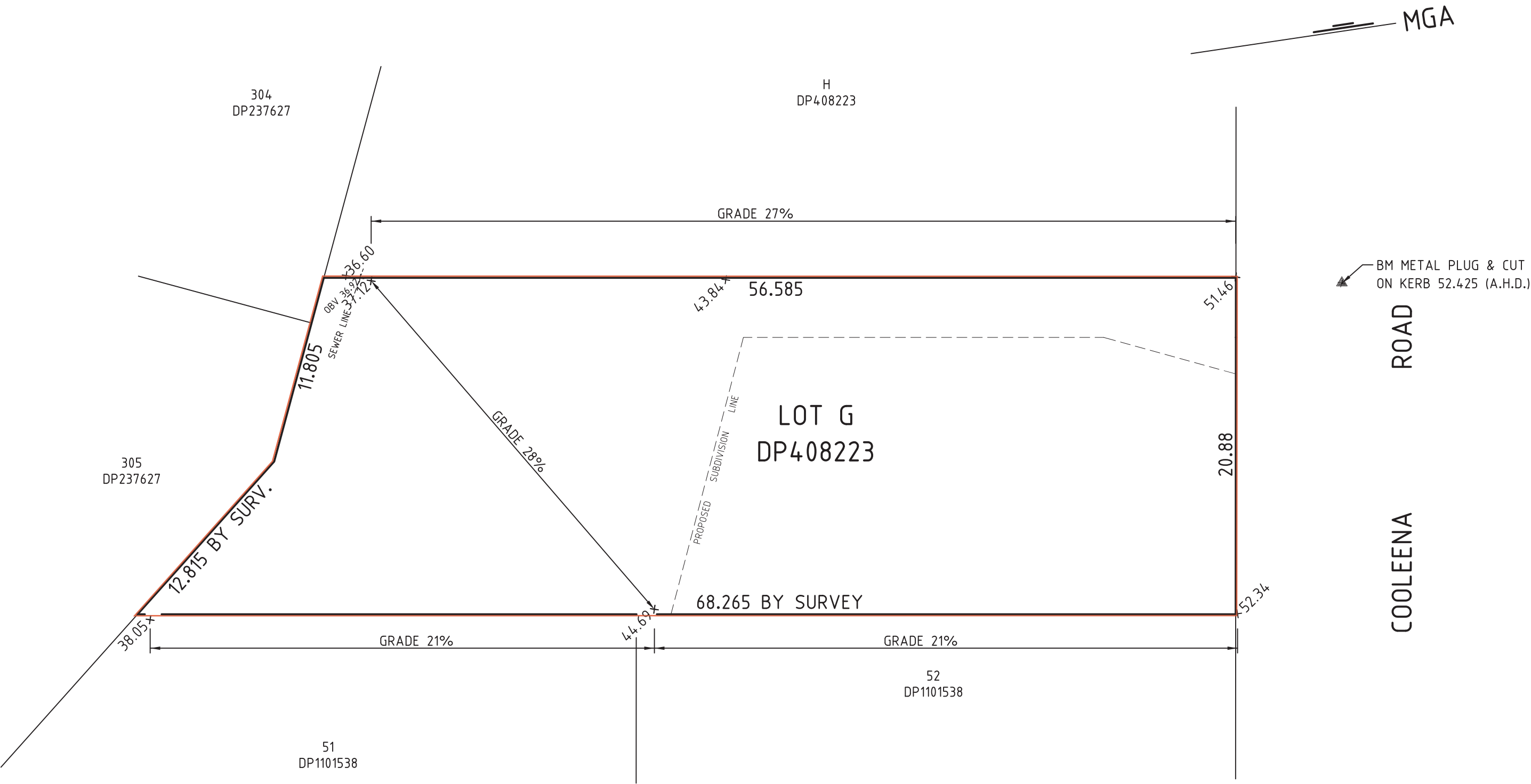

NOTES:

1. LEVELS TAKEN AS FAR AS REASONABLY PRACTICAL NEAR TO REAR BOUNDARY, GIVEN OVERGROWTH OF VEGETATION CONSTRAINTS.
2. ORIGIN OF LEVELS FROM PM5287 R.L. 55.611 FROM SCIMS SEARCH DATED 5TH MARCH 2025.
3. SURVEY IS LIMITED TO LEVELS SHOWN ON THIS SKETCH PLAN.  
NO FURTHER INVESTIGATION HAS BEEN MADE OR ANY COMMENT OFFERED.
4. THIS DOCUMENT IS COPYRIGHT AND CAN ONLY BE USED IN THE MATTER OF IANNI.

**ROBERT FRIEND SURVEYS PTY LTD**  
Consulting Land Surveyor  
PO Box 4209, Denistone East, NSW, 2112  
Email: admin@rfsurveys.com.au Mobile: 0457 602 177

BOSSI ID SU003841  
  
Surveyor Registered under  
the Surveying and Spatial  
Information Act, 2002