

WAKEHURST PARKWAY

NOTE: INTERNAL DRIVEWAY IS TO BE CONSTRUCTED TO AN ALL WEATHER STANDARD FINISH TO BE OF DARK OR EARTHY TONES, LINE MARKED AND SIGNPOSTED TO AS 2890 OFF STREET CAR PARKING

DEMOLISH EXISTING & PROVIDE NEW 150 THICK (SL82(T)) CONCRETE DRIVE CROSSING TO COUNCIL STANDARD. REFER TO DWG 17817-3 FOR DETAILS

EXISTING COUNCIL DRAINAGE LINE

RECONSTRUCT EXISTING HEADWALL & APRON AS NECESSARY TO SATISFACTION OF COUNCIL & SUPERVISING ENGINEER

DRIVEWAY ACROSS PUBLIC ROAD RESERVE TO BE OF A PLAIN CONCRETE FINISH

ELANORA ROAD

NOTE: ALL TREES TO BE RETAINED OR REMOVED TO STRICTLY COMPLY WITH THE 'TREE LOCATION PLAN' & RECOMMENDATIONS IN ARBORICULTURAL ASSESSMENT REPORT DATED MARCH 2017

NOTE: CHECK & LOCATE DEPTH OF LINES, SIZES AND LEVEL OF EXISTING MAINS & SERVICES PRIOR TO COMMENCEMENT OF CONSTRUCTION AS VARIATIONS IN POSITION OF MAINS & SERVICES COULD AFFECT CONSTRUCTION DETAILS

EDGE OF PROPOSED CONCRETE DRIVEWAY IS ALSO THE EXTENT OF RIGHT OF WAY & EASEMENT FOR SERVICES (3.65m WIDE)

EXTENT OF PROPOSED RETAINING WALL TO BE DETERMINED ON SITE (TYP)

NOT INSTALLED VEHICLE IMPACT BARRIER WHERE D > 600

3350mm (MIN) WIDE CONCRETE DRIVE (CLEAR WIDTH)

INDICATIVE BUILDING PLATFORM

EXISTING SURFACE LEVELS

CMS Surveyors Pty Limited
A.B.N. 79 096 240 201
LAND SURVEYING, PLANNING & DEVELOPMENT CONSULTANTS
PO Box 463, DEE WHY NSW 2099
1/32 CAMPBELL AVENUE, DEE WHY NSW 2099
Ph: 02 9971 4802 Fax: 02 9971 4822 Email: info@cmssurveyors.com.au

SUBDIVISION DRIVEWAY PLAN

SCALE 1:200

- NOTE: 1. FOR DRAINAGE DETAILS REFER TO INTER-ALLOTMENT DRAINAGE PLAN DWG 17817-2
2. ALL SERVICES TO BE INSTALLED IN ACCORDANCE WITH THE UTILITY PROVIDERS (SYDNEY WATER, JEMENA, AUSGRID, TELSTRA) RECOMMENDATIONS FOR UNDERGROUND UTILITIES & TO BE PLACED WITHIN THE SERVICES CORRIDOR SHOWN ON DRIVEWAY & DRAINAGE DETAILS DWG 17817-3

OUR REF: 957A as-built redups

Date: 23-10-17

we have attended site on 5-10-17 and as built the newly constructed civil works.
we hereby confirm the dimensions, features and levels confirmed hereon in red represents finished works.

SG

Registered Surveyor
No.1605

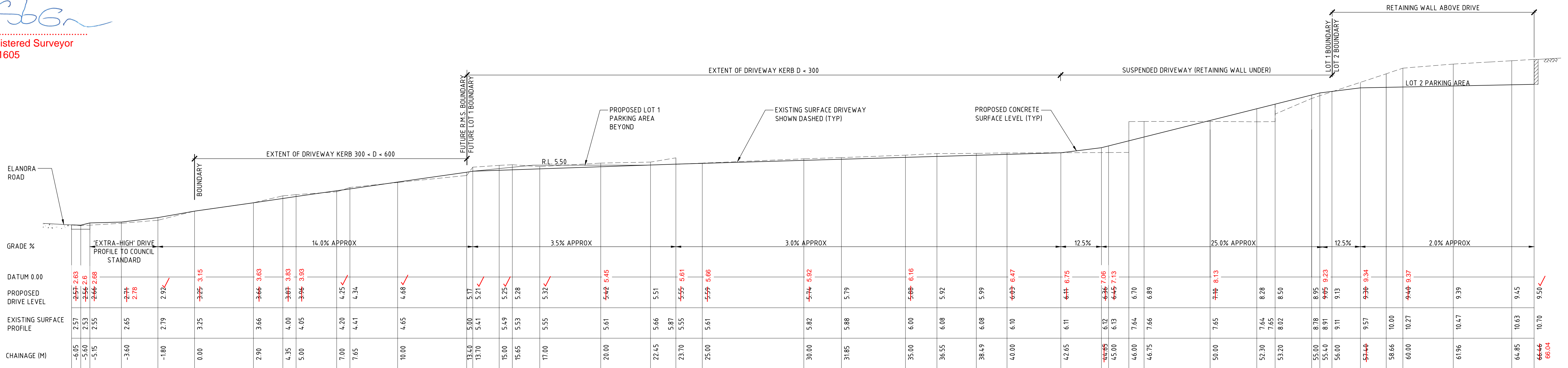

DRIVEWAY LONG-SECTION

SCALE 1:100 NATURAL

CONSTRUCTION CERTIFICATE

Certificate No.S1170045C01.....
Date of Issue29 May 2017.....
Issuing Officer *Harry B*
Accreditation No.BPB0565.....
These plans/specifications form part of the certificate issued 29 May 2017

ALL WORKS WITHIN THE EXISTING ROAD RESERVE ARE EXCLUDED FROM THIS APPROVAL

ISSUE DATE	REVISION
MAY 2017	COUNCIL DRIVE PROFILE ADDED
MAY 2017	REVISED TO SUIT CERTIFIERS COMMENTS
MAY 2017	PARKING BAYS ADDED

TITLE
DRIVEWAY PLAN & LONG-SECTION
1 ELANORA ROAD, ELANORA HEIGHTS

DRAWN
JBK

DATE
20 APRIL 2017

CHECKED
Self
BE Civil (Hons) MIE Aust

SCALE @ A1
1:200
1:100

TAYLOR
CONSULTING
CIVIL & STRUCTURAL ENGINEERS

DRAWING NO
17817-1/C

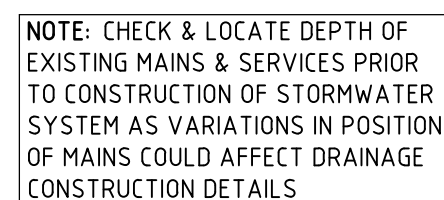

**NOTE: CONNECT EXISTING
SITE DRAINAGE AS
NECESSARY NEW SITE
DRAINAGE SYSTEM**

NOTE: PLUMBER TO PERFORM WATER TESTING OF EXISTING PIPED SYSTEM TO DETERMINE CAPACITY AND STATE OF REPAIR. PLUMBER TO INSPECT & REPAIR DAMAGED SECTIONS OF EXISTING PIPE (INCLUDING DOWNPIPES) AS NECESSARY OR PROVIDE NEW DRAINAGE LINES WHERE NECESSARY SUBJECT TO THE APPROVAL BY THE SUPERVISING ENGINEER.

NOTE: EDGE OF PROPOSED
CONCRETE DRIVEWAY IS ALSO
THE EXTENT OF RIGHT OF WAY
& EASEMENT FOR SERVICES

INLET PIT 7
450 SQ. INLET PIT
GRATE R.L. - 9.45
INVERT R.L. - ~~8.85~~ 8.80

150 WIDE GRATED
DRAIN (TYP)

INLET PIT 6
100 SQ. INLET PIT
GRADE RL. 9.80
INVERT RL. 8.87

900 SQ. INLET PIT
GRATE RL. 10.55
INVERT RL. 8.97

CONSTRUCT 900 SQ. INLET PIT TO
PIT WATER COUNCIL STANDARD
DRAINAGE DRAWINGS SHEET 3 OF 5

DRAINAGE NOTES

1. + DENOTES EXISTING GROUND LEVEL
2. FALL STORMWATER PIPES AT 1% MIN. UNLESS OTHERWISE NOTED.
3. SUB-SOIL DRAINAGE TO BE CONNECTED TO THE SITE DRAINAGE SYSTEM AS NECESSARY.
4. SURFACE GRATES 450 SQ. UNLESS OTHERWISE NOTED.
5. ALL STORMWATER PIPES TO HAVE SOLVENT CEMENT WATERTIGHT JOINTS.
6. CHECK & LOCATE DEPTH OF EXISTING MAINS & SERVICES PRIOR TO CONSTRUCTION OF STORMWATER SYSTEM AS VARIATIONS IN POSITION OF MAINS COULD AFFECT DRAINAGE CONSTRUCTION DETAILS.
7. INSPECTIONS MUST BE UNDERTAKEN BY THIS OFFICE (BY PRIOR ARRANGEMENT WITH ENGINEER) DURING CONSTRUCTION TO ENABLE FULL CERTIFICATION UPON COMPLETION OF WORKS.
8. ALL CONSTRUCTION OF COUNCIL DRAINAGE WORKS TO COMPLY WITH COUNCIL STANDARD.
9. REMOVE REDUNDANT DRAINAGE PITS AND SEAL PIPES.
10. PIT BENCHING TO BE HALF THE OUTGOING PIPE DIAMETER. CONCRETE FOR BENCHING TO BE 20 MPa MASS CONCRETE.
11. APPROVED PRE-CAST PITS MAY BE USED.
12. ALL PIPES TO BE LAID ON COMPACTED FINE CRUSHED ROCK OR SAND BEDDING 75mm THICK & PIPES BACKFILLED WITH COMPACTED SAND TO 300mm ABOVE TOP OF PIPE. ELITE ATTACHED TO UNDERSIDE OF STRUCTURE AT 600mm c/c AS NECESSARY.
13. PIPE ROUTES SHOWN ARE INDICATIVE ONLY AND SHOULD BE AS NECESSARY ACCORDING TO SITE CONDITIONS, TERRAIN POSITIONS ETC. CONFIRM SIGNIFICANT CHANGES IN PIPES SYSTEM DETAILS WITH SUPERVISING ENGINEER PRIOR TO COMMENCEMENT OF DRAINAGE CONSTRUCTION WORKS.
14. CONTRACTOR SHALL ENSURE THAT SERVICES TO BUILDINGS NOT AFFECTED BY THE WORKS ARE NOT DISRUPTED. CONTRACTOR SHALL CONSTRUCT TEMPORARY SERVICES TO MAINTAIN EXISTING SUPPLY TO BUILDINGS WHERE REQUIRED. ONCE WORKS ARE COMPLETE AND COMPLETED THE CONTRACTOR SHALL REMOVE ALL TEMPORARY SERVICES AND MAKE GOOD ALL DISTURBED AREAS.
15. STORMWATER SYSTEM REQUIRES SIGNIFICANT MAINTENANCE DUE TO POTENTIAL HIGH POLLUTANT LOAD. FILTERS AND POLLUTANT TRAPS SHOULD BE CHECKED AFTER LARGE STORM EVENTS AND CLEANED EVERY 6 MONTHS.
16. PLUMBING AND DRAINAGE WORKS TO COMPLY WITH AS-3500, THE NATIONAL DRAINAGE & PLUMBING CODE.
17. WHERE POSSIBLE DRAINAGE LINES SHALL BE LAID IN AREAS PREVIOUSLY DISTURBED BY OTHER SITE WORKS AND FOLLOW TOPOGRAPHICAL FEATURES TO REDUCE IMPACT AND AVOID TREE ROOTS.
18. THIS STORMWATER MANAGEMENT PLAN HAS BEEN PREPARED FOR C.C. SUBMISSION TO COUNCIL AND DOES NOT NECESSARILY CONTAIN ALL APPROPRIATE INFORMATION TO PROCEED WITH THE PROJECT. THE PLUMBER/BUILDER FOR CONSTRUCTION, CONTACT TAYLOR CONSULTING FOR MORE INFORMATION.

SITE SYSTEM DESIGN DATA

LOT1 DATA

SITE AREA = 779 m²
EXIST. MODELLED IMPERVIOUS AREA = 69 % imp
EXIST. GRASSED FLOW LENGTH = 61 m
EXIST. GRASSED SLOPE = 30%

5 YR ARI = 29 l/s
20 YR ARI = 42 l/s
100 YR ARI = 49 l/s

LOT 2 DATA

SITE AREA = 1098 m²
EXIST. MODELLED IMPERVIOUS AREA = 2.5 % imp
EXIST. GRASSED FLOW LENGTH = 75 m
GRASSED SLOPE = 30%

5 YR ARI = 22 l/s
20 YR ARI = 41 l/s
100 YR ARI = 55 l/s

INTER-ALLOTMENT DRAINAGE PLAN

SCALE 1:200

NOTE: REFER TO DRIVEWAY PLAN & LONG-SECTION DWG
17817-1 FOR DRIVEWAY PLAN & SET OUT



OUR REF: 957A as-built redups

Date: 23-10-17

we have attended site on 5-10-17 and as built the newly constructed civil works. we hereby confirm the dimensions, features and levels confirmed hereon in red represents finished works.

Registered Surveyor
No.1605

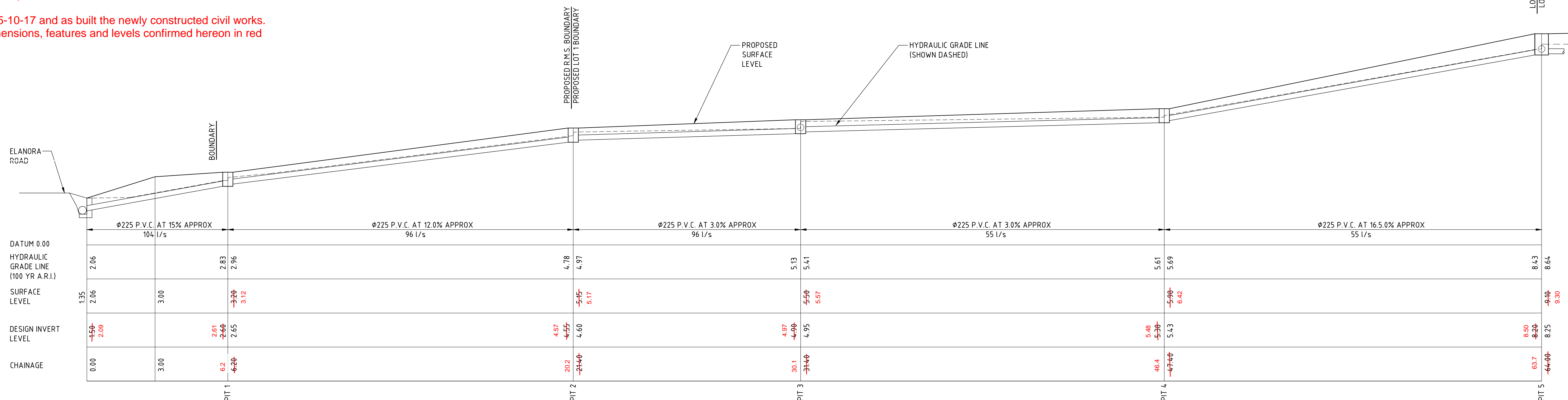

INTER-ALLOTMENT DRAINAGE LONG-SECTION

SCALE 1:100

CONSTRUCTION CERTIFICATE

Certificate No. SY170045C01
Date of Issue 29 May 2017
Issuing Officer *James By*
Accreditation No. BPP0565

These plans/specifications form part of the certificate issued 29 May 2017

ALL WORKS WITHIN THE EXISTING
ROAD RESERVE ARE EXCLUDED
FROM THIS APPROVAL

[illegible]

TITLE
INTER-ALLOTMENT DRAINAGE PLAN
1 ELANORA ROAD, ELANORA HEIGHTS

DRAWN

AV

DATE
20 APRIL 2017

CHECKED

SCALE @ A1
1:200
1:100

TAYLOR
CONSULTING
CIVIL & STRUCTURAL ENGINEERS

17817-2/C

Seascope Suite 7 22-26 Fisher Rd Dee Why NSW 2099 : T 02 9982 7092 : F 02 9982 5898 : enquire@taylorconsulting.net.au : www.taylorconsulting.net.au