

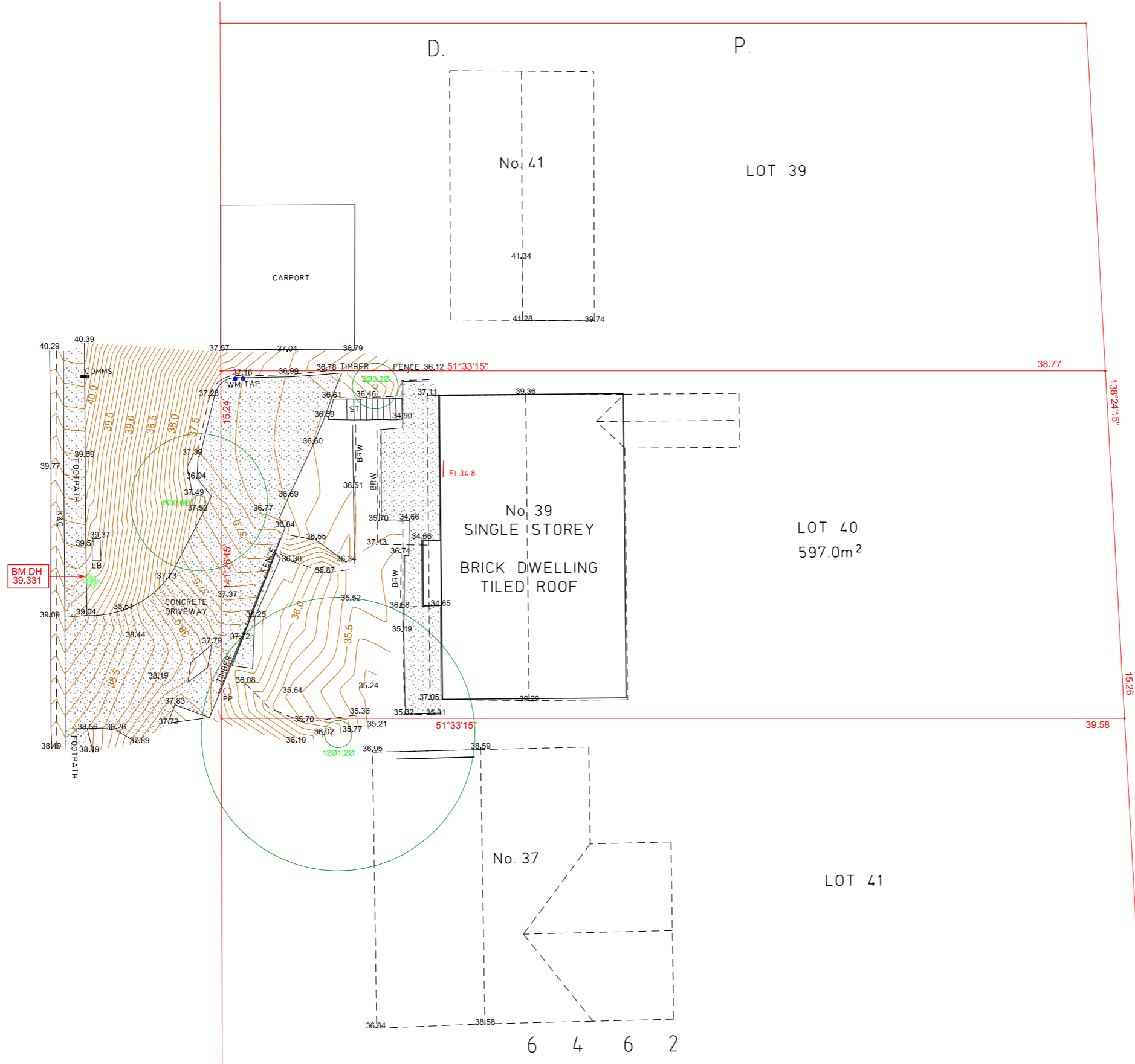

POWDERWORKS ROAD



NOTES

- * CO-ORDINATE SYSTEM IS MGA
- * ORIGIN OF LEVELS IS AUSTRALIAN HEIGHT DATUM (A.H.D.) DERIVED FROM PM5285 (SOURCE - SCIMS).
- * SPOT LEVELS & CONTOURS REPRESENT GENERAL GROUND LEVEL ONLY. THEY GIVE AN APPROXIMATE REPRESENTATION ONLY OF THE SHAPE AND LEVELS OF THE GROUND SURFACE. CONTOURS DO NOT REPRESENT THE PRECISE LEVEL AT ANY PARTICULAR POINT EXCEPT WHERE A SPOT LEVEL IS SHOWN. SHOULD CRITICAL DESIGN FACTORS BE IN EXISTENCE THEN IT MAY BE NECESSARY TO OBTAIN SUPPLEMENTARY LEVELS TO CONFIRM DESIGN CONSTRAINTS OR PARTICULARS. THE CONTOUR SHOWN HEREON IS 0.1 m.
- * CONTOURS ARE INTERPOLATED FROM SPOT LEVELS AS SHOWN & SHOULD BE USED AS A GUIDE ONLY. DO NOT RE-INTERPOLATE CONTOURS.
- * ONLY APPARENT SERVICES HAVE BEEN LOCATED BY SURVEY. NO SEARCH OF PUBLIC UTILITIES OR SUB-SURFACE INVESTIGATION HAS BEEN CARRIED OUT TO DETERMINE THE LOCATION OF ANY UNDERGROUND SERVICES.
- * RELATIONSHIP OF IMPROVEMENTS AND TREES TO BOUNDARIES HAVE BEEN ACCURATELY DETERMINED.
- * ROOF PROFILES, ROOF/GUTTER/EAVE LEVELS AND WINDOW INFORMATION SHOWN ARE APPROXIMATE ONLY.
- * PLEASE NOTE THAT A BOUNDARY DEFINITION SURVEY HAS BEEN UNDERTAKEN FOR THIS PLAN

LEGEND

- EB ELECTRICITY BOX
- WM WATER METER
- COMMS COMMUNICATIONS PIT
- 300.30 TREE SPREAD/TRUNK DIAMETER
- PP POWER POLE
- LP LIGHT POLE
- OHP OVERHEAD POWER LINE
- RRW ROCK RETAINING WALL
- BRW BRICK RETAINING WALL
- LW LOG RETAINING WALL
- BW BRICK WALL
- BLRW BLOCK RETAINING WALL
- TOB TOP OF BANK
- BOB BOTTOM OF BANK
- ST STEPS
- FL FLOOR LEVEL
- GFL GARAGE FLOOR LEVEL
- LB LETTER BOX
- VC VEHICLE CROSSING
- K&G BACK OF STANDARD KERB & GUTTER
- G TOP OF GUTTER RL & POSITION
- R RIDGE/ROOF HEIGHT
- W WINDOW
- H WINDOW / DOOR HEAD HEIGHT
- S WINDOW / DOOR SILL HEIGHT
- HARDSTAND
- GARDEN
- RETAINING WALL
- POST
- OVERHEAD POWER

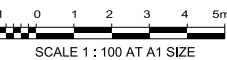

SCALE 1 : 100 AT A1 SIZE

DRAWN : DC	SURVEYOR : DC	C. ROBSON & ASSOCIATES PTY. LTD. LAND & ENGINEERING SURVEYORS	CHARTERS SURVEYING	39 POWDERWORKS ROAD NORTH NARRABEEN DETAIL SURVEY	
CHECKED : DC	DATE: JUN 2024				
CLIENT		Craig Robson B. Surv. R.S. M.L.S. (NSW) SURVEYOR REGISTERED UNDER THE SURVEYING AND SPATIAL INFORMATION ACT 2002	dcsurveying@outlook.com Ph. 0403 217 399	DRAWING NO:	REV:
					0