

DETAIL 01

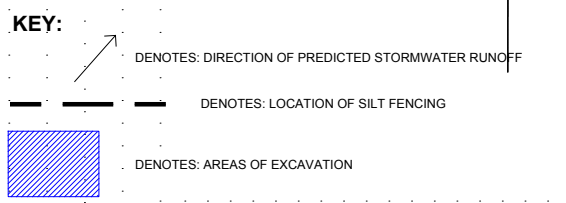

NOTE: DEMOLITION IS TO BE CARRIED OUT IN ACCORDANCE WITH THE RELEVANT PROVISIONS OF AUSTRALIAN STANDARDS 2601:2001: DEMOLITION OF STRUCTURES

SEDIMENT CONTROL PLAN 1:100 @ A1 OR 1:200 @ A3

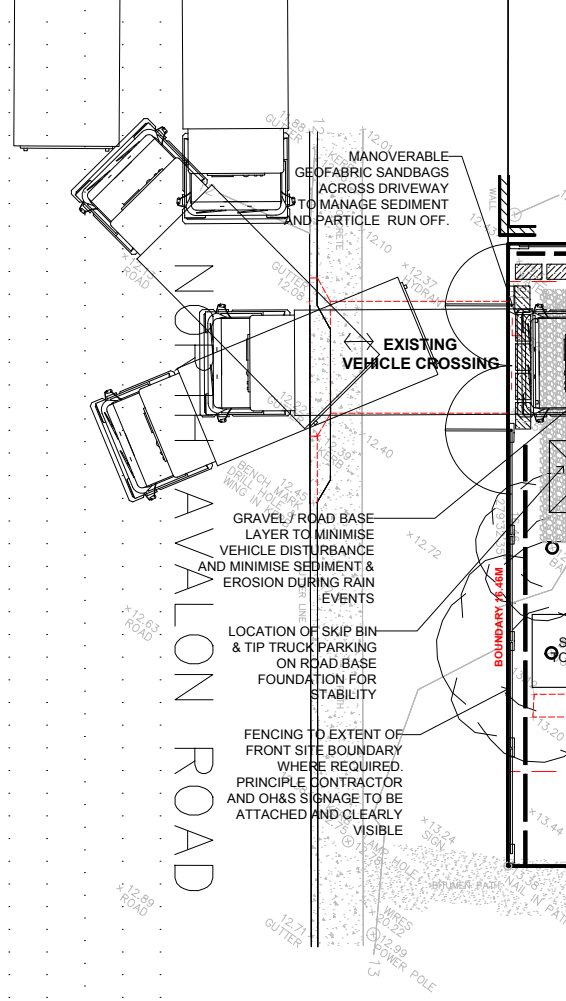
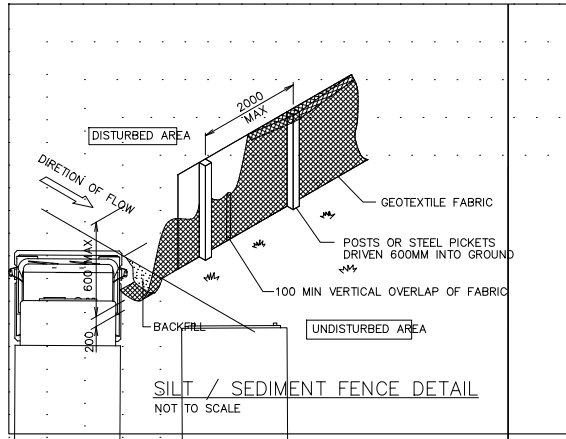
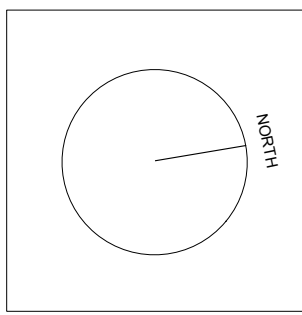

LEGEND:
 7.03 DENOTES EXISTING SPOT LEVEL
 RL 7.10 DENOTES PROPOSED LEVEL

NOTE: THESE DRAWINGS ARE NOT FOR CONSTRUCTION. CONCEPT DESIGN ONLY.
 NOTE: DO NOT SCALE OFF THIS DRAWING
 NOTE: ALL WORKS TO BE IN ACCORDANCE WITH THE NCC.
 NOTE: ALL WORKS TO BE IN ACCORDANCE WITH THE RELEVANT AUSTRALIAN STANDARDS.
 NOTE: ALL WORKS TO BE IN ACCORDANCE WITH THE BASIX REQUIREMENTS

KEY:
 ■ DENOTES PROPOSED WALL TO BE CONSTRUCTED
 □ DENOTES EXISTING WALL TO REMAIN
 - - - DENOTES EXISTING WALL TO BE REMOVED
 ■ DENOTES AREA OF PROPOSED ADDITION
 ■ DENOTES AREA OF PROPOSED ALTERATION TO EXISTING DWELLING
 ■ DENOTES AREA OF PROPOSED SOFT LANDSCAPE AREA

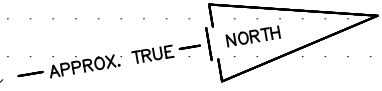

D.P. 8394
15

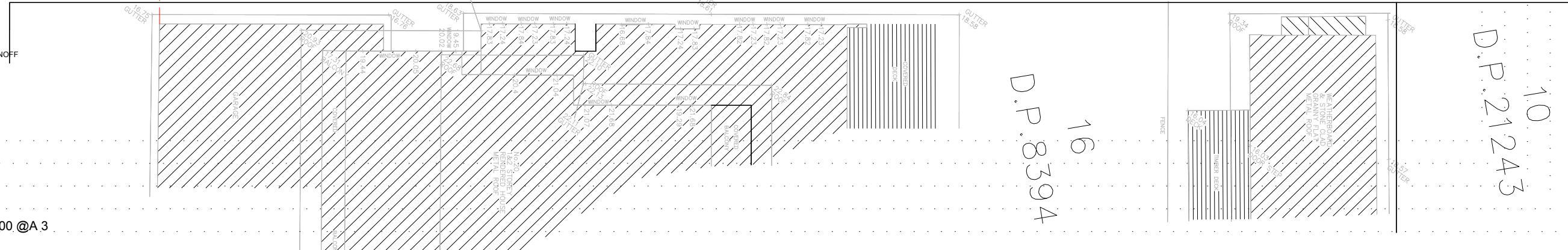
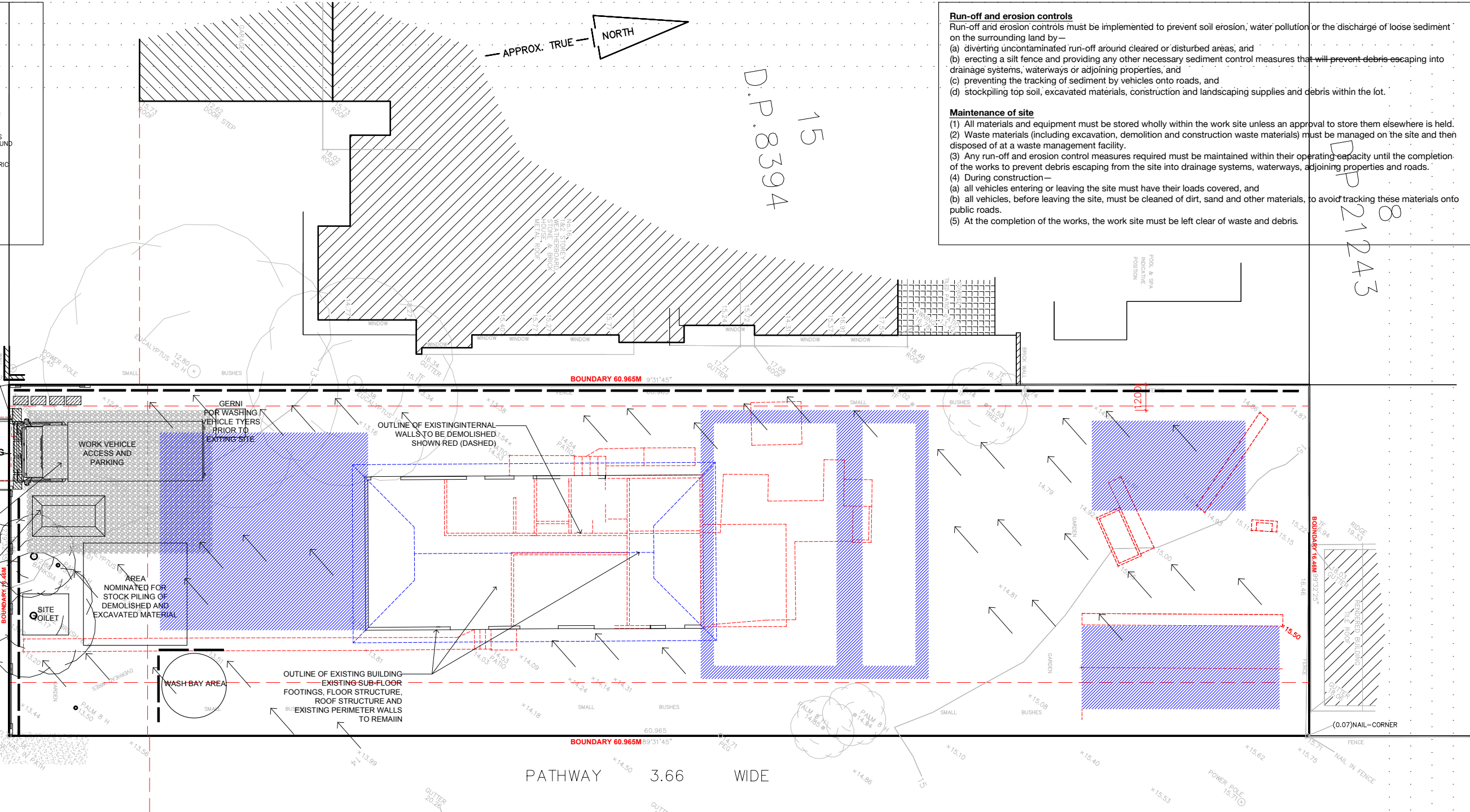

D.P. 8394
16

D.P. 21243
10

NOTES:
Run-off and erosion controls
 Run-off and erosion controls must be implemented to prevent soil erosion, water pollution or the discharge of loose sediment on the surrounding land by—
 (a) diverting uncontaminated run-off around cleared or disturbed areas, and
 (b) erecting a silt fence and providing any other necessary sediment control measures that will prevent debris escaping into drainage systems, waterways or adjoining properties, and
 (c) preventing the tracking of sediment by vehicles onto roads, and
 (d) stockpiling top soil, excavated materials, construction and landscaping supplies and debris within the lot.
Maintenance of site
 (1) All materials and equipment must be stored wholly within the work site unless an approval to store them elsewhere is held.
 (2) Waste materials (including excavation, demolition and construction waste materials) must be managed on the site and then disposed of at a waste management facility.
 (3) Any run-off and erosion control measures required must be maintained within their operating capacity until the completion of the works to prevent debris escaping from the site into drainage systems, waterways, adjoining properties and roads.
 (4) During construction—
 (a) all vehicles entering or leaving the site must have their loads covered, and
 (b) all vehicles, before leaving the site, must be cleaned of dirt, sand and other materials, to avoid tracking these materials onto public roads.
 (5) At the completion of the works, the work site must be left clear of waste and debris.

PROJECT:
 PROPOSED ALT'S & ADD'S TO EXISTING DWELLING INC. SWIMMING POOL, DETACHED POOL HOUSE & ASSOCIATED LANDSCAPING

CLIENT:
 PADOVAN

LOCATION:
 18 NORTH AVALON RD, AVALON BEACH, NSW.

PROJECT STAGE:
 DA

DRAWING TITLE:
 SITE PLAN

SCALE:
 1:100 @ A3

DATE OF ISSUE:
 29.03.2024

DRAWING NO.
 DA-000

REVISION:
 -

RAW
 D AND C

Daniel Raymond Architect NSW Reg. #9788 dan@rawdandc.com 0409 369 275
 Travers Williams Builder Lic No. 235416C trav@rawdandc.com 0421 904 523

NOTE: THIS DRAWING IS NOT TO BE USED OR REPRODUCED IN ANY FORM WITHOUT CONSENT. DO NOT SCALE FROM THIS DRAWING