

TRAFFIC MANAGEMENT PLAN

NORTHSIDE CONSTRUCTIONS

24 Darley Street East Mona Vale

November 2021

EXCAVATION & CONSTRUCTION



Tel: 0414 994 726

E-mail: Peter@pwtp.com.au

Web: pwtp.com.au

Address: PO BOX 4024, Lake Haven, NSW 2163

CONTROL SHEET – SUMMARY UPDATES

1. Insert new or revised sheets into the section of the TMP and remove/destroy any superseded sheets
2. Record revision, date and brief description immediately after the TMP is updated
- 3.

[illegible]

TABLE OF CONTENTS

1.0	INTRODUCTION	4
1.1	Purpose.....	5
1.2	Scope of Work.....	5
1.3	Application.....	6
1.4	Abbreviation and Terminology.....	6
2.0	DISTRIBUTION CONTROL & APPROVAL OF THIS PLAN	6
2.1	Approval & Changes.....	6
3.0	CONDITIONS & APPROVAL RESPONSE	8
4.0	STAGING PLANS, PROPOSED SEQUENCE OF WORKS	8
4.1	Work Area – 24 Darley Street East Mona Vale.....	8
5.0	PROPOSED PROGRAMME	9
5.1	Managing Cumulative Impacts.....	9
5.2	Work Area Assessment & Impacts.....	9
5.3	Work Area – Assess and Egress for Construction Vehicles.....	10
6.0	OTHER TMP REQUIREMENTS	12
6.1	Provision for other users.....	12
6.2	Hours of Operation.....	12
	Annexures	
	TCP 01092021 Excavation	13
	TCP 01082021 Construction	14
	VMP.....	15

1.0

INTRODUCTION

The Project located at 24 Darley Street East, Mona Vale comprises of the excavation and the construction of a new Residential Care facility as per DA2019/0860. Demolition of the existing structure will be completed prior to excavation with a separate CTMP already being completed. The construction site is located on the Northern side of Darley Street East Mona Vale and is completely surrounded by existing driveways as per Diagram 1.

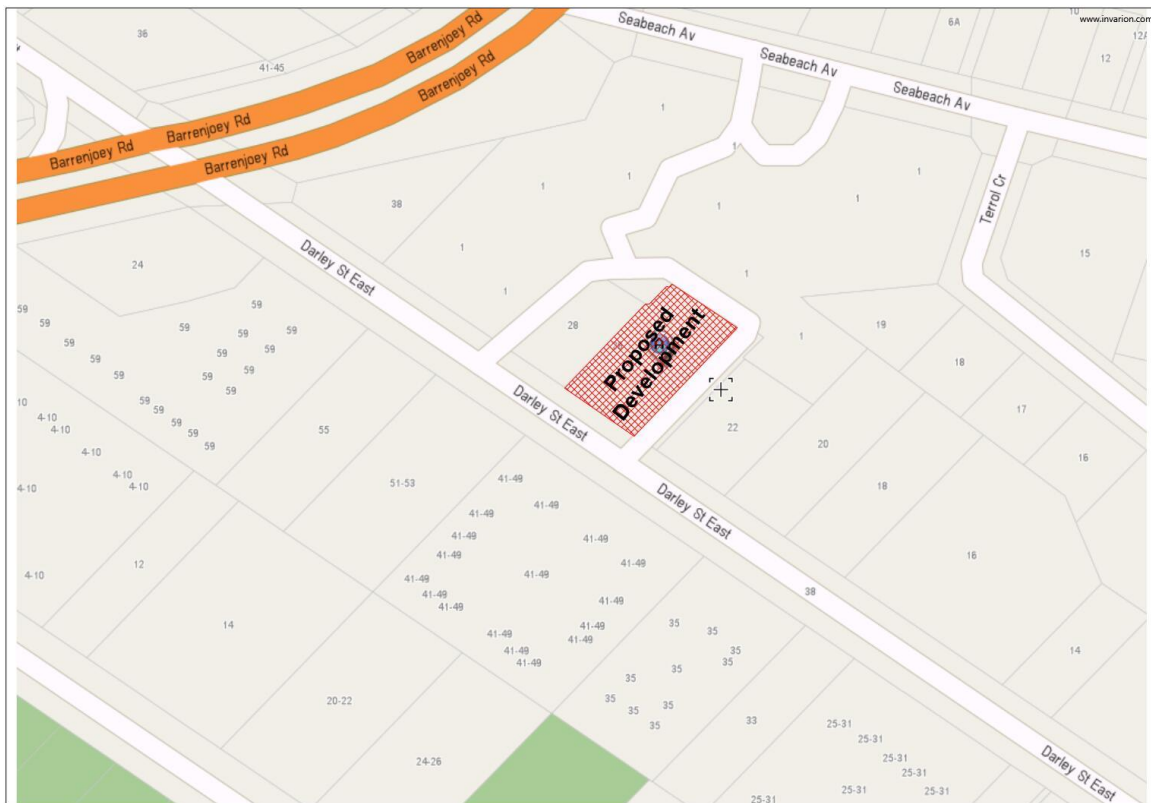

Diagram 1(Source: street-directory.com.au)

The Traffic Management plan addresses the conditions, approval requirements for this project, as well as the excavation and construction works proposed by Northside Constructions.

The objective of the plan is to ensure that the Traffic issues and the construction movement of both plant and equipment are managed with minimal impact to motorists, pedestrians and local residents and complies with the requirements of all relevant authorities including TfNSW, Northern Beaches Council and the Emergency Services.

Through a consultative approach between Northside Constructions and PW Traffic Plans, this plan details the best way to manage traffic issues associated with this project.

1.1

PURPOSE

The purpose of the Traffic Management Plan is to ensure that the planned works adhere to and comply with the Authority requirements for the Control of movement of excavation and construction vehicles (Plant & Equipment) around the Project and adjacent transport corridors. Specifically, this plan must recognize, be consistent with and comply with the traffic configuration of the local road network as it exists at varying stages, during the project.

In addition to the Authority requirements, this plan must also comply with:

- The requirements of relevant authorities, including TfNSW, Northern Beaches Council, NSW Police and State Emergency Services;
- Road Act 1993 (NSW) and all other legislative requirements;
- Certificates, licenses, consents, permits and approvals, including in respect of working hours;

This plan will provide:

- Detailed traffic management procedures for the site;
- Traffic control plan detailing modification to existing Traffic patterns vehicular and pedestrians. (Attached)
- Ensure the appropriate notification of relevant emergency services prior to implementing road and pedestrian traffic modifications;
- Safety of Pedestrians, Commuters, Cyclists and personnel of both Northside Constructions and its sub-contractors;
- Impacts on residents and/or commercial enterprises on traffic routes (including traffic movement);
- Objectives for Material delivery management & transportation to and from site;
- Roles and responsibilities of personnel and sub-contractors;
- Updating of the Traffic Management Plan on an as needs basis;

1.2

SCOPE OF WORK

The main element of the work in respect to traffic management is;

- Traffic Management while demolition vehicles are entering and exiting the work zones;
- Control of movement of vehicles carrying excavation and construction plant/equipment around the Project and adjacent traffic corridors;
- Plan must recognize, be consistent with and comply with the traffic configuration of the local road network as it exists at varying stages, during the project;

1.3

APPLICATION

All delivery drivers and sub-contractors of Northside Constructions shall comply with the requirements of this plan.

1.4

ABBREVIATIONS & TERMINOLOGY

The following terms, abbreviations and definitions are used in this Plan;

Terms	Explanation
TMP/Plan	Traffic Management Plan
VMP	Vehicle Movement Plan
PMP	Pedestrian Movement Plan
JPM	Junior Project Manager
TfNSW	Transport for New South Wales
TMC	TfNSW - Traffic Management Centre
NBC	Northern Beaches Council

2.0

DISTRIBUTION CONTROL & APPROVAL OF THIS PLAN

2.1 Approval & Changes

Approval of Plan

Record of Issue, Review and Approval of plan will be via NBC and Northside Constructions.

Issue of Plan

Northside Constructions Site Manager will ensure the Approved Plan is available to all personnel.

The most current version of the plan was issued on 13/03/2023. Copies of the TMP and TCP's are to be available from the site office. Laminated copies of the TCP's will be placed on the walls of the induction room.

Changes to the TMP

No changes to this TMP are permitted, with any changes to be provided in a new TMP to be approved by NBC.

Distribution Policy

Controlled copy of the TMP is held by Northside Constructions. All company employees have access to this plan through the Site Manager. The list of holders of controlled copies of the plan includes;

COPY NO	ISSUED TO	ISSUE DATE	ISSUED BY
01	Project Manager	13/03/2023	PW Traffic Plans
02	Site Manger	13/03/2023	PW Traffic Plans
03	Cadet	13/03/2023	PW Traffic Plans
04			
05			
06			

The personnel to whom these copies have been issued will be sent amendments as they occur.

Uncontrolled Copies

Uncontrolled copies will now be issued amendments.

Acknowledgement of receipt

If a controlled copy of the Traffic Management Plan has been issued, acknowledgement of its receipt is to be sent to the Site Manager within seven days to ensure further amendments are received.

3.0

CONDITIONS OF APPROVED RESPONSE

The checklist detailing the verification process to ensure contract requirements have been met in this Traffic Management Plan for the Conditions of Approval listed below:

CONDITIONS OF APPROVAL	WHERE ADDRESSED
Traffic Management Plan (TMP) has been prepared in consultation with relevant Northside Constructions personnel. The TMP must include information on the following matters relating to the project: a) Including the staging of demolition works to minimize traffic and pedestrian delays	All Sections
b) The impact on pedestrians including measures to ensure safety to pedestrians at all times;	Section 5.3
c) Maximum and average truck volumes	Section 5.3
d) Truck ingress and egress routes	Section 5.3
e) Access, for construction vehicles entering and leaving work area;	Section 5.3
f) No heavy vehicle queuing on public roads unless otherwise agreed by the NBC and/or TfNSW	Section 5.2
g) Construction traffic generation	Section 5.3
h) A response plan which sets out the proposed response to any traffic, construction or other incident.	Section 5.3
i) Proposed traffic control within the TCP	ATTACHED
j) Measures to manage traffic flows around the area affected by the Project, including as required traffic control devices necessary for the implementation of the TCP's.	Section 5.3
The performance of all project traffic arrangements must be monitored during construction. Any additional traffic and transport management measures as Required by the TfNSW shall form part of the TMP.	

4.0 STAGING PLANS, PROPOSED SEQUENCE OF WORKS

The Work Area listed below, itemized on site activity (in relation to proposed works) and relate to Traffic Control sequences.

4.1 WORK AREA – 24 Darley Street East, Mona Vale

Date	Area	Activity
March 2023	WA1	Excavation
May 2023	WA1	Construction

5.0

PROPOSED PROGRAMME

The approximate program for implementation of the work area is as follows:

WORK AREA	START DATE	FINISH DATE
Excavation	March 2023	May 2023
Construction	May 2023	May 2024

5.1 Managing Cumulative Impacts

Spoil from excavation shall be loaded entirely within the site boundaries. There is no queuing on Darley Street East, Barrenjoey Road or any other surrounding roads. Any large deliveries will need to be organized in advance to reduce any cumulative congestion impacts attributed to Traffic.

The site manager is responsible for monitoring Traffic conditions. In the event that construction Traffic impacts do have a negative impact on the road network, Northside Constructions shall liaise with NBC to solve the problem.

5.2 Work Area Assessment and Impacts

This section details the requirements for the Construction Site.

Darley Street East is a 4 lane 2-way road consisting of 2 through lanes and 2 parking lanes. The speed limit on Darley Street East is 50Km/h and it runs in a South East – North West direction.

There is no onsite parking for vehicles during excavation however minimal employees will be on site during this stage. Sub-contractors are to be advised that they should utilize public transport wherever possible. Once the basement area has been constructed it will be utilized for contractor parking.

There will be a works zone required during excavation & demolition. All spoil from excavation is to be loaded entirely within the site boundaries. For excavation Truck and dog vehicles will be used.

Excavation vehicles will drive into the site from the Eastern driveway and exit from the Western driveway. All construction related deliveries will be loaded and unloaded from the construction zone via the tower crane. There will need to be Traffic control present as per the attached TCP's. The proposed works will generate additional minimal truck movements along the main access routes. Heavy vehicles movement shall be kept to minimum during school zone hours and during times of high pedestrian activity.

A notification must be provided to adjoining property owners a minimum of fourteen (14) days prior to the implementation of any temporary traffic control measures.

There are currently no other known construction sites within a 250m radius of this proposed work site, therefore there are no combined construction activities to plan for.

The roadway (inclusive of footpaths) must be kept in a serviceable condition for the duration of excavation and construction works. At the direction of NBC, the applicant is to undertake remedial treatments (such as patching) for any damaged roadways at no cost to NBC.

5.3 WORK AREA – ACCESS & EGRESS FOR CONSTRUCTION VEHICLES

Access

Excavation Vehicles are to approach as follows:

All vehicles are to approach either along Mona Vale Road turning left onto Pittwater Road or from along Pittwater Road and continue onto Barrenjoey Road, turning right onto Darley Street East, and then turning left via the Eastern driveway into the construction site (as per attached VMP).

Construction Vehicles are to approach as follows:

All vehicles are to approach either along Mona Vale Road turning left onto Pittwater Road or from along Pittwater Road and continue onto Barrenjoey Road, turning right onto Darley Street East, and then entering the construction zone (as per attached VMP).

Egress

Excavation Vehicles are to leave as follows:

Vehicles are to leave the construction site turning right onto Darley Street East where they will turn left onto Mona Vale Road and continue onto Pittwater Road, either turning right onto Mona Vale Road or continuing further along Pittwater Road to disperse to their intended destination (as per VMP).

Construction Vehicles are to leave as follows:

Vehicles are to leave the construction zone continuing along Darley Street East where they will turn left onto Surf View Road, turning left onto Seabeach Avenue, turning left onto Barrenjoey Road and continuing onto Pittwater Road, either turning right onto Mona Vale Road or continuing further along Pittwater Road to disperse to their intended destination (as per VMP).

Truck Volumes

Excavation vehicle volume is expected to be approximately 6 movements per day and construction vehicle volume is expected to be approximately 5 movements per day. There will be a number of concrete pours throughout construction with the largest requiring approximately 20 concrete trucks. Within the context of the surrounding broader road network, the abovementioned construction traffic activity will be distributed throughout the day. It is anticipated that the peak construction traffic activity will not generate any noticeable impacts on the surrounding road network operation.

Traffic Diversions

There will be no need for Traffic diversions for this project. The road must be fully opened to the public when works are completed at the end of each day.

No heavy vehicle queuing on public roads is allowed unless approved by the TfNSW and NBC. The Site Manager will provide strict instruction to all drivers during toolbox meetings and inductions.

Impact on Public Transport

No impact is expected on public transport. There are no Bus Routes in this area, the planned works will have no effect on any bus stops or bus routes in the area.

Pedestrians/Road Closures

Pedestrians will not be required to divert on Darley Street East as per the attached TCP, there will be isolated instances where they will be required to stop for short periods while Excavation enter and exit the driveway, and construction vehicles are loaded/unloaded from the construction zone under Traffic Controller guidance.

Traffic Control Requirements

All site access, egress and unloading zones will require traffic control in accordance with the Transport for New South Wales Guideline Traffic Control at Work Sites, and Australian Standards 1742.3 Manual of Uniform Traffic Control Devices, Part 3: Traffic Control Devices for works on Roads.

The main access, egress and unloading points for these works are via council or TfNSW roads. Safe and simple traffic control for all road users shall be provided at all site access points in accordance with standard requirements. (Refer to 5.2)

6.0

OTHER TMP REQUIREMENTS

6.1 Provisions for other users

TCP's must cater for all users affected by the demolition at 24 Darley Street East, Mona Vale. These users include but are not limited to cyclists and emergency vehicles.

6.2 Hours of Operation

The hours of Operation for Demolition and Excavation will be:

For Excavation

Monday to Friday	08.00am – 17.00pm
Saturday, Sunday & Public Holidays	No Work Permitted

For Construction

Monday to Friday	07.00am – 17.00pm
Saturday	08.00am – 13.00pm
Sunday & Public Holidays	No Work Permitted

This TMP is based on the information that was obtained from numerous sources.

This plan is presented by Peter Wieteki TfNSW PWZTMP Cert # TCT0058984 on behalf of PW Traffic Plans

Peter Wieteki

Peter Wieteki
PW Traffic Plans

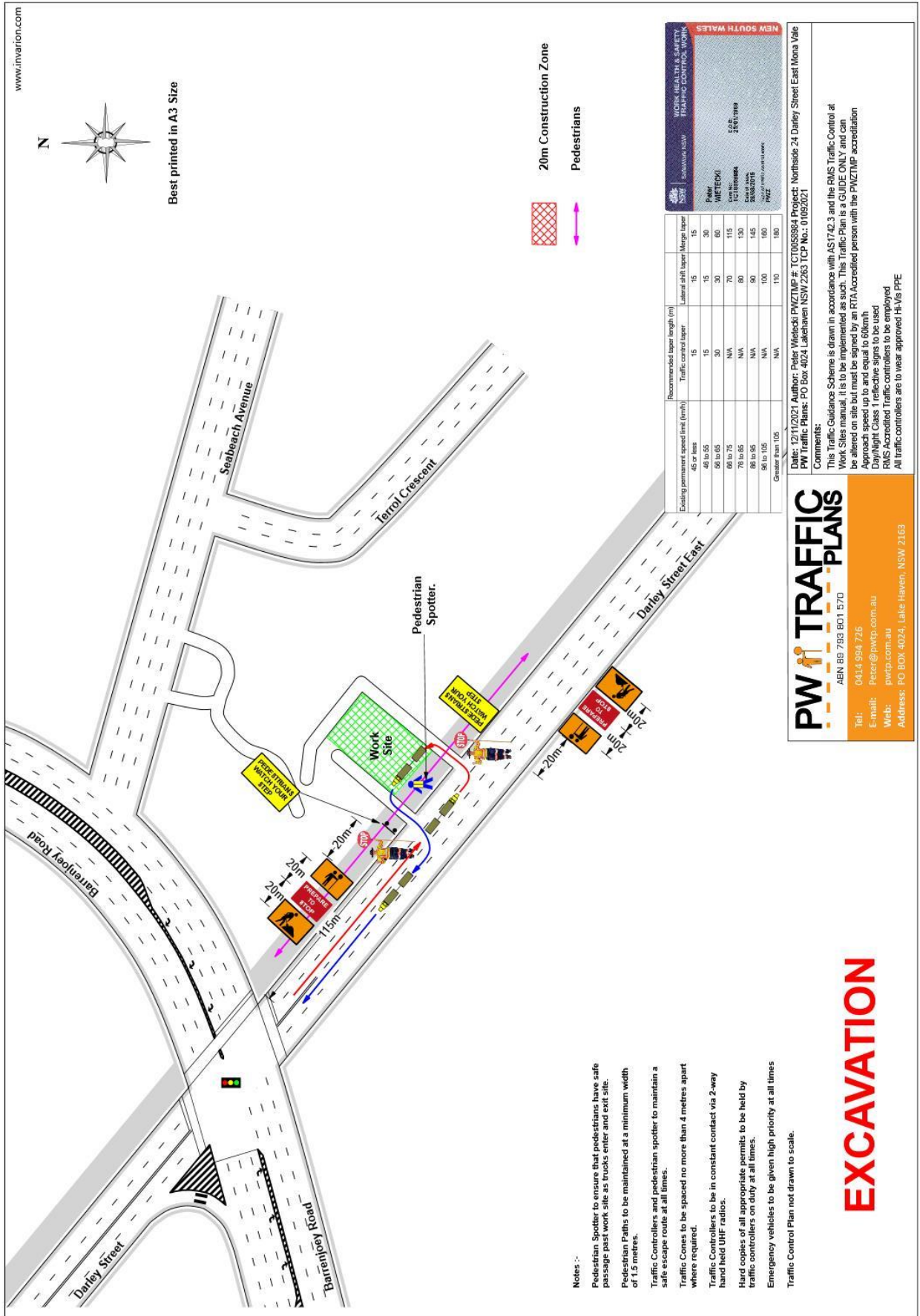



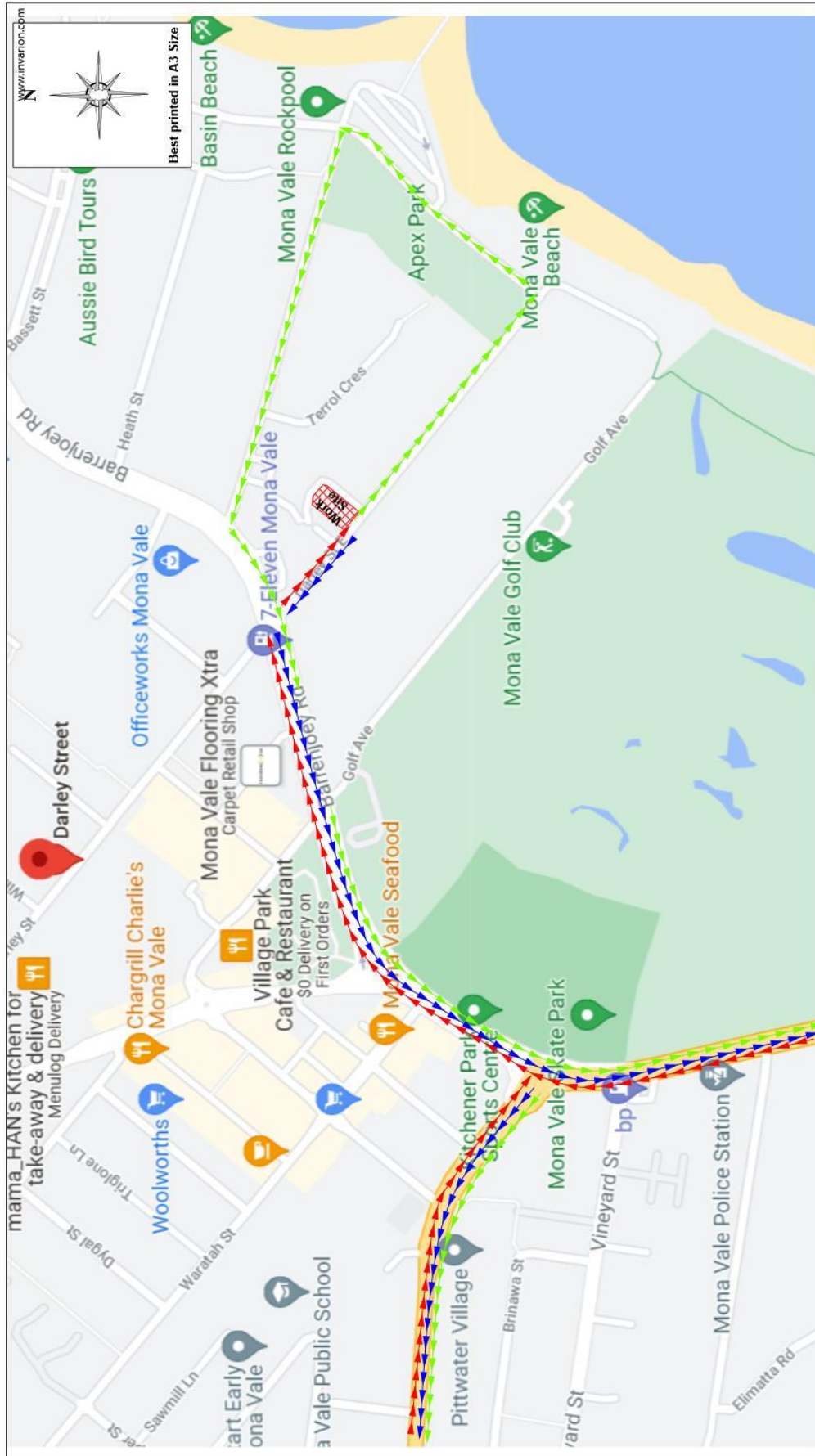

Construction Vehicle Ingress
Excavation Vehicle Egress
Construction Vehicle Egress

PW TRAFFIC PLANS
 ABN 69 793 801 570
 Tel: 0414 994 726
 Email: Peter@pwtp.com.au
 Web: pwtp.com.au
 Address: PO BOX 4024, Lake Haven, NSW 2163

Date: 12/11/2021 Author: Peter Wietecio PWZTMP # TCT0058884 Project: Northside 24 Darley Street East Monavale VMP
 PW Traffic Plans: PO Box 4024 Lakehaven NSW 2263 TCP No: 01072021

Comments:
 This Traffic Guidance Scheme is drawn in accordance with AS1742.3 and the RMS Traffic Control at Work Sites manual. It is to be implemented as such. This Traffic Plan is a GUIDE ONLY and can be altered on site but must be signed by an RTA Accredited person with the PWZTMP accreditation
 Approach speed up to and equal to 60km/h
 Day/Night Class 1 reflective signs to be used
 RMS Accredited Traffic controllers to be employed
 All traffic controllers are to wear approved H-VIS PPE