

DEVELOPMENT DETAILS

- SWIMMING POOL WATER CAPACITY IS LESS MORE 40 000 LITRES - 47,500 LITRES
- SPA WATER CAPACITY IS LESS THAN 40 000 LITRES - 4,700 LITRES
- SWIMMING POOL LOCATED IN REAR YARD
- SWIMMING POOL SAFETY FENCING & SWIMMING POOL SHALL COMPLY WITH;
- COUNCIL CODES
- BUILDING CODE OF AUSTRALIA
- SWIMMING POOLS ACT 1992-NO. 49
- SWIMMING POOL SAFETY AS 1926.1-2007
- SWIMMING POOL SAFETY AS 1926.2-2007
- SWIMMING POOL SAFETY AS AS1926.1-2012 AS APPLICABLE.
- ALL TREES TO BE REMOVED ARE EXCEMPT SPECIES AS LISTED ON NORTHERN BEACHES COUNCIL WEBSITE

POOL COPING LEVELS  
(RELATIVE TO EXISTING GROUND LEVELS)

- (A) -1000mm
- (B) +1150mm
- (C) -940mm
- (D) +1200mm

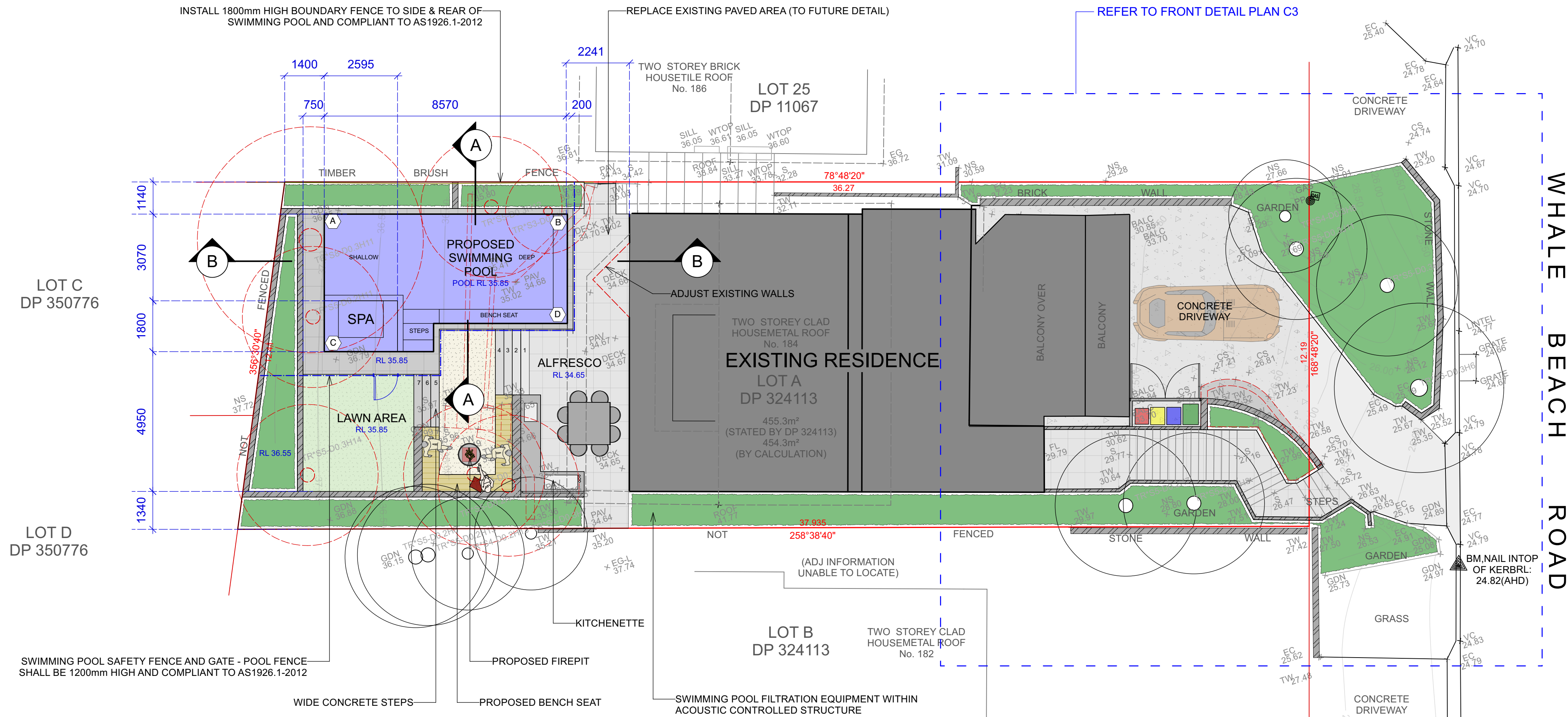

LEGEND

- LAWN AREA
- CONCRETE
- GARDEN AREA
- DECORATIVE PEBBLES
- OFF FORM CONCRETE STEPS
- PAVED AREA
- TIMBER DECKING
- TREE TO BE REMOVED
- TREE TO BE RETAINED

CONTOUR  
LANDSCAPE ARCHITECTURE

PO Box 698 MONA VALE NSW 1660  
Tel: 0434 500 705 - AIDLIM

PROJECT  
**Bonnici Residence**  
184 Whale Beach Road,  
Whale Beach NSW 2107

NOTES

comply with building code of australia and all relevant australian standards  
all works shall be in accordance with development application and construction certificate conditions of consent  
all levels to and  
refer to survey information relating to existing site data  
verify all dimensions prior to works  
do not scale from drawings  
use figured dimenitions in preference to scaling  
refer all discrepancies to landscape architect for determination  
this drawing is copyright and must not be retained, copied, used or reproduced in any way without prior written permission of  
contour landscape architects.

DATE	REV.	ISSUE
20/04/21	A	DRAFT
28/04/21	B	DRAFT
30/04/21	C	DRAFT
11/05/21	D	DRAFT
18/06/21	E	DA

DATE: 30/04/21  
  
SCALE: 1:100 @ A1  
1:200 @ A3  
  
DRAWN: LH

DRAWING  
SITE PLAN

DRAWING NO:  
C1  
  
REV:  
E

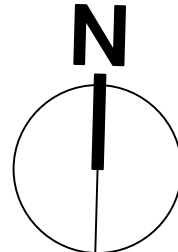

northern  
beaches  
council  
  
THIS PLAN IS TO BE READ IN  
CONJUNCTION WITH  
THE CONDITIONS OF DEVELOPMENT  
CONSENT  
  
DA2021/0976

EXISTING TIMBER RETAINING WALL TO REMAIN  
AND BE ADJUSTED TO SUIT PROPOSED LEVELS

EXISTING TIMBER PYLONS TO BE RETAINED

PROPOSED RETAINING WALL ATTACHED TO EXISTING  
RETAINING WALL (TO ENGINEERS DETAIL & SPECIFICATIONS)

PROPOSED DRAINAGE CAVITY  
BETWEEN WALL AND RETAINING WALL

LEGEND

- PROPOSED WALL
- WALL TO BE DEMOLISHED
- CARPET SURFACE TREATMENT
- TILED SURFACE TREATMENT
- INDOOR TIMBER SURFACE TREATMENT
- OUTDOOR TIMBER SURFACE TREATMENT

CONTOUR  
LANDSCAPE ARCHITECTURE

PO Box 698 MONA VALE NSW 1660  
Tel: 0434 500 705 - AIDLM

PROJECT  
**Bonnici Residence**  
184 Whale Beach Road,  
Whale Beach NSW 2107

NOTES  
comply with building code of australia and all relevant australian standards  
all works shall be in accordance with development application and construction certificate conditions of consent  
all levels to ahd  
refer to survey information relating to existing site data  
verify all dimensions prior to works  
do not scale from drawings  
use figured dimensions in preference to scaling  
refer all discrepancies to landscape architect for determination  
this drawing is copyright and must not be retained, copied, used or reproduced in any way without prior written permission of  
contour landscape architects.

DATE	REV.	ISSUE
18/05/21	A	DRAFT
19/05/21	B	REVISION
25/05/21	C	REVISION
18/06/21	D	REVISION
18/06/21	E	DA

DATE: 18/06/21  
SCALE: 1:100 @ A3  
DRAWN: LH

DRAWING  
**LOWER GROUND  
FLOOR PLAN**  
DRAWING NO:  
C2  
REV:  
E

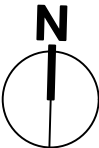

northern  
beaches  
council

THIS PLAN IS TO BE READ IN  
CONJUNCTION WITH  
THE CONDITIONS OF DEVELOPMENT  
CONSENT

DA2021/0976



LEGEND

- LAWN AREA
- CONCRETE
- GARDEN AREA
- DECORATIVE PEBBLES
- OFF FORM CONCRETE STEPS
- PAVED AREA
- TIMBER DECKING
- TREE TO BE REMOVED
- TREE TO BE RETAINED

PROPOSED BIN STORAGE LOCATION

REPLACE EXISTING PAVING WITH NEW TILE (TO FUTURE DETAIL)

PROPOSED BIN STORAGE ENCLOSURE (POTENTIAL GREEN ROOF)

PROPOSED RETAINING WALL TO SAME HEIGHT AS EXISTING

PROPOSED DRIVEWAY ADDITION

REMOVE EXISTING BALUSTRADE (SHOWN DASHED RED)

DEMOLISH EXISTING RETAINING WALL (SHOWN DASHED RED)

REPLANT EXISTING GARDEN AREA

REPLANT EXISTING GARDEN AREA

BM,NAIL INTO  
TOP OF KERB:  
24.82(AHD)

northern  
beaches  
council

THIS PLAN IS TO BE READ IN  
CONJUNCTION WITH  
THE CONDITIONS OF DEVELOPMENT  
CONSENT

DA2021/0976

CONTOUR  
LANDSCAPE ARCHITECTURE

PO Box 698 MONA VALE NSW 1660  
Tel: 0434 500 705 - AIDL

PROJECT  
**Bonnici Residence**  
184 Whale Beach Road,  
Whale Beach NSW 2107

NOTES

comply with building code of australia and all relevant australian standards  
all works shall be in accordance with development application and construction certificate conditions of consent  
all levels to ahd  
refer to survey information relating to existing site data  
verify all dimensions prior to works  
do not scale from drawings  
use figured dimensions in preference to scaling  
refer all discrepancies to landscape architect for determination  
this drawing is copyright and must not be retained, copied, used or reproduced in any way without prior written permission of  
contour landscape architects.

DATE	REV.	ISSUE
11/05/21	A	DRAFT
18/06/21	B	DA

DATE: 23/06/21

SCALE: 1:50 @ A1  
1:100 @ A3

DRAWN: LH

DRAWING  
**FRONT DETAIL PLAN**

DRAWING NO:  
C3

REV:  
B

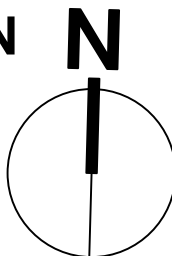

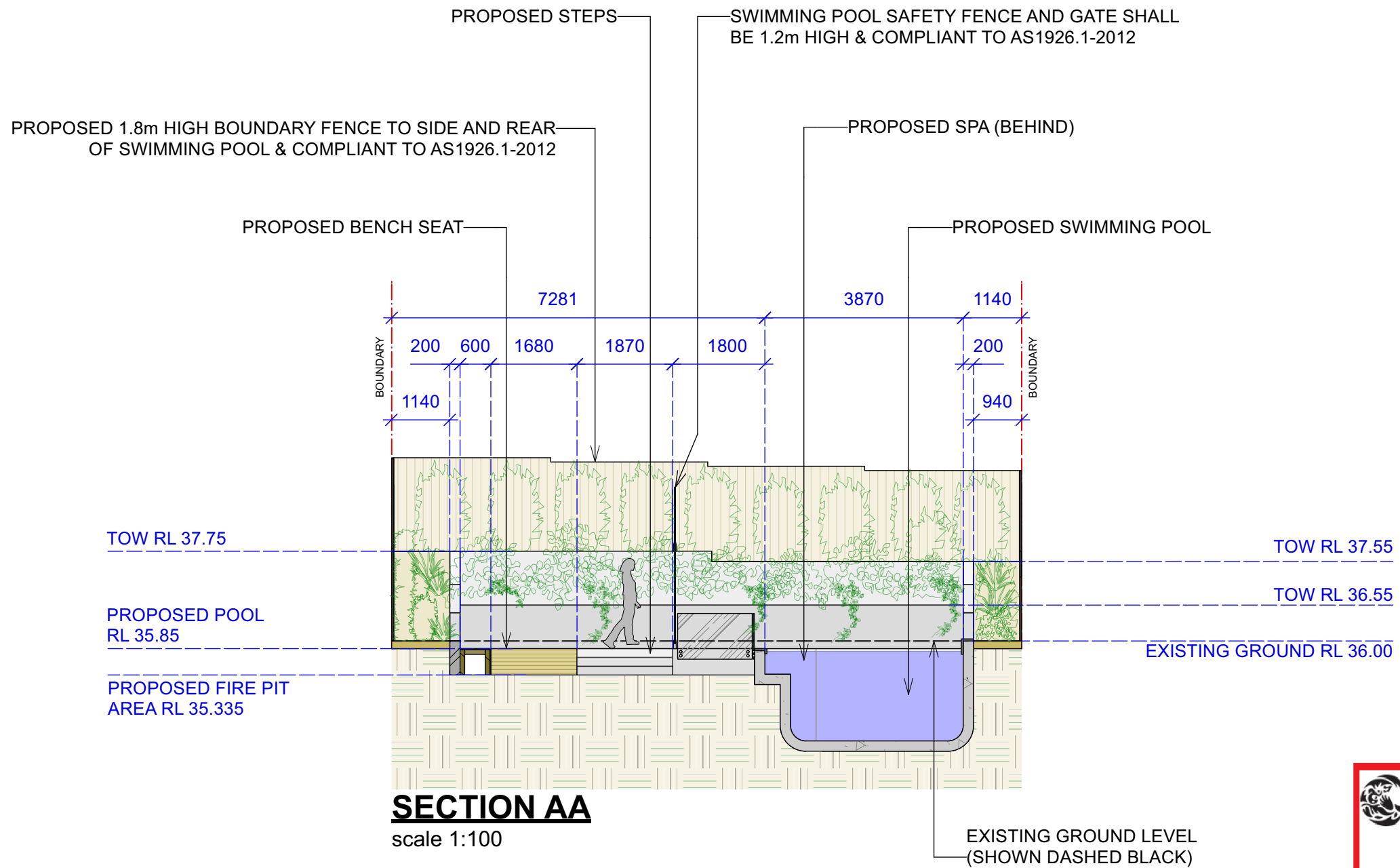

 northern  
beaches  
council

**THIS PLAN IS TO BE READ IN  
CONJUNCTION WITH  
THE CONDITIONS OF DEVELOPMENT  
CONSENT**

**DA2021/0976**

**CONTOUR**  
LANDSCAPE ARCHITECTURE

PO Box 698 MONA VALE NSW 1660  
Tel: 0434 500 705 - AIDLM

PROJECT

**Bonnici Residence**

184 Whale Beach Road,  
Whale Beach NSW 2107

NOTES

comply with building code of australia and all relevant australian standards  
all works shall be in accordance with development application and construction certificate conditions of consent  
all levels to ahd  
refer to survey information relating to existing site data  
verify all dimensions prior to works  
do not scale from drawings  
use figured dimensions in preference to scaling  
refer all discrepancies to landscape architect for determination  
this drawing is copyright and must not be retained, copied, used or reproduced in any way without prior written permission of  
contour landscape architects.

DATE	REV.	ISSUE
02/06/21	A	DRAFT
18/06/21	B	DA

DATE:	18/06/21	DRAWING
SCALE:	1:100 @ A3	<b>SECTION AA</b>
DRAWN:	LH	DRAWING NO:
		C4
		REV:
		B

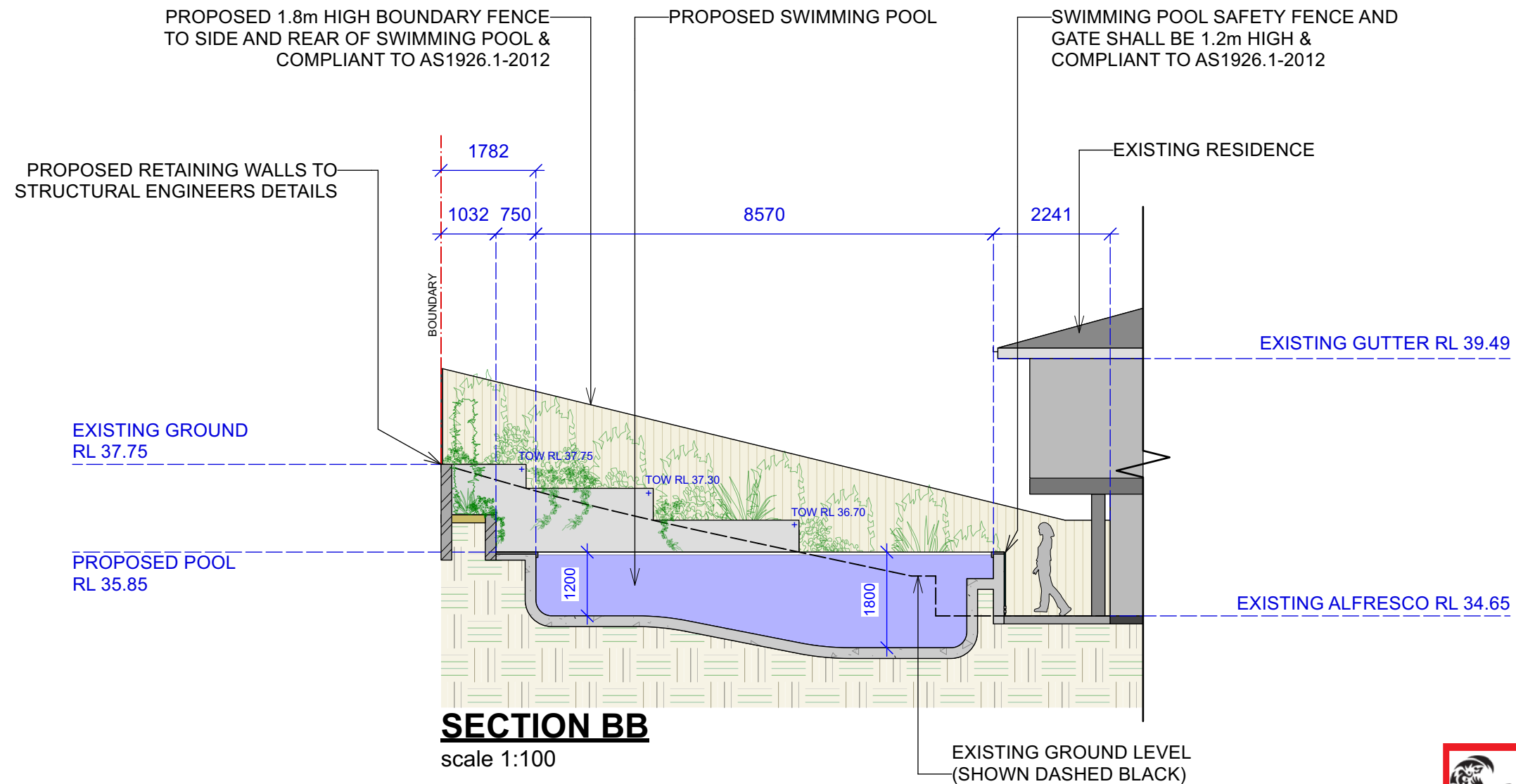

**THIS PLAN IS TO BE READ IN  
CONJUNCTION WITH  
THE CONDITIONS OF DEVELOPMENT  
CONSENT**

**DA2021/0976**

**CONTOUR**  
LANDSCAPE ARCHITECTURE

PO Box 698 MONA VALE NSW 1660  
Tel: 0434 500 705 - AIDLM

PROJECT

**Bonnici Residence**

184 Whale Beach Road,  
Whale Beach NSW 2107

NOTES

comply with building code of australia and all relevant australian standards  
all works shall be in accordance with development application and construction certificate conditions of consent  
all levels to ahd  
refer to survey information relating to existing site data  
verify all dimensions prior to works  
do not scale from drawings  
use figured dimensions in preference to scaling  
refer all discrepancies to landscape architect for determination  
this drawing is copyright and must not be retained, copied, used or reproduced in any way without prior written permission of  
contour landscape architects.

DATE REV. ISSUE

02/06/21 A DRAFT

18/06/21 B DA

DATE: 18/06/21

SCALE: 1:100 @ A3

DRAWN: LH

DRAWING  
**SECTION BB**

DRAWING NO:  
C5

REV:  
B

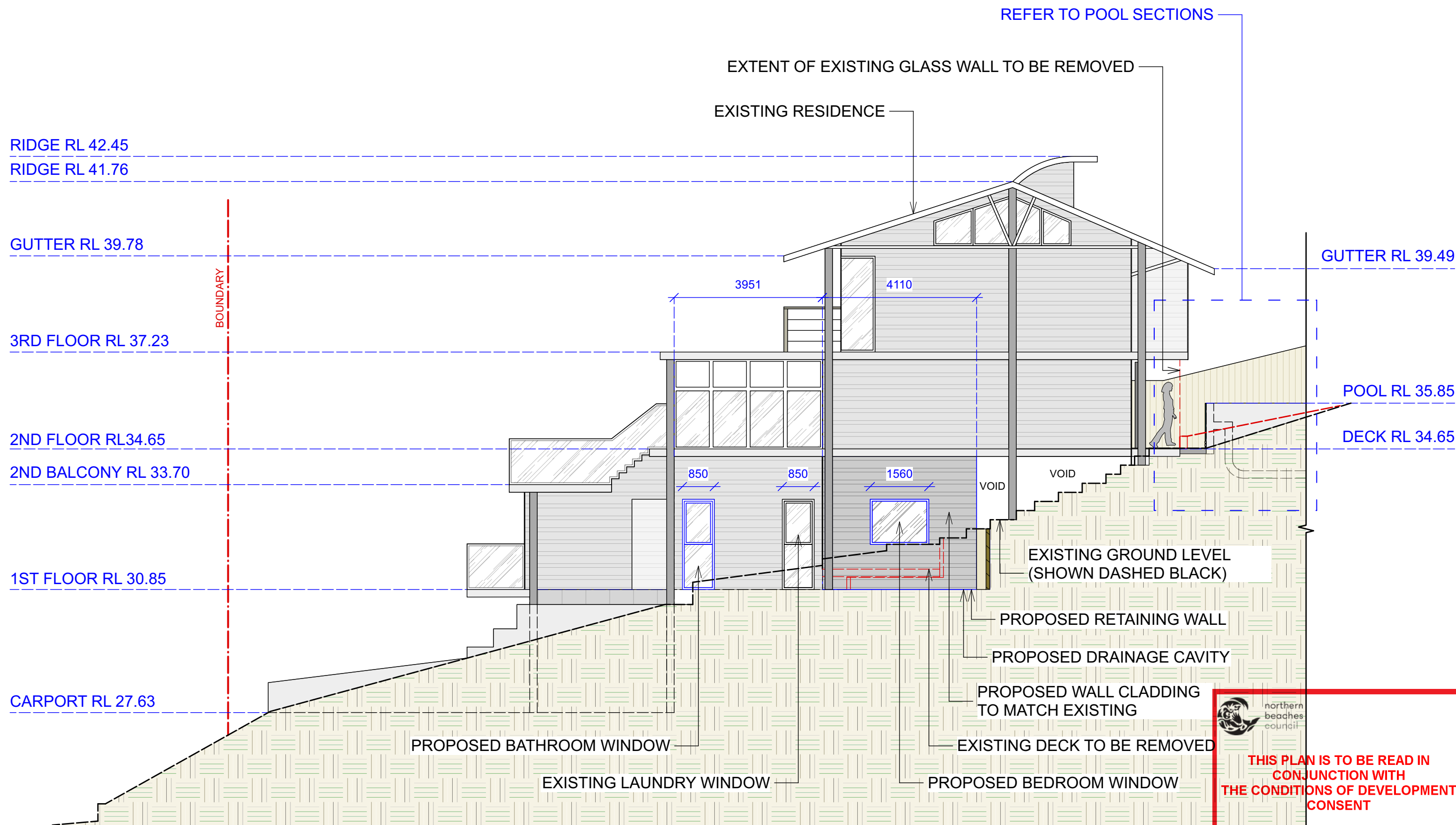

 **northern  
beaches  
council**

**THIS PLAN IS TO BE READ IN  
CONJUNCTION WITH  
THE CONDITIONS OF DEVELOPMENT  
CONSENT**

**DA2021/0976**

**CONTOUR**  
LANDSCAPE ARCHITECTURE  
PO Box 698 MONA VALE NSW 1660  
Tel: 0434 500 705 - AIDLM

PROJECT  
**Bonnici Residence**  
184 Whale Beach Road,  
Whale Beach NSW 2107

NOTES  
comply with building code of australia and all relevant australian standards  
all works shall be in accordance with development application and construction certificate conditions of consent  
all levels to ahd  
refer to survey information relating to existing site data  
verify all dimensions prior to works  
do not scale from drawings  
use figured dimensions in preference to scaling  
refer all discrepancies to landscape architect for determination  
this drawing is copyright and must not be retained, copied, used or reproduced in any way without prior written permission of  
contour landscape architects.

DATE	REV.	ISSUE
18/06/21	A	DA

DATE:	18/06/21	DRAWING
		<b>NORTH ELEVATION</b>
SCALE:	1:100 @ A3	DRAWING NO:
		C6
DRAWN:	LH	REV:
		B



Sun Angles

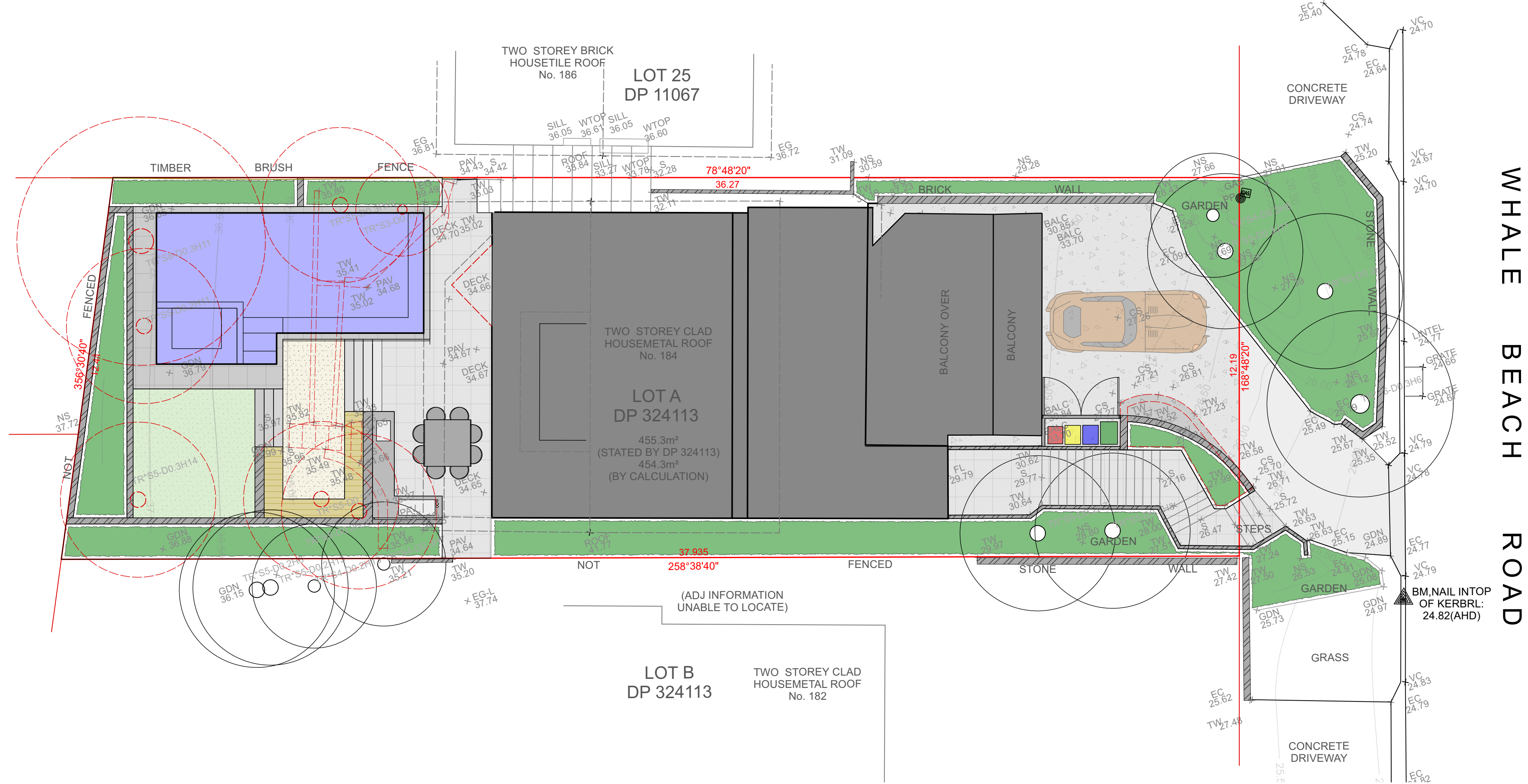
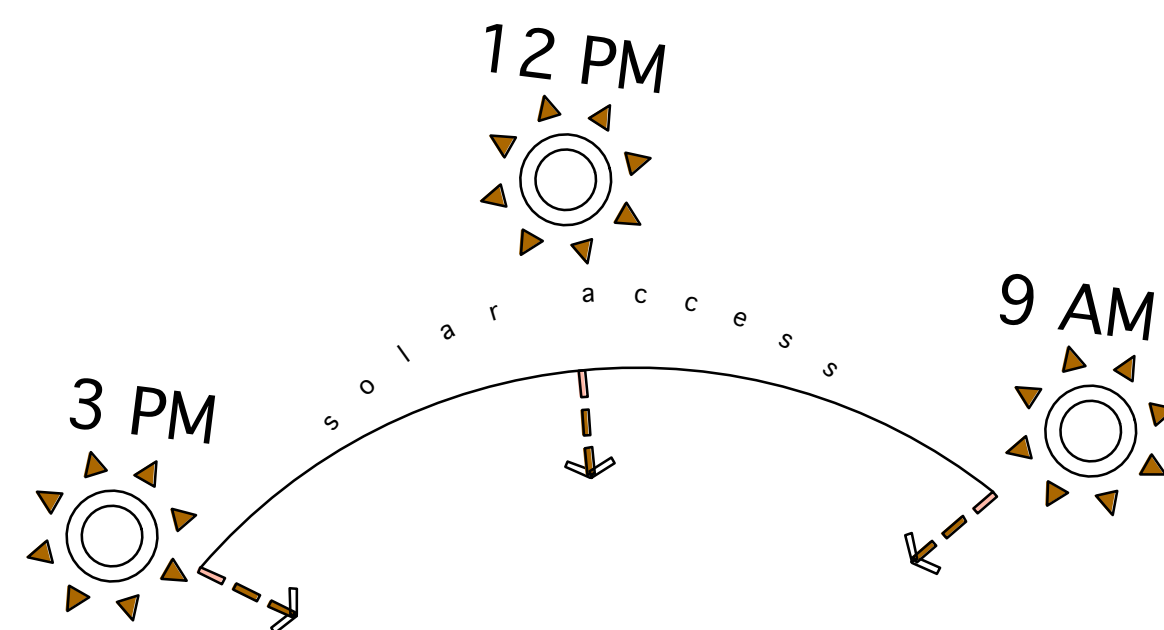
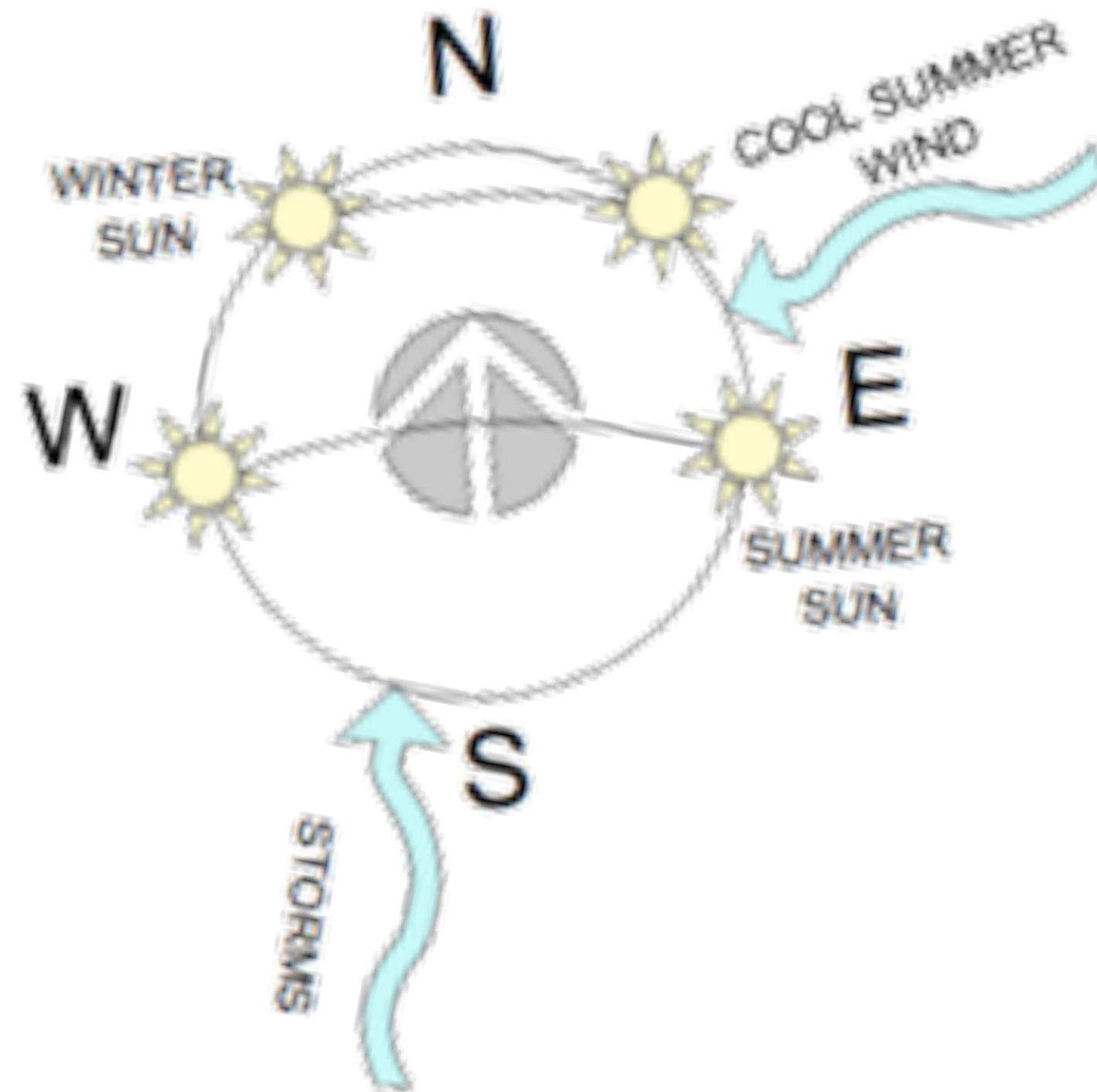
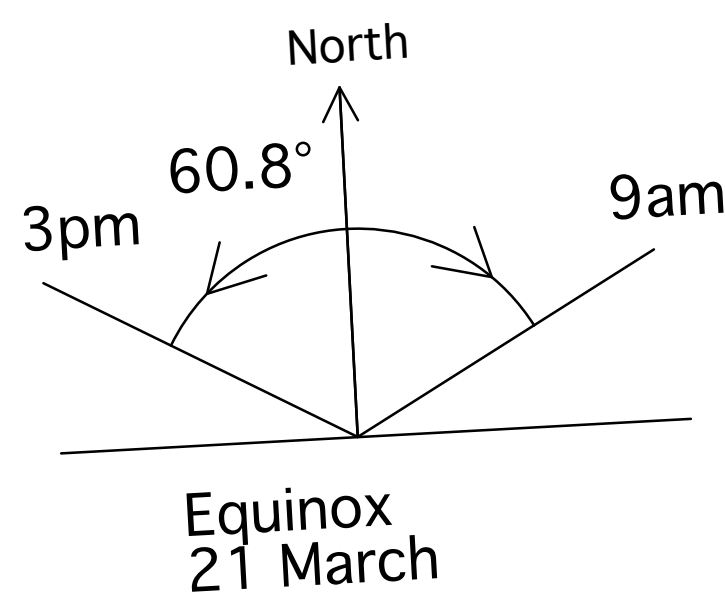
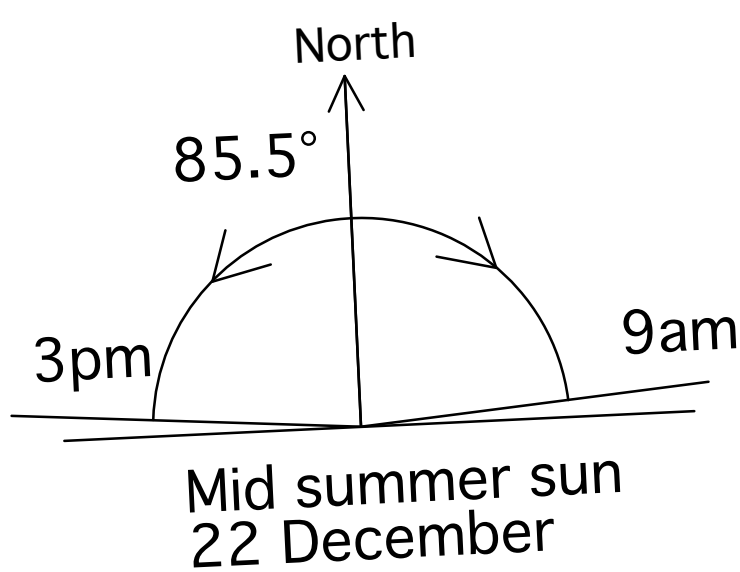
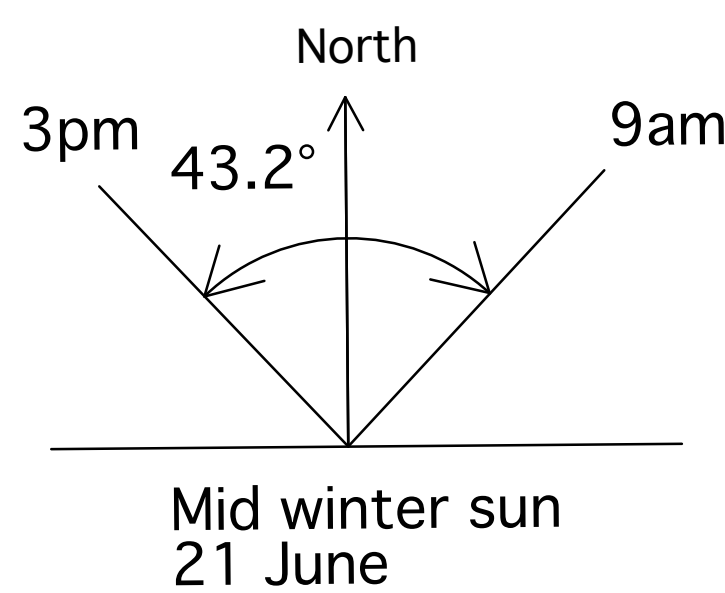
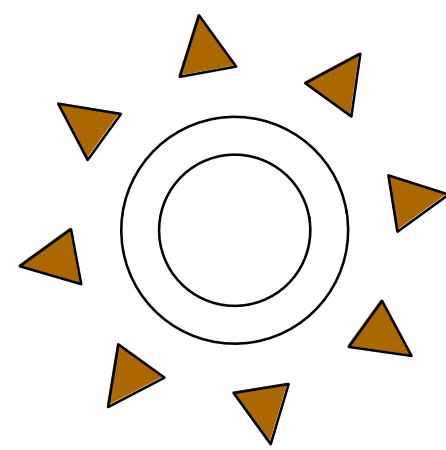

THIS PLAN IS TO BE READ IN CONJUNCTION WITH THE CONDITIONS OF DEVELOPMENT CONSENT DA2021/0976

CONTOUR LANDSCAPE ARCHITECTURE  
PO Box 698 MONA VALE NSW 1660  
Tel: 0434 500 705 - AIDLM

PROJECT  
**Bonnici Residence**  
184 Whale Beach Road,  
Whale Beach NSW 2107

NOTES  
comply with building code of australia and all relevant australian standards  
all works shall be in accordance with development application and construction certificate conditions of consent  
all levels to and  
refer to survey information relating to existing site data  
verify all dimensions prior to works  
do not scale from drawings  
use figured dimensions in preference to scaling  
refer all discrepancies to landscape architect for determination  
this drawing is copyright and must not be retained, copied, used or reproduced in any way without prior written permission of  
contour landscape architects.

DATE	REV.	ISSUE
11/05/21	A	DRAFT
18/06/21	B	DA

DATE: 18/06/21  
SCALE: 1:100 @ A1  
1:200 @ A3  
DRAWN: LH

DRAWING  
**SITE ANALYSIS PLAN**  
DRAWING NO: C8  
REV: B

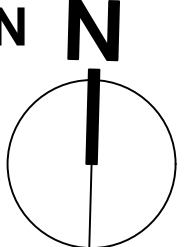



ALL PAVED AREAS AND COPING SHALL FALL TOWARDS GARDEN & LAWN AREAS

LOT C  
DP 350776

LOT D  
DP 350776

PROPOSED SWIMMING POOL OVERFLOW SHALL BE CONNECTED TO THE EXISTING SEWER SYSTEM

EXISTING STORMWATER SYSTEM TO RESIDENCE TO REMAIN UNCHANGED

WHALE BEACH ROAD



THIS PLAN IS TO BE READ IN CONJUNCTION WITH THE CONDITIONS OF DEVELOPMENT CONSENT

DA2021/0976

CONTOUR  
LANDSCAPE ARCHITECTURE

PO Box 698 MONA VALE NSW 1660  
Tel: 0434 500 705 - AIDLM

PROJECT  
**Bonnici Residence**  
184 Whale Beach Road,  
Whale Beach NSW 2107

NOTES

comply with building code of australia and all relevant australian standards  
all works shall be in accordance with development application and construction certificate conditions of consent  
all levels to and  
refer to survey information relating to existing site data  
verify all dimensions prior to works  
do not scale from drawings  
use figured dimensions in preference to scaling  
refer all discrepancies to landscape architect for determination  
this drawing is copyright and must not be retained, copied, used or reproduced in any way without prior written permission of  
contour landscape architects

DATE	REV.	ISSUE
11/05/21	A	DRAFT
18/06/21	B	DA

DATE: 18/06/21

SCALE: 1:100 @ A1  
1:200 @ A3

DRAWN: LH

DRAWING  
**STORMWATER DRAINAGE PLAN**

DRAWING NO:  
C10

REV:  
B

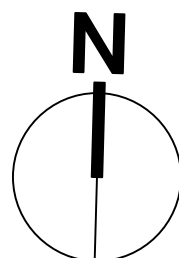





NO PROPOSED CHANGES ON UPPER FLOOR

## UPPER FLOOR PLAN

scale 1:100

INSTALL NEW GLASS BIFOLD DOORS

REMOVE GLASS WALLS

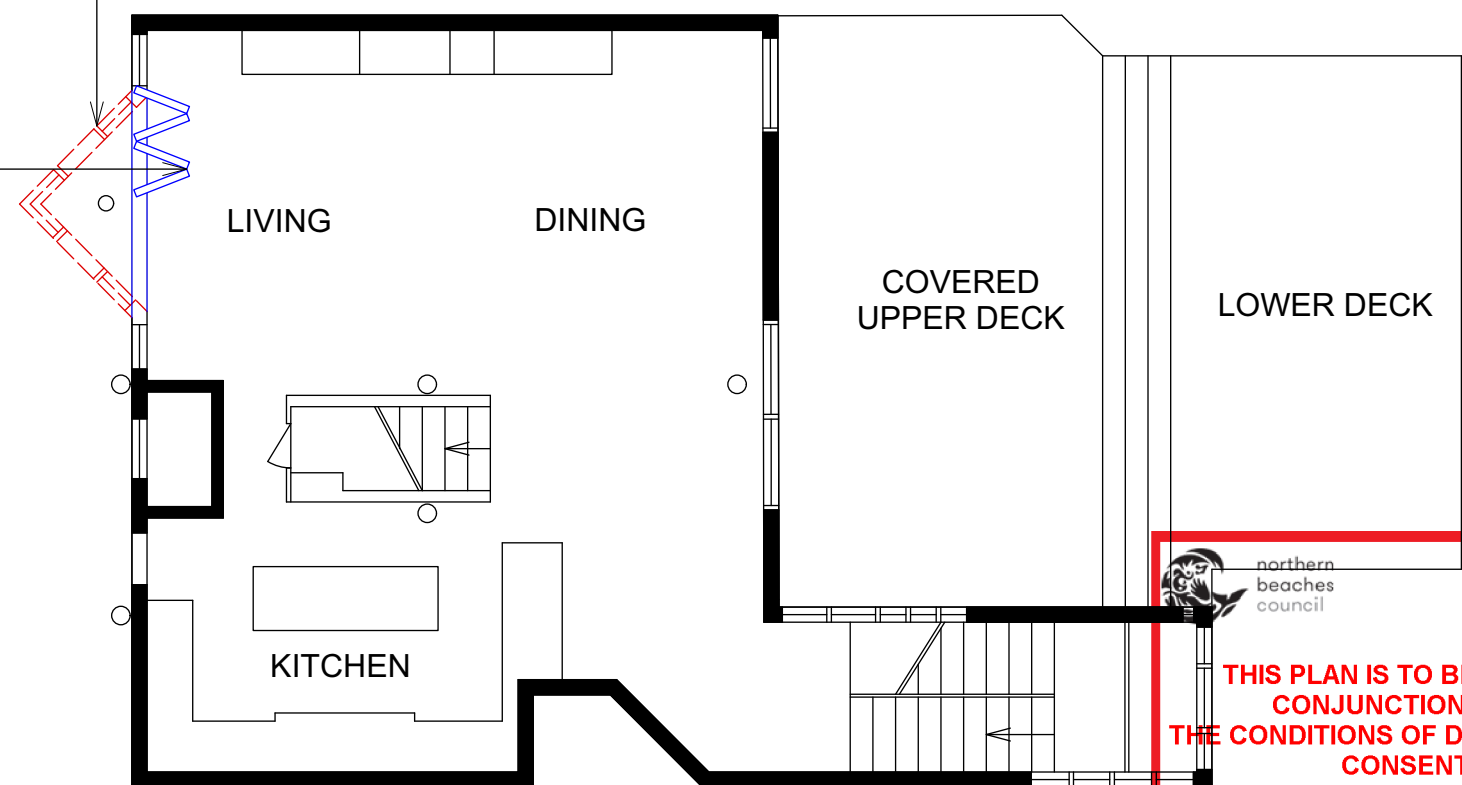

## GROUND FLOOR PLAN

scale 1:100

## LEGEND

- PROPOSED WALL
- - - - - WALL TO BE DEMOLISHED



**THIS PLAN IS TO BE READ IN  
CONJUNCTION WITH  
THE CONDITIONS OF DEVELOPMENT  
CONSENT**

**DA2021/0976**

**CONTOUR**  
LANDSCAPE ARCHITECTURE

PO Box 698 MONA VALE NSW 1660  
Tel: 0434 500 705 - AIDLM

**PROJECT**  
**Bonnici Residence**  
184 Whale Beach Road,  
Whale Beach NSW 2107

### NOTES

comply with building code of australia and all relevant australian standards  
all works shall be in accordance with development application and construction certificate conditions of consent  
all levels to ahd  
refer to survey information relating to existing site data  
verify all dimensions prior to works  
do not scale from drawings  
use figured dimensions in preference to scaling  
refer all discrepancies to landscape architect for determination  
this drawing is copyright and must not be retained, copied, used or reproduced in any way without prior written permission of  
contour landscape architects.

### DATE REV. ISSUE

18/06/21 \_ A \_ DA  
-----  
-----  
-----  
-----  
-----

DATE: 18/06/21

SCALE: 1:100 @ A3

DRAWN: LH

**DRAWING**  
**GROUND & UPPER**  
**FLOOR PLANS**

DRAWING NO:  
C11

REV:  
A

