

- LEGEND
- BK - BOTTOM OF KERB
 - BW - BOTTOM OF WALL
 - BRW - BOTTOM OF RETAINING WALL
 - CL - CENTRE LINE
 - CH - CHIMNEY
 - CONC - CONCRETE
 - D - DOOR
 - FLG - FLOOR LEVEL OF GROUND
 - FH - FIRE HYDRANT
 - GD - GRADED DRAIN
 - GM - GAS METER
 - GAR - GARDEN
 - IP - INVERT PIT
 - LP - LIGHT POLE
 - MUD - METAL LID
 - MP - METAL POST
 - PARA - PARAPET
 - PP - POWER POLE
 - RET - RETAINING
 - RR - ROOF RIDGE
 - RRL - ROOF RL
 - SIC - SEWER INSPECTION CAP
 - SMH - SEWER MANHOLE
 - SRW - STONE RETAINING WALL
 - SV - SEWER VENT
 - SWGP - STORM WATER GRADED PIT
 - TEL - TELSTRA
 - TA - TOP OF AWNING
 - TFCE - TOP OF FENCE
 - TG - TOP OF GUTTER
 - TK - TOP OF KERB
 - TP - TOP OF PARAPET
 - TR - TOP OF ROOF
 - TT - TOP OF TREE
 - TW - TOP OF WALL
 - TRW - TOP OF RET. WALL
 - US - UNDERSIDE
 - VC - VEHICLE CROSSING
 - W - WINDOW
 - WM - WATER METER
 - WV - WATER VALVE

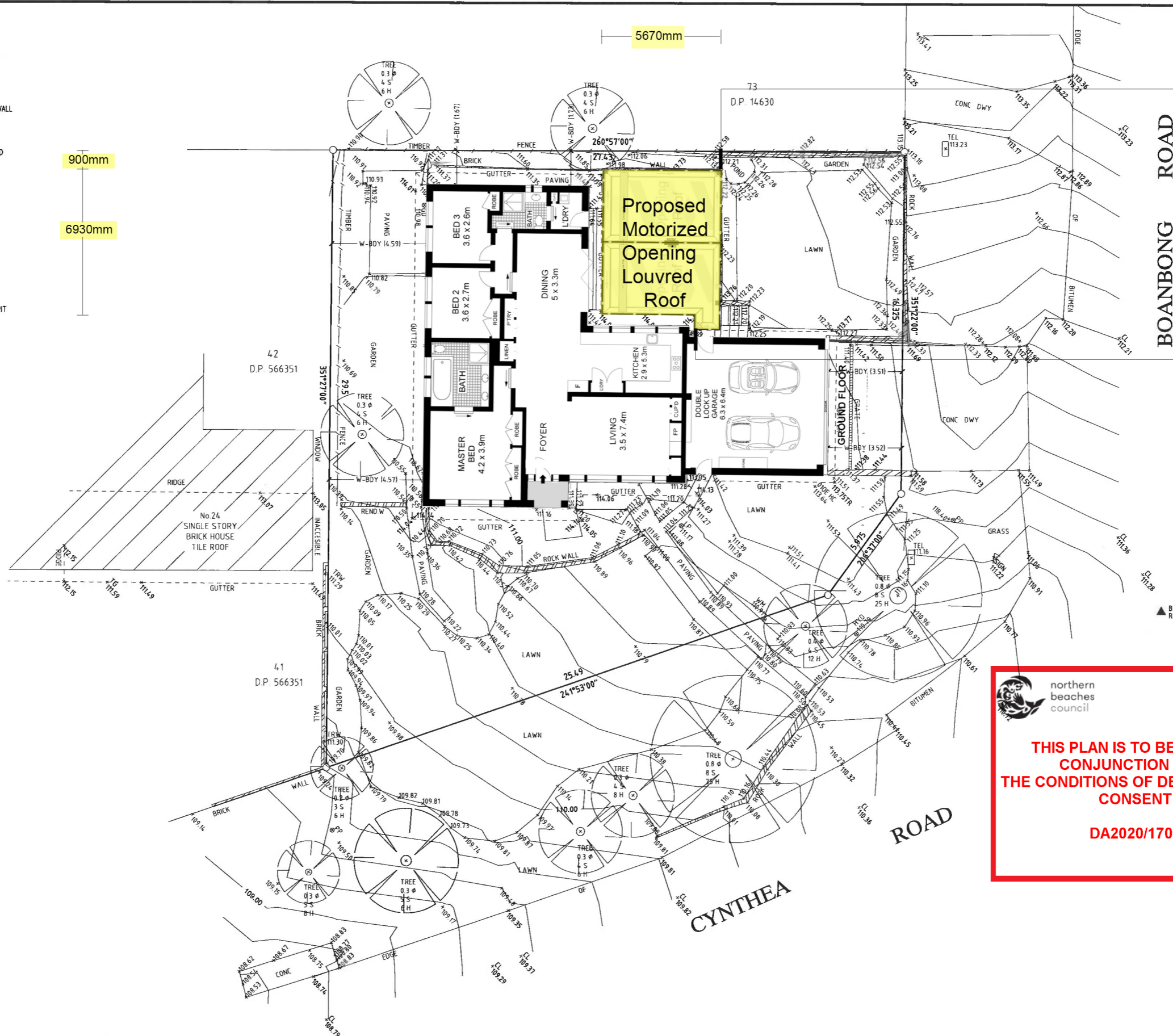
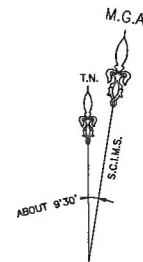

 northern
beaches
council

**THIS PLAN IS TO BE READ IN
CONJUNCTION WITH
THE CONDITIONS OF DEVELOPMENT
CONSENT**

DA2020/1709

G398387 : COVENANT

- NOTES:
1. ORIGIN OF LEVELS PM 52401 RL 114.302 (A.H.D.) (SOURCE: S.C.I.M.S. AS AT 21 JUL 2020).
 2. BEARINGS ARE ON MGA
 3. THIS PLAN IS PREPARED IN ACCORDANCE WITH COUNCIL'S DA GUIDE.
 4. RELATIONSHIP OF IMPROVEMENTS AND DETAIL TO BOUNDARIES IS DIAGRAMMATIC ONLY AND SPECIFIC DETAILS, IF CRITICAL, WILL REQUIRE FURTHER SURVEY.
 5. NO SERVICES OR UNDERGROUND SERVICES SEARCH HAS BEEN UNDERTAKEN. SERVICES SHOWN ARE BASED ON VISIBLE SURFACE INDICATORS EVIDENT AT THE DATE OF SURVEY & ARE CHARTED AS A GUIDE TO THE POSITION & NATURE OF THE SERVICE. ALL SERVICE AUTHORITIES SHOULD BE CONTACTED PRIOR TO ANY DEVELOPMENT.
 6. RIDGE, EAVE & GUTTER HEIGHTS HAVE BEEN OBTAINED BY AN INDIRECT METHOD AND ARE ACCURATE FOR PLANNING PURPOSES ONLY.
 7. ADJOINING BUILDINGS AND DWELLINGS HAVE BEEN PLOTTED FOR DIAGRAMMATIC PURPOSES ONLY AND SPECIFIC DETAILS, IF CRITICAL, WILL REQUIRE FURTHER SURVEY.
 8. THE SPREAD & HEIGHT OF EACH TREE IS INDICATIVE ONLY AND SPECIFIC DETAILS, IF CRITICAL, WILL REQUIRE FURTHER SURVEY.

DATE	BY	REVISION	ISSUE
CLIENT: GORDON LANG			

Site Plan
No.22 CYNTHIA ROAD, PALM BEACH
LOT 439 IN DP 20204

 **Opening Roof
Specialists**

For enquiries or service 02 8708 1500
Sales@openingroofspecialists.com.au
www.openingroofspecialists.com.au

RATIO: 1:100	DATE: 14th Dec 2020
DATUM: AHD	ISSUE: 0
DRAWN: MJC	SHEET: A1 1 OF 1
REF. No: 3510	DATE OF SURVEY: 21-JUL-2020

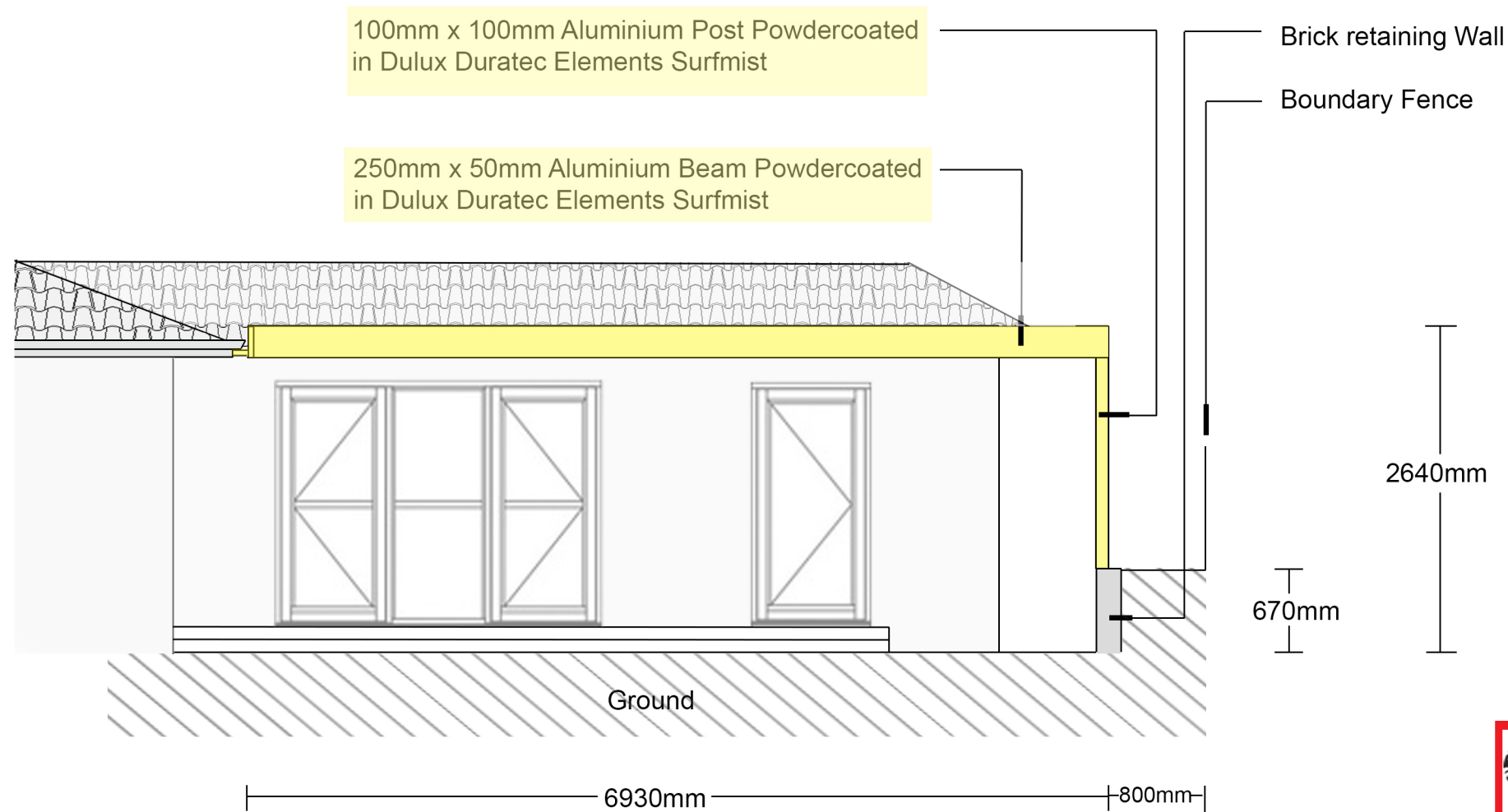

NOTES:

Connect drainage to rainwater tank on Northern side of roof.

Connect drainage to house stormwater system on Southern side of Roof



East Elevation

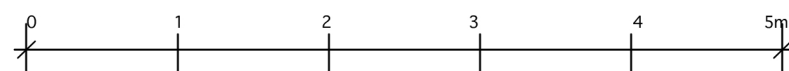

Scale 1:100



This Eclipse Opening Roof was supplied and installed by Opening Roof Specialists Pty Ltd



For enquiries or service 02 8708 1500
Sales@openingroofspecialists.com.au
www.openingroofspecialists.com.au

PROJECT: Lot 439 DP 20201 22 Cynthea Rd, Palm Beach NSW		
CLIENT: Gordon & Robyn Lang		
DRAWING TITLE: Proposed Motorised Opening Roof East Elevation		
Date Created: 5th December 2020	Scale: 1:100 @ A3	
Job No: 3510	Drawing No: RP01	Issue: A

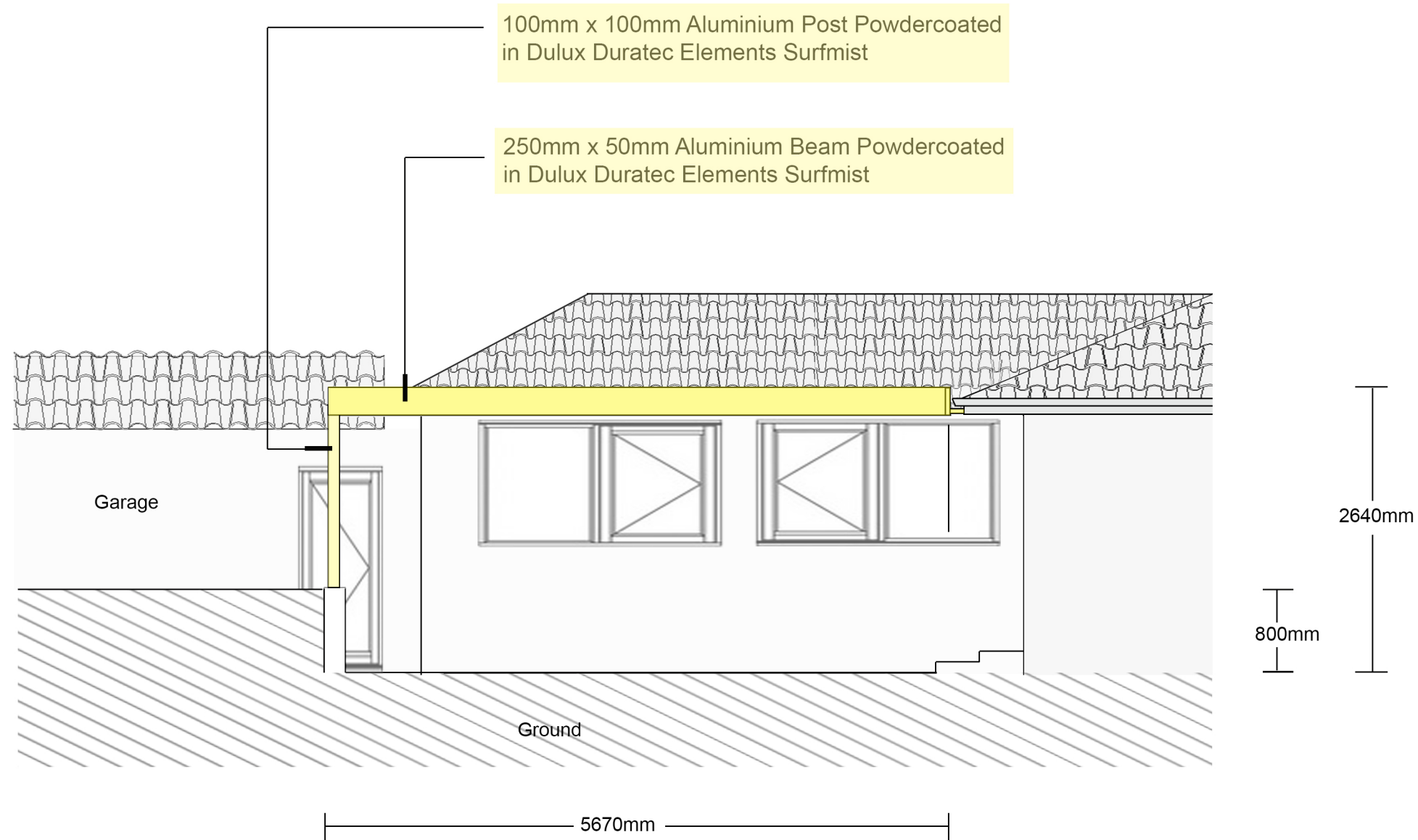

NOTES:

Connect drainage to rainwater tank on Northern side of roof.

Connect drainage to house stormwater system on Southern side of Roof



northern
beaches
council

**THIS PLAN IS TO BE READ IN
CONJUNCTION WITH
THE CONDITIONS OF DEVELOPMENT
CONSENT**

DA2020/1709

North Elevation

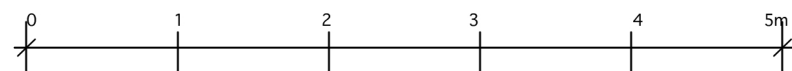

Scale 1:100



This Eclipse Opening Roof was
supplied and installed by
Opening Roof Specialists Pty Ltd



For enquiries or service 02 8708 1500
Sales@openingroofspecialists.com.au
www.openingroofspecialists.com.au

PROJECT: Lot 439 DP 20201

22 Cynthea Rd, Palm Beach NSW

CLIENT:

Gordon & Robyn Lang

DRAWING TITLE:

Proposed Motorised Opening Roof
North Elevation

Date Created:

5th December 2020

Scale:

1:100 @ A3

Job No:
3510

Drawing No:
RP02

Issue:
A