

PERTAKA PLACE

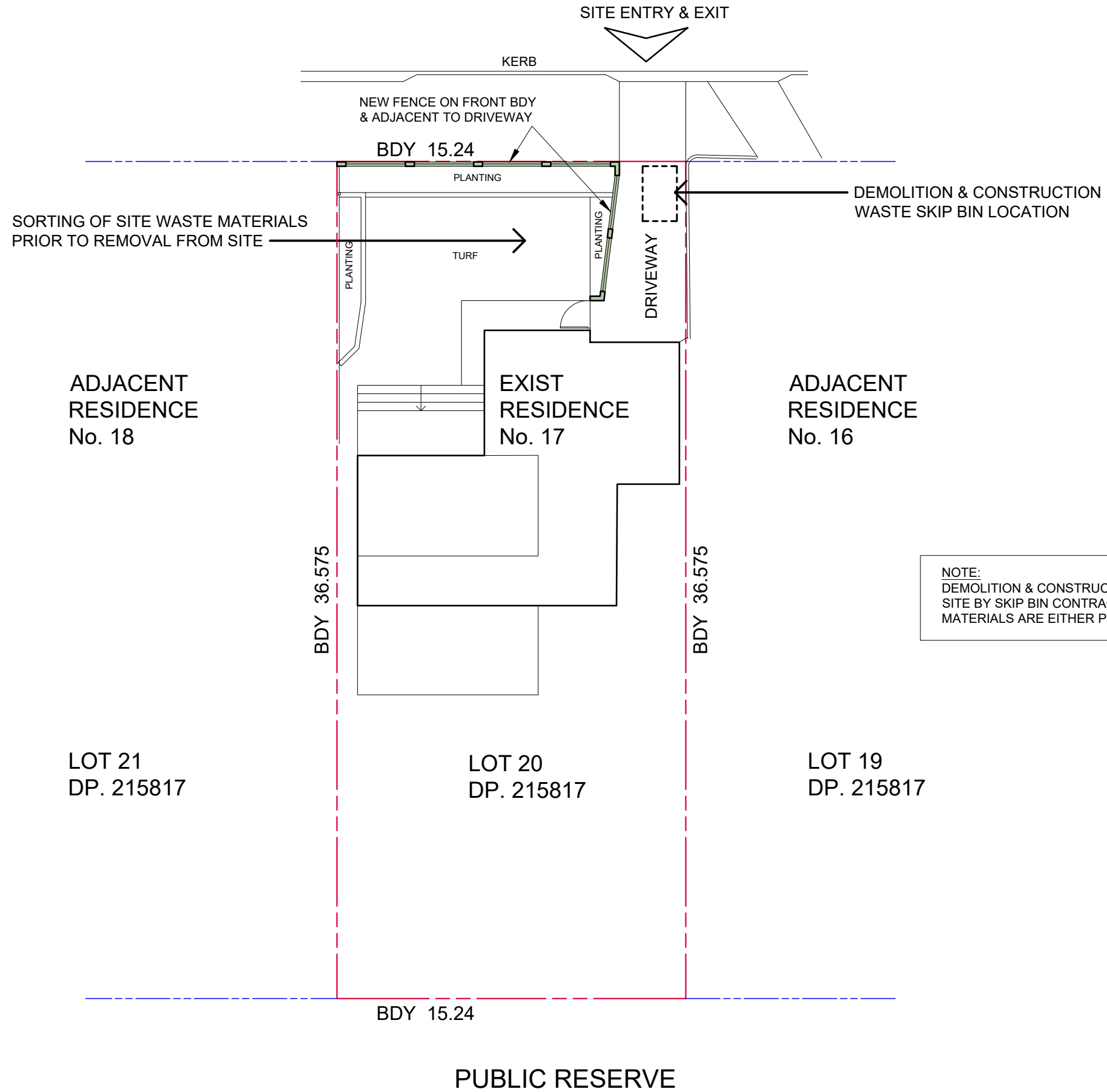

NOTE:
 DEMOLITION & CONSTRUCTION WASTE MATERIALS TO BE REMOVED FROM SITE BY SKIP BIN CONTRACTOR & TAKEN TO KIMBRIKI WASTE FACILITY WHERE MATERIALS ARE EITHER PROCESSED FOR RECYCLING OR LANDFILL.

NORTH

