

1 5-EX-SHADOW DIAGRAM - 9AM 21JUNE-NE  
Scale: 1 : 1000

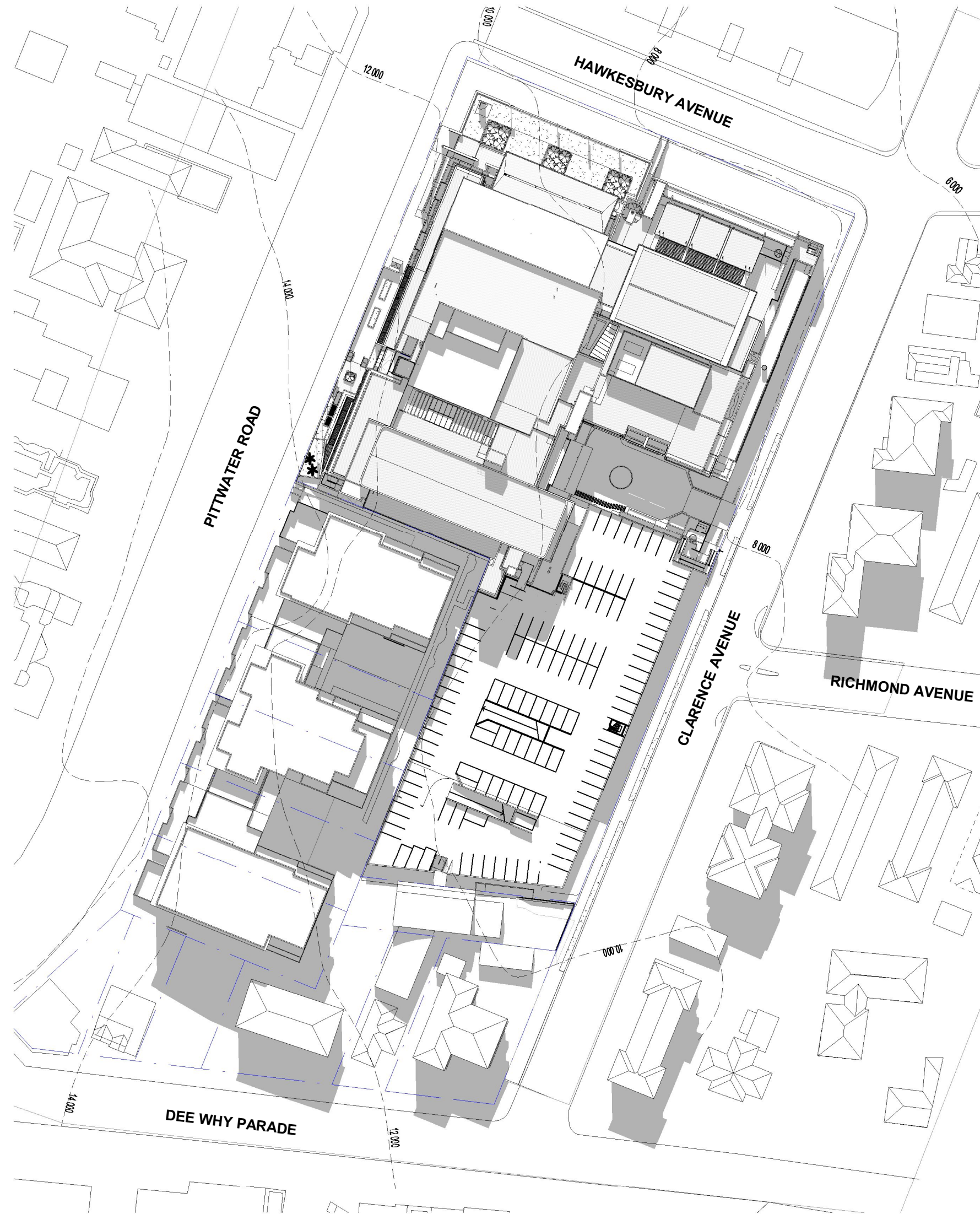

2 5-EX-SHADOW DIAGRAM - 12PM 21JUNE-NE  
Scale: 1 : 1000



3 5-EX-SHADOW DIAGRAM - 3PM 21JUNE-NE  
Scale: 1 : 1000

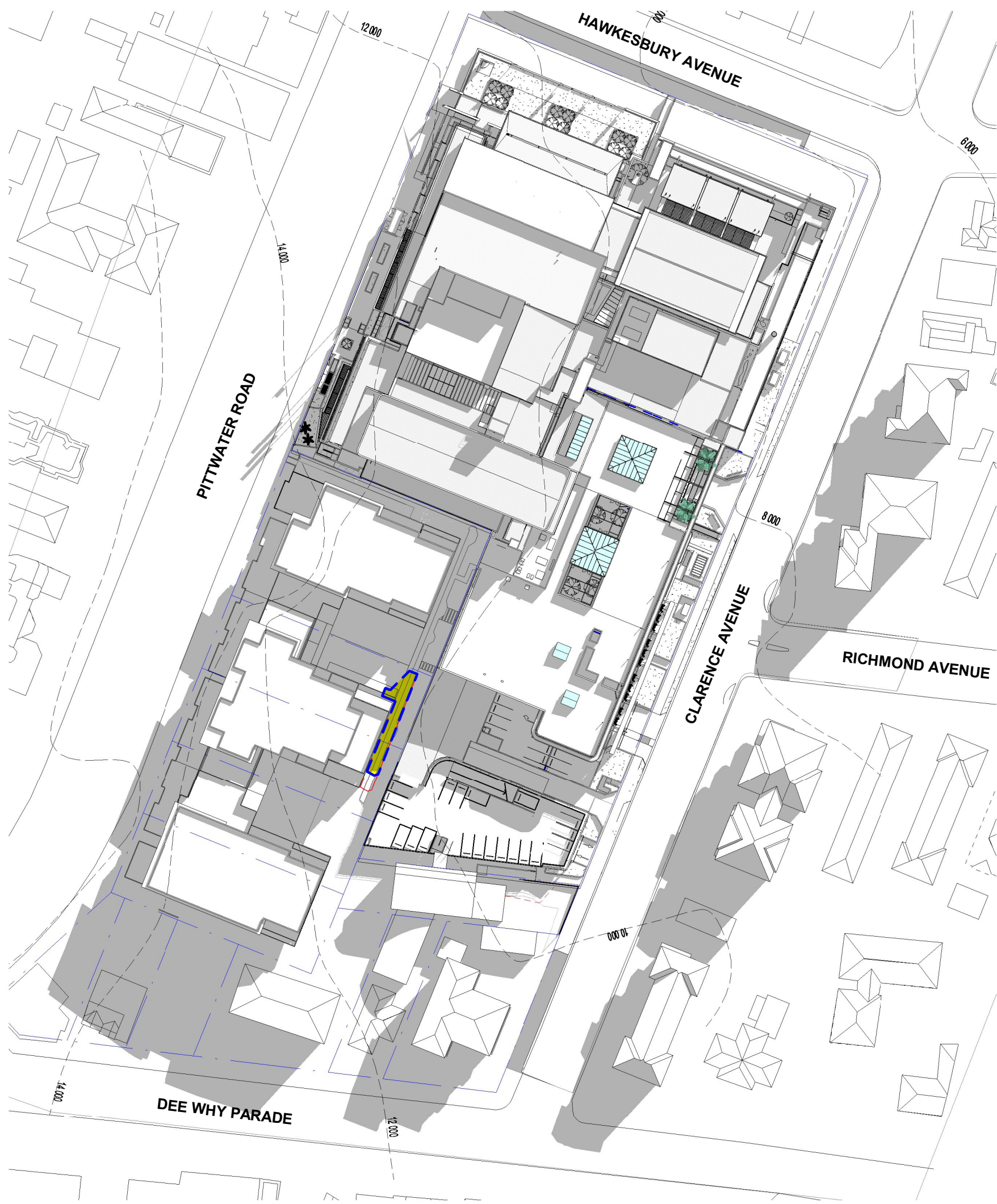

4 5-DA-SHADOW DIAGRAM - 9AM 21JUNE  
Scale: 1 : 1000

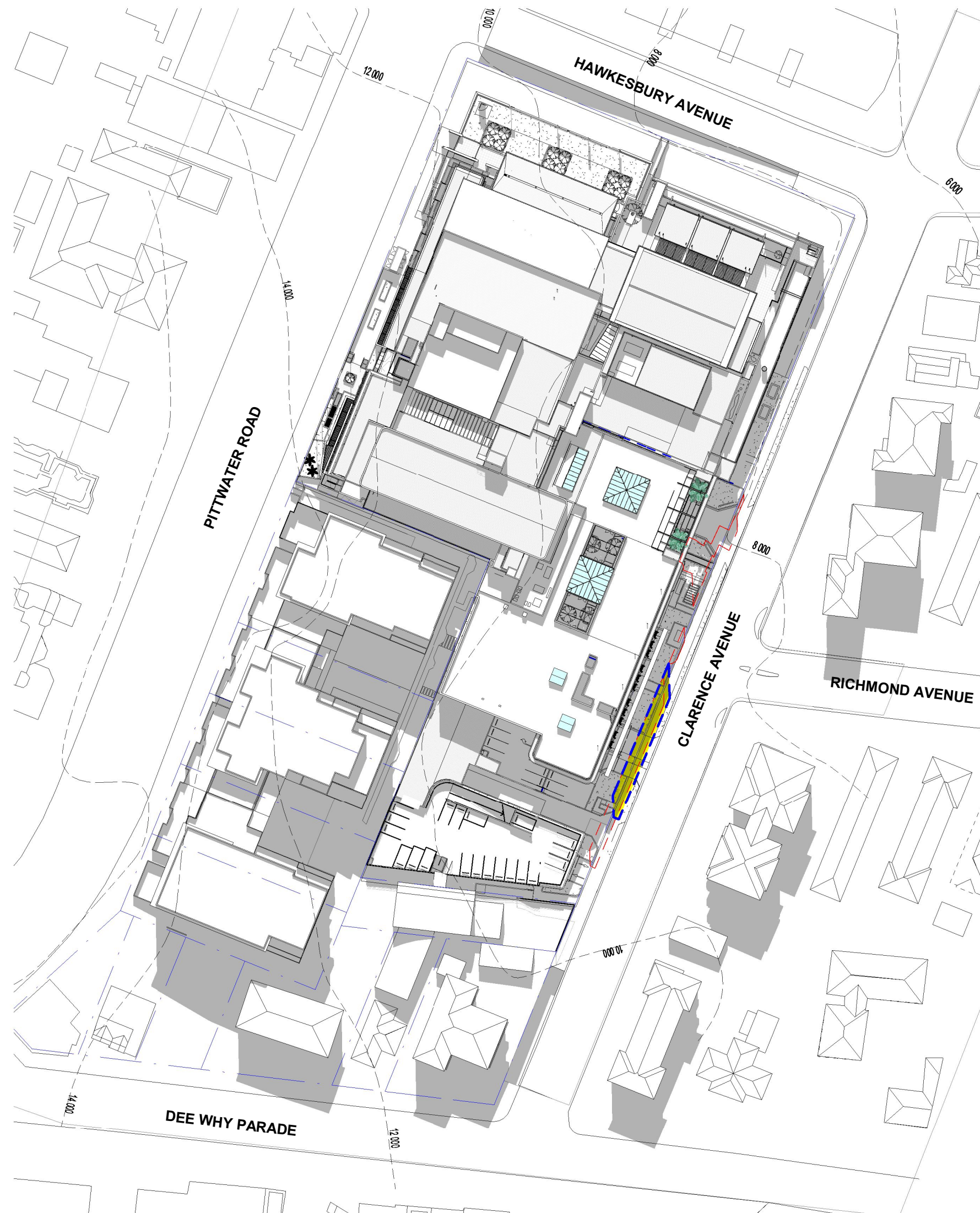

5 5-DA-SHADOW DIAGRAM - 12PM 21JUNE  
Scale: 1 : 1000



6 5-DA-SHADOW DIAGRAM - 3PM 21JUNE  
Scale: 1 : 1000

ISSUE	DATE	DESCRIPTION
1	17.03.2017	ISSUED FOR DEVELOPMENT APPLICATION
2	02.03.2018	PRELIMINARY SECTION 96

- SHADOW CAST BASED ON SECTION 96 MODIFICATIONS, REDUCED IMPACT
- SHADOW CAST ONTO SURROUNDING BY PROPOSED DEVELOPMENT AS PER ORIGINAL DA 2017/0244

CLIENT:  
DEE WHY RSL CLUB

PROJECT:  
STAGE 5 - CLUB EXTENSION  
PHASE 2 WORKS - SOUTHERN  
CARPARK & ENCLOSURE

ARCHITECT:  
**ALTIS**  
architecture  
p 61 2 9364 9000 f 61 2 9571 7930 lower deck jones bay wharf  
suite 123 / 26 - 32 pirrama road pyrmont nsw 2009 australia

DRAWING TITLE:  
SHADOW DIAGRAM - 21 JUNE

NOTES:  
Nominated architect: Rofe Latimer - 5035  
Copyright remains the property of Altis Architecture Pty Ltd.  
Use only figured dimensions.  
All discrepancies to be referred to Altis Architecture Pty Ltd prior to construction.  
Ensure compliance with the Building Code of Australia and all relevant Australian Standards and Authority requirements.

SCALE:  
As indicated @ B1  
DRAWN BY: MC  
CHECKED BY: DOC  
PROJECT NO: 2341.06  
DRAWING NO: DA-0003  
ISSUE: 2

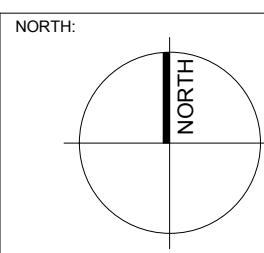

DATE: MARCH 2018  
ISSUE: 2

## SECTION 96