

## Existing View

Existing View Key Diagram

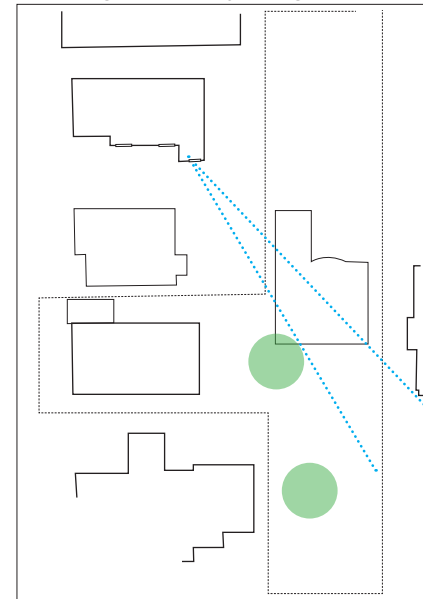

Disclaimer: The photomontages have been prepared according to the survey information provided by Geosurv and photographs provided by the client. The methodology includes using 3d modelling software to create the existing context, proposed built forms and match the photographs to the 3d model based on existing reference points.

RobertsDay does not attempt to verify the accuracy, validity or comprehensive of any information supplied to RobertsDay by third parties.

## Proposed DA

Proposed DA View Key Diagram

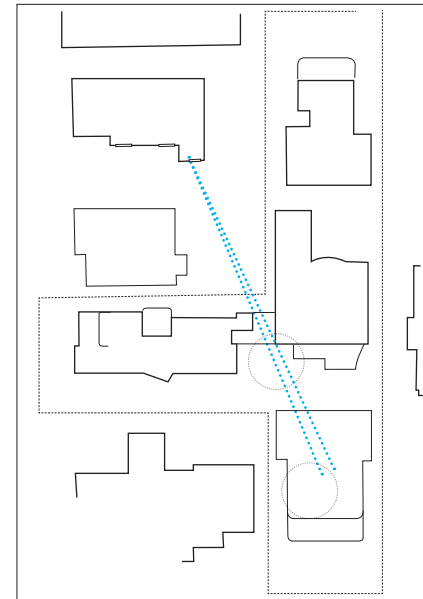

Disclaimer: The photomontages have been prepared according to the survey information provided by Geosurv and photographs provided by the client. The methodology includes using 3d modelling software to create the existing context, proposed built forms and match the photographs to the 3d model based on existing reference points.

RobertsDay does not attempt to verify the accuracy, validity or comprehensive of any information supplied to RobertsDay by third parties.



\*The mullions on window have been made translucent to better represent view access through the opening.



## Proposed DA Amendment

Proposed Amendment View Key Diagram

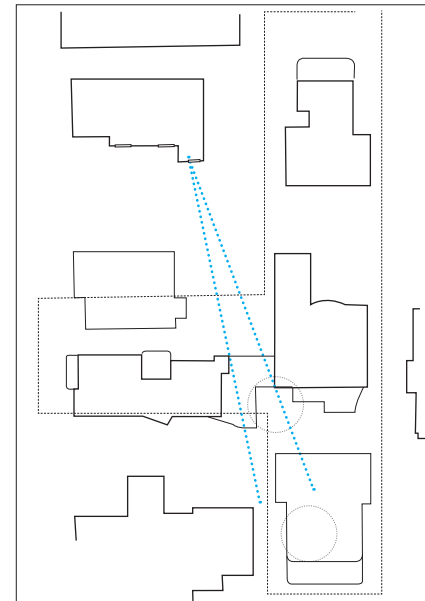

Disclaimer: The photomontages have been prepared according to the survey information provided by Geosurv and photographs provided by the client. The methodology includes using 3d modelling software to create the existing context, proposed built forms and match the photographs to the 3d model based on existing reference points.

RobertsDay does not attempt to verify the accuracy, validity or comprehensive of any information supplied to RobertsDay by third parties.



\*The mullions on window have been made translucent to better represent view access through the opening.



## Site Visit Verification Photography

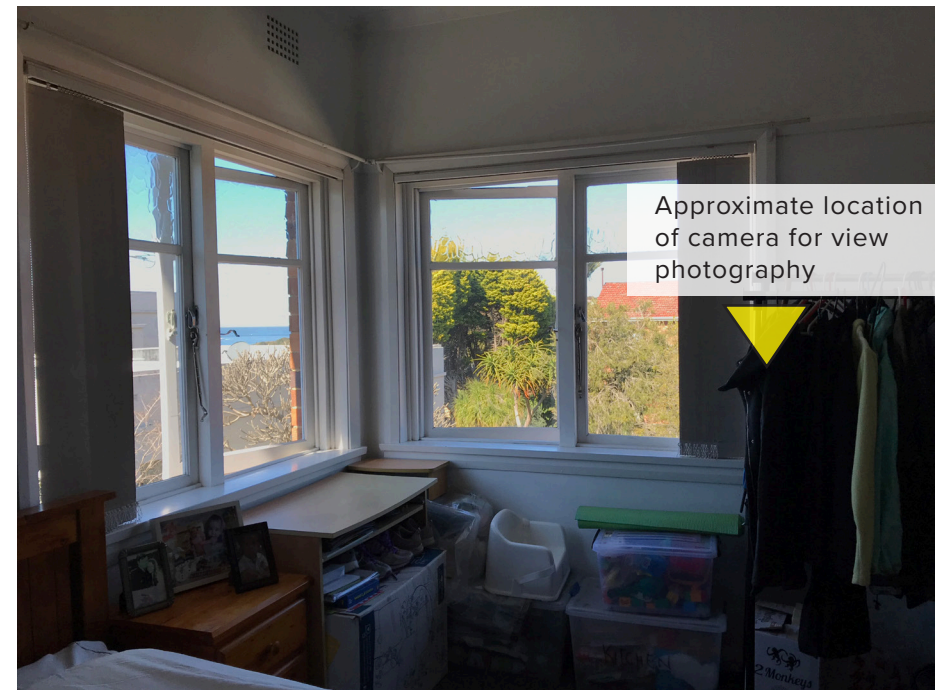



## Existing View

Existing View Key Diagram

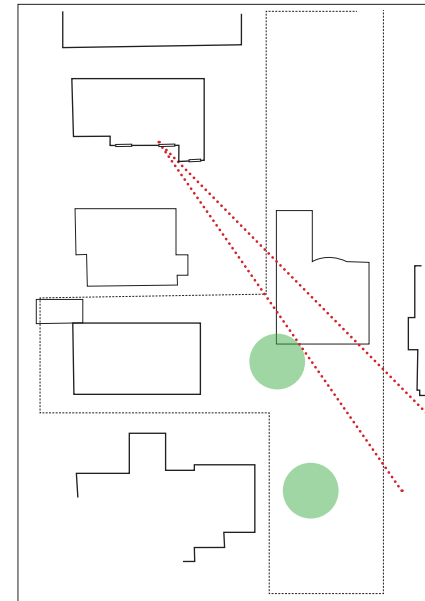

Disclaimer: The photomontages have been prepared according to the survey information provided by Geosurv and photographs provided by the client. The methodology includes using 3d modelling software to create the existing context, proposed built forms and match the photographs to the 3d model based on existing reference points.

RobertsDay does not attempt to verify the accuracy, validity or comprehensive of any information supplied to RobertsDay by third parties.

## Proposed DA

Proposed DA View Key Diagram

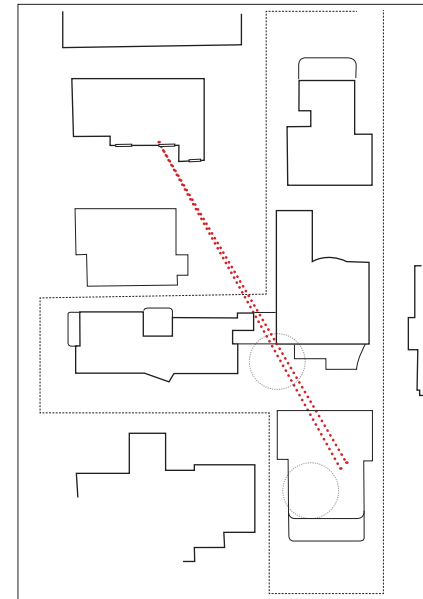

Disclaimer: The photomontages have been prepared according to the survey information provided by Geosurv and photographs provided by the client. The methodology includes using 3d modelling software to create the existing context, proposed built forms and match the photographs to the 3d model based on existing reference points.

RobertsDay does not attempt to verify the accuracy, validity or comprehensive of any information supplied to RobertsDay by third parties.



\*The mullions on window have been made translucent to better represent view access through the opening.



## Proposed DA Amendment

Proposed Amendment View Key Diagram

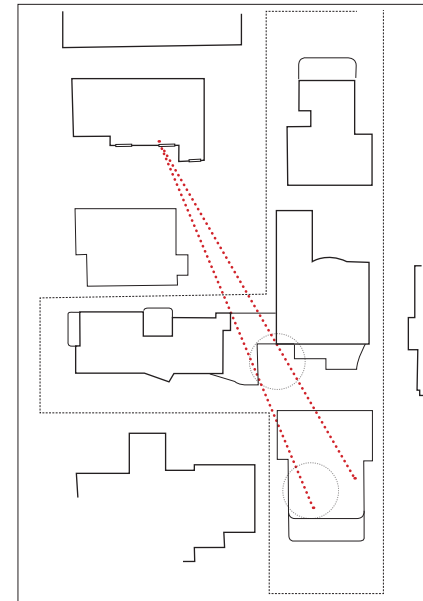

Disclaimer: The photomontages have been prepared according to the survey information provided by Geosurv and photographs provided by the client. The methodology includes using 3d modelling software to create the existing context, proposed built forms and match the photographs to the 3d model based on existing reference points.

RobertsDay does not attempt to verify the accuracy, validity or comprehensive of any information supplied to RobertsDay by third parties.



## Site Visit Verification Photography





## Western Living Room View Analysis From Unit3/16 Boyle St

### Existing View

Existing View Key Diagram

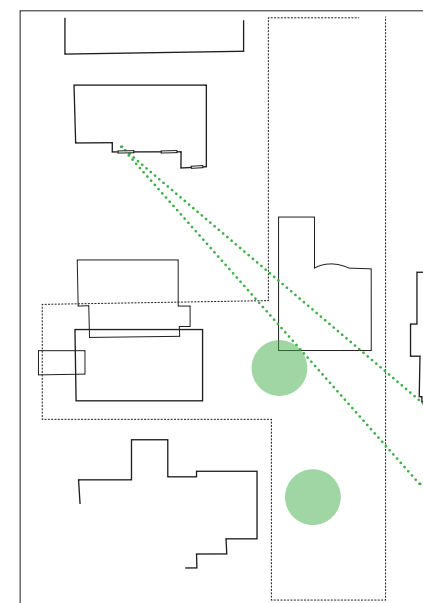

Disclaimer: The photomontages have been prepared according to the survey information provided by Geosurv and photographs provided by the client. The methodology includes using 3d modelling software to create the existing context, proposed built forms and match the photographs to the 3d model based on existing reference points.

RobertsDay does not attempt to verify the accuracy, validity or comprehensive of any information supplied to RobertsDay by third parties.



# Western Living Room View Analysis From Unit3/16 Boyle St

## Proposed DA

### Proposed DA View Key Diagram

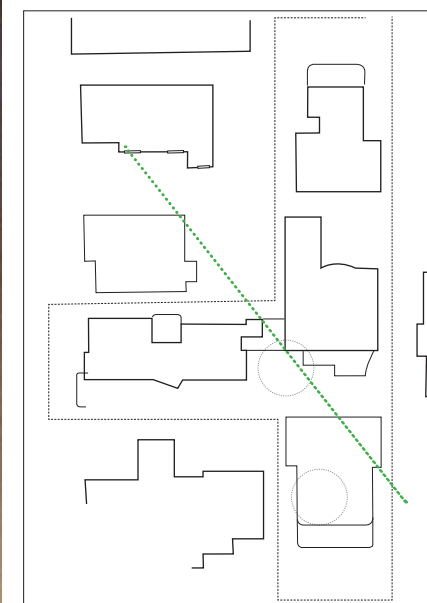

Disclaimer: The photomontages have been prepared according to the survey information provided by Geosurv and photographs provided by the client. The methodology includes using 3d modelling software to create the existing context, proposed built forms and match the photographs to the 3d model based on existing reference points.

RobertsDay does not attempt to verify the accuracy, validity or comprehensive of any information supplied to RobertsDay by third parties.



\*The mullions on window have been made translucent to better represent view access through the opening.



# Western Living Room View Analysis From Unit3/16 Boyle St

## Proposed DA Amendment

### Proposed Amendment View Key Diagram

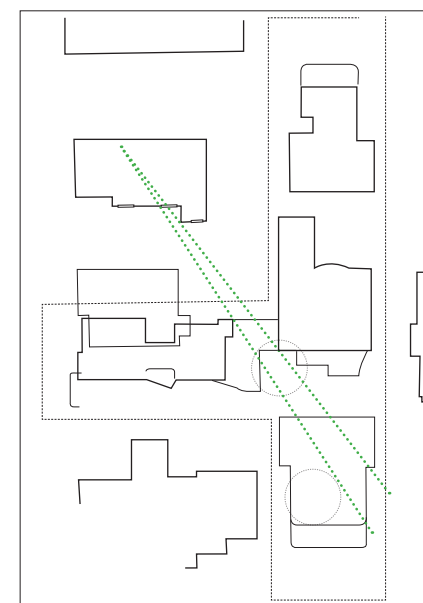

Disclaimer: The photomontages have been prepared according to the survey information provided by Geosurv and photographs provided by the client. The methodology includes using 3d modelling software to create the existing context, proposed built forms and match the photographs to the 3d model based on existing reference points.

RobertsDay does not attempt to verify the accuracy, validity or comprehensive of any information supplied to RobertsDay by third parties.

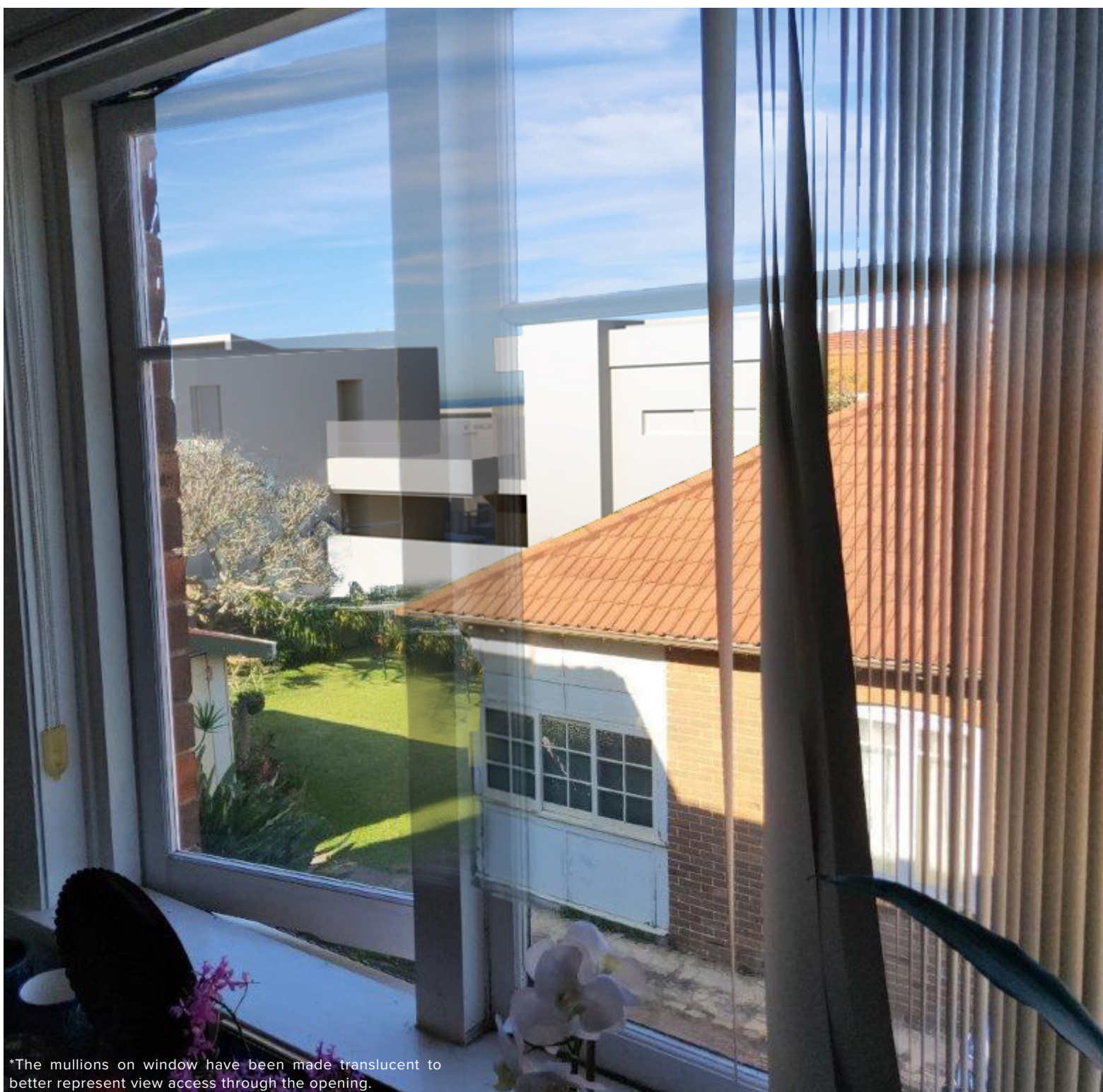

\*The mullions on window have been made translucent to better represent view access through the opening.



Western Living Room View Analysis  
From Unit3/16 Boyle St

**Site Visit Verification  
Photography**

