

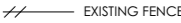

LEGENDS AND SYMBOLS

-  NEIGHBOURING BUILDINGS
-  EXISTING TREE
-  SITE BOUNDARY
-  EXISTING FENCE
-  NEW FENCE / GATE
-  PEDESTRAIN ACCESS
-  EXISTING RL
-  PROPOSED RL

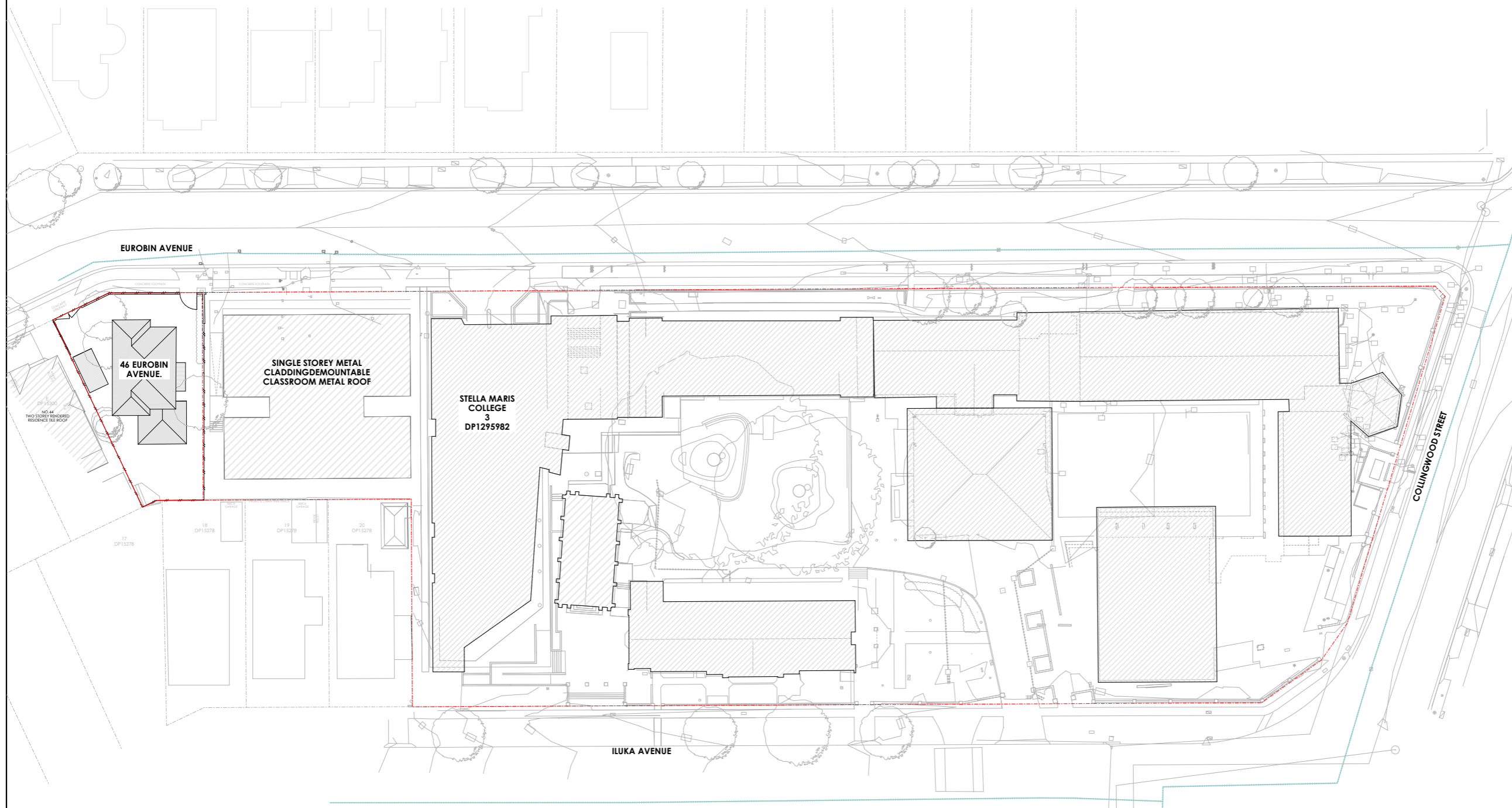

© COPYRIGHT & LIABILITY NOTICE
 THESE DESIGNS AND DRAWINGS AND THE COPYRIGHT THEREOF ARE THE PROPERTY OF JDH ARCHITECTS AND ARE NOT TO BE USED, RETAINED OR COPIED BY EITHER PHYSICAL OR ELECTRONIC MEANS WITHOUT WRITTEN OR EXPRESSED PERMISSION. ACCEPTS NO RESPONSIBILITY FOR THE COMPLETENESS, ACCURACY OR COMPATIBILITY OF ELECTRONICALLY TRANSFERRED DOCUMENTS. IF NECESSARY, RECIPIENTS SHOULD REQUEST A HARD COPY VERSION FOR VERIFICATION.
DO NOT SCALE OFF THESE DRAWINGS

REV	DESCRIPTION	DATE	INT
A	ISSUED FOR DA	12/04/2024	A

AMENDMENTS

PROJECT:
46 EUROBIN DEVELOPMENT APPLICATION

CLIENT:
STELLA MARIS COLLEGE

ADDRESS:
 46, EUROBIN AVENUE,
 MANLY, NSW, 2095 AUS











EXISTING LOCATION & BOUNDARY PLAN



PROJECT DATE: 29.01.2024	SCALE: 1:650 @A3	DESIGNED/DRAWN: FS	CHECKED: JT	SHEET SIZE: A3
Job No: 1354	Sheet No: DA_001	Revision: A		

COPYRIGHT 2024 JDSH 240409_1354_46_Eurobin DA.ppt_A

LEGENDS AND SYMBOLS

-  NEIGHBOURING BUILDINGS
-  EXISTING TREE
-  SITE BOUNDARY
-  EXISTING FENCE
-  NEW FENCE / GATE
-  PEDESTRAIN ACCESS
-  EXISTING RL
-  PROPOSED RL

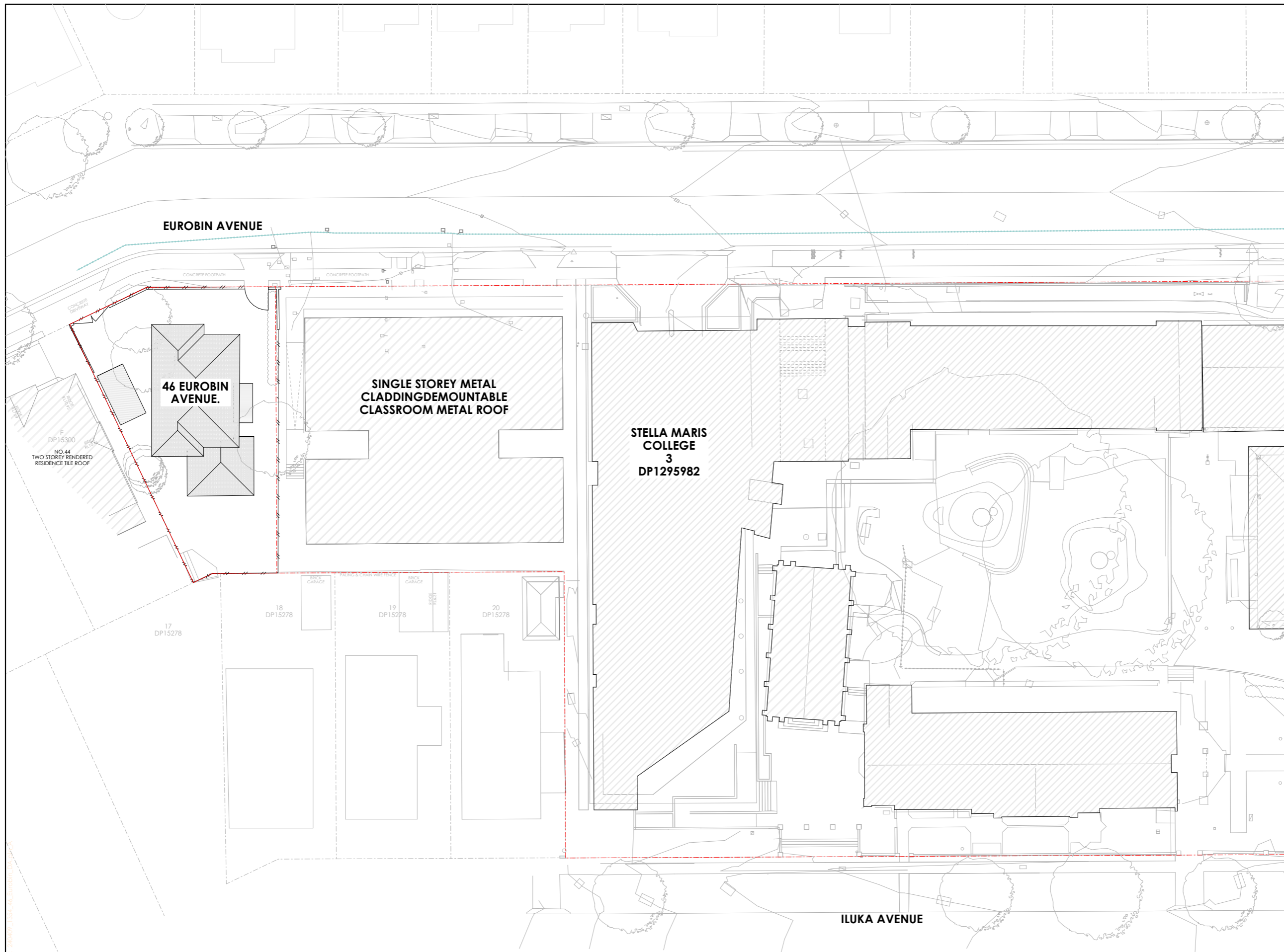

© COPYRIGHT & LIABILITY NOTICE
 THESE DESIGNS AND DRAWINGS AND THE COPYRIGHT THEREOF ARE THE PROPERTY OF JDA ARCHITECTS AND ARE NOT TO BE USED, RETAINED OR COPIED BY EITHER PHYSICAL OR ELECTRONIC MEANS WITHOUT WRITTEN OR EXPRESSED PERMISSION. ACCEPTS NO RESPONSIBILITY FOR THE COMPLETENESS, ACCURACY OR COMPATIBILITY OF ELECTRONICALLY TRANSFERRED DOCUMENTS. IF NECESSARY, RECIPIENTS SHOULD REQUEST A HARD COPY VERSION FOR VERIFICATION.
DO NOT SCALE OFF THESE DRAWINGS

REV	DESCRIPTION	DATE	INT
A	ISSUED FOR DA	12/04/2024	A

AMENDMENTS

PROJECT:
46 EUROBIN DEVELOPMENT APPLICATION

CLIENT:
STELLA MARIS COLLEGE

ADDRESS:
 46, EUROBIN AVENUE,
 MANLY, NSW, 2095 AUS











EXISTING SITE PLAN

PROJECT DATE: 29.01.2024	SCALE: 1:400 @A3	DESIGNED/DRAWN: FS	CHECKED: JT	SHEET SIZE: A3
Job No: 1354	Sheet No: DA_001	Revision: A		

COPYRIGHT 2024 JDA ARCHITECTS 240009_1354_46_Eurobin.DWG

LEGENDS AND SYMBOLS

-  NEIGHBOURING BUILDINGS
-  EXISTING TREE
-  SITE BOUNDARY
-  EXISTING FENCE
-  NEW FENCE / GATE
-  PEDESTRAIN ACCESS
-  EXISTING RL
-  PROPOSED RL

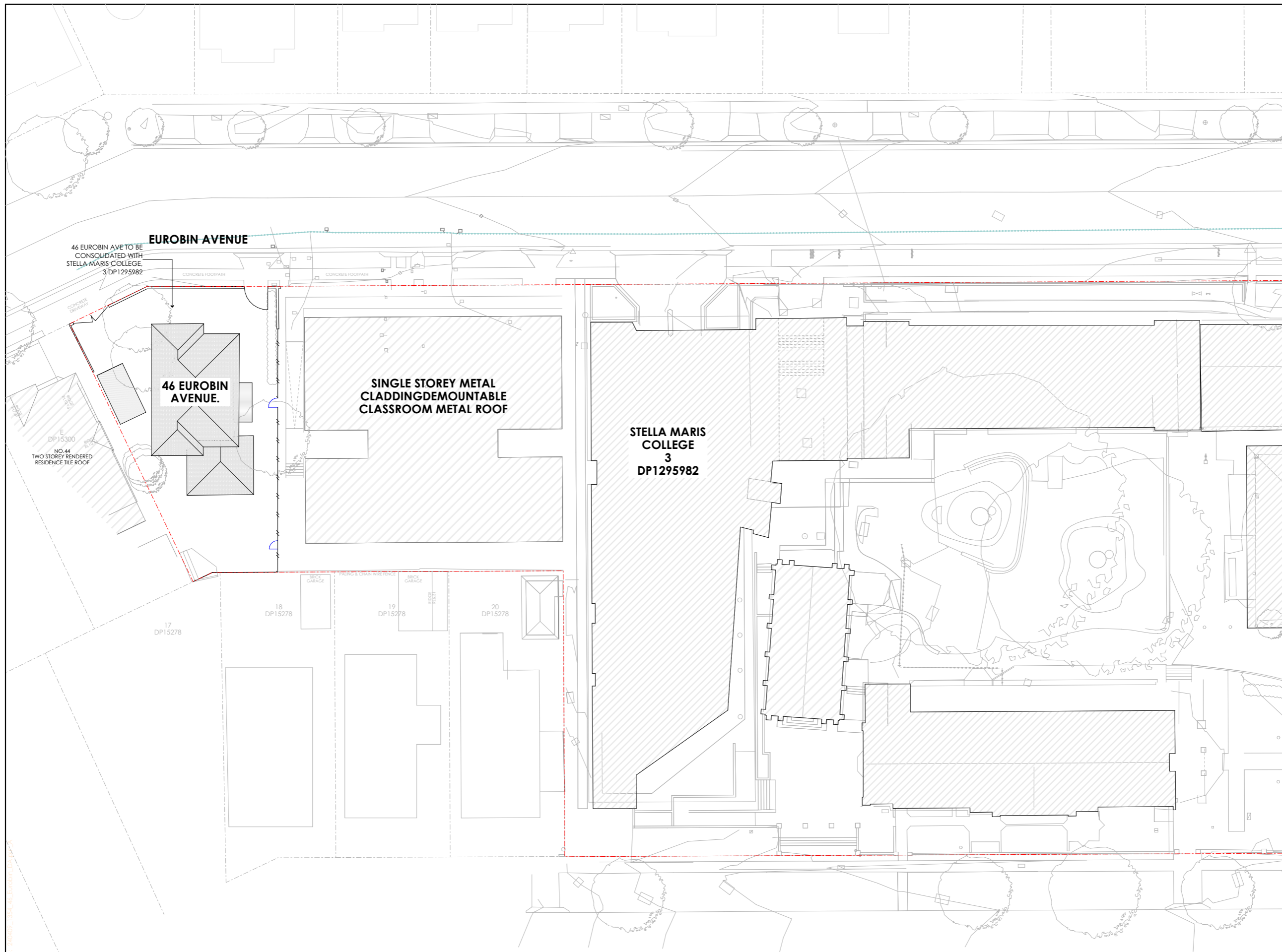

© COPYRIGHT & LIABILITY NOTICE
 THESE DESIGNS AND DRAWINGS AND THE COPYRIGHT THEREOF ARE THE PROPERTY OF JDA ARCHITECTS AND ARE NOT TO BE USED, RETAINED OR COPIED BY EITHER PHYSICAL OR ELECTRONIC MEANS WITHOUT WRITTEN OR EXPRESSED PERMISSION. ACCEPTS NO RESPONSIBILITY FOR THE COMPLETENESS, ACCURACY OR COMPATIBILITY OF ELECTRONICALLY TRANSFERRED DOCUMENTS. IF NECESSARY, RECIPIENTS SHOULD REQUEST A HARD COPY VERSION FOR VERIFICATION.
DO NOT SCALE OFF THESE DRAWINGS

REV	DESCRIPTION	DATE	INT
A	ISSUED FOR DA	12/04/2024	A

AMENDMENTS

PROJECT:
46 EUROBIN DEVELOPMENT APPLICATION

CLIENT:
STELLA MARIS COLLEGE

ADDRESS:
 46, EUROBIN AVENUE,
 MANLY, NSW, 2095 AUS



PROPOSED SITE PLAN



PROJECT DATE: 29.01.2024	SCALE: 1:400 @A3	DESIGNED/DRAWN: FS	CHECKED: JT	SHEET SIZE: A3
Job No: 1354	Sheet No: DA_002	Revision: A		

COPYRIGHT 2024 JDA ARCHITECTS 240009_1354_46_Eurobin.DWG