

THIS PLAN IS TO BE READ IN
CONJUNCTION WITH
THE CONDITIONS OF DEVELOPMENT
CONSENT

DA2021/1096

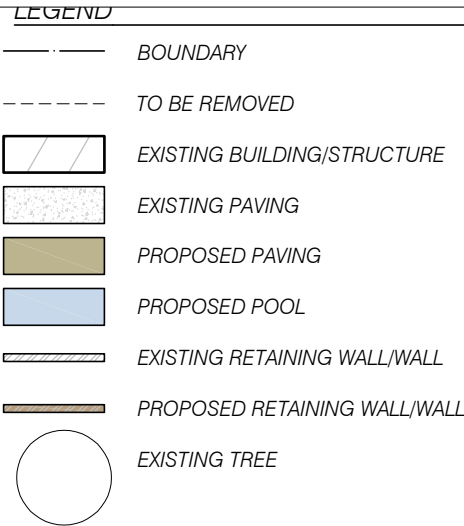
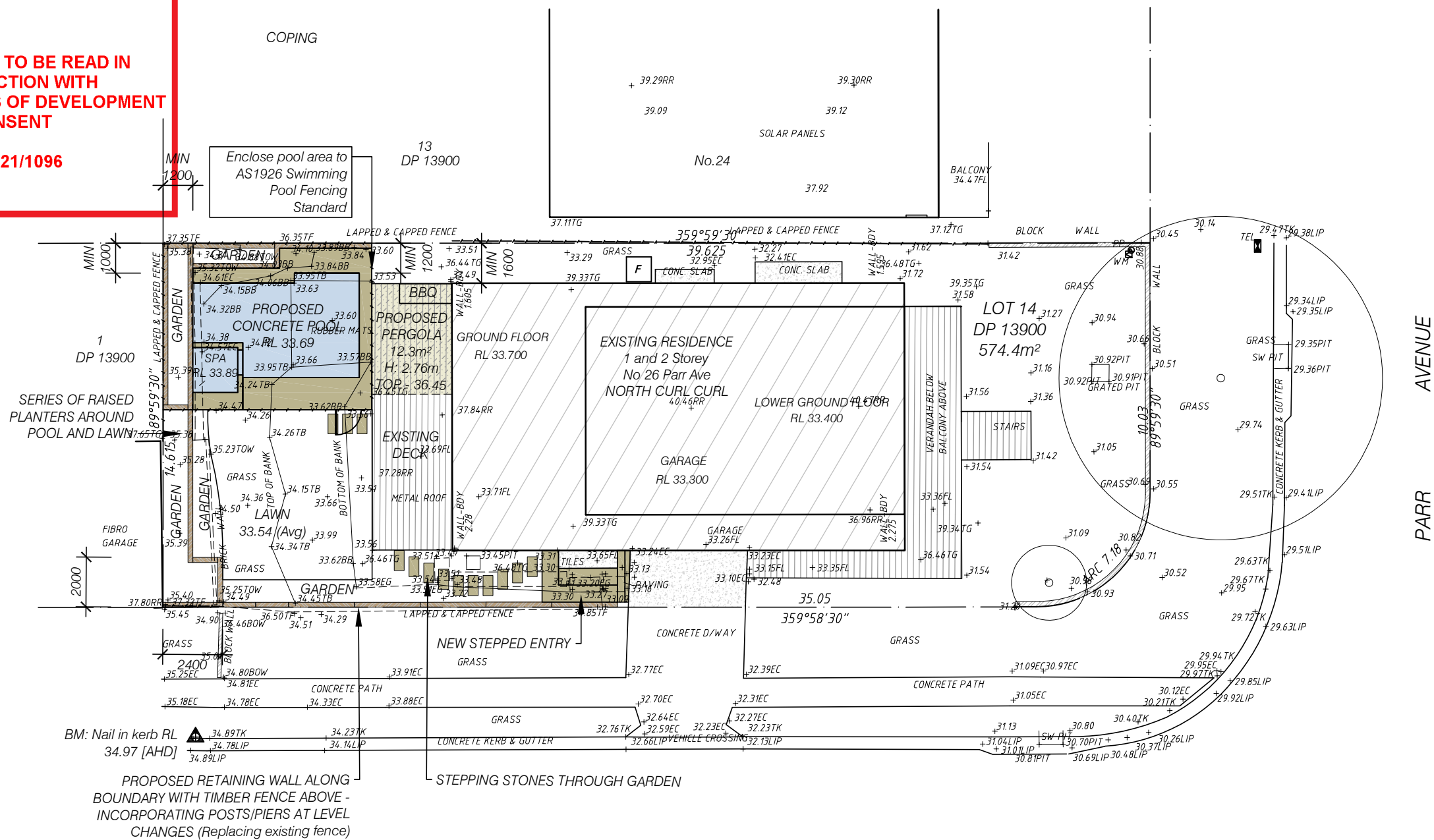

IDENTIFY & MARK THE LOCATION OF ALL
ABOVE & BELOW GROUND SERVICES
PRIOR TO COMMENCING ANY WORK.
TAKE ALL REQUIRED PRECAUTIONS TO
PREVENT DAMAGE TO SERVICES

F SOUND PROOF FILTER BOX

POOL OVERFLOW TO BE PUMPED
TO SEWER TO COUNCIL'S &
SYDNEY WATER'S REQUIREMENTS

NOTE- FENCE LOCATIONS HAVE
NOT BEEN DETERMINED IN
RELATION TO BOUNDARIES

NOTES

1. All dimensions to be verified prior to commencement by the builder. Any discrepancies are to be resolved with the designer.
2. All structural work to engineer's detail.
3. Levels shown are indicative (unless provided by a registered surveyor)
4. All services are to be located and verified prior to commencement of building work.
6. Materials and workmanship to comply with the provisions of the National Construction Code, relevant Australian Standards and the requirements of the Local Government Authority.
7. The structure is to be maintained in a stable condition during construction.

PLAYFAIR

ROAD

SITE CALCULATIONS

SITE - 574.4m²

PROPOSED WORKS
Proposed Pool - 28m²
Proposed Pool Coping - 4.6m²
Proposed Paving - 5.6m²

PROPOSED LANDSCAPED OPEN SPACE
(Required - 40% of the site, min 2.0m wide)
229.8m²

Proposed - 221.5m²

SCALE 1:200 @A3

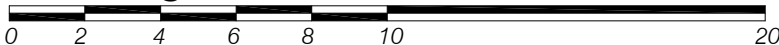

DRAWN BY
Unit 20
12 Phillip Mall
West Pymble 2073
Phone 9440 5451 Facsimile 9402 6499
ABN 97 077 163 663
Fellow of Australian Institute of Landscape Designers and Managers



NOTES TO THE PLAN

THIS PLAN IS TO BE READ AS PART OF A COMPLETE SET OF
DRAWINGS RELATING TO THE PROPOSED DEVELOPMENT
THIS PLAN RELATES TO A SPECIFIC DEVELOPMENT
INFORMATION RELATING TO THE DEVELOPMENT NEEDS TO BE
CONFIRMED ON SITE PRIOR TO CONSTRUCTION
ALL MEASUREMENTS ARE IN MILLIMETRES UNLESS
OTHERWISE INDICATED

CLIENT

HAINES AND MOSS RESIDENCE
SITE
26 PARR AVE
NORTH CURL CURL

DRAWING

SITE PLAN
PROJECT
PROPOSED SWIMMING POOL
AND LANDSCAPING

Date of Issue

A 26-02-21
B 24-05-21

JOB No

21-02

ISSUE

B

DWG No

2

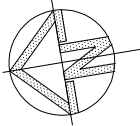

THIS PLAN IS TO BE READ IN
CONJUNCTION WITH
THE CONDITIONS OF DEVELOPMENT
CONSENT

DA2021/1096

LEGEND

- BOUNDARY
- TO BE REMOVED
- EXISTING BUILDING/STRUCTURE
- EXISTING SPOT HEIGHT
- P: 33.59; TOW PROPOSED SPOT HEIGHT/TOP OF WALL
- EXISTING PAVING
- PROPOSED PAVING
- PROPOSED POOL
- EXISTING RETAINING WALL/WALL
- PROPOSED RETAINING WALL/WALL
- EXISTING TREE

IDENTIFY & MARK THE LOCATION OF ALL
ABOVE & BELOW GROUND SERVICES
PRIOR TO COMMENCING ANY WORK.
TAKE ALL REQUIRED PRECAUTIONS TO
PREVENT DAMAGE TO SERVICES

F SOUND PROOF FILTER BOX

POOL OVERFLOW TO BE PUMPED
TO SEWER TO COUNCIL'S &
SYDNEY WATER'S REQUIREMENTS

NOTE- FENCE LOCATIONS HAVE
NOT BEEN DETERMINED IN
RELATION TO BOUNDARIES

NOTES

- All dimensions to be verified prior to commencement by the builder. Any discrepancies are to be resolved with the designer.
- All structural work to engineer's detail.
- Levels shown are indicative (unless provided by a registered surveyor)
- All services are to be located and verified prior to commencement of building work.
- Materials and workmanship to comply with the provisions of the National Construction Code, relevant Australian Standards and the requirements of the Local Government Authority.
- The structure is to be maintained in a stable condition during construction.

SCALE 1:100 @A3

BM: Nail in kerb RL 34.97 [AHD]

DRAWN BY
Unit 20
12 Phillip Mall
West Pymble 2073

Phone 9440 5451 Facsimile 9402 6499
ABN 97 077 163 663
Fellow of Australian Institute of Landscape Designers and Managers



NOTES TO THE PLAN

THIS PLAN IS TO BE READ AS PART OF A COMPLETE SET OF
DRAWINGS RELATING TO THE PROPOSED DEVELOPMENT
THIS PLAN RELATES TO A SPECIFIC DEVELOPMENT
INFORMATION RELATING TO THE DEVELOPMENT NEEDS TO BE
CONFIRMED ON SITE PRIOR TO CONSTRUCTION
ALL MEASUREMENTS ARE IN MILLIMETRES UNLESS
OTHERWISE INDICATED

CLIENT
HAINES AND MOSS RESIDENCE
SITE
26 PARR AVE
NORTH CURL CURL

DRAWING
PART SITE PLAN
PROJECT
**PROPOSED SWIMMING POOL
AND LANDSCAPING**

Date of Issue
A 26-02-21
B 24-05-21

JOB No
21-02
ISSUE
B
DWG No
3

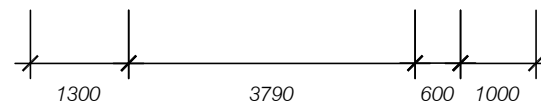
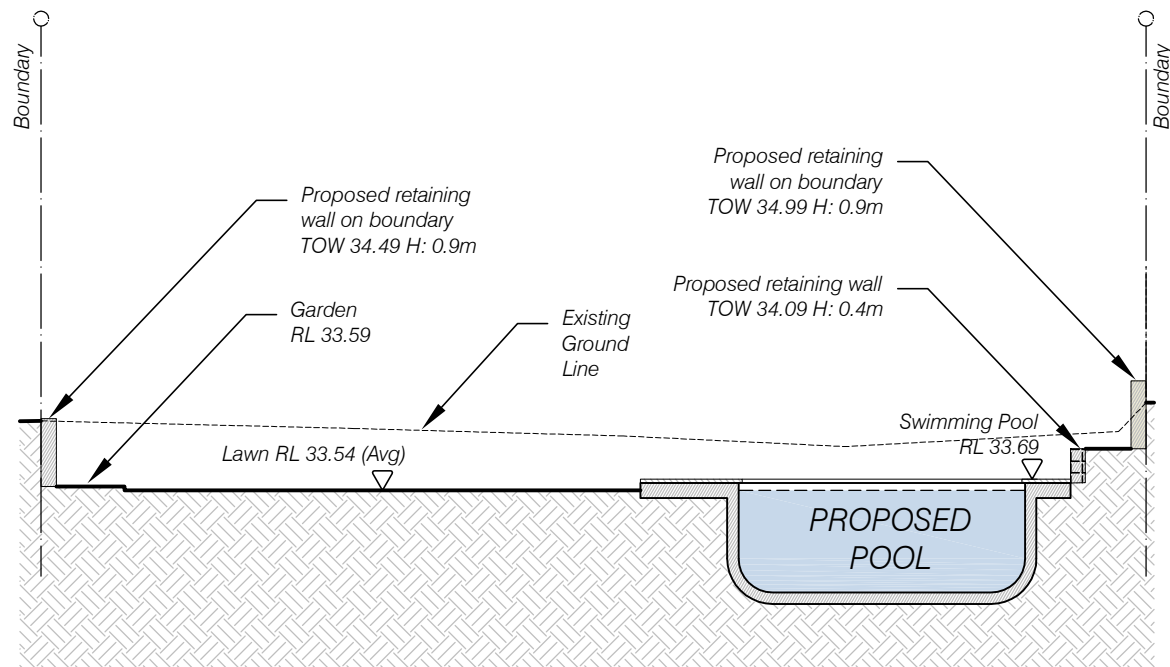

SECTION X-X

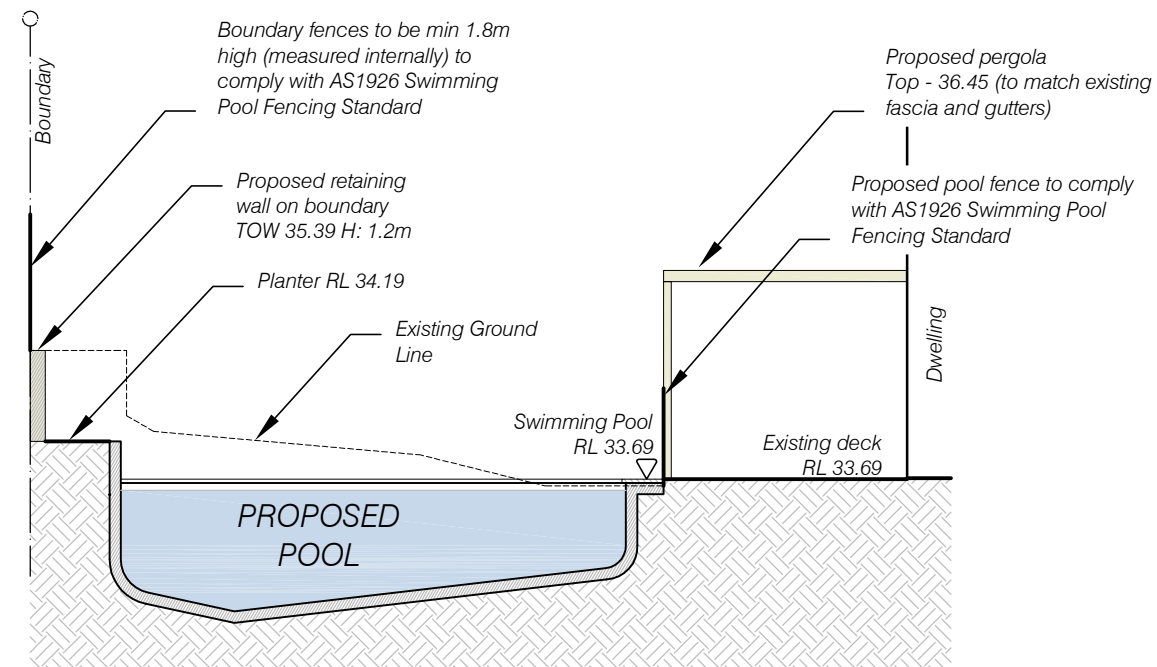
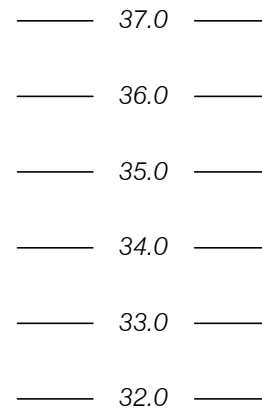

SECTION Y-Y

THIS PLAN IS TO BE READ IN CONJUNCTION WITH THE CONDITIONS OF DEVELOPMENT CONSENT

DA2021/1096

NOTES

1. All dimensions to be verified prior to commencement by the builder. Any discrepancies are to be resolved with the designer.
2. All structural work to engineer's detail.
3. Levels shown are indicative (unless provided by a registered surveyor)
4. All services are to be located and verified prior to commencement of building work.
6. Materials and workmanship to comply with the provisions of the National Construction Code, relevant Australian Standards and the requirements of the Local Government Authority.
7. The structure is to be maintained in a stable condition during construction.

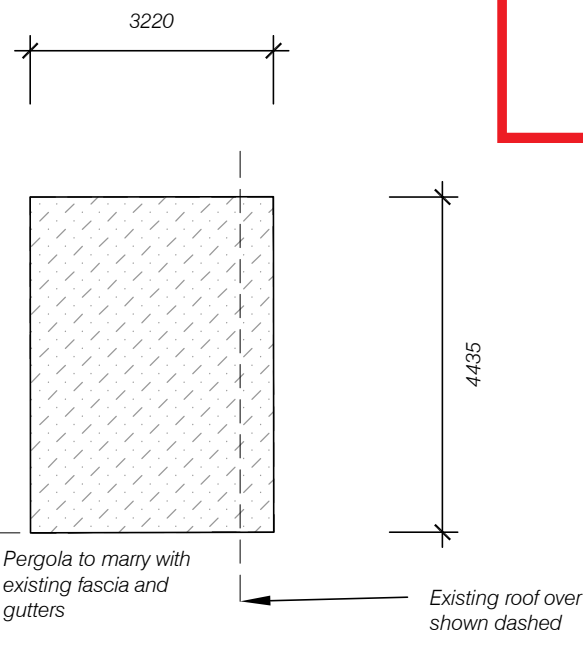

PERGOLA ROOF PLAN

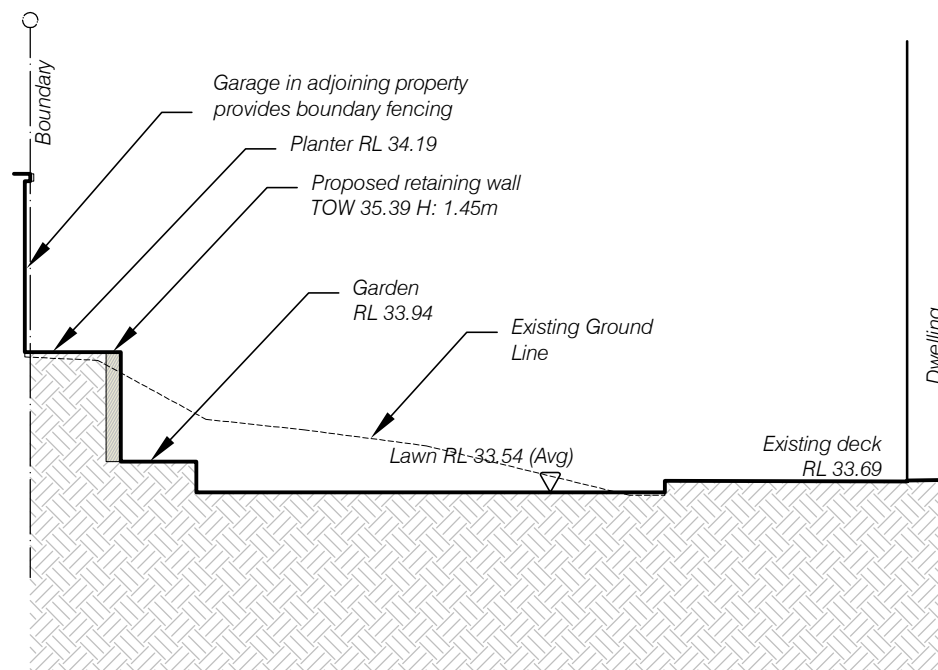
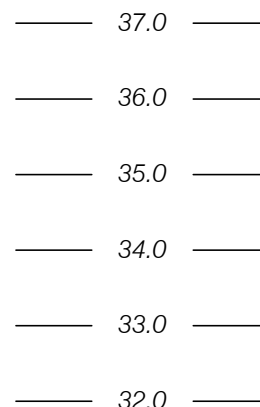

SECTION Z-Z

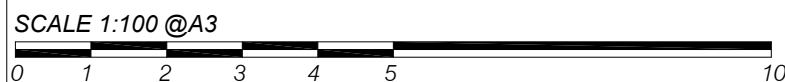

outside LIVING

DRAWN BY
Unit 20
12 Phillip Mall
West Pymble 2073

Phone 9440 5451 Facsimile 9402 6499
ABN 97 077 163 663
Fellow of Australian Institute of Landscape Designers and Managers

NOTES TO THE PLAN

THIS PLAN IS TO BE READ AS PART OF A COMPLETE SET OF DRAWINGS RELATING TO THE PROPOSED DEVELOPMENT

THIS PLAN RELATES TO A SPECIFIC DEVELOPMENT INFORMATION RELATING TO THE DEVELOPMENT NEEDS TO BE CONFIRMED ON SITE PRIOR TO CONSTRUCTION

ALL MEASUREMENTS ARE IN MILLIMETRES UNLESS OTHERWISE INDICATED

CLIENT
HAINES AND MOSS RESIDENCE

SITE
26 PARR AVE
NORTH CURL CURL

DRAWING
SECTIONS and PERGOLA ROOF PLAN

PROJECT
PROPOSED SWIMMING POOL AND LANDSCAPING

Date of Issue
A 26-02-21
B 24-05-21

JOB No
21-02

ISSUE
B

DWG No
5

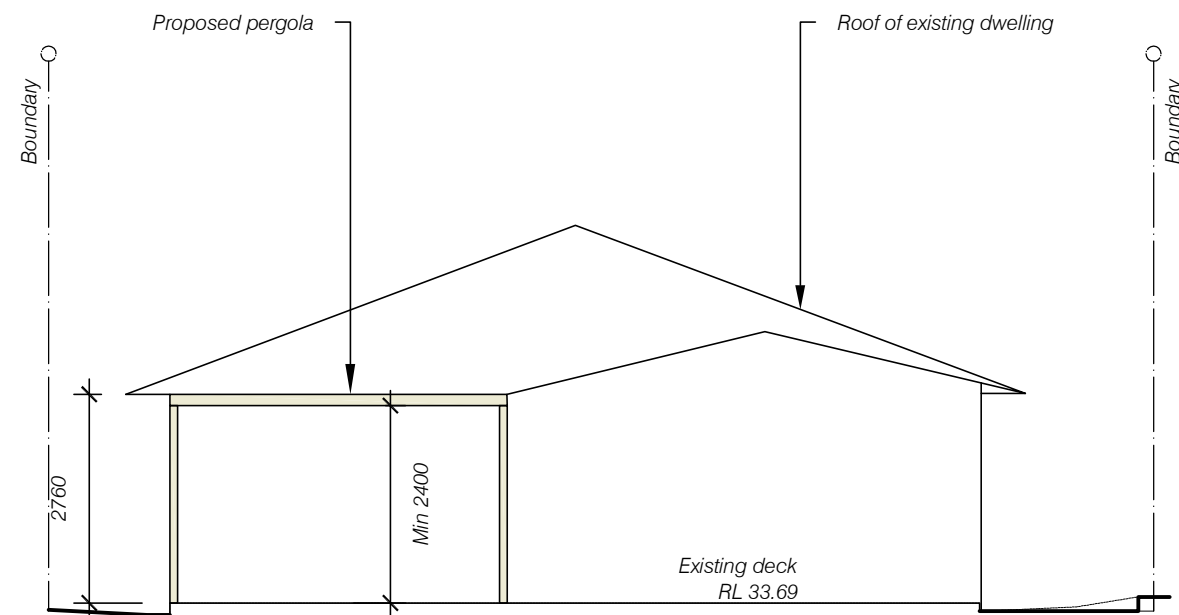

NORTH ELEVATION
(Rear)

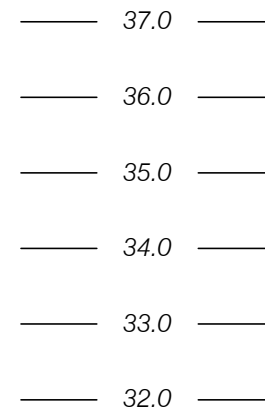

WEST ELEVATION

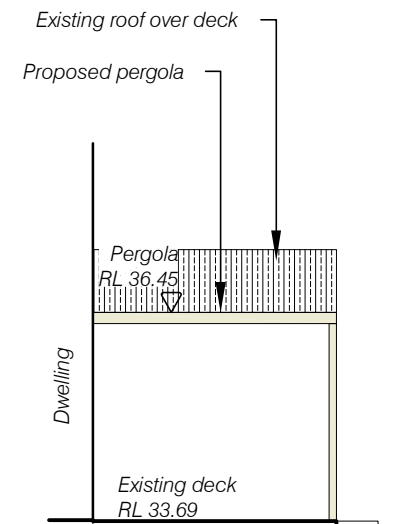

EAST ELEVATION

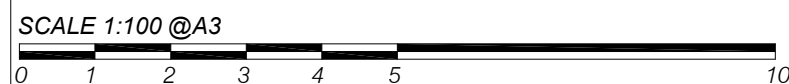

DRAWN BY
Unit 20
12 Phillip Mall
West Pymble 2073

outside
LIVING

Phone 9440 5451 Facsimile 9402 6499
ABN 97 077 163 663
Fellow of Australian Institute of Landscape Designers and Managers

NOTES TO THE PLAN
THIS PLAN IS TO BE READ AS PART OF A COMPLETE SET OF
DRAWINGS RELATING TO THE PROPOSED DEVELOPMENT
THIS PLAN RELATES TO A SPECIFIC DEVELOPMENT
INFORMATION RELATING TO THE DEVELOPMENT NEEDS TO BE
CONFIRMED ON SITE PRIOR TO CONSTRUCTION
ALL MEASUREMENTS ARE IN MILLIMETRES UNLESS
OTHERWISE INDICATED

CLIENT
HAINES AND MOSS RESIDENCE
SITE
26 PARR AVE
NORTH CURL CURL

DRAWING
PERGOLA ELEVATIONS
PROJECT
**PROPOSED SWIMMING POOL
AND LANDSCAPING**

Date of Issue
A 26-02-21
B 24-05-21

JOB No
21-02
ISSUE
B
DWG No
6

NOTES

1. All dimensions to be verified prior to commencement by the builder. Any discrepancies are to be resolved with the designer.
2. All structural work to engineer's detail.
3. Levels shown are indicative (unless provided by a registered surveyor)
4. All services are to be located and verified prior to commencement of building work.
6. Materials and workmanship to comply with the provisions of the National Construction Code, relevant Australian Standards and the requirements of the Local Government Authority.
7. The structure is to be maintained in a stable condition during construction.

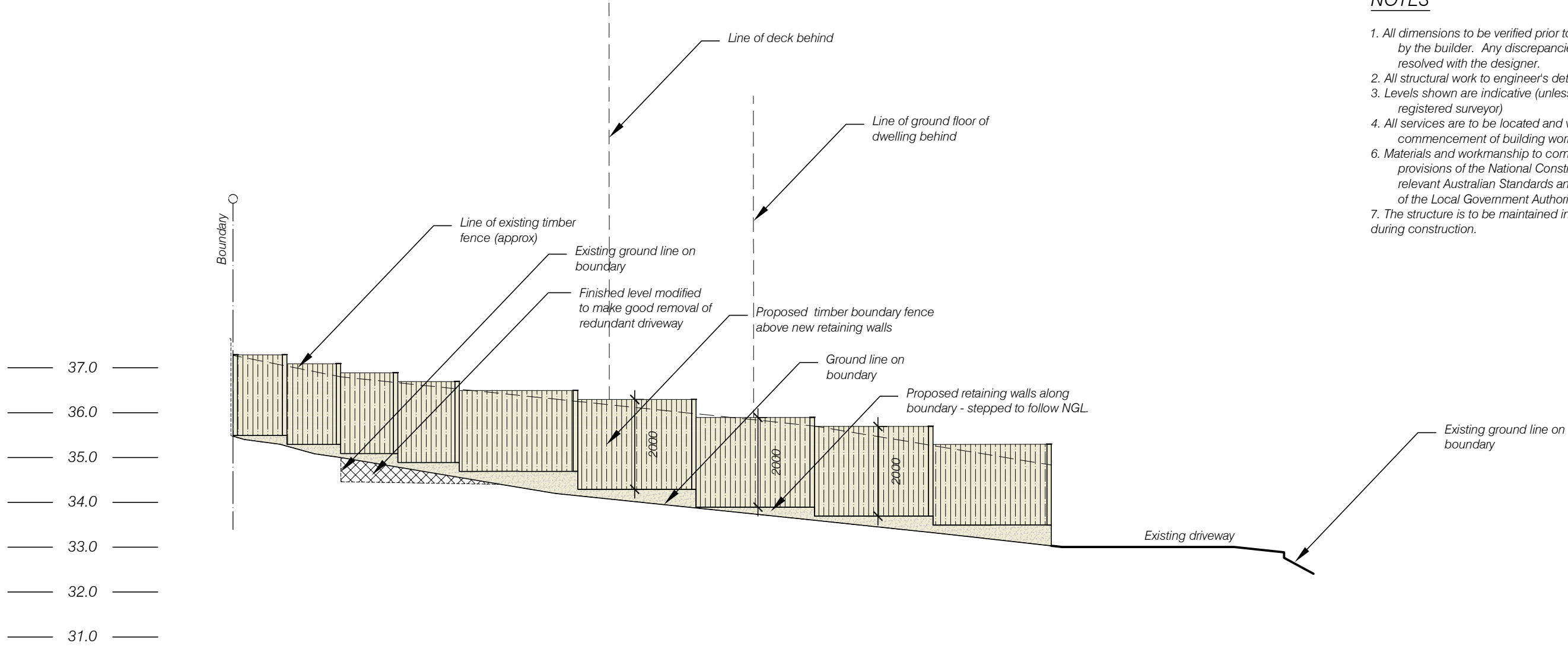

PLAYFAIR ROAD ELEVATION

 northern
beaches
council

**THIS PLAN IS TO BE READ IN
CONJUNCTION WITH
THE CONDITIONS OF DEVELOPMENT
CONSENT**

DA2021/1096

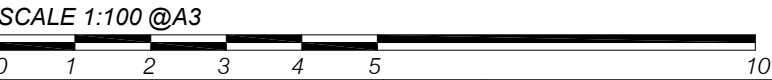

DRAWN BY
Unit 20
12 Phillip Mall
West Pymble 2073

outside
LIVING

Phone 9440 5451 Facsimile 9402 6499
ABN 97 077 163 663
Fellow of Australian Institute of Landscape Designers and Managers

NOTES TO THE PLAN

THIS PLAN IS TO BE READ AS PART OF A COMPLETE SET OF DRAWINGS RELATING TO THE PROPOSED DEVELOPMENT

THIS PLAN RELATES TO A SPECIFIC DEVELOPMENT INFORMATION RELATING TO THE DEVELOPMENT NEEDS TO BE CONFIRMED ON SITE PRIOR TO CONSTRUCTION

ALL MEASUREMENTS ARE IN MILLIMETRES UNLESS OTHERWISE INDICATED

CLIENT
HAINES AND MOSS RESIDENCE

SITE
**26 PARR AVE
NORTH CURL CURL**

DRAWING
PLAYFAIR ROAD ELEVATION

PROJECT
**PROPOSED SWIMMING POOL
AND LANDSCAPING**

Date of Issue
A 26-02-21
B 24-05-21

JOB No
21-02

ISSUE
B

DWG No
7