

M.G.A. NORTH

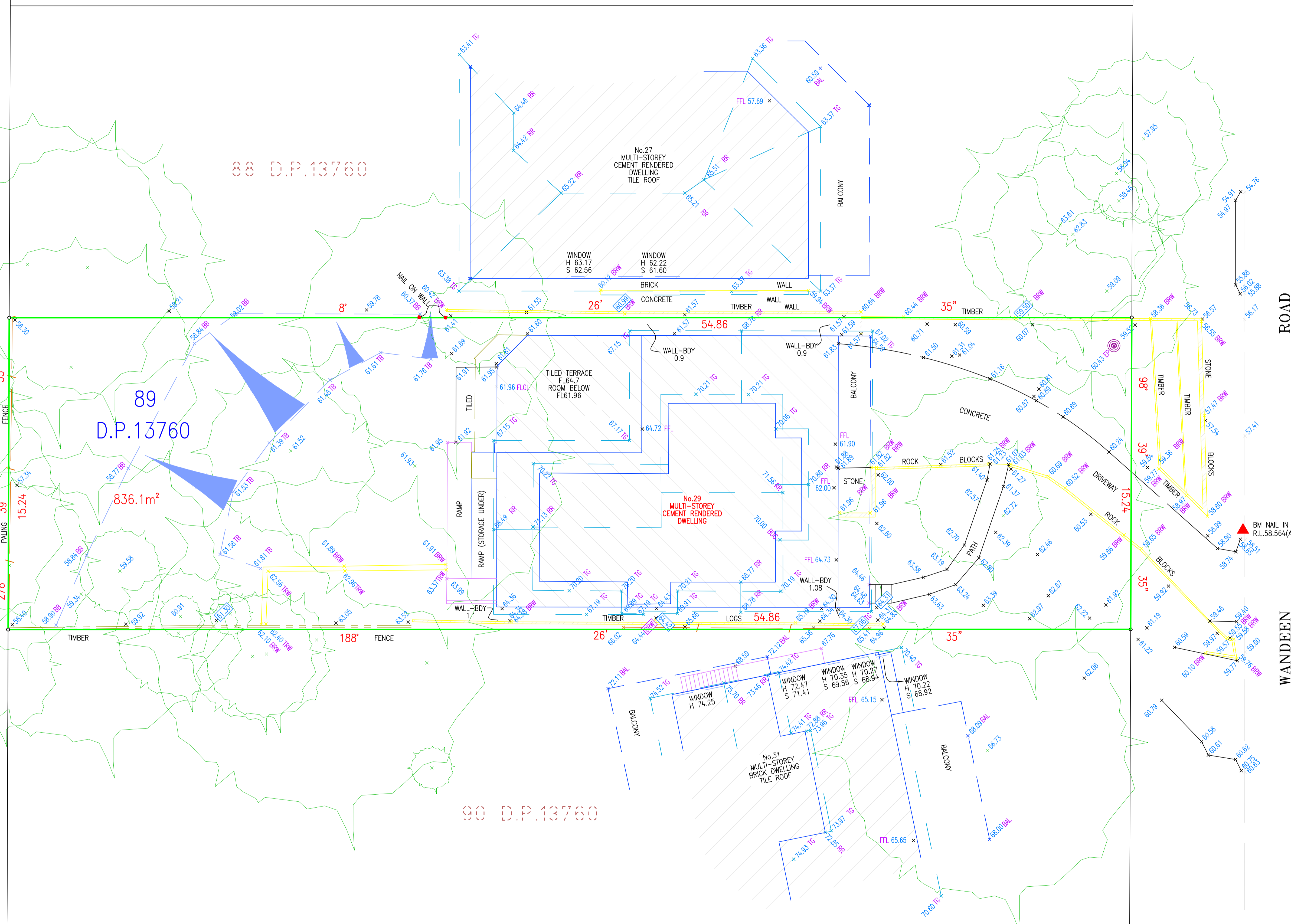

51.30 SSM



88 D.P.13760

89 D.P.13760
836.1m²

90 D.P.13760

ROAD

WANDEEN

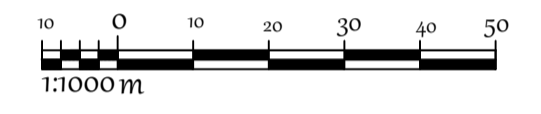

REV	DATE	DESCRIPTION	BY
E	23.09.2024	GENERAL PLAN UPDATE	IS
D	8.03.2021	BOUNDARY MARKS ADDED	IS
C	10.12.2020	BOUNDARY SURVEY AND MGA	IS
B	17.10.2018	REAR UPDATED	IS
A	19.09.2014	ORIGINAL ISSUE	IS

- NOTES:
- BOUNDARY SURVEY HAS BEEN COMPLETED.
 - RELATIONSHIP OF IMPROVEMENTS AND DETAIL TO BOUNDARIES IS DIAGRAMMATIC ONLY AND SPECIFIC DETAILS, IF CRITICAL, WILL REQUIRE FURTHER SURVEY.
 - NO SERVICES OR UNDERGROUND SERVICES SEARCH HAS BEEN UNDERTAKEN. SERVICES SHOWN ARE BASED ON VISIBLE SURFACE INDICATORS EVIDENT AT THE DATE OF SURVEY & ARE CHARTED AS A GUIDE TO THE POSITION & NATURE OF THE SERVICE. ALL SERVICE AUTHORITIES SHOULD BE CONTACTED PRIOR TO ANY DEVELOPMENT.
 - RIDGE, EAVE & GUTTER HEIGHTS HAVE BEEN OBTAINED BY AN INDIRECT METHOD AND ARE ACCURATE FOR PLANNING PURPOSES ONLY.
 - ADJOINING BUILDINGS AND DWELLINGS HAVE BEEN PLOTTED FOR DIAGRAMMATIC PURPOSES ONLY AND SPECIFIC DETAILS, IF CRITICAL, WILL REQUIRE FURTHER SURVEY.
 - THE SPREAD & HEIGHT OF EACH TREE IS INDICATIVE ONLY AND SPECIFIC DETAILS, IF CRITICAL, WILL REQUIRE FURTHER SURVEY.
 - CONTOURS ARE AN INDICATION OF THE TOPOGRAPHY ONLY. SPOT LEVELS SHOULD BE USED IF DETAILED DESIGN IS TO BE UNDERTAKEN. CONTOUR INTERVALS: MAJOR - N/A, MINOR - N/A.

HORIZONTAL SYSTEM: MGA 2020
 MARK ADOPTED:
 E 333 000.000
 N 6 000 000.000
 VERTICAL SYSTEM: A.H.D. 71
 BM ADOPTED SSM 38123
 R.L.51.3 CLASS E ORDER

CLIENT:
 MR PETER QUIRK
 PROJECT:
 PLAN SHOWING DETAIL AND LEVELS AT
 No.29 WANDEEN ROAD
 CLAREVILLE



SCALE: HOR 1:100	VER 1:100	A1
LGA: NORTHERN BEACHES	SHEET 01 OF 01 SHEETS	
DRAWN A.L.	SURVEYED I.S.	
REFERENCE	REVISION	
140802-DET	E	