



# Consulting Engineers

## STRUCTURAL - CIVIL - STORMWATER - REMEDIAL

**GENERAL NOTES:**

- G1. THIS DRAWING IS NOT TO BE USED FOR CONSTRUCTION IF THE ISSUE DATE PRECEDES THE ISSUE DATE ON THE LATEST ARCHITECTURAL DRAWINGS.
- G2. DO NOT SCALE FROM THIS DRAWING.
- G3. ALL DIMENSIONS ARE TO BE VERIFIED ON SITE BY THE BUILDER BEFORE COMMENCING WITH ASSOCIATED WORK.

**CIVIL GENERAL NOTES:**

- GN1. ALL WORKS SHALL BE CARRIED OUT IN ACCORDANCE WITH AUSTRALIAN STANDARDS AND THE REQUIREMENTS OF LOCAL COUNCIL AND ANY APPLICABLE AUTHORITIES.
- GN2. NB CONSULTING TAKES NO RESPONSIBILITY AND ACCURACY OF SURVEY INFORMATION. SURVEY INFORMATION AND LEVELS TO BE CONFIRMED PRIOR TO CONSTRUCTION.
- GN3. FOR EXISTING CONTOURS AND LEVELS, REFER SURVEY PLAN. ALL LEVELS AND DIMENSIONS TO BE CONFIRMED PRIOR TO CONSTRUCTION.
- GN4. ALL BATTERS, RETAINING WALLS, SHORING AND BULK EARTHWORKS TO FUTURE DETAILS BY OTHERS. ALL RETAINING WALLS GREATER THAN 900mm HIGH TO BE DESIGNED BY A QUALIFIED ENGINEER.
- GN5. APPROVAL REQUIRED WITH RELEVANT AUTHORITIES PRIOR TO RETAINING WALLS, SHORING, AND BATTERS IMPACTING NEIGHBOURING PROPERTIES AND INFRASTRUCTURE BEYOND BOUNDARIES.
- GN6. DRIVEWAY CROSSOVER & LAYBACK IN ACCORDANCE WITH COUNCIL SPECIFICATIONS AND DETAILS. UNLESS NOTED OTHERWISE.
- GN7. NATURE STRIP, PAVEMENT, GUTTER & FOOTWAY CROSSINGS TO COUNCIL SPECIFICATIONS.
- GN8. FILLING & REGRADING OF NATURE STRIP MAY BE REQUIRED TO ENSURE LEVELS AND GRADES MATCH ADJACENT LEVELS TO COUNCIL REQUIREMENTS & DETAILS.
- GN9. CONCRETE DRIVEWAY & JOINTING PLAN BY OTHERS.
- GN10. IMPACT OF PROPOSED WORKS ON EXISTING TREE/S. REFER ARCHITECT AND/OR ARBORIST REPORT FOR DETAILS AND SPECIFICATIONS.
- GN11. TRAFFIC CONTROL SIGNAGE AND TRAFFIC CONTROL MEASURES BY OTHERS.
- GN12. LINES AND MARKINGS BY OTHERS TO CONFORM TO MAIN ROADS 'MANUAL OF UNIFORM TRAFFIC CONTROL DEVICES.
- GN13. DISABLED PARKING SIGNAGE TO AS2890.
- GN14. DISABLED PARKING TO COMPLY WITH AS2890.6. REFER ARCHITECT FOR SPECIFICATIONS AND DETAILS.
- GN15. REFER ARCHITECT FOR LATEST PLANS AND EXTENTS OF PROPOSED BUILDING WORKS & STRUCTURES. TO BE CONFIRMED PRIOR TO CONSTRUCTION.
- GN16. COUNCIL APPROVAL MAY BE REQUIRED PRIOR TO COMMENCING CONSTRUCTION.
- GN17. NOTICE PRIOR TO COMMENCEMENT OR WORKS: AT LEAST SEVEN (7) DAYS BEFORE COMMENCEMENT OF ANY EXCAVATION OR DEMOLITION WORKS, THE BUILDER OR CLIENT MUST GIVE NOTICE TO THE OWNER(S) OF THE ADJOINING PROPERTY(S) AND PROVIDE DETAILS OF THE PROPOSED WORKS. FURTHER, THE ADJOINING OWNER MUST BE MADE AWARE OF THE RISK OF MINOR CRACKING DUE TO VIBRATIONS DURING CONSTRUCTION. THE BUILDER OR CLIENT IS RESPONSIBLE TO RECTIFY ANY DAMAGE WHICH MAY OCCUR AT THEIR OWN COST.
- GN18. ANY EXCAVATION MUST NOT EXTEND BELOW NEIGHBOURING FOOTINGS. THE BUILDER MUST IMMEDIATELY NOTIFY THE STRUCTURAL AND GEOTECHNICAL ENGINEER IF, AT ANY TIME, EXCAVATION INADVERTENTLY EXTENDS BELOW NEIGHBOURING FOOTINGS. THE ENGINEERS WILL BOTH NEED TO COME OUT AND INSPECT AND IF NECESSARY PROVIDE UNDERPINNING OR ADDITIONAL SUPPORT DETAILS.
- GN19. GARAGE ENTRY STEP GRADED AS PER ARCHITECTS SPECIFICATIONS & DETAILS.
- GN20. VEHICLE BARRIERS & BALUSTRADING IN ACCORDANCE WITH AUSTRALIAN STANDARDS. REFER ARCHITECT FOR SPECIFICATIONS AND DETAILS.
- GN21. VEHICLE CRASH BARRIERS AND BALUSTRADING TO COMPLY WITH AS3845 ROAD SAFETY BARRIER SYSTEMS AND DEVICES. REFER ARCHITECT FOR SPECIFICATIONS AND DETAILS.

**VEHICLE PROFILE NOTES**

- VP1. ANY VEHICLE PROFILE ANALYSIS SUCH AS THE B85 PROFILE IS NORMALLY UNDERTAKEN ALONG THE DETAILED LONGITUDINAL SECTIONS WHICH HAVE GENERALLY BEEN LOCATED IN ACCORDANCE WITH COUNCIL POLICY. UNLESS NOTED OTHERWISE, THIS MAY NOT NECESSARILY REPRESENT THE WORSE CASE ANALYSIS.
- VP2. SWEPT PATH ANALYSIS HAS ONLY BEEN UNDERTAKEN AS THAT SHOWN, REFER SWEPT PATH ANALYSIS PLAN/S.

**AS2890.1 OFF-STREET CAR PARKING NOTES:**

- CP1. PARKING SPACE REQUIREMENTS TO COMPLY WITH AS2890.1. REFER ARCHITECT FOR SPECIFICATIONS AND DETAILS.
- CP2. MINIMUM DRIVEWAY WIDTHS, CLEARANCES, INCLUDING HEAD CLEARANCES TO COMPLY WITH AS2890.1 REFER ARCHITECT FOR SPECIFICATIONS & DETAILS.
- CP3. GARAGE DOORWAY OPENING WIDTH BY OTHERS REFER ARCHITECT FOR SPECIFICATIONS AND DETAILS TO COMPLY WITH AS2890.1.
- CP4. BARRIERS REQUIRED WHERE DRIVEWAY DROP EXCEEDS 600mm. WHEEL STOP REQUIRED WHERE DRIVEWAY DROP IS BETWEEN 150-600mm. REFER AS2890.1. REFER ARCHITECT & LANDSCAPE ARCHITECT FOR SPECIFICATIONS AND DETAILS.
- CP5. VEHICULAR SIGHT LINES TO COMPLY WITH AS2890.1.

**AS2890.2 OFF-STREET COMMERCIAL VEHICLE NOTES:**

- CV1. MINIMUM DRIVEWAY WIDTHS, CLEARANCES, INCLUDING HEAD CLEARANCES TO COMPLY WITH AS2890.2 REFER ARCHITECT FOR SPECIFICATIONS & DETAILS.
- CV2. VEHICULAR SIGHT LINES TO COMPLY WITH AS2890.2.

**CIVIL STORMWATER NOTES**

- CS1. APPROVAL MAY BE REQUIRED WITH RELEVANT AUTHORITIES PRIOR TO RETAINING WALLS, SHORING, BATTERS & DRAINAGE IMPACTING NEIGHBOURING PROPERTIES AND INFRASTRUCTURE BEYOND BOUNDARIES.
- GS2. STORMWATER AND DRAINAGE BY OTHERS TO AS3500 AND COUNCIL SPECIFCATIONS AND DETAILS.
- GS3. DRIVEWAY AND CIVIL WORKS DRAINAGE SUCH AS GRATED DRAINS & PITS HAVE NOT BEEN SHOWN. REFER ARCHITECT AND/OR HYDRAULIC ENGINEER FOR SPECIFICATIONS & DETAILS. PRIOR APPROVAL MAY BE REQUIRED WITH COUNCIL PRIOR TO CONSTRUCTION.
- CS4. EXISTING DRAINAGE ACROSS NATURE STRIP & KERBS IMPACTING PROPOSED WORKS TO BE RELOCATED OR UPGRADED AS REQUIRED BY OTHERS IN AN APPROVED MANNER. REFER ARCHITECT FOR SPECIFICATIONS AND DETAILS.
- CS5. STORMWATER FLOOD ANALYSIS AND/OR FREEBOARD LEVELS IF REQUIRED HAVE NOT BEEN PROVIDED FOR THIS CIVIL/DRIVEWAY ACCESS PLAN. COUNCIL TO CONFIRM IF REQUIRED PRIOR TO CONSTRUCTION.

**CADASTRAL REFERENCE MARKS, SURVEY PMs OR SSMs**

- RS1. PURSUANT TO THE SURVEYING AND SPATIAL INFORMATION ACT, ANY CADASTRAL REFERENCE MARKS, SURVEY PMs OR SSMs THAT ARE ON KERBS, FOOTPATHS OR SIMILAR THAT MAY BE AFFECTED BY CONSTRUCTION OR MAINTENANCE, NEED TO BE IDENTIFIED AND SURVEYED BY A REGISTERED LAND SURVEYOR BEFORE THEY ARE DESTROYED OR DISTURBED, PERSONAL FINES APPLY FOR BREACHES OF THE ACT.

**DIAL BEFORE YOU DIG NOTE:**

- NO INVESTIGATION OF UNDERGROUND SERVICES HAS BEEN MADE. ALL RELEVANT AUTHORITIES SHOULD BE NOTIFIED PRIOR TO ANY EXCAVATION ON OR NEAR THE SITE DEVELOPERS & EXCAVATORS MAY BE HELD FINANCIALLY RESPONSIBLE BY THE ASSET OWNER SHOULD THEY DAMAGE UNDERGROUND NETWORKS.

**CARELESS DIGGING CAN:**

- CAUSE DEATH OR SERIOUS INJURY TO WORKERS AND THE GENERAL PUBLIC
- INCONVENIENCE USERS OF ELECTRICITY, GAS, WATER AND COMMUNICATIONS
- LEAD TO CRIMINAL PROSECUTION AND DAMAGES CLAIMS
- CAUSE EXPENSIVE FINANCIAL LOSSES TO BUSINESS
- CUT OFF EMERGENCY SERVICES
- DELAY PROJECT COMPLETION TIMES WHILE THE DAMAGE IS REPAIRED



MINIMISE YOUR RISK AND CONTACT [www.byda.com.au](http://www.byda.com.au) BEFORE YOU DIG.

**DRAWING SCHEDULE:**

- C01 - CIVIL GENERAL NOTES & DRAWING SCHEDULE
- C02 - DRIVEWAY ACCESS PLANS
- C03 - PROPOSED CONTOUR & SPOT LEVEL LAYOUT PLAN (APPROXIMATE)
- C04 - LONGITUDINAL SECTIONS - SHEET 1
- C05 - LONGITUDINAL SECTIONS - SHEET 2
- C06 - LONGITUDINAL SECTIONS - SHEET 3

Scale check - 100mm when printed to scale

AI

--	--	--	--	--	--	--	--	--	--	--	--	--	--	--	--	--	--	--	--	--	--	--	--	--	--	--	--	--	--	--	--	--	--	--	--	--	--	--	--	--	--	--	--	--	--	--	--	--	--	--	--	--	--	--	--	--	--	--	--	--	--	--	--	--	--	--	--	--	--	--	--	--	--	--	--	--	--	--	--	--	--	--	--	--	--	--	--	--	--	--	--	--	--	--	--	--	--	--	--	--	--	--	--	--	--	--	--	--	--	--	--	--	--	--	--	--	--	--	--	--	--	--	--	--	--	--	--	--	--	--	--	--	--	--	--	--	--	--	--	--	--	--	--	--	--	--	--	--	--	--	--	--	--	--	--	--	--	--	--	--	--	--	--	--	--	--	--	--	--	--	--	--	--	--	--	--	--	--	--	--	--	--	--	--	--	--	--	--	--	--	--	--	--	--	--	--	--	--	--	--	--	--	--	--	--	--	--	--	--	--	--	--	--	--	--	--	--	--	--	--	--	--	--	--	--	--	--	--	--	--	--	--	--	--	--	--	--	--	--	--	--	--	--	--	--	--	--	--	--	--	--	--	--	--	--	--	--	--	--	--	--	--	--	--	--	--	--	--	--	--	--	--	--	--	--	--	--	--	--	--	--	--	--	--	--	--	--	--	--	--	--	--	--	--	--	--	--	--	--	--	--	--	--	--	--	--	--	--	--	--	--	--	--	--	--	--	--	--	--	--	--	--	--	--	--	--	--	--	--	--	--	--	--	--	--	--	--	--	--	--	--	--	--	--	--	--	--	--	--	--	--	--	--	--	--	--	--	--	--	--	--	--	--	--	--	--	--	--	--	--	--	--	--	--	--	--	--	--	--	--	--	--	--	--	--	--	--	--	--	--	--	--	--	--	--	--	--	--	--	--	--	--	--	--	--	--	--	--	--	--	--	--	--	--	--	--	--	--	--	--	--	--	--	--	--	--	--	--	--	--	--	--	--	--	--	--	--	--	--	--	--	--	--	--	--	--	--	--	--	--	--	--	--	--	--	--	--	--	--	--	--	--	--	--	--	--	--	--	--	--	--	--	--	--	--	--	--	--	--	--	--	--	--	--	--	--	--	--	--	--	--	--	--	--	--	--	--	--	--	--	--	--	--	--	--	--	--	--	--	--	--	--	--	--	--	--	--	--	--	--	--	--	--	--	--	--	--	--	--	--	--	--	--	--	--	--	--	--	--	--	--	--	--	--	--	--	--	--	--	--	--	--	--	--	--	--	--	--	--	--	--	--	--	--	--	--	--	--	--	--	--	--	--	--	--	--	--	--	--	--	--	--	--	--	--	--	--	--	--	--	--	--	--	--	--	--	--	--	--	--	--	--	--	--	--	--	--	--	--	--	--	--	--	--	--	--	--	--	--	--	--	--	--	--	--	--	--	--	--	--	--	--	--	--	--	--	--	--	--	--	--	--	--	--	--	--	--	--	--	--	--	--	--	--	--	--	--	--	--	--	--	--	--	--	--	--	--	--	--	--	--	--	--	--	--	--	--	--	--	--	--	--	--	--	--	--	--	--	--	--	--	--	--	--	--	--	--	--	--	--	--	--	--	--	--	--	--	--	--	--	--	--	--	--	--	--	--	--	--	--	--	--	--	--	--	--	--	--	--	--	--	--	--	--	--	--	--	--	--	--	--	--	--	--	--	--	--	--	--	--	--	--	--	--	--	--	--	--	--	--	--	--	--	--	--	--	--	--	--	--	--	--	--	--	--	--	--	--	--	--	--	--	--	--	--	--	--	--	--	--	--	--	--	--	--	--	--	--	--	--	--	--	--	--	--	--	--	--	--	--	--	--	--	--	--	--	--	--	--	--	--	--	--	--	--	--	--	--	--	--	--	--	--	--	--	--	--	--	--	--	--	--	--	--	--	--	--	--	--	--	--	--	--	--	--	--	--	--	--	--	--	--	--	--	--	--	--	--	--	--	--	--	--	--	--	--	--	--	--	--	--	--	--	--	--	--	--	--	--	--	--	--	--	--	--	--	--	--	--	--	--	--	--	--	--	--	--	--	--	--	--	--	--	--	--	--	--	--	--	--	--	--	--	--	--	--	--	--	--	--	--	--	--	--	--	--	--	--	--	--	--	--	--	--	--	--	--	--	--	--	--	--	--	--	--	--	--	--	--	--	--	--	--	--	--	--	--	--	--	--	--	--	--	--	--	--	--	--	--	--	--	--	--	--	--	--	--	--	--	--	--	--	--	--	--	--	--	--	--	--	--	--	--	--	--	--	--	--	--	--	--	--	--	--	--	--	--	--	--	--	--	--	--	--	--	--	--	--	--	--	--	--	--	--	--	--	--	--	--	--	--	--	--	--	--	--	--	--	--	--	--	--	--	--	--	--	--	--	--	--	--	--	--	--	--	--	--	--	--	--	--	--	--	--	--	--	--	--	--	--	--	--	--	--	--	--	--	--	--	--	--	--	--	--	--	--	--	--	--	--	--	--	--	--	--	--	--	--	--	--	--	--	--	--	--	--	--	--	--	--	--	--	--	--	--	--	--	--	--	--	--	--	--	--	--	--	--	--	--	--	--	--	--	--	--	--	--	--	--	--	--	--	--	--	--	--	--	--	--	--	--	--	--	--	--	--	--	--	--	--	--	--	--

ISSUED FOR  
DA SUBMISSION ONLY  
NOT FOR  
CONSTRUCTION

IF IN DOUBT ASK

NB Consulting Engineers



LEGEND:

- CHAINAGES
- PROPOSED DRIVEWAY/FOOTPATH OUTLINE

COUNCIL DRIVEWAY  
CROSSOVER PROFILE NOTES

COUNCIL: NORTHERN BEACHES COUNCIL  
PROFILE/TITLE: EXTRA LOW STANDARD  
VEHICLE CROSSING PROFILE  
DRAWING: PLAN No.: A4 3330/5 EL  
DATED: LAST AMENDED DEC 2006

NOTES:

- THIS DRAWING IS NOT TO BE USED FOR CONSTRUCTION IF THE ISSUE DATE PRECEDES THE ISSUE DATE ON THE ARCHITECTURAL DRAWINGS.
- DO NOT SCALE FROM THIS DRAWING.
- ALL DIMENSIONS ARE TO BE VERIFIED ON SITE BY THE BUILDER BEFORE COMMENCING WITH ASSOCIATED WORK.
- FOR GENERAL NOTES REFER TO DRAWING NUMBER: C01.

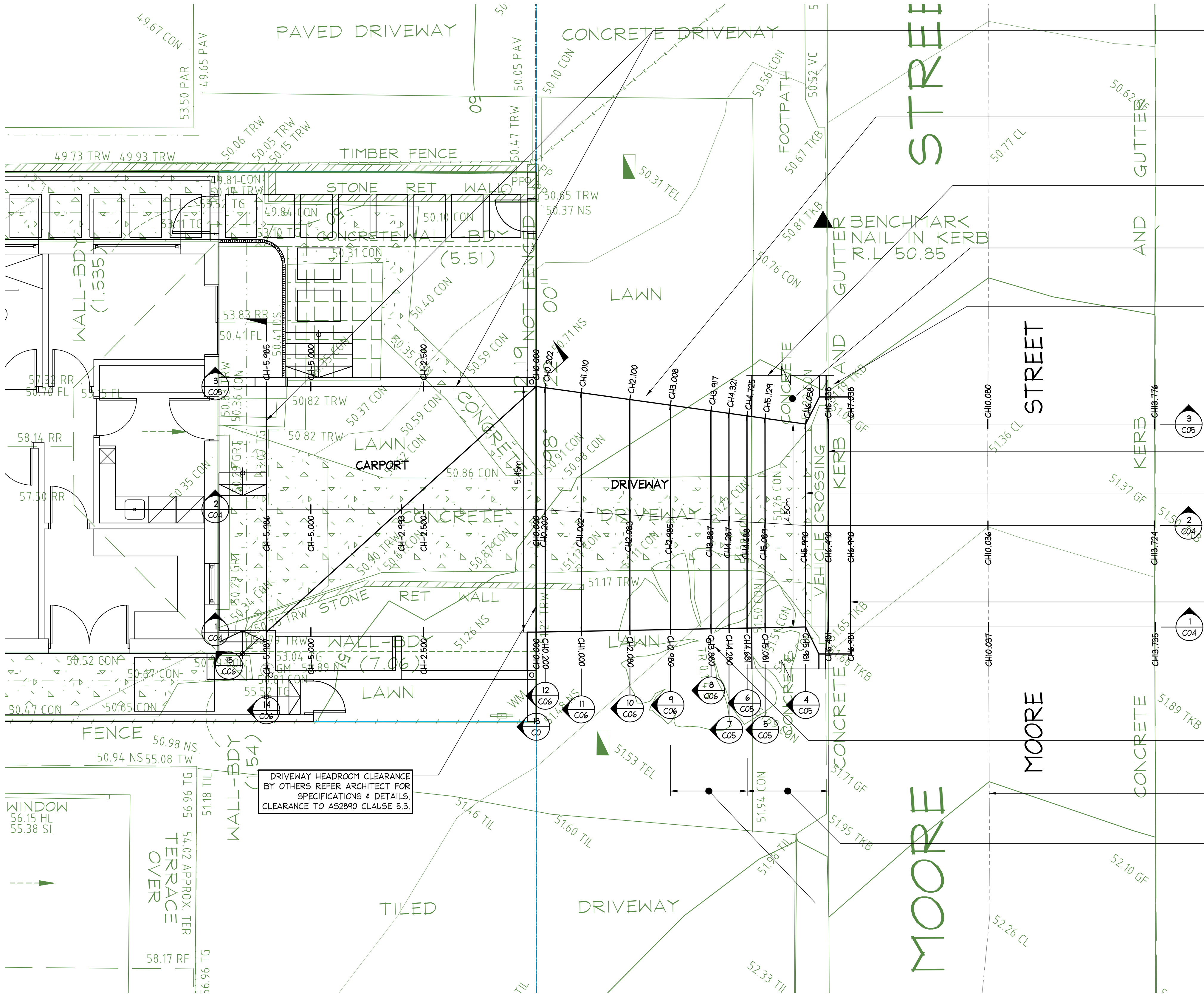
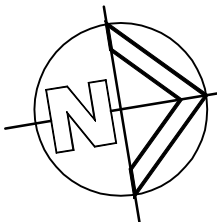

VEHICLE CRASH BARRIERS REQUIRED WHERE DRIVEWAY DROP EXCEEDS 600mm. 150 MIN HIGH WHEEL STOP REQUIRED WHERE DRIVEWAY DROP IS BETWEEN 150-600mm. REFER AUSTRALIAN STANDARDS AS2890.1. REFER ARCHITECT FOR SPECIFICATIONS AND DETAILS - TYPICAL.

FILLING & REGRADING OF NATURE STRIP MAY BE REQUIRED TO ENSURE LEVELS AND GRADES MATCH ADJACENT LEVELS TO COUNCIL REQUIREMENTS & DETAILS - TYPICAL

TRANSITION FOOTPATH TO MATCH EXISTING LEVELS IN ACCORDANCE WITH COUNCIL SPECIFICATIONS AND DETAIL. EXTENTS TO BE CONFIRMED PRIOR TO CONSTRUCTION - TYPICAL.

RECONSTRUCT FOOTPATH IN ACCORDANCE WITH COUNCIL SPECIFICATIONS AND DETAILS. EXTENTS, GRADES AND LEVELS TO BE CONFIRMED PRIOR TO CONSTRUCTION - TYPICAL.

TRANSITION LAYBACK INTO EXISTING SURROUNDING ROADWAY & KERB GUTTER TO COUNCIL REQUIREMENTS - TYPICAL

LOCATION OF LAYBACK TO BE CONFIRMED PRIOR TO CONSTRUCTION. INFORM ENGINEER OF ANY CHANGES TO CHAINAGES

DUE TO THE EXISTING ROAD CAMBER THE LAYBACK HAS BEEN MODIFIED TO A NON-STANDARD LAYBACK TO ACCOMMODATE THE B85 VEHICLE PROFILE TEMPLATE

EXISTING KERB & GUTTER LIP (LIP) LEVEL HAS BEEN INTERPOLATED. TO BE CONFIRMED PRIOR TO CONSTRUCTION.

EXISTING TREE REFER ARBORIST AND COUNCIL REQUIREMENTS TO CONFIRM IF TREE IS TO BE REMOVED OR RETAINED?

ROAD CENTRELINE AS PER SURVEY. TO BE CONFIRMED PRIOR TO CONSTRUCTION

1.8m PROJECTED OFFSET AS PER COUNCIL PROFILE

1.7m PROJECTED OFFSET AS PER COUNCIL PROFILE

DRIVEWAY ACCESS PLAN

SCALE = 1 : 50

ISSUED FOR  
DA SUBMISSION ONLY  
NOT FOR  
CONSTRUCTION

IF IN DOUBT ASK

NB Consulting Engineers

DOCUMENT CERTIFICATION				Architect:		Project:		Date:	Design:	Drawn:	
Date : 6 Jun '23 Michael Wachjo B.E.(Civil), MIEAust. (Director NB Consulting Engineers)				HOBBS JAMIESON ARCHITECTURE		PROPOSED DRIVEWAY AT 17 MOORE STREET, CLONTARF		JUN 2023	D.K.	D.K.	
The copyright of this drawing remains with Northern Beaches Consulting Engineers Pty Ltd. Trading as NB Consulting Engineers				Client:		Drawing Title:		Job No:		Drawing No:	
By: Review:				HP CONSTRUCTIONS		DRIVEWAY ACCESS PLANS		2301041		C02	
5/06/2023 A ISSUED FOR DA SUBMISSION ONLY - NOT FOR CONSTRUCTION										A	



**FFL 10.100** X FFL AND/OR SPOT LEVEL REFER ARCHITECT. TO BE CONFIRMED PRIOR TO CONSTRUCTION

**DES 7.080** X PROPOSED DESIGN SPOT LEVEL

**EX 7.080** X EXISTING SURFACE SPOT LEVEL REFER SURVEY PLANS. TO BE CONFIRMED PRIOR TO CONSTRUCTION.



PROPOSED DESIGN CONTOURS & SPOT  
LEVELS ARE INDICATIVE ONLY. ALL  
LEVELS TO BE CONFIRMED PRIOR TO  
CONSTRUCTION. DO NOT SCALE.

SLOPE RANGES [%]	COLOUR
0.50 to 2.00	Blue
2.00 to 3.00	Cyan
3.00 to 5.00	Green
5.00 to 6.25	Magenta
6.25 to 15.00	Orange
15.00 to 25.00	Pink
25.00 to 30.00	Red

1) SLOPE ARROWS TO BE READ IN COLOUR ONLY. DO NOT INTERPRET DATA IN BLACK & WHITE PRINT.

1. THIS DRAWING IS NOT TO BE USED FOR CONSTRUCTION IF THE ISSUE DATE PRECEDES THE ISSUE DATE ON THE ARCHITECTURAL DRAWINGS.
2. DO NOT SCALE FROM THIS DRAWING.
3. ALL DIMENSIONS ARE TO BE VERIFIED ON SITE BY THE BUILDER BEFORE COMMENCING WITH ASSOCIATED WORK.
4. FOR GENERAL NOTES REFER TO DRAWING NUMBER: 001.

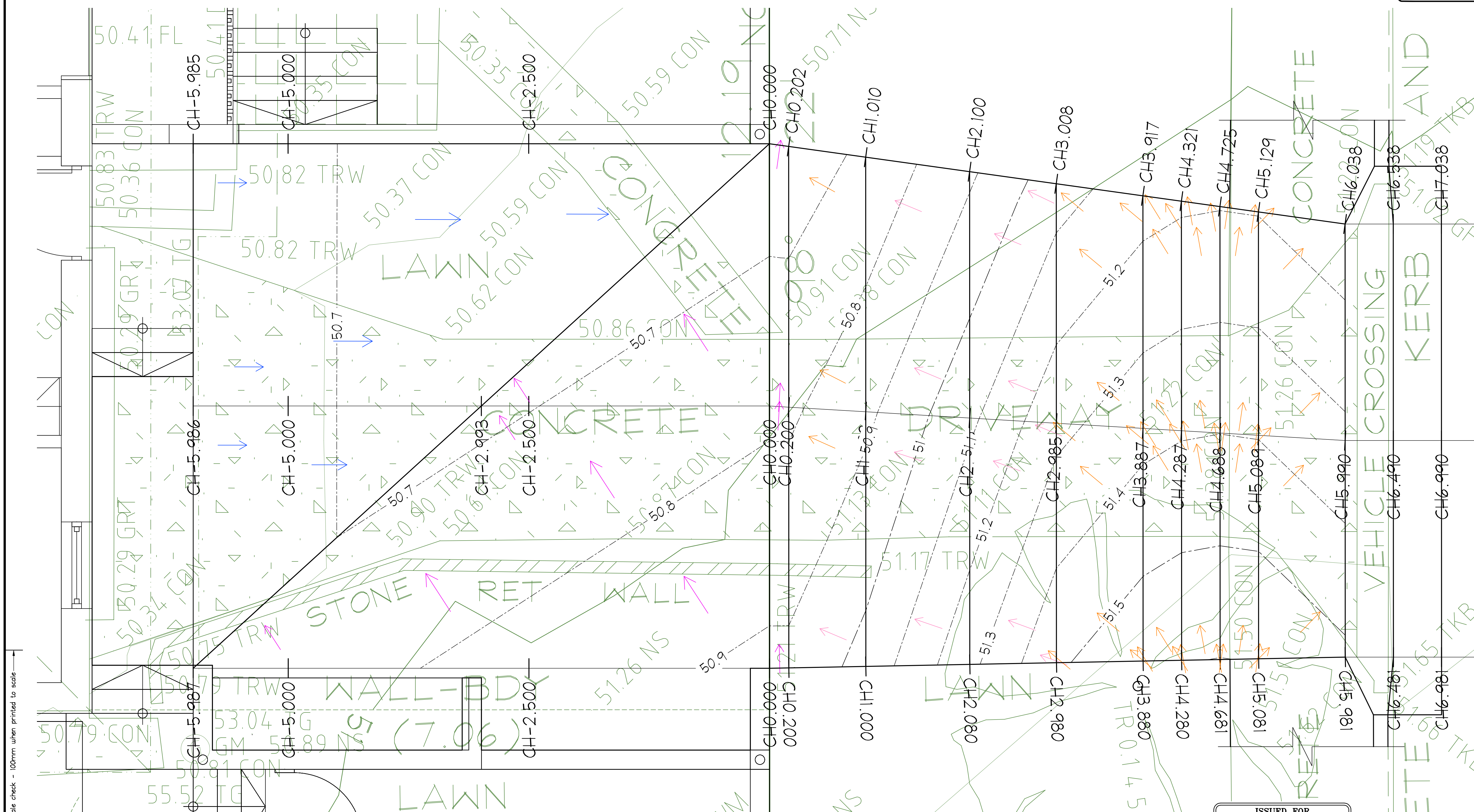

PROPOSED CONTOUR & SPOT LEVELS LAYOUT PLAN (APPROXIMATE)

NOT TO SCALE

ISSUED FOR  
DA SUBMISSION ONLY  
NOT FOR  
CONSTRUCTION

IF IN DOUBT ASK

									DOCUMENT CERTIFICATION			 <b>NB Consulting Engineers</b> STRUCTURAL - CIVIL - STORMWATER - REMEDIAL A.C.N. 076 121 616 A.B.N. 24 076 121 616 <b>Sydney:</b> Ph: (02) 9984 7000 Suite 207, 30 Fisher Road Dee Why N.S.W. 2099 <b>Gold Coast:</b> Ph: (07) 5631 4744 30 Griffith Street Coolangatta QLD 4225 E : nb@nbconsulting.com.au W : www.nbconsulting.com.au			Architect: <b>HOBBS JAMIESON ARCHITECTURE</b>			Project: <b>PROPOSED DRIVEWAY AT 17 MOORE STREET, CLONTARF</b>			Date: <b>JUN 2023</b>	Design: <b>D.K.</b>	Drawn: <b>D.K.</b>	
05/06/2023			A	ISSUED FOR DA SUBMISSION ONLY - NOT FOR CONSTRUCTION					D.K.			M.H.	Date : 6 Jun '23 <b>Michael Wachjo</b>  B.E.(Civil), MIEAust. (Director NB Consulting Engineers)			Client: <b>HP CONSTRUCTIONS</b>			Drawing Title: <b>PROPOSED CONTOUR &amp; SPOT LEVELS LAYOUT PLAN (APPROXIMATE)</b>			Job No: <b>2301041</b>	Drawing No: <b>C03</b>	Issue: <b>A</b>
Date:	Issue:	Description:					By:	Review:	The copyright in this drawing remains with Northern Beaches Consulting Engineers Pty Ltd. Trading as NB Consulting Engineers															



**N3 Consulting Engineers**



VEHICLE CRASH BARRIERS REQUIRED WHERE DRIVEWAY DROP EXCEEDS 600mm. 150 MIN HIGH WHEEL STOP REQUIRED WHERE DRIVEWAY DROP IS BETWEEN 150-600mm. REFER AUSTRALIAN STANDARDS AS2890.1. REFER ARCHITECT FOR SPECIFICATIONS AND DETAILS - TYPICAL.

REFER ARCHITECTURAL FOR EXTENTS, SPECIFICATIONS AND DETAILS - TYPICAL

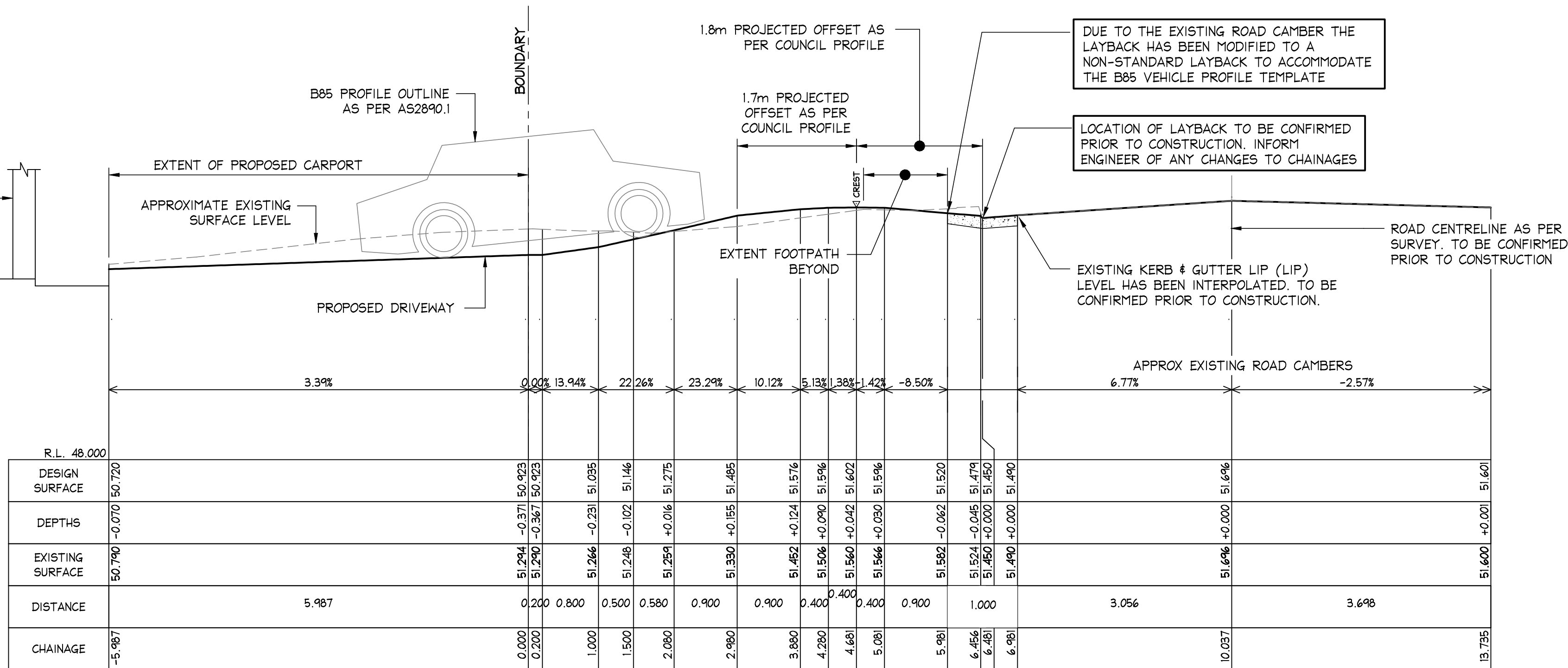

LONGITUDINAL SECTION DRIVEWAY  
FROM CH: -5.987 TO CH: 13.735  
SCALES: HORIZONTAL 1:50 VERTICAL 1:50

SECTION 1  
C02

VEHICLE CRASH BARRIERS REQUIRED WHERE DRIVEWAY DROP EXCEEDS 600mm. 150 MIN HIGH WHEEL STOP REQUIRED WHERE DRIVEWAY DROP IS BETWEEN 150-600mm. REFER AUSTRALIAN STANDARDS AS2890.1. REFER ARCHITECT FOR SPECIFICATIONS AND DETAILS - TYPICAL.

REFER ARCHITECTURAL FOR EXTENTS, SPECIFICATIONS AND DETAILS - TYPICAL

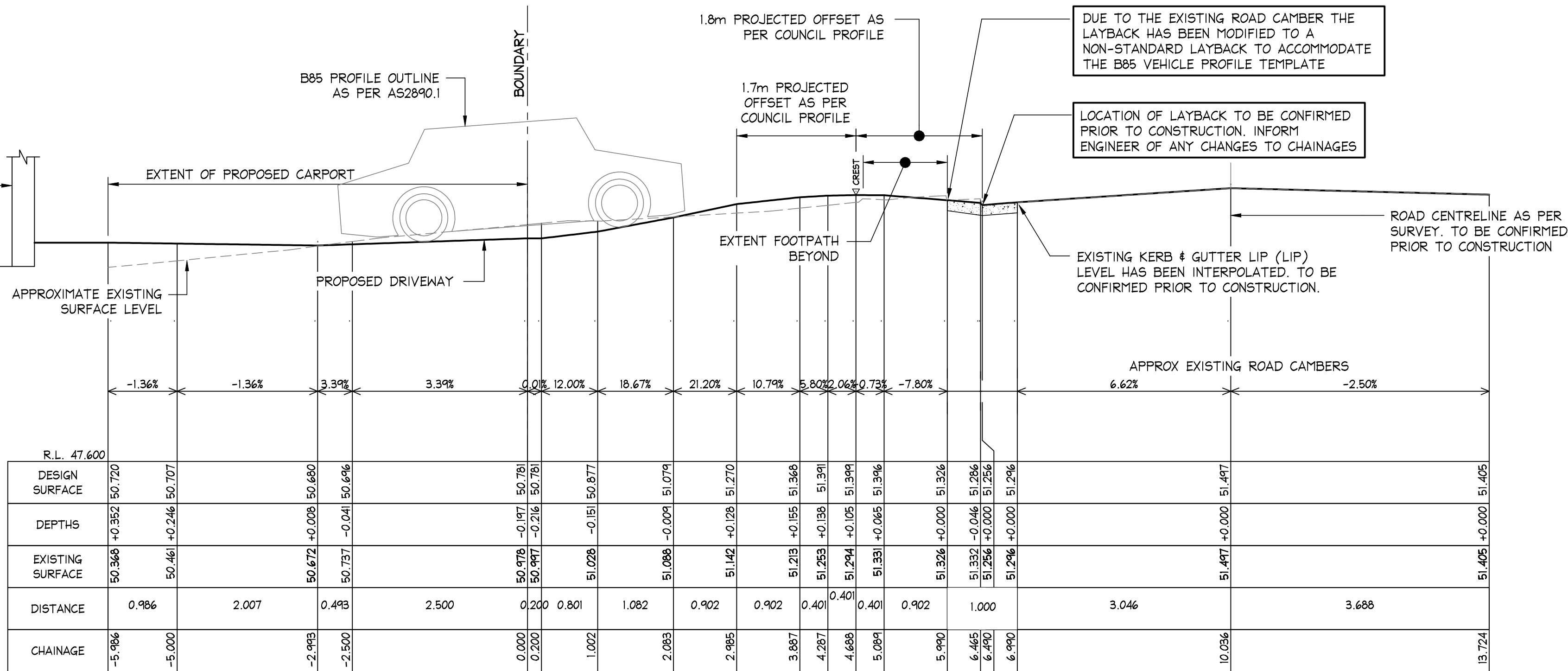

LONGITUDINAL SECTION DRIVEWAY  
FROM CH: -5.986 TO CH: 13.724  
SCALES: HORIZONTAL 1:50 VERTICAL 1:50

SECTION 2  
C02

#### NOTES:

- THIS DRAWING IS NOT TO BE USED FOR CONSTRUCTION IF THE ISSUE DATE PRECEDES THE ISSUE DATE ON THE ARCHITECTURAL DRAWINGS.
- DO NOT SCALE FROM THIS DRAWING.
- ALL DIMENSIONS ARE TO BE VERIFIED ON SITE BY THE BUILDER BEFORE COMMENCING WITH ASSOCIATED WORK.
- FOR GENERAL NOTES REFER TO DRAWING NUMBER: C01.



#### COUNCIL DRIVEWAY CROSSOVER PROFILE NOTES

COUNCIL: NORTHERN BEACHES COUNCIL  
PROFILE/TITLE: EXTRA LOW STANDARD VEHICLE CROSSING PROFILE  
DRAWING: PLAN No.: A4 3330/5 EL  
DATED: LAST AMENDED DEC 2006

#### B85 PROFILE

NOTE: NOT TO SCALE - DO NOT SCALE

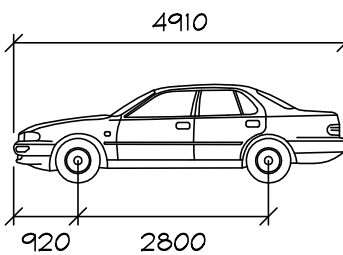

Width : 1870 mm  
Track : 1770 mm  
Lock to Lock Time : 6.0 s  
Steering Angle : 34.1°

VEHICLE CRASH BARRIERS REQUIRED WHERE DRIVEWAY DROP EXCEEDS 600mm. 150 MIN HIGH WHEEL STOP REQUIRED WHERE DRIVEWAY DROP IS BETWEEN 150-600mm. REFER AUSTRALIAN STANDARDS AS2890.1. REFER ARCHITECT FOR SPECIFICATIONS AND DETAILS - TYPICAL.

ISSUED FOR  
DA SUBMISSION ONLY  
NOT FOR  
CONSTRUCTION

IF IN DOUBT ASK

NB Consulting Engineers

Scale check - 100mm when printed to scale

AI

--	--	--	--	--	--	--	--	--	--	--	--	--	--	--	--	--	--	--	--	--	--	--	--	--	--	--	--	--	--	--	--	--	--	--	--	--	--	--	--	--	--	--	--	--	--	--	--	--	--	--	--	--	--	--	--	--	--	--	--	--	--	--	--	--	--	--	--	--	--	--	--	--	--	--	--	--	--	--	--	--	--	--	--	--	--	--	--	--	--	--	--	--	--	--	--	--	--	--	--	--	--	--	--	--	--	--	--	--	--	--	--	--	--	--	--	--	--	--	--	--	--	--	--	--	--	--	--	--	--	--	--	--	--	--	--	--	--	--	--	--	--	--	--	--	--	--	--	--	--	--	--	--	--	--	--	--	--	--	--	--	--	--	--	--	--	--	--	--	--	--	--	--	--	--	--	--	--	--	--	--	--	--	--	--	--	--	--	--	--	--	--	--	--	--	--	--	--	--	--	--	--	--	--	--	--	--	--	--	--	--	--	--	--	--	--	--	--	--	--	--	--	--	--	--	--	--	--	--	--	--	--	--	--	--	--	--	--	--	--	--	--	--	--	--	--	--	--	--	--	--	--	--	--	--	--	--	--	--	--	--	--	--	--	--	--	--	--	--	--	--	--	--	--	--	--	--	--	--	--	--	--	--	--	--	--	--	--	--	--	--	--	--	--	--	--	--	--	--	--	--	--	--	--	--	--	--	--	--	--	--	--	--	--	--	--	--	--	--	--	--	--	--	--	--	--	--	--	--	--	--	--	--	--	--	--	--	--	--	--	--	--	--	--	--	--	--	--	--	--	--	--	--	--	--	--	--	--	--	--	--	--	--	--	--	--	--	--	--	--	--	--	--	--	--	--	--	--	--	--	--	--	--	--	--	--	--	--	--	--	--	--	--	--	--	--	--	--	--	--	--	--	--	--	--	--	--	--	--	--	--	--	--	--	--	--	--	--	--	--	--	--	--	--	--	--	--	--	--	--	--	--	--	--	--	--	--	--	--	--	--	--	--	--	--	--	--	--	--	--	--	--	--	--	--	--	--	--	--	--	--	--	--	--	--	--	--	--	--	--	--	--	--	--	--	--	--	--	--	--	--	--	--	--	--	--	--	--	--	--	--	--	--	--	--	--	--	--	--	--	--	--	--	--	--	--	--	--	--	--	--	--	--	--	--	--	--	--	--	--	--	--	--	--	--	--	--	--	--	--	--	--	--	--	--	--	--	--	--	--	--	--	--	--	--	--	--	--	--	--	--	--	--	--	--	--	--	--	--	--	--	--	--	--	--	--	--	--	--	--	--	--	--	--	--	--	--	--	--	--	--	--	--	--	--	--	--	--	--	--	--	--	--	--	--	--	--	--	--	--	--	--	--	--	--	--	--	--	--	--	--	--	--	--	--	--	--	--	--	--	--	--	--	--	--	--	--	--	--	--	--	--	--	--	--	--	--	--	--	--	--	--	--	--	--	--	--	--	--	--	--	--	--	--	--	--	--	--	--	--	--	--	--	--	--	--	--	--	--	--	--	--	--	--	--	--	--	--	--	--	--	--	--	--	--	--	--	--	--	--	--	--	--	--	--	--	--	--	--	--	--	--	--	--	--	--	--	--	--	--	--	--	--	--	--	--	--	--	--	--	--	--	--	--	--	--	--	--	--	--	--	--	--	--	--	--	--	--	--	--	--	--	--	--	--	--	--	--	--	--	--	--	--	--	--	--	--	--	--	--	--	--	--	--	--	--	--	--	--	--	--	--	--	--	--	--	--	--	--	--	--	--	--	--	--	--	--	--	--	--	--	--	--	--	--	--	--	--	--	--	--	--	--	--	--	--	--	--	--	--	--	--	--	--	--	--	--	--	--	--	--	--	--	--	--	--	--	--	--	--	--	--	--	--	--	--	--	--	--	--	--	--	--	--	--	--	--	--	--	--	--	--	--	--	--	--	--	--	--	--	--	--	--	--	--	--	--	--	--	--	--	--	--	--	--	--	--	--	--	--	--	--	--	--	--	--	--	--	--	--	--	--	--	--	--	--	--	--	--	--	--	--	--	--	--	--	--	--	--	--	--	--	--	--	--	--	--	--	--	--	--	--	--	--	--	--	--	--	--	--	--	--	--	--	--	--	--	--	--	--	--	--	--	--	--	--	--	--	--	--	--	--	--	--	--	--	--	--	--	--	--	--	--	--	--	--	--	--	--	--	--	--	--	--	--	--	--	--	--	--	--	--	--	--	--	--	--	--	--	--	--	--	--	--	--	--	--	--	--	--	--	--	--	--	--	--	--	--	--	--	--	--	--	--	--	--	--	--	--	--	--	--	--	--	--	--	--	--	--	--	--	--	--	--	--	--	--	--	--	--	--	--	--	--	--	--	--	--	--	--	--	--	--	--	--	--	--	--	--	--	--	--	--	--	--	--	--	--	--	--	--	--	--	--	--	--	--	--	--	--	--	--	--	--	--	--	--	--	--	--	--	--	--	--	--	--	--	--	--	--	--	--	--	--	--	--	--	--	--	--	--	--	--	--	--	--	--	--	--	--	--	--	--	--	--	--	--	--	--	--	--	--	--	--	--	--	--	--	--	--	--	--	--	--	--	--	--	--	--	--	--	--	--	--	--	--	--	--	--	--	--	--	--	--	--	--	--	--	--	--	--	--	--	--	--	--	--	--	--	--	--	--	--	--	--	--	--	--	--	--	--	--	--	--	--	--	--	--	--	--	--	--	--	--	--	--	--	--	--	--	--	--	--	--	--	--	--	--	--	--	--	--	--	--	--	--	--	--	--	--	--	--	--	--	--	--	--	--	--	--	--	--	--	--	--	--	--	--	--	--	--	--	--	--	--	--	--	--	--	--	--	--	--	--	--	--	--	--	--	--	--	--	--	--	--	--	--	--	--	--	--	--	--	--	--	--	--	--	--	--	--	--	--	--	--	--	--	--	--	--	--	--	--	--	--	--	--	--	--	--	--	--	--	--	--	--	--	--	--	--	--	--	--	--	--	--	--	--	--	--	--	--	--	--	--	--	--	--	--	--	--	--	--	--	--	--	--	--	--	--	--	--	--	--	--	--	--	--	--	--	--	--	--	--	--	--	--	--	--	--	--	--	--	--	--	--	--	--	--	--	--	--	--	--	--	--	--	--	--	--	--	--	--	--	--	--	--	--	--	--	--	--	--	--	--	--	--	--	--	--	--	--	--	--	--	--	--	--	--	--	--	--	--	--	--	--	--	--	--	--	--	--	--	--	--	--	--	--	--	--	--	--	--	--	--	--	--	--	--	--	--



VEHICLE CRASH BARRIERS REQUIRED WHERE DRIVEWAY DROP EXCEEDS 600mm. 150 MIN HIGH WHEEL STOP REQUIRED WHERE DRIVEWAY DROP IS BETWEEN 150-600mm. REFER AUSTRALIAN STANDARDS AS2890.1. REFER ARCHITECT FOR SPECIFICATIONS AND DETAILS - TYPICAL.

REFER ARCHITECTURAL FOR EXTENTS, SPECIFICATIONS AND DETAILS - TYPICAL

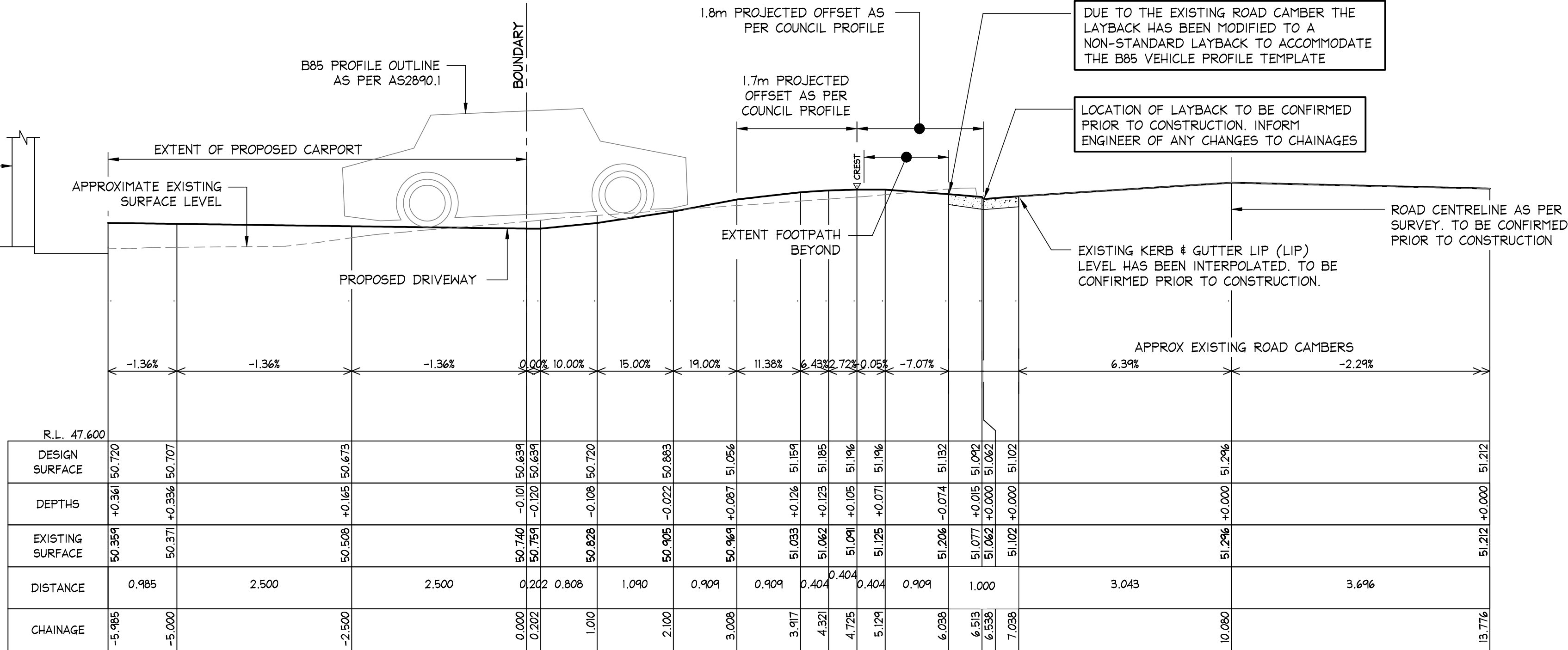

LONGITUDINAL SECTION DRIVEWAY  
FROM CH: -5.985 TO CH: 13.776  
SCALES: HORIZONTAL 1:50 VERTICAL 1:50

SECTION 3  
C02

#### NOTES:

- THIS DRAWING IS NOT TO BE USED FOR CONSTRUCTION IF THE ISSUE DATE PRECEDES THE ISSUE DATE ON THE ARCHITECTURAL DRAWINGS.
- DO NOT SCALE FROM THIS DRAWING.
- ALL DIMENSIONS ARE TO BE VERIFIED ON SITE BY THE BUILDER BEFORE COMMENCING WITH ASSOCIATED WORK.
- FOR GENERAL NOTES REFER TO DRAWING NUMBER: C01.



#### COUNCIL DRIVEWAY CROSSOVER PROFILE NOTES

COUNCIL: NORTHERN BEACHES COUNCIL  
PROFILE/TITLE: EXTRA LOW STANDARD VEHICLE CROSSING PROFILE  
DRAWING: PLAN No.: A4 3330/5 EL  
DATED: LAST AMENDED DEC 2006

#### B85 PROFILE

NOTE: NOT TO SCALE - DO NOT SCALE

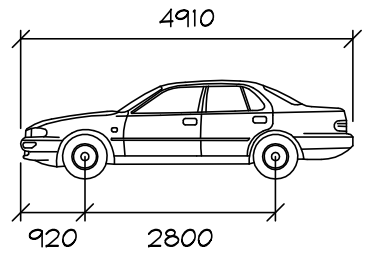

Width : 1870mm  
Track : 1770mm  
Lock to Lock Time : 6.0s  
Steering Angle : 34.1°

VEHICLE CRASH BARRIERS REQUIRED WHERE DRIVEWAY DROP EXCEEDS 600mm. 150 MIN HIGH WHEEL STOP REQUIRED WHERE DRIVEWAY DROP IS BETWEEN 150-600mm. REFER AUSTRALIAN STANDARDS AS2890.1. REFER ARCHITECT FOR SPECIFICATIONS AND DETAILS - TYPICAL.

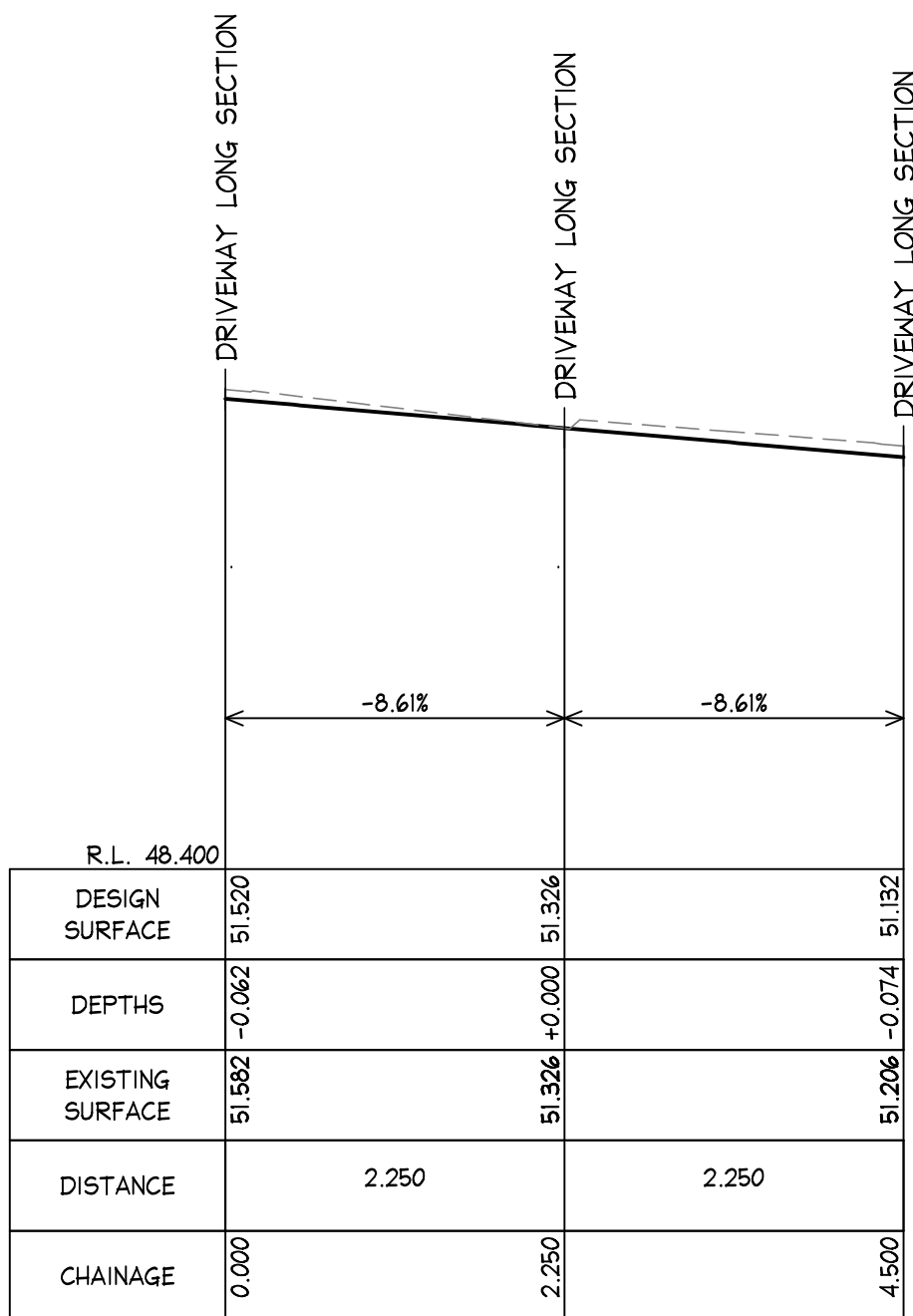

LONGITUDINAL CROSS SECTION  
SCALES: HORIZONTAL 1:50 VERTICAL 1:50

SECTION 4  
C02

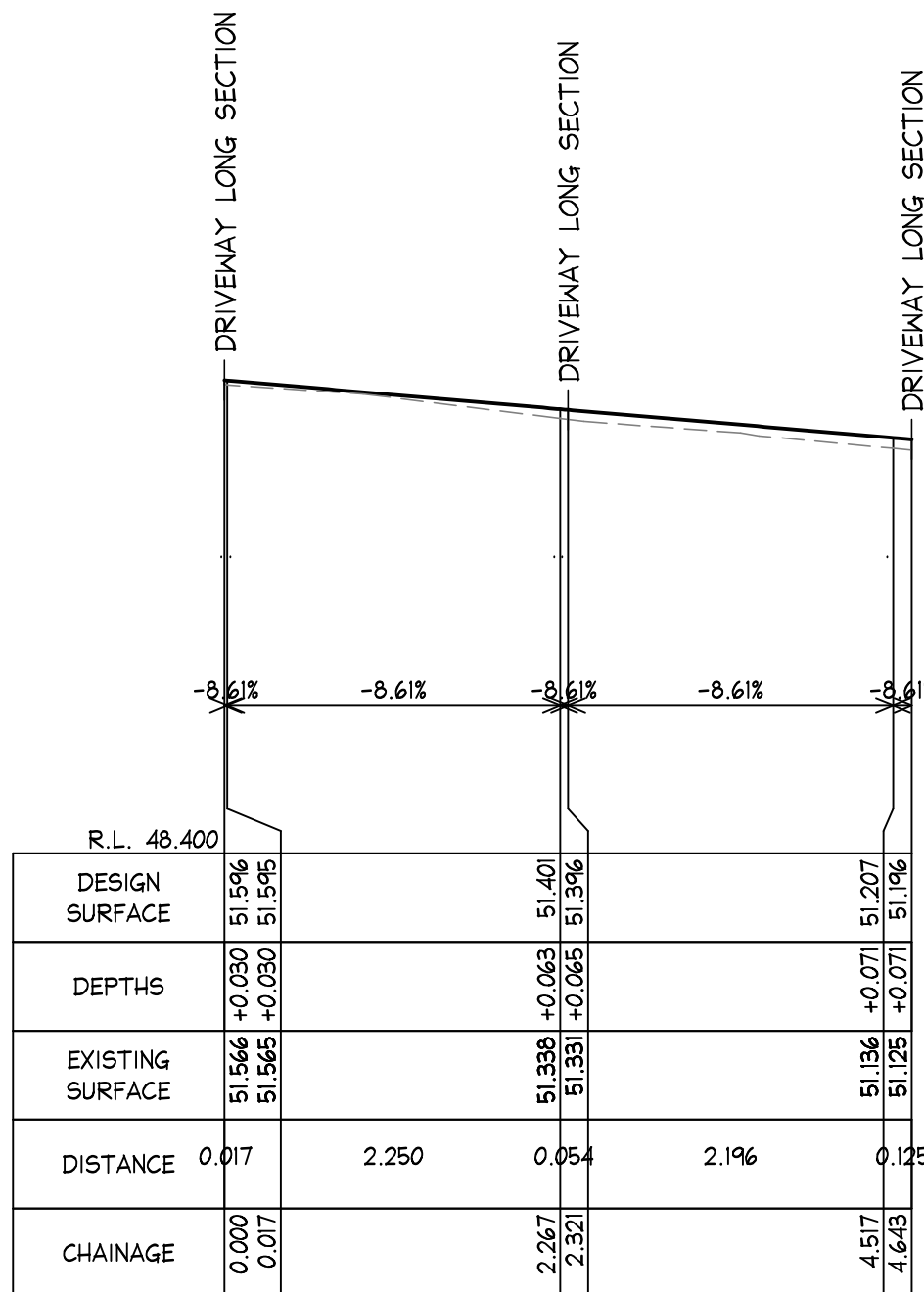

LONGITUDINAL CROSS SECTION  
SCALES: HORIZONTAL 1:50 VERTICAL 1:50

SECTION 5  
C02

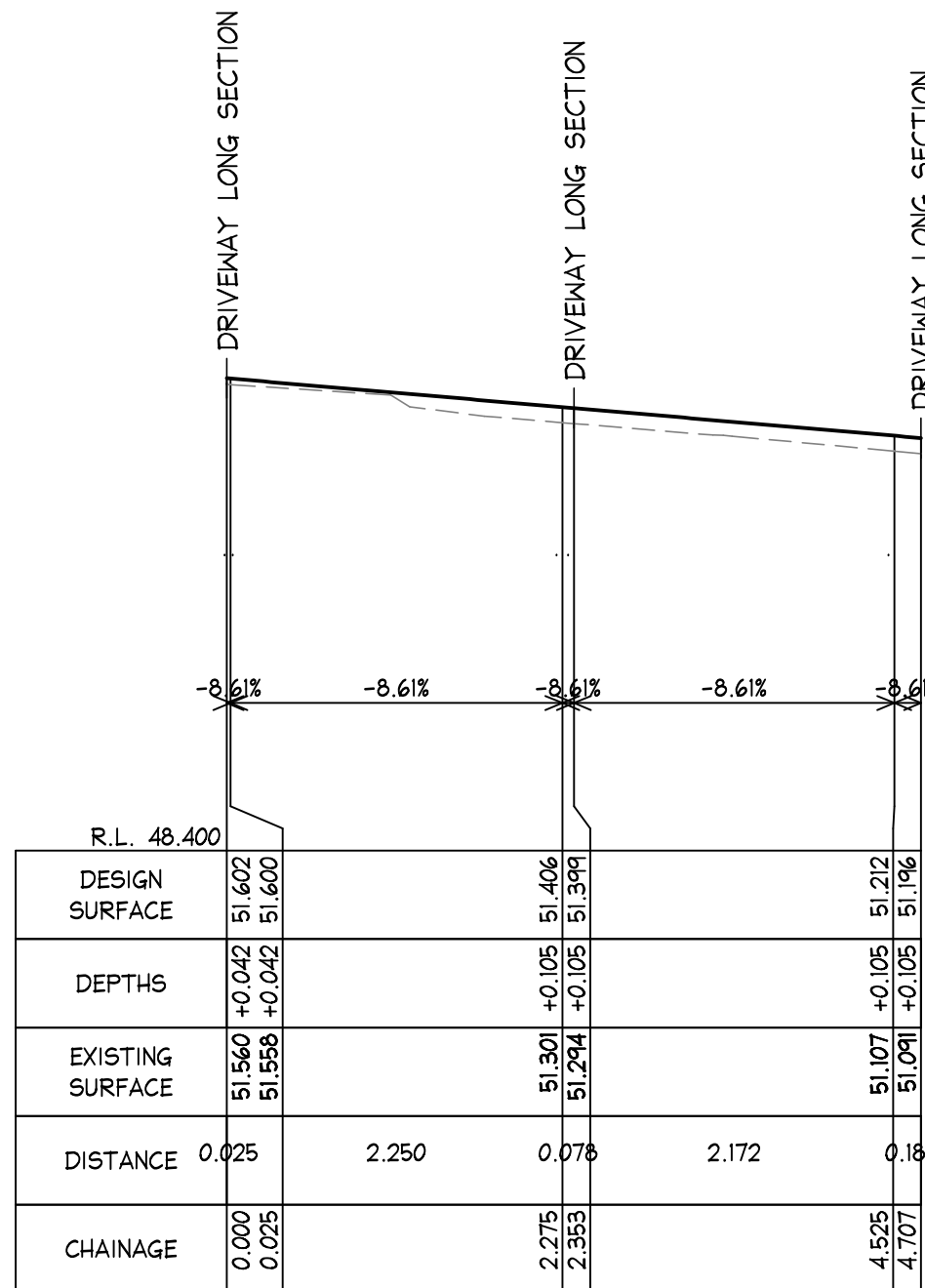

LONGITUDINAL CROSS SECTION  
SCALES: HORIZONTAL 1:50 VERTICAL 1:50

SECTION 6  
C02

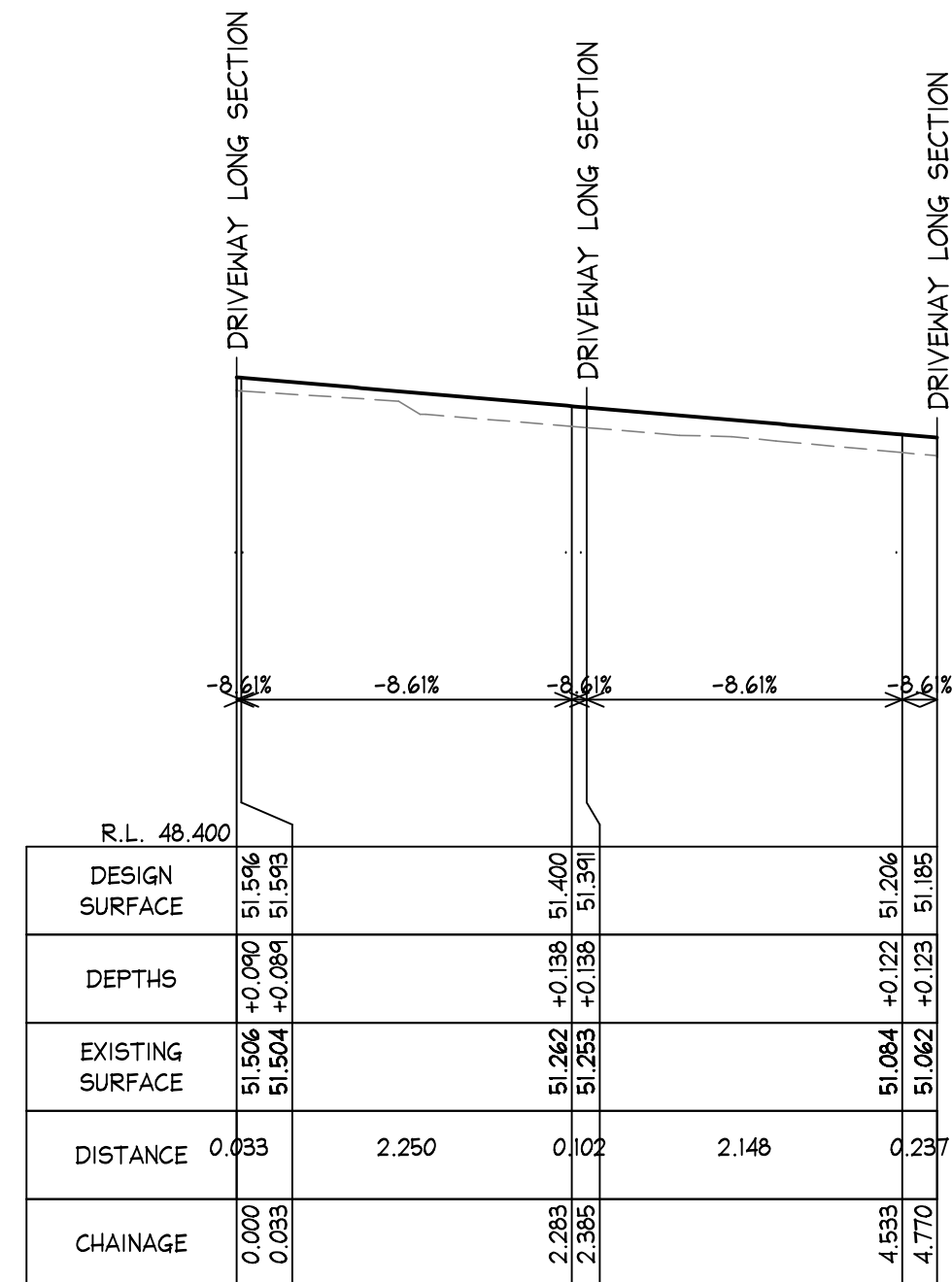

LONGITUDINAL CROSS SECTION  
SCALES: HORIZONTAL 1:50 VERTICAL 1:50

SECTION 7  
C02

ISSUED FOR  
DA SUBMISSION ONLY  
NOT FOR  
CONSTRUCTION

IF IN DOUBT ASK

DOCUMENT CERTIFICATION			Architect:			Project:			Date:			Design:			Drawn:		
Date : 6 Jun '23			HOBBS JAMIESON ARCHITECTURE			PROPOSED DRIVEWAY AT 17 MOORE STREET, CLONTARF			JUN 2023			D.K.			D.K.		
Michael Wachjo			Client:			Drawing Title:			Job No:			Drawing No:			Issue:		
B.E.(Civil), MIEAust. (Director NB Consulting Engineers)			HP CONSTRUCTIONS			LONGITUDINAL SECTIONS - SHEET 2			2301041			C05			A		
05/06/2023			A			ISSUED FOR DA SUBMISSION ONLY - NOT FOR CONSTRUCTION			Date:			Issue:			Description:		
D.K.			M.W.			By:			Review:			The copyright of this drawing remains with Northern Beaches Consulting Engineers Pty Ltd. Trading as NB Consulting Engineers			E : nb@nbconsulting.com.au W : www.nbconsulting.com.au		

**NB Consulting Engineers**  
STRUCTURAL - CIVIL - STORMWATER - REMEDIAL  
A.C.N. 076 121 616 A.B.N. 24 076 121 616  
Sydney: Ph: (02) 9984 7000  
Suite 207, 30 Fisher Road Dee Why N.S.W. 2099  
Gold Coast: Ph: (07) 5631 4744  
30 Griffith Street Coolangubra QLD 4225  
E : nb@nbconsulting.com.au W : www.nbconsulting.com.au

- NOTES:
1. THIS DRAWING IS NOT TO BE USED FOR CONSTRUCTION IF THE ISSUE DATE PRECEDES THE ISSUE DATE ON THE ARCHITECTURAL DRAWINGS.
  2. DO NOT SCALE FROM THIS DRAWING.
  3. ALL DIMENSIONS ARE TO BE VERIFIED ON SITE BY THE BUILDER BEFORE COMMENCING WITH ASSOCIATED WORK.
  4. FOR GENERAL NOTES REFER TO DRAWING NUMBER: C01.

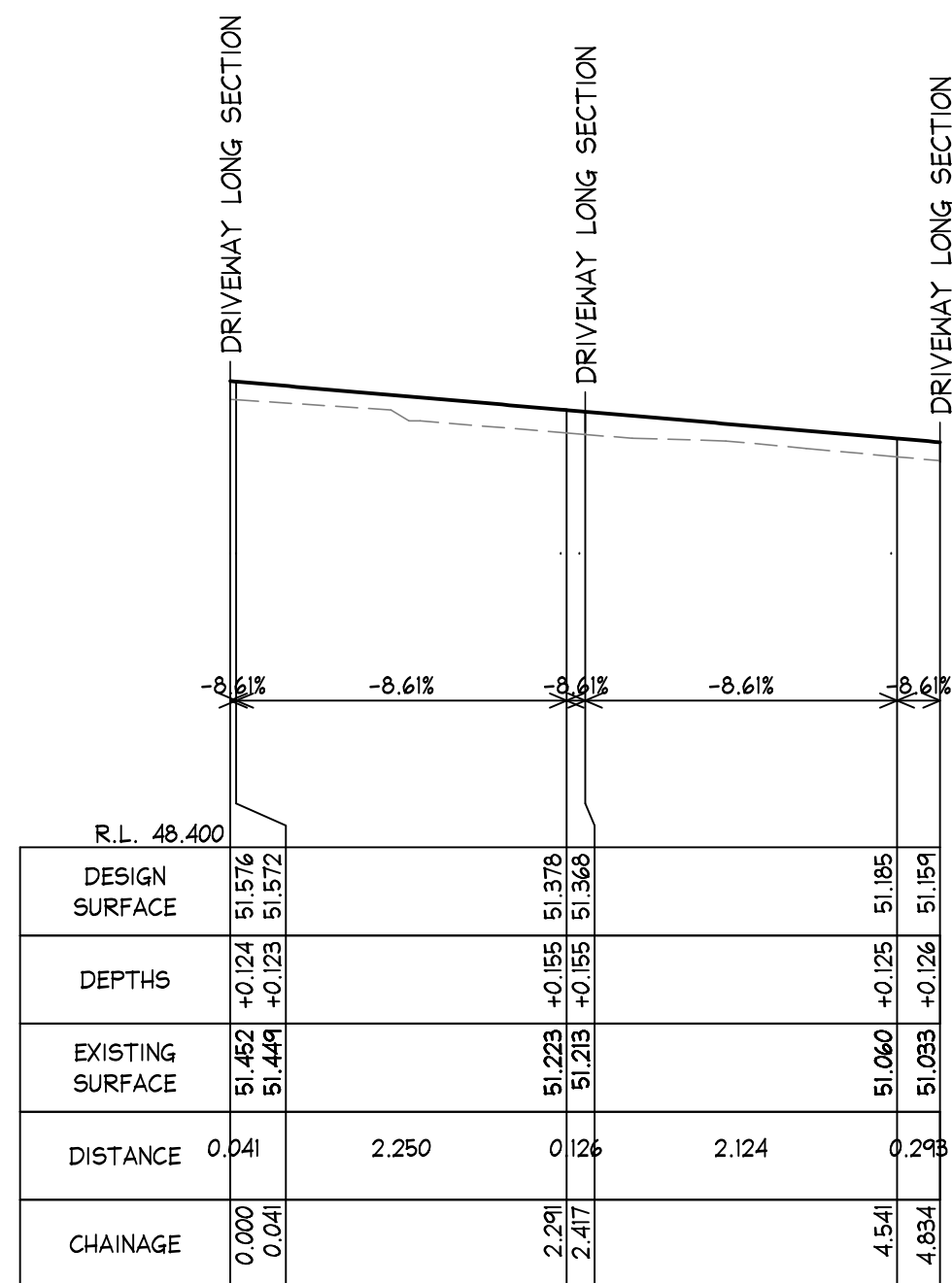

LONGITUDINAL CROSS SECTION  
SCALES: HORIZONTAL 1:50 VERTICAL 1:50  
SECTION 8  
C02

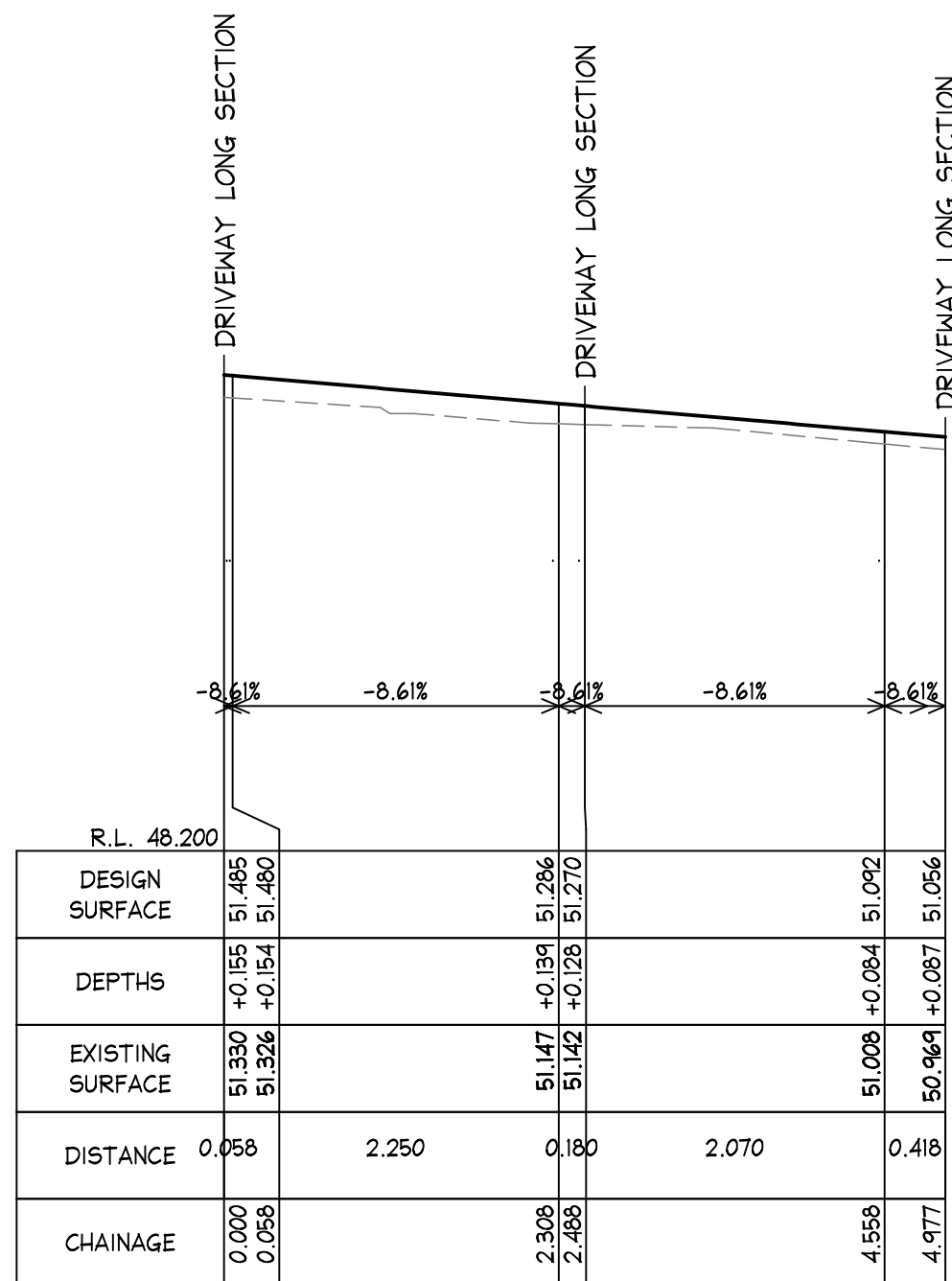

LONGITUDINAL CROSS SECTION  
SCALES: HORIZONTAL 1:50 VERTICAL 1:50  
SECTION 9  
C02

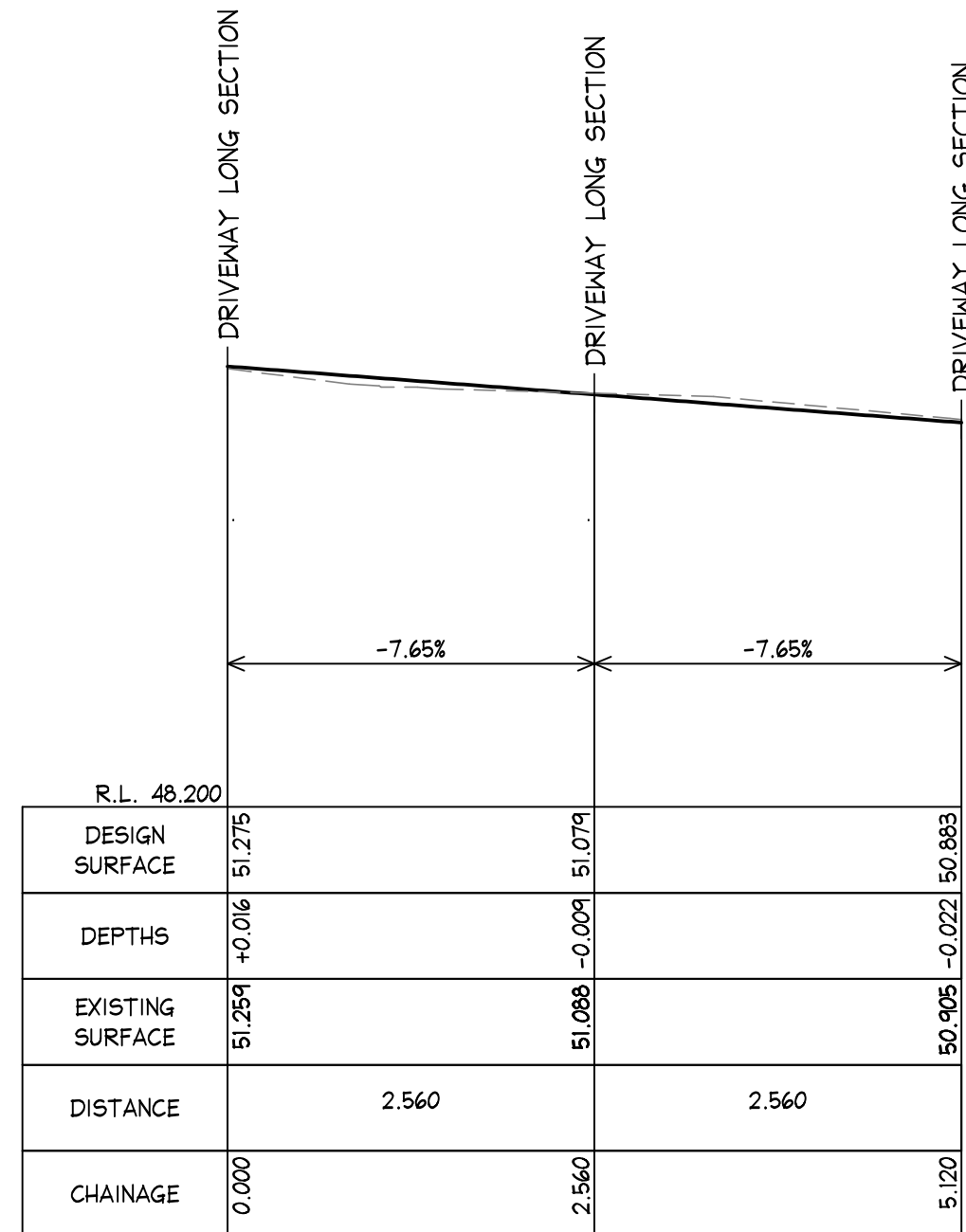

LONGITUDINAL CROSS SECTION  
SCALES: HORIZONTAL 1:50 VERTICAL 1:50  
SECTION 10  
C02

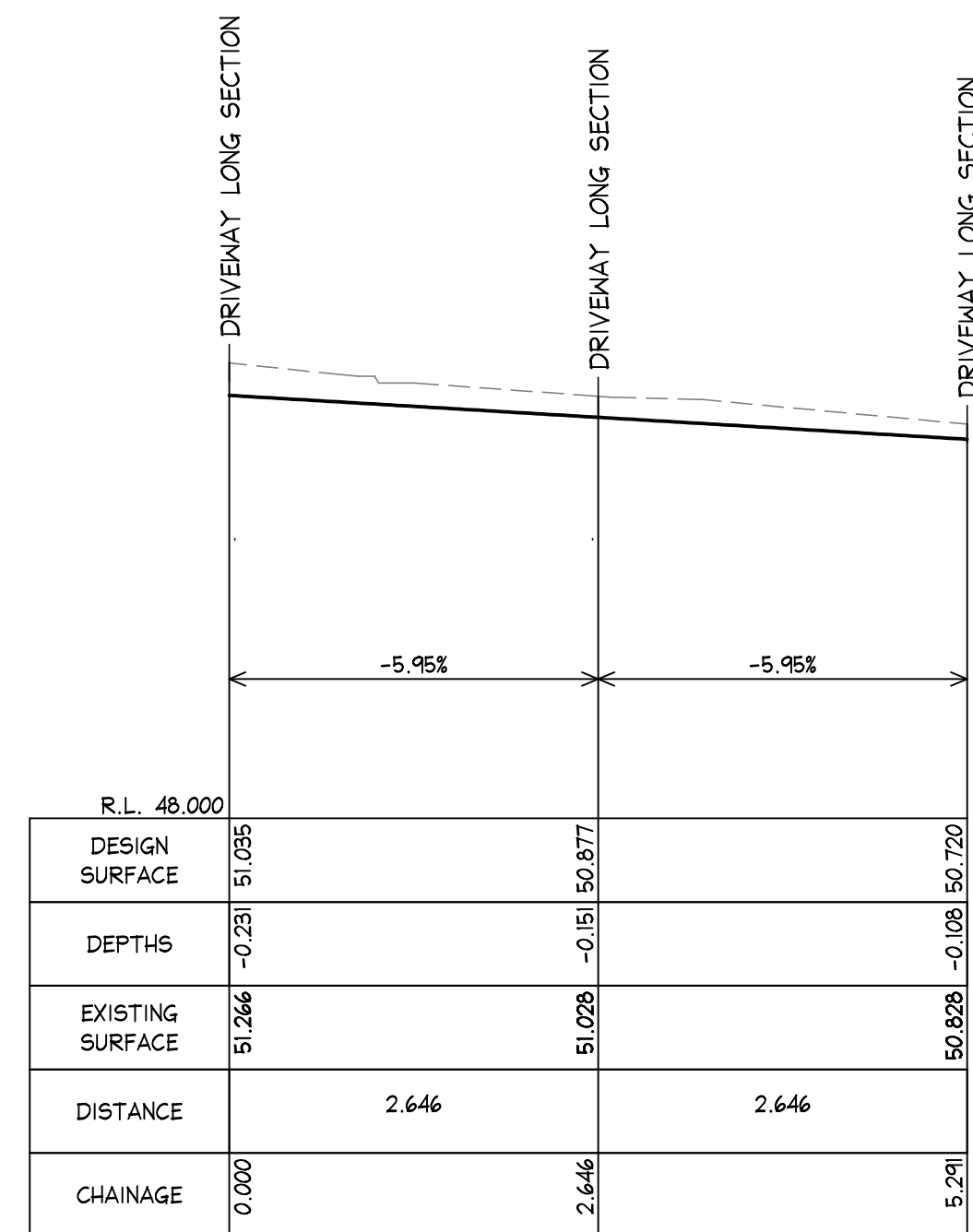

LONGITUDINAL CROSS SECTION  
SCALES: HORIZONTAL 1:50 VERTICAL 1:50  
SECTION 11  
C02

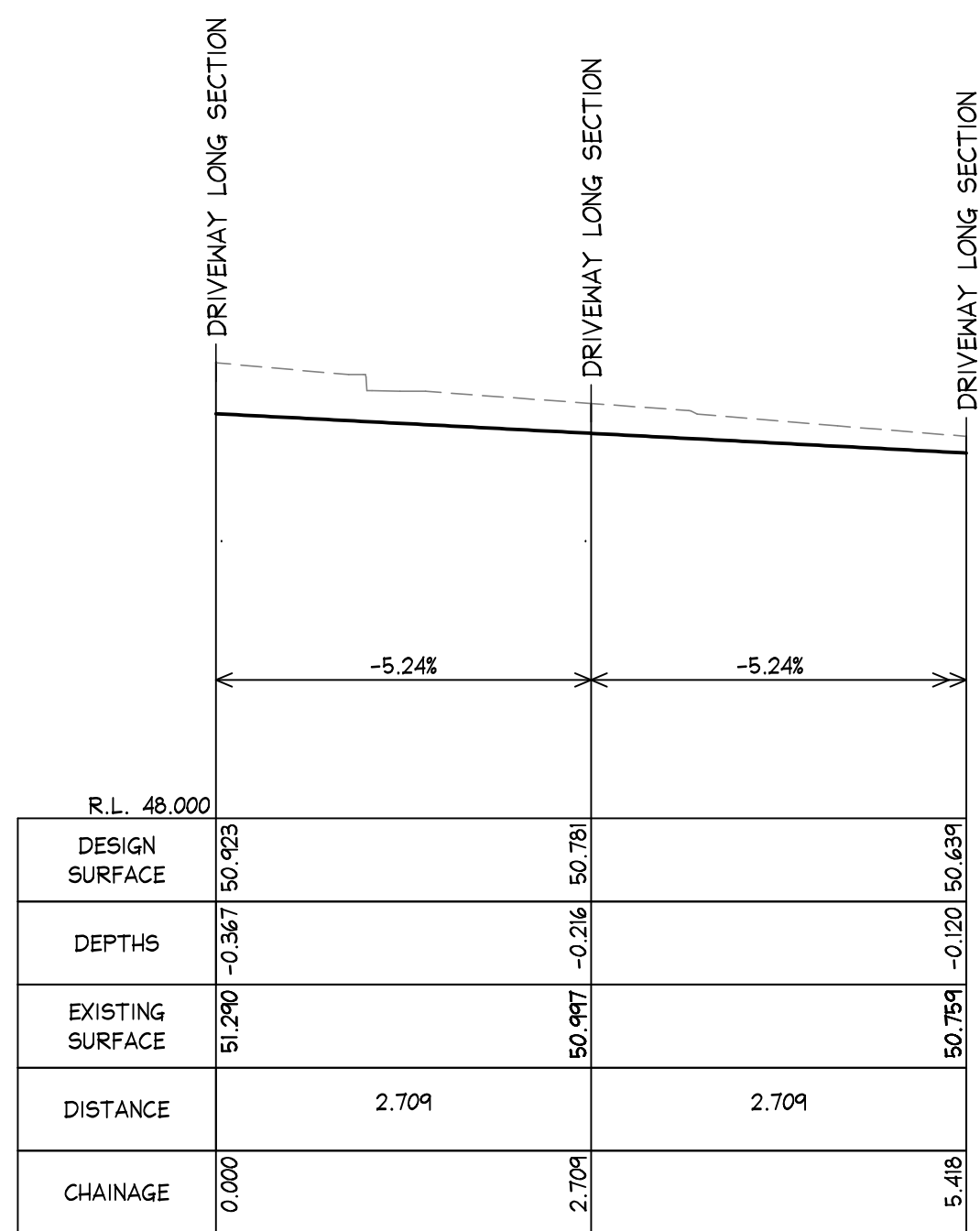

LONGITUDINAL CROSS SECTION  
SCALES: HORIZONTAL 1:50 VERTICAL 1:50  
SECTION 12  
C02

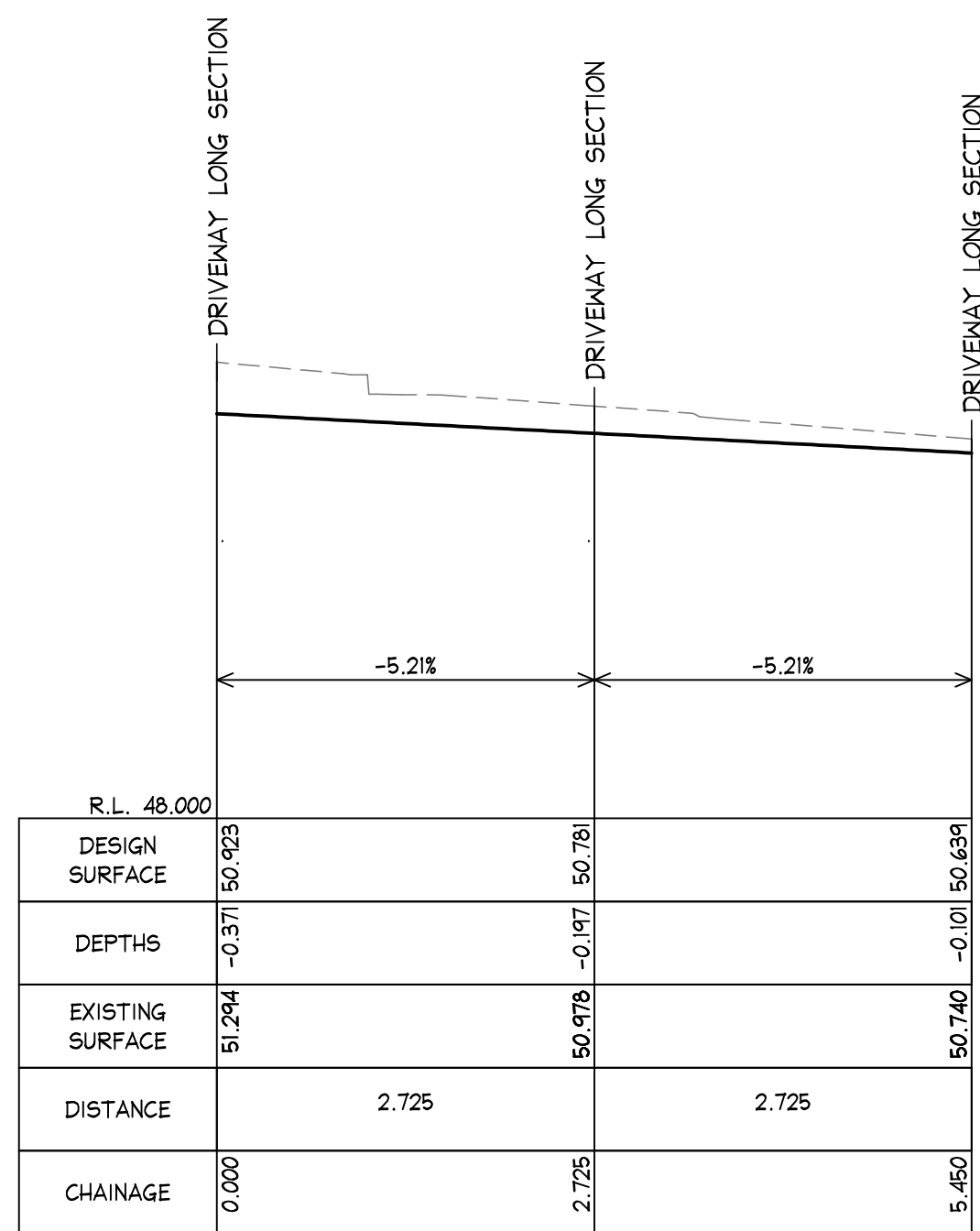

LONGITUDINAL CROSS SECTION  
SCALES: HORIZONTAL 1:50 VERTICAL 1:50  
SECTION 13  
C02

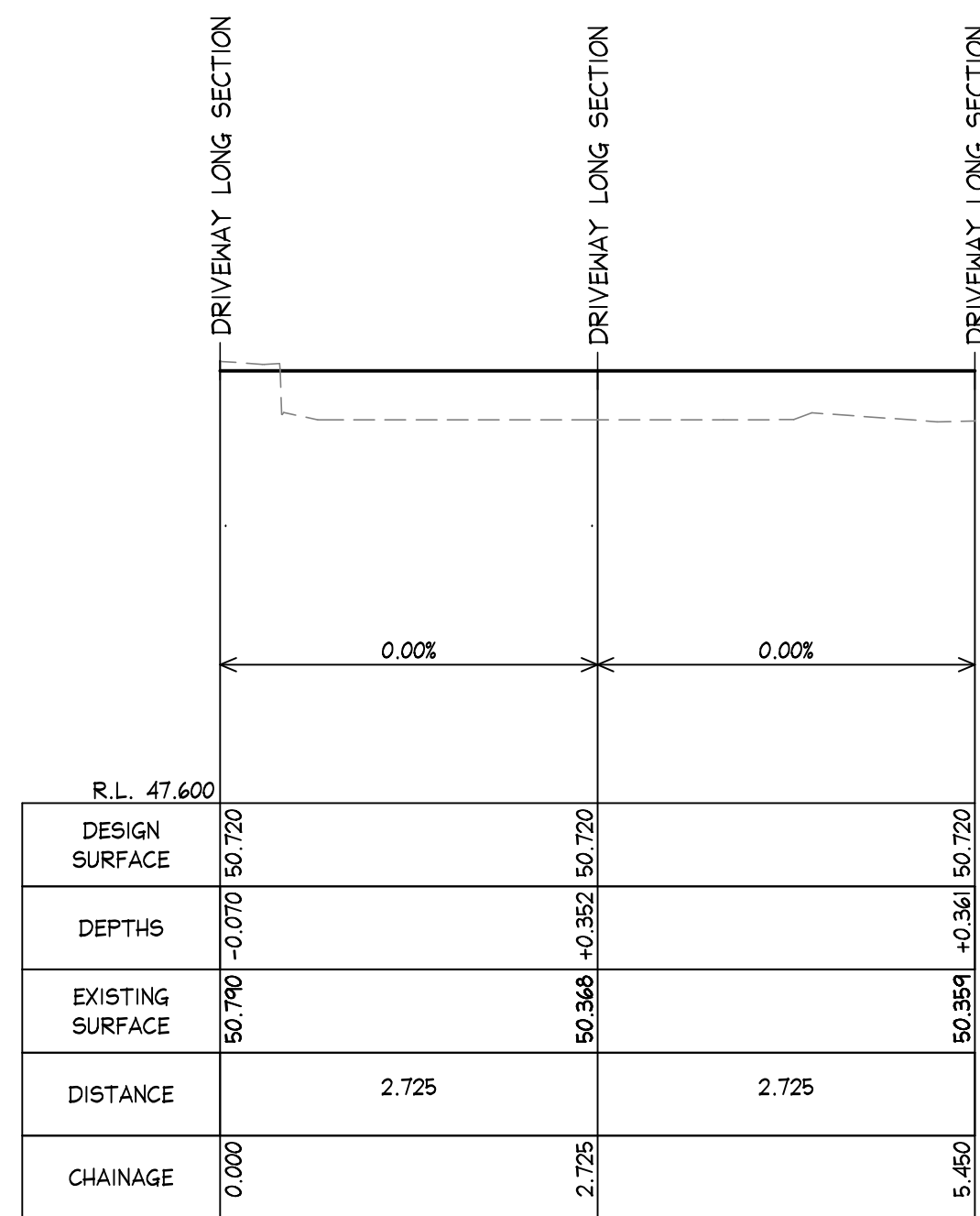

LONGITUDINAL CROSS SECTION  
SCALES: HORIZONTAL 1:50 VERTICAL 1:50  
SECTION 14  
C02

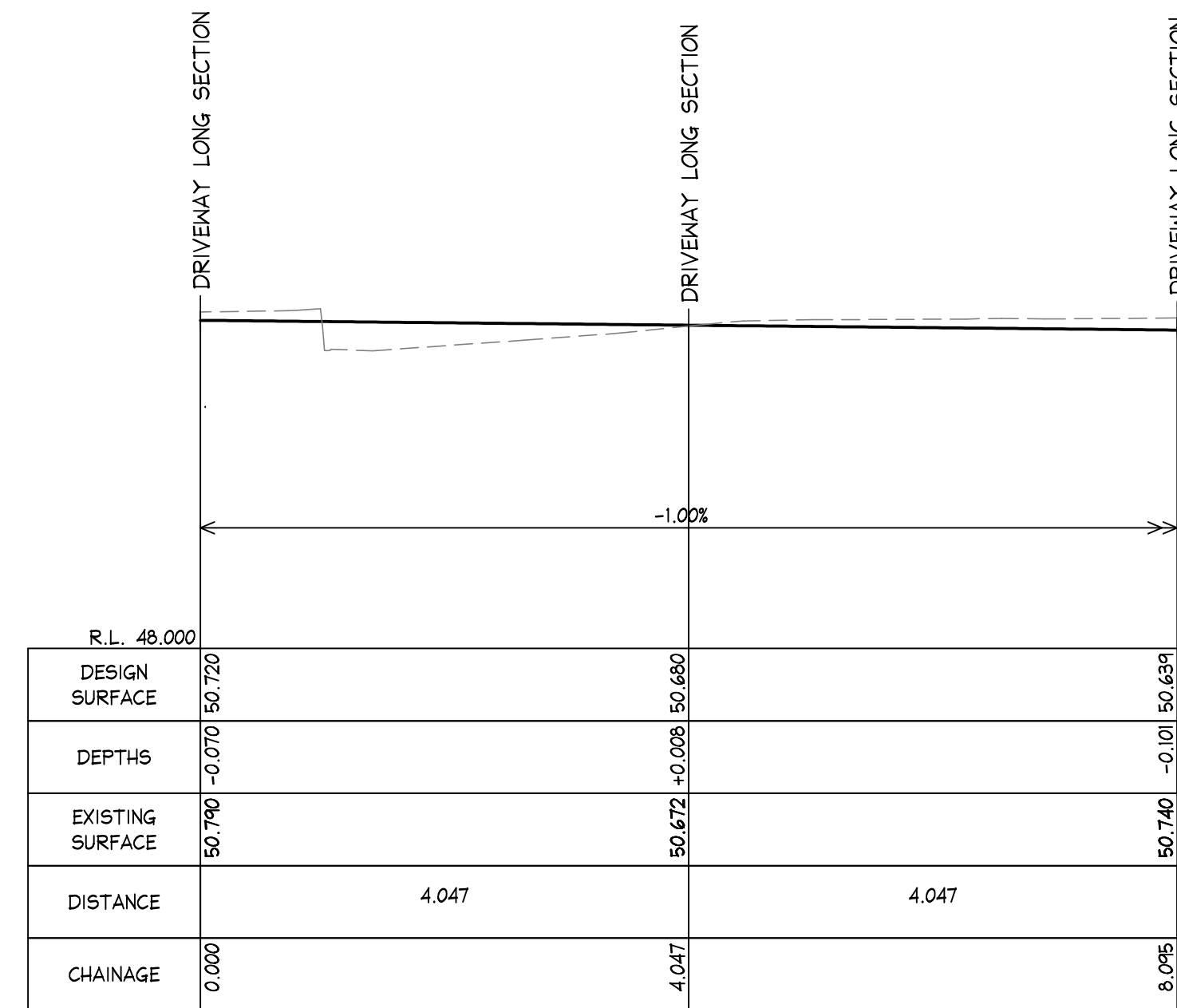

LONGITUDINAL CROSS SECTION  
SCALES: HORIZONTAL 1:50 VERTICAL 1:50  
SECTION 15  
C02

ISSUED FOR  
DA SUBMISSION ONLY  
NOT FOR  
CONSTRUCTION

IF IN DOUBT ASK

DOCUMENT CERTIFICATION			Architect:			Project:			Date:	Design:	Drawn:
Date : 6 Jun '23 Michael Wachjo B.E.(Civil), MIE Aust. (Director NB Consulting Engineers)			HOBBS JAMIESON ARCHITECTURE			PROPOSED DRIVEWAY AT 17 MOORE STREET, CLONTARF			JUN 2023	D.K.	D.K.
By: Review:			Client:			Drawing Title:			Job No:	Drawing No:	Issue:
05/06/2023 A ISSUED FOR DA SUBMISSION ONLY - NOT FOR CONSTRUCTION			HP CONSTRUCTIONS			LONGITUDINAL SECTIONS - SHEET 3			2301041	C06	A