

Flower Power Garden Centre

Landscape Development Application

Flower Power Garden Centre, 277 Mona Vale Road, Terrey Hills, NSW

Drawing Schedule

| Drawing Number | Drawing Title | Scale |
|----------------|----------------------|----------|
| 000 | Landscape Coversheet | N/A |
| 001 | Landscape Plan | 1:500 |
| 101 | Landscape Plan - 1 | 1:200 |
| 102 | Landscape Plan - 2 | 1:200 |
| 103 | Landscape Plan - 3 | 1:200 |
| 104 | Landscape Plan - 4 | 1:200 |
| 501 | Landscape Details | As Shown |
| 502 | Landscape Details | As Shown |

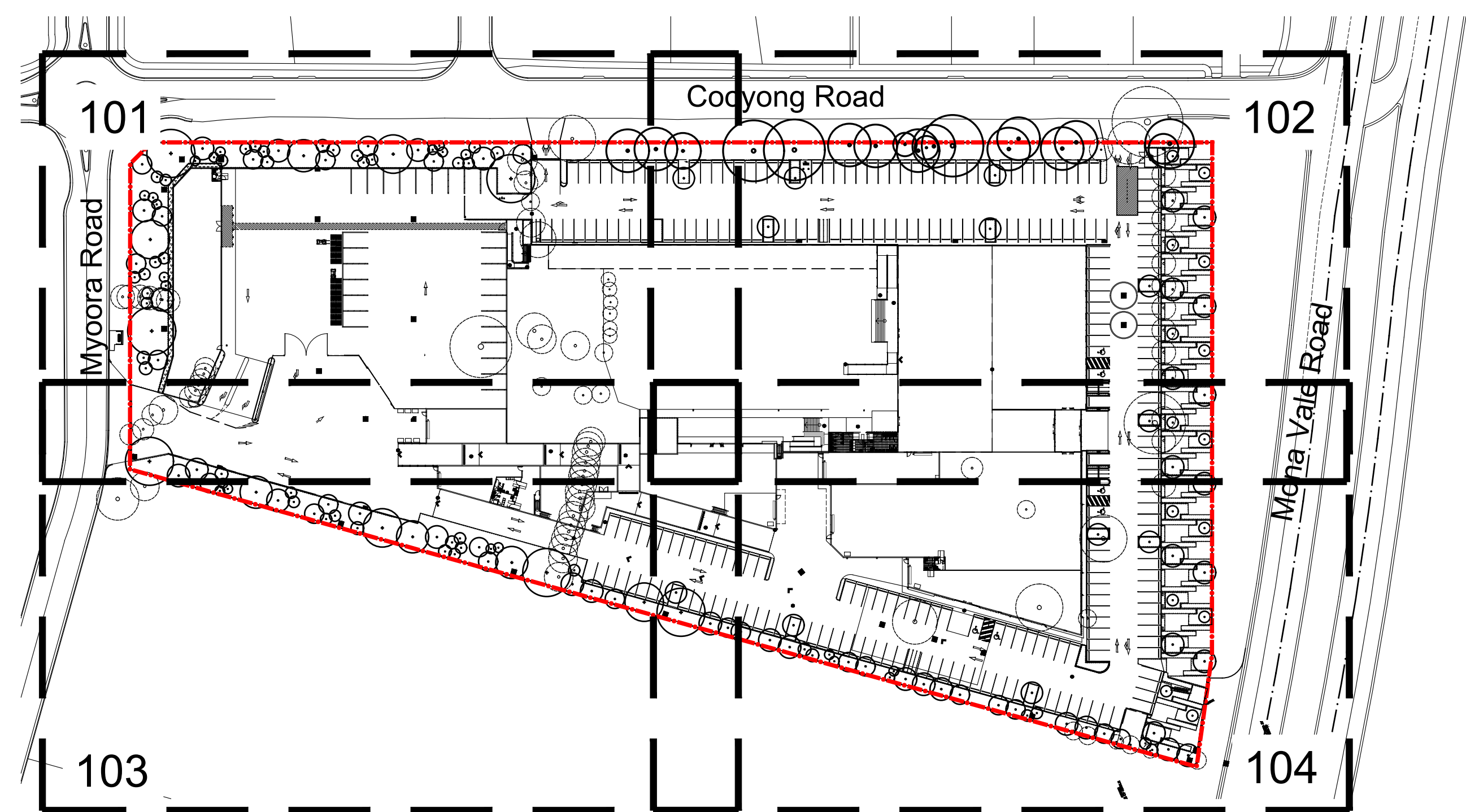

Site Plan | 1:1000

NOT FOR CONSTRUCTION

© 2021 Site Image (NSW) Pty Ltd ABN 44 801 262 380 as agent for Site Image NSW Partnership. All rights reserved. This drawing is copyright and shall not be reproduced or copied in any form or by any means (graphic, electronic or mechanical including photocopy) without the written permission of Site Image (NSW) Pty Ltd Any license, expressed or implied, to use this document for any purpose what so ever is restricted to the terms of the written agreement between Site Image (NSW) Pty Ltd and the instructing party.

The contractor shall check and verify all work on site (including work by others) before commencing the landscape installation. Any discrepancies are to be reported to the Project Manager or Landscape Architect prior to commencing work. Do not scale this drawing. Any required dimensions not shown shall be referred to the Landscape Architect for confirmation.

| | | | | |
|-------|----------------------------|-------|-------|------------|
| F | Development Application | LP | NM | 18.04.2024 |
| E | For Comment | LP | NM | 27.03.2024 |
| D | Architectural Coordination | LW | NM | 24.05.2023 |
| C | Architectural Coordination | LW | NM | 21.04.2023 |
| B | Architectural Coordination | LW | NM | 21.02.2022 |
| A | Preliminary | LW | NM | 31.01.2022 |
| Issue | Revision Description | Drawn | Check | Date |

S I T E I M A G E

Landscape Architects

Level 1, 3-5 Baptist Street
Redfern NSW 2016
Australia

Tel: (61 2) 8332 5600
Fax: (61 2) 9698 2877
www.siteimage.com.au

Client

Flower Power

Project

Flower Power Garden Centre

277 Mona Vale Road

Terrey Hills, NSW

Drawing Name

Coversheet

Development Application

Scale As Shown

Job Number

SS21-4790

Drawing Number

000

Issue

F

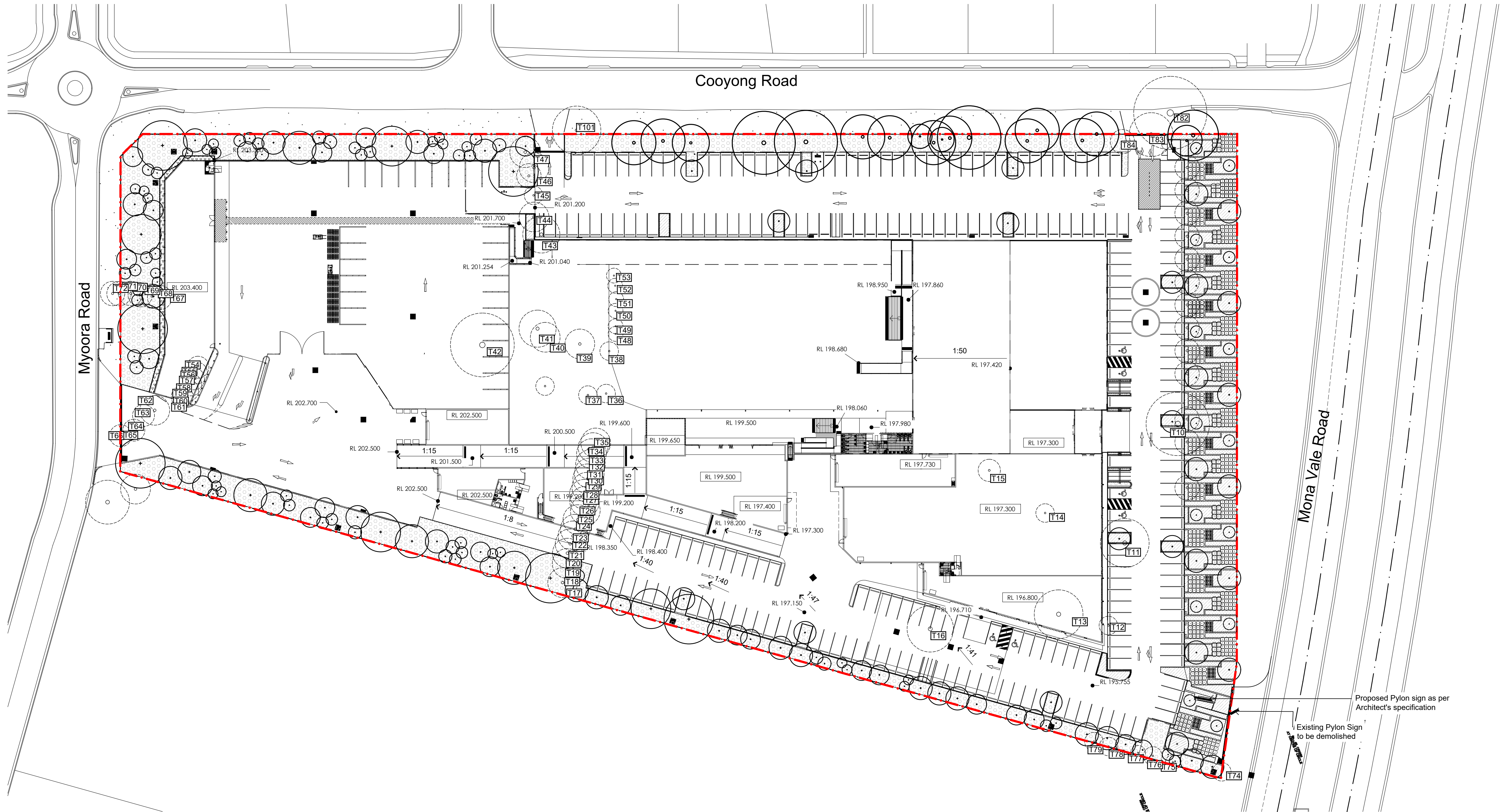

NOT FOR CONSTRUCTION

© 2021 Site Image (NSW) Pty Ltd ABN 44 801 262 380 as agent for Site Image NSW Partnership. All rights reserved. This drawing is copyright and shall not be reproduced or copied in any form or by any means (graphic, electronic or mechanical including photocopy) without the written permission of Site Image (NSW) Pty Ltd. Any license, expressed or implied, to use this document for any purpose what so ever is restricted to the terms of the written agreement between Site Image (NSW) Pty Ltd and the instructing party.

The contractor shall check and verify all work on site (including work by others) before commencing the landscape installation. Any discrepancies are to be reported to the Project Manager or Landscape Architect prior to commencing work. Do not scale this drawing. Any required dimensions not shown shall be referred to the Landscape Architect for confirmation.

| Issue | Revision Description |
|-------|----------------------------|
| F | Development Application |
| E | For Comment |
| D | Architectural Coordination |
| C | Architectural Coordination |
| B | Architectural Coordination |
| A | Preliminary |

| | | |
|-------|-------|------------|
| LP | NM | 18.04.2024 |
| LP | NM | 27.03.2024 |
| LW | NM | 24.05.2023 |
| LW | NM | 21.04.2023 |
| LW | NM | 21.02.2022 |
| LW | NM | 31.01.2022 |
| Drawn | Check | Date |

| Legend | |
|--------|--|
| | Site Boundary |
| | Proposed Trees (Refer to Schedule and Detail) |
| | Existing Trees to be Retained |
| | Existing Trees to be Removed |
| | Ground Cover (Refer to Schedule and Detail) |
| | Boundary Planting Matrix (Refer to Schedule and Detail) |
| | Shrubs and Accents (Refer to Schedule and Detail) |
| | Existing Turf |

Key Plan

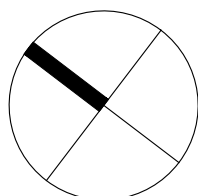

SITE IMAGE
Landscape Architects
Level 1, 3-5 Baptist Street
Redfern NSW 2016
Australia
Tel: (61 2) 8332 5600
Fax: (61 2) 9698 2877
www.siteimage.com.au

Client
Flower Power

Project
Flower Power Garden Centre
277 Mona Vale Road
Terrey Hills, NSW

Drawing Name
Landscape Plan
Ground Floor

Scale 1:500 @ A1
Job Number
SS21-4790

0 2 5 10 15 25m
Drawing Number
Issue

001 F



The contractor shall check and verify all work on site (including work by others) before commencing the landscape installation. Any discrepancies are to be reported to the Project Manager or Landscape Architect prior to commencing work. Do not scale this drawing. Any required dimensions not shown shall be referred to the Landscape Architect for confirmation.

| | | |
|-------|-------|------------|
| LP | NM | 18.04.2024 |
| LP | NM | 27.03.2024 |
| LW | NM | 24.05.2023 |
| LW | NM | 21.04.2023 |
| LW | NM | 21.02.2022 |
| LW | NM | 31.01.2022 |
| Drawn | Check | Date |

Proposed Trees
(Refer to Schedule and Detail)

Existing Trees to be Retained

Existing Trees to be Removed

A diagram of a rectangular object, possibly a book cover, with a red bounding box. A circular inset on the right shows a detail of the object's surface, which is divided into four quadrants by a cross, with the top-left quadrant shaded black.

Tel: (61 2) 8332 5600
Fax: (61 2) 9698 2877
www.siteimage.com.au

Project
Flower Power Garden Centre
277 Mona Vale Road
Terrey Hills, NSW

0 1 2 4 6 10m
Drawing Number Issue

102 F



NOT FOR CONSTRUCTION

© 2021 Site Image (NSW) Pty Ltd ABN 44 801 262 380 as agent for Site Image NSW Partnership. All rights reserved. This drawing is copyright and shall not be reproduced or copied in any form or by any means (graphic, electronic or mechanical including photocopy) without the written permission of Site Image (NSW) Pty Ltd. Any license, expressed or implied, to use this document for any purpose what so ever is restricted to the terms of the written agreement between Site Image (NSW) Pty Ltd and the instructing party.

The contractor shall check and verify all work on site (including work by others) before commencing the landscape installation. Any discrepancies are to be reported to the Project Manager or Landscape Architect prior to commencing work. Do not scale this drawing. Any required dimensions not shown shall be referred to the Landscape Architect for confirmation.

| | |
|-------|----------------------------|
| F | Development Application |
| E | For Comment |
| D | Architectural Coordination |
| C | Architectural Coordination |
| B | Architectural Coordination |
| A | Preliminary |
| Issue | Revision Description |

| | | |
|-------|-------|------------|
| LP | NM | 18.04.2024 |
| LP | NM | 27.03.2024 |
| LW | NM | 24.05.2023 |
| LW | NM | 21.04.2023 |
| LW | NM | 21.02.2022 |
| LW | NM | 31.01.2022 |
| Drawn | Check | Date |

| Legend | |
|--------|--|
| | Site Boundary |
| | Proposed Trees (Refer to Schedule and Detail) |
| | Existing Trees to be Retained |
| | Existing Trees to be Removed |

| | |
|--|--|
| | Ground Cover (Refer to Schedule and Detail) |
| | Boundary Planting Matrix (Refer to Schedule and Detail) |
| | Shrubs and Accents (Refer to Schedule and Detail) |
| | Turf |

Key Plan

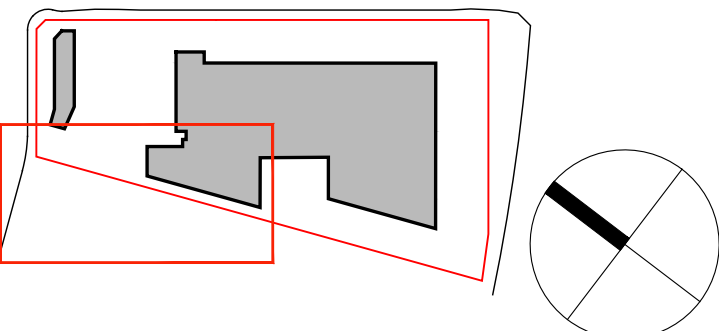

SITE IMAGE
Landscape Architects
Level 1, 3-5 Baptist Street
Redfern NSW 2016
Australia
Tel: (61 2) 8332 5600
Fax: (61 2) 9698 2877
www.siteimage.com.au

Client
Flower Power

Project
Flower Power Garden Centre
277 Mona Vale Road
Terrey Hills, NSW

Drawing Name
Landscape Plan - 3

Scale 1:200 @ A1
Job Number
SS21-4790

Drawing Number
103
Issue
F

Development Application

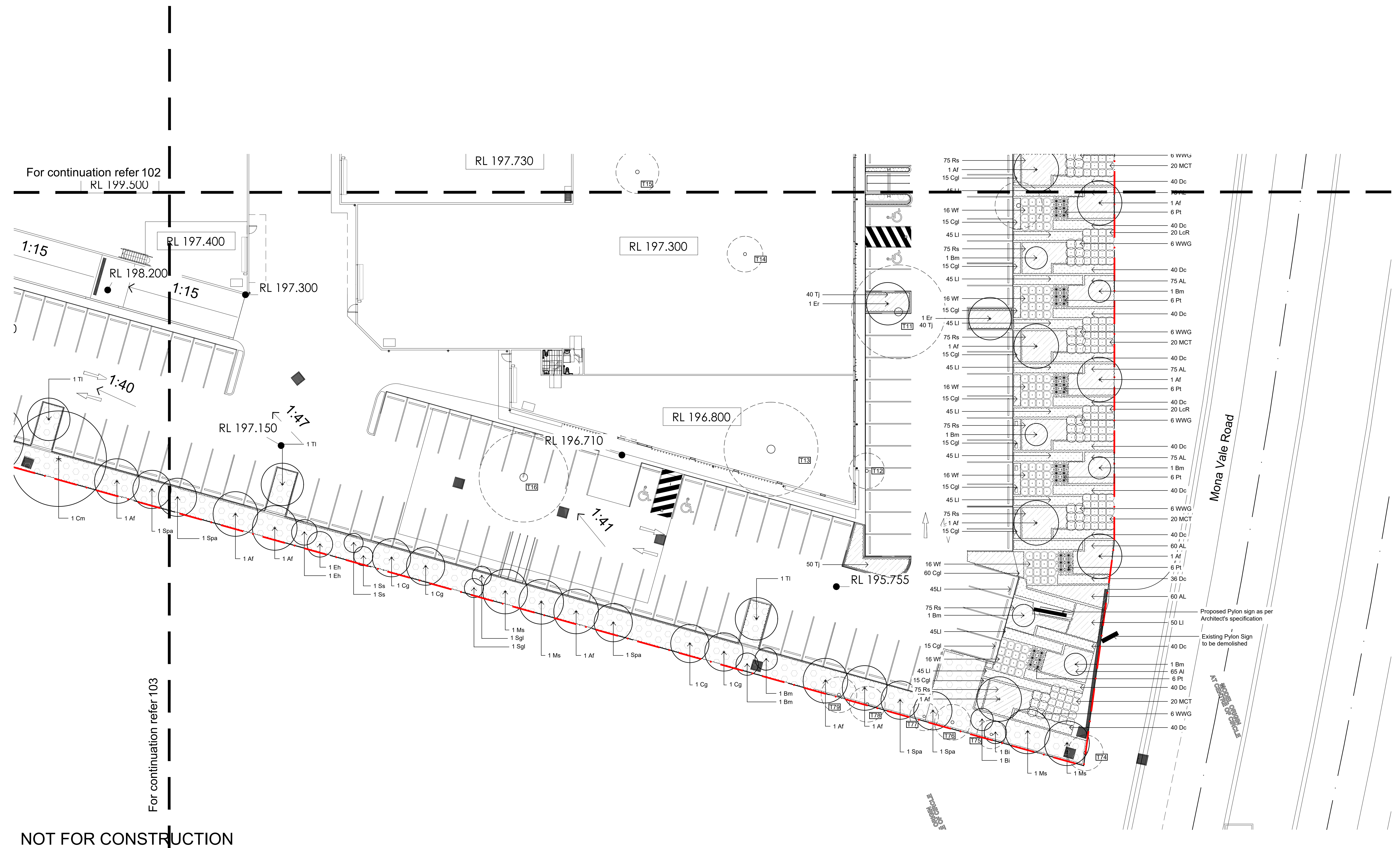

NOT FOR CONSTRUCTION

© 2021 Site Image (NSW) Pty Ltd ABN 44 801 262 380 as agent for Site Image NSW Partnership. All rights reserved. This drawing is copyright and shall not be reproduced or copied in any form or by any means (graphic, electronic or mechanical including photocopy) without the written permission of Site Image (NSW) Pty Ltd. Any license, expressed or implied, to use this document for any purpose what so ever is restricted to the terms of the written agreement between Site Image (NSW) Pty Ltd and the instructing party.

The contractor shall check and verify all work on site (including work by others) before commencing the landscape installation. Any discrepancies are to be reported to the Project Manager or Landscape Architect prior to commencing work. Do not scale this drawing. Any required dimensions not shown shall be referred to the Landscape Architect for confirmation.

| Legend | |
|--------|--|
| | Site Boundary |
| | Proposed Trees (Refer to Schedule and Detail) |
| | Existing Trees to be Retained |
| | Existing Trees to be Removed |

| | |
|--|--|
| | Ground Cover (Refer to Schedule and Detail) |
| | Boundary Planting Matrix (Refer to Schedule and Detail) |
| | Shrubs and Accents (Refer to Schedule and Detail) |
| | Turf |

Key Plan

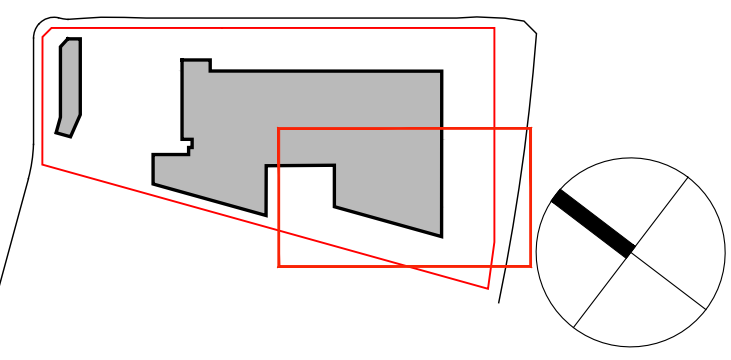

SITE IMAGE
Landscape Architects
Level 1, 3-5 Baptist Street
Redfern NSW 2016
Australia
Tel: (61 2) 8332 5600
Fax: (61 2) 9698 2877
www.siteimage.com.au

Client
Flower Power

Project
Flower Power Garden Centre
277 Mona Vale Road
Terrey Hills, NSW

Drawing Name
Landscape Plan - 4

Development Application

Scale 1:200 @ A1

Job Number
SS21-4790

Drawing Number
104

Issue
F

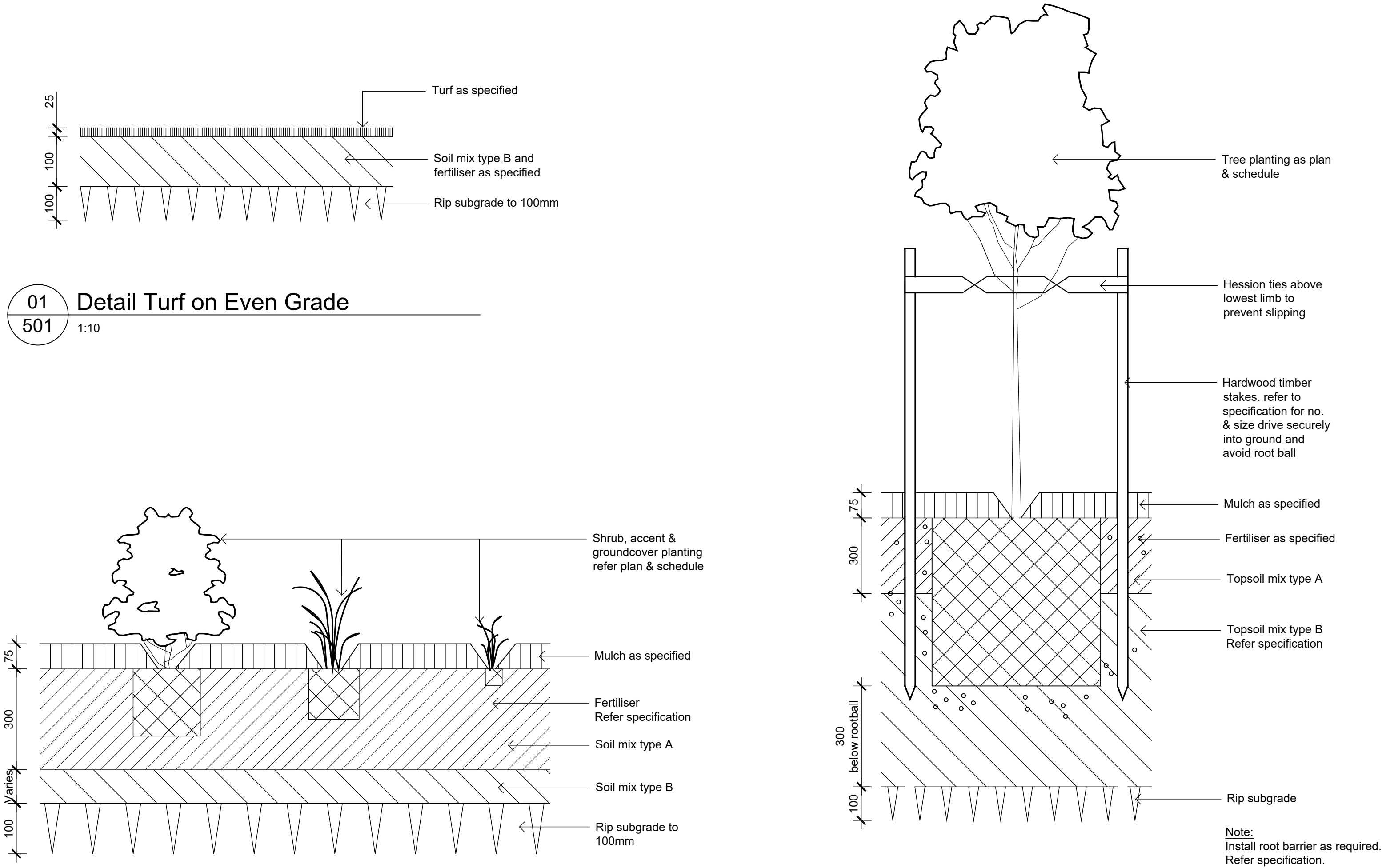

Indicative Plant Schedule

| | Botanical Name | Common Name | Mature Size (h x w) | Spacings | Pot Size |
|--------------------------|--|---------------------------|---------------------|---------------|----------|
| Carpark Trees | | | | | |
| Er | Elaeocarpus reticulatus | Blueberry Ash | 10 x 4 | As Shown | 100L |
| Md | Melaleuca decora | White Feather Honeymyrtle | 6 x 3 | As Shown | 100L |
| Mq | Melaleuca quinquenervia | Paperbark | 12 x 6 | As Shown | 100L |
| Tl | Tristaniaopsis laurina | Water Gum | 10 x 5 | As Shown | 100L |
| Boundary Trees | | | | | |
| Af | Angophora floribunda | Rough-barked Angophora | 18 x 7 | As Shown | 45L |
| Bm | Backhousia myrtifolia | Grey Myrtle | 5 x 3.5 | As Shown | 45L |
| Bi | Bankia integrifolia | Coast Banksia | 10 x 3.5 | As Shown | 45L |
| Cg | Casuarina glauca | Swamp She-oak | 14 x 6 | As Shown | 45L |
| Cgu | Corymbia gummifera | Red Bloodwood | 30 x 10 | As Shown | 45L |
| Cm | Corymbia maculata | Spotted Gum | 45 x 15 | As Shown | 45L |
| Eh | Eucalyptus haemastoma | Scribbly Gum | 10 x 4 | As Shown | 45L |
| Ms | Melaleuca stypheloides | Prickly-leaved Paperbark | 20 x 7 | As Shown | 45L |
| Sg | Syzygium glomulifera | Turpentine | 25 x 12 | As Shown | 45L |
| Sgl | Synoum glandulosum | Scentless Rosewood | 7 x 3 | As Shown | 45L |
| Spa | Syzygium paniculatum | Magenta Lilly Pilly | 9 x 6 | As Shown | 45L |
| Ss | Syzygium smithii | Common Lilly Pilly | 5 x 3 | As Shown | 45L |
| Shrubs and Accents | | | | | |
| AsM | Acmena smithii 'Minor' | Dwarf Lilly Pilly | 4 x 2 | As Shown | 300mm |
| De | Doryanthes exceisa | Gymea Lily | 3 x 2 | As Shown | 200mm |
| LcR | Loropetalum chinense 'Rubrum ' | Chinese Fringe Flower | 1 x 1 | As Shown | 200mm |
| MCT | Melaleuca linariifolia 'Claret Tops' | Honey Myrtle | 1 x 1 | As Shown | 200mm |
| PgR | Photinia glabra 'Rubens' | Japanese Photinia | 4 x 2 | As Shown | 300mm |
| Pt | Phormium tenax | New Zealand Flax | 3 x 1.5 | As Shown | 200mm |
| PX | Philodendron 'Xanadu' | Xanadu | .8 x 1 | As Shown | 200mm |
| WF | Westringia fruticosa | Coastal Rosemary | 2 x 2 | As Shown | 200mm |
| WWG | Westringia 'Wynyabbie Gem' | Coastal Rosemary | 2 x 2 | As Shown | 200mm |
| Groundcovers / Grasses | | | | | |
| AL | Acacia 'Limelight' | Acacia Limelight | 0.5 x 0.5 | 5/m2 | 150mm |
| Cgl | Carpobrotus glaucescens | Pigface | .2 x 1 | 5/m2 | 150mm |
| Cap | Carex appressa | Tall sedge | .8 x 1 | 5/m2 | 150mm |
| DcB | Dianella caerulea 'Breeze' | Breeze Paroo Lily | .6 x .6 | 5/m2 | 150mm |
| HvR | Hardenbergia violacea 'Rosea' | Native Sarsaparilla | 2 x 1 | 5/m2 | 150mm |
| Hs | Hibbertia scandens | Guinea Flower | .5 x 1 | 5/m2 | 150mm |
| LI | Lomandra longifolia | Mat Rush | .7 x 1 | 5/m2 | 150mm |
| MpY | Myoporum parvifolium 'Yareena' | Yareena Myoporum | 1.5 | 5/m2 | 150mm |
| PIE | Poa labillardieri 'Eskdale' | Tussock Grass | .6 x .6 | 5/m2 | 150mm |
| Rs | Rhagodia spinescens 'Aussie Flat Bush' | Saltbush | 0.4 x 1 | 5/m2 | 150mm |
| Tj | Trachelospermum jasminoides | Star Jasmine | .2 x .5 | 5/m2 | 150mm |
| Boundary Planting Matrix | | | | | |
| | Botanical Name | Common Name | Mature Size (h x w) | Density /25m2 | Pot Size |
| Be | Bankia ericifolia | Heath-leaved Banksia | 6 x 2 | 7 | 150mm |
| De | Doryanthes exceisa | Gymea Lily | 3 x 2 | As Shown | 200mm |
| Dt | Dodonaea triquetra | Common Hop-Bush | 3 x 2 | 7 | 150mm |
| Wf | Westringia fruticosa | Coast Rosemary | 1 x 1 | 7 | 150mm |
| Dc | Dianella caerulea | Blue Flax Lily | .4 x .4 | 10 | Tube |
| Cg | Carpobrotus glaucescens | Pig Face | .2 x 1 | 10 | Tube |
| Hs | Hibbertia scandens | Golden Guinea Flower | .2 x 1 | 10 | Tube |
| LI | Lomandra longifolia | Spiny-headed Mat-rush | .6 x .6 | 10 | Tube |

NOT FOR CONSTRUCTION

© 2021 Site Image (NSW) Pty Ltd ABN 44 801 262 380 as agent for Site Image NSW Partnership. All rights reserved. This drawing is copyright and shall not be reproduced or copied in any form or by any means (graphic, electronic or mechanical including photocopy) without the written permission of Site Image (NSW) Pty Ltd Any license, expressed or implied, to use this document for any purpose what so ever is restricted to the terms of the written agreement between Site Image (NSW) Pty Ltd and the instructing party.

The contractor shall check and verify all work on site (including work by others) before commencing the landscape installation. Any discrepancies are to be reported to the Project Manager or Landscape Architect prior to commencing work. Do not scale this drawing. Any required dimensions not shown shall be referred to the Landscape Architect for confirmation.

| | | | | |
|-------|----------------------------|-------|-------|------------|
| F | Development Application | LP | NM | 18.04.2024 |
| E | For Comment | LP | NM | 27.03.2024 |
| D | Architectural Coordination | LW | NM | 24.05.2023 |
| C | Architectural Coordination | LW | NM | 21.04.2023 |
| B | Architectural Coordination | LW | NM | 21.02.2022 |
| A | Preliminary | LW | NM | 31.01.2022 |
| Issue | Revision Description | Drawn | Check | Date |



Client
Flower Power

Project
Flower Power Garden Centre
277 Mona Vale Road
Terrey Hills, NSW

Drawing Name
Landscape Details

Development Application

Scale
Job Number
Drawing Number
Issue

SS21-4790

501 F

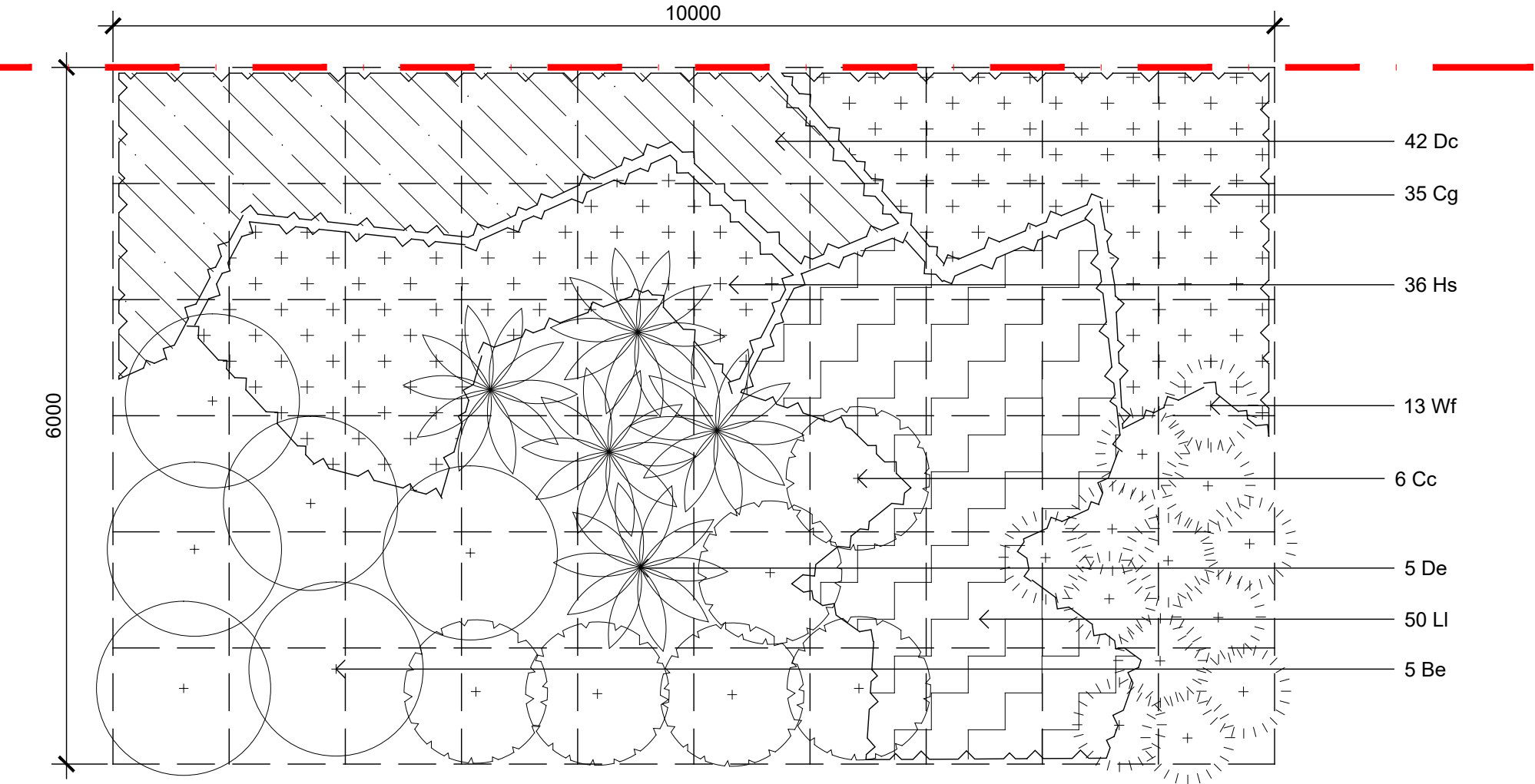

01
502

Boundary Planting Matrix

1:50
Shrubs to be planted away from existing and proposed tree's to ensure shrub and tree canopy are not connected.

NOT FOR CONSTRUCTION

© 2021 Site Image (NSW) Pty Ltd. ABN 44 801 262 380 as agent for Site Image NSW Partnership. All rights reserved. This drawing is copyright and shall not be reproduced or copied in any form or by any means (graphic, electronic or mechanical including photocopy) without the written permission of Site Image (NSW) Pty Ltd. Any license, expressed or implied, to use this document for any purpose what so ever is restricted to the terms of the written agreement between Site Image (NSW) Pty Ltd and the instructing party.

The contractor shall check and verify all work on site (including work by others) before commencing the landscape installation. Any discrepancies are to be reported to the Project Manager or Landscape Architect prior to commencing work. Do not scale this drawing. Any required dimensions not shown shall be referred to the Landscape Architect for confirmation.

| | | | | |
|-------|----------------------------|-------|-------|------------|
| F | Development Application | LP | NM | 18.04.2024 |
| E | For Comment | LP | NM | 27.03.2024 |
| D | Architectural Coordination | LW | NM | 24.05.2023 |
| C | Architectural Coordination | LW | NM | 21.04.2023 |
| B | Architectural Coordination | LW | NM | 21.02.2022 |
| A | Preliminary | LW | NM | 31.01.2022 |
| Issue | Revision Description | Drawn | Check | Date |



Client
Flower Power

Project
Flower Power Garden Centre
277 Mona Vale Road
Terrey Hills, NSW

Drawing Name
Landscape Details

Development Application

Scale
Job Number
Drawing Number
Issue

SS21-4790
502 F