

EXISTING TREE SCHEDULE						
TREE No.	BOTANICAL NAME	COMMON NAME	DBH	SPREAD	HEIGHT	RETAIN / REMOVE
T1	MELALEUCA QUINQUENRERIA	BROAD LEAF PAPERBARK	0.20m	5m	10m	REMOVE
T2	BRACHYCHITON ACERIFOLIUS	ILLAWARRA FLAME TREE	0.20m	8m	10m	RETAIN
T3	BRACHYCHITON ACERIFOLIUS	ILLAWARRA FLAME TREE	0.17m	7m	8m	RETAIN
T4	SYNCARPIA GLOMULIFERA	TURPENTINE	0.31m	6m	8m	RETAIN
T5	SYNCARPIA GLOMULIFERA	TURPENTINE	0.20m	6m	10m	RETAIN
T6	SYNCARPIA GLOMULIFERA	TURPENTINE	0.18m	4m	10m	RETAIN
T7	SYNCARPIA GLOMULIFERA	TURPENTINE	0.64m	10m	16m	RETAIN
T8	JACARANDA MIMOSIFOLIA	JACARANDA	0.30m	4m	10m	REMOVE
T9	JACARANDA MIMOSIFOLIA	JACARANDA	0.48m	8m	10m	REMOVE
T10	CYATHEA COOPERI	TREE FERN	0.15m	4m	7m	REMOVE
T11	CYATHEA COOPERI	TREE FERN	0.15m	4m	6m	REMOVE
T12	CYATHEA COOPERI	TREE FERN	0.05m	3m	4m	REMOVE
T13	CYATHEA COOPERI	TREE FERN	0.15m	6m	8m	REMOVE
T14	CYATHEA COOPERI	TREE FERN	0.15m	4m	8m	REMOVE

Site Analysis Legend					
	Site vehicle entry		Prevailing wind		Sediment control device during construction phase
	Waste storage area during construction phase		Materials storage area during construction phase		Proposed 'hard' works shown blue

Note:
1/ Pool pavement pattern and setout shown is indicative only. No allowance has been made for coping overhang, mortar gaps and joints.
2/ Pool fence shown is the approximate position of proposed 1200mm(h) minimum childproof safety barrier with sc/sl gate in accordance with AS1926.1-2012 as adopted by the Swimming Pools Regulation 2008. The proposed pool enclosure has been designed to comply with the Australian standard, the swimming pools act and swimming pools regulation. Serenescapes Landscape Designs accepts no responsibility if changes during construction & installation cause any non-compliance.
3/ The boundary fence inside the pool zone must be a minimum height of 1800mm with a non climbable zone of 900mm on the inside of the fencing in accordance with the Australian Standard prescribed by the Swimming Pools Regulation 2008.
4) Any shrubs or plants located adjacent to the pool enclosure must be maintained for the lifetime of the development at a height that does not interfere with the required non climbable zones.

Note:
- Contractors to check and verify all dimensions and all levels on site prior to any works.
- Any discrepancies should be immediately referred to Serenescapes Landscape Designs.
- All work to comply with B.C.A. Statutory Authorities and relevant Australian Standards.
- Dimensions recognised over scaling. All measurements are in millimetres.
- Copyright Serenescapes Landscape Designs 2018.

Serenescapes Landscape Designs
ABN 71 611 726 222

Suite 54, 14 Narabang Way
Belrose NSW 2085
Tel: 02 9986 2157
info@serenescapes.com.au
www.serenescapes.com.au

Client:
Jon & Alison Cutler

Site Address:
**46A Irrubel Road
Newport**

Drawing Title:
**Site Plan / Site Analysis /
Sedimentation Control Plan**

Drawn by:
Ben Farrar
AILDM # 1179

Project Number:
18495

Scale:
1:200 @ A3

Sheet Number:
L-01 of 7

Rev:
A

Date:
23/11/18

Issue:
Preliminary Issue

Checked:
TB

Rev:
B

Date:
09/01/19

Issue:
DA Issue

Checked:
TB

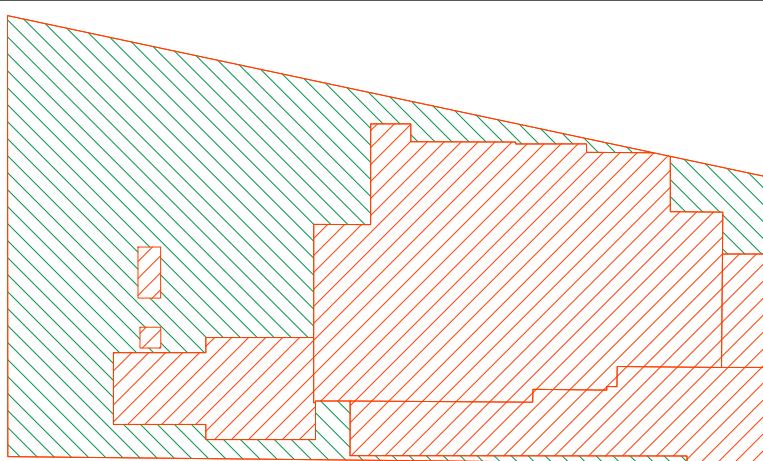

Landscape Area Diagram
Scale 1:400

Landscape Area Calculations Legend	
	Landscape Area
	Excluded From Landscape Area

Landscape area calculations including access handle

Site Area:	1060.80m ²
Required landscape area:	636.48m ² (60%)
Existing landscape area:	509.87m ² (48.06%)
Proposed landscape area:	439.57m ² (41.44%)
Impervious area allowance:	63.65m ² (6%)
Total landscape areas:	503.22m ² (47.44%)

Landscape area calculations excluding access handle

Site Area:	774.24m ²
Required landscape area:	464.54m ² (60%)
Existing landscape area:	430.08m ² (55.55%)
Proposed landscape area:	363.89m ² (47.00%)
Impervious area allowance:	46.45m ² (6%)
Total landscape areas:	410.34m ² (53.00%)

Note:
1. Ensure minimum clearance from outer edge of access chamber lid is 1 metre. No structures above existing ground level within. Refer to Diagram 7 of Sydney Water Technical Guidelines for building over and adjacent to pipe assets' for details.
2. Ensure minimum clearance from outer edge of access chamber structure and vertical face of swimming pool is 2 metres. Refer to Diagram 13 of Sydney Water Technical Guidelines for building over and adjacent to pipe assets' for details.

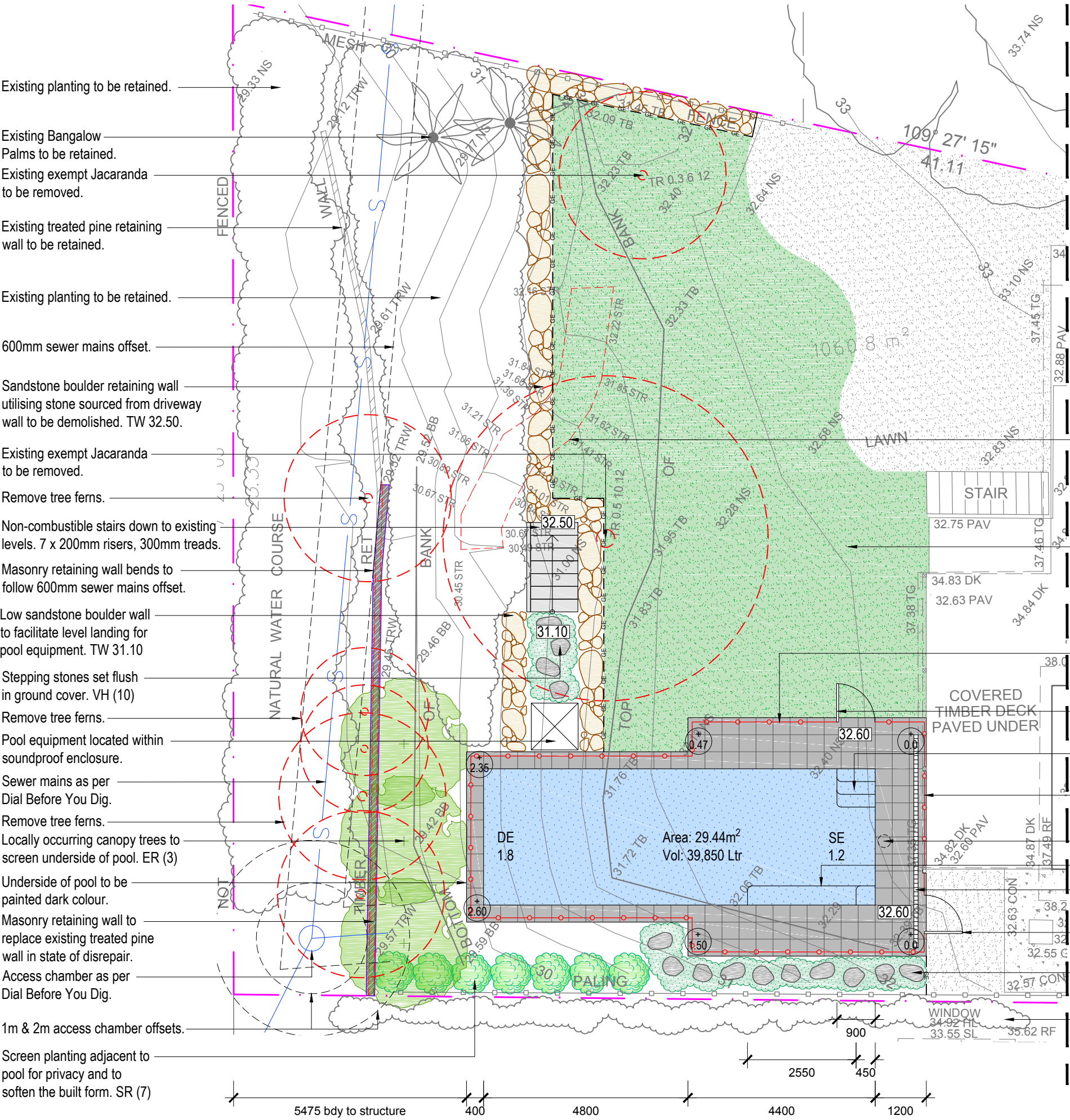

ZONE A PROPOSED PLANT SCHEDULE					
KEY	BOTANICAL NAME	COMMON NAME	QTY	MATURE HEIGHT	POT SIZE
ER"	TREES ELAEOCARPUS RETICULATUS	BLUEBERRY ASH	3	8m	45Ltr
	SHRUBS SYZYGIUM AUSTRALE 'RESILIENCE'	RESILIENCE	7	5m	300mm
VH	GRASSES / GROUND COVERS VIOLA HEDERACEAE	NATIVE VIOLET	30	0.1m	tubes

" Denotes species selected from Shale Slopes plant community as found within 'Native plants for your garden' publication.

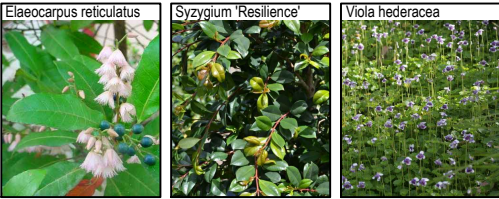

Existing timber stairs to be demolished.

New Soft Leaf Buffalo turf as required.

1200mm (h) frameless glass fence over extended walkway.

Self closing, self locking gate.

Pool entry steps.

1200mm (h) frameless glass fence between existing posts.

Skimmer box under tile infill lid.

Entry step & seating ledge.

Strip grate drain to be connected to existing storm water system.

Self closing, self locking gate.

Stepping stones set flush in ground cover to facilitate maintenance access.

Existing neighbouring screen planting.

Beyond scope of works.
Refer to L-01 for details.

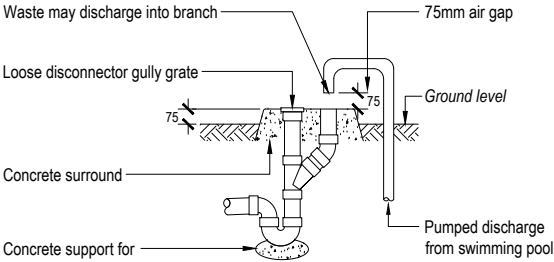

Note: Overflow relief gully (ORG) to be constructed to AS/NZS 3500.

Overflow relief gully
N.T.S

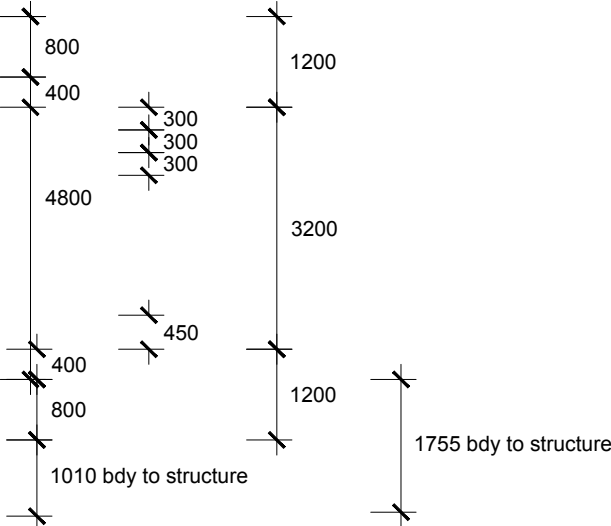

Note:
- Contractors to check and verify all dimensions and all levels on site prior to any works.
- Any discrepancies should be immediately referred to Serenescapes Landscape Designs.
- All work to comply with B.C.A. Statutory Authorities and relevant Australian Standards.
- Dimensions recognised over scaling. All measurements are in millimetres.
- Copyright Serenescapes Landscape Designs 2018.



Serenescapes Landscape Designs
ABN 71 611 726 222

Suite 54, 14 Narabang Way
Belrose NSW 2085
Tel: 02 9986 2157
info@serenescapes.com.au
www.serenescapes.com.au

Client:

Jon & Alison Cutler

Site Address:

46A Irrubel Road
Newport

Drawing Title:

Zone A Landscape Plan

Drawn by:

Ben Farrar
AILDM # 1179

Project Number:

18495

Scale:

1:100 @ A3

Sheet Number:

L-02 of 7

Rev:

A

Date:

23/11/18

Issue:

Preliminary Issue

Checked:

TB

B

09/01/19

DA Issue

TB



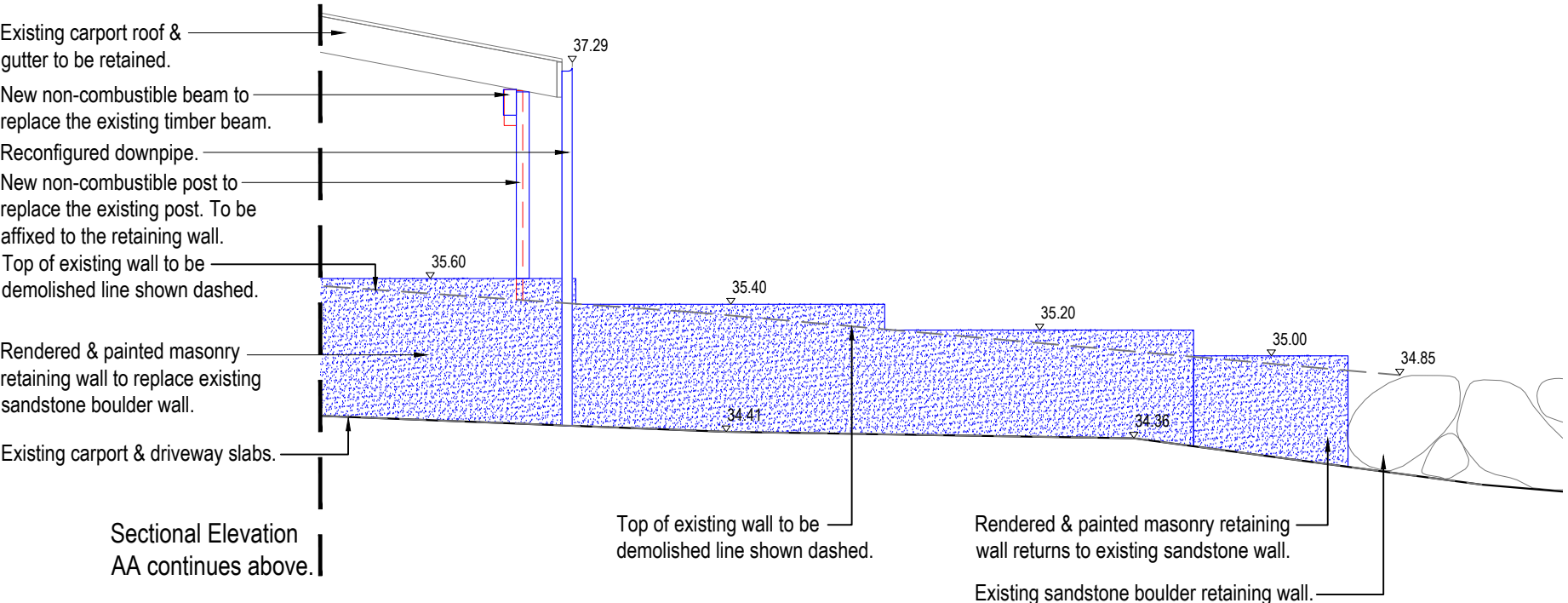
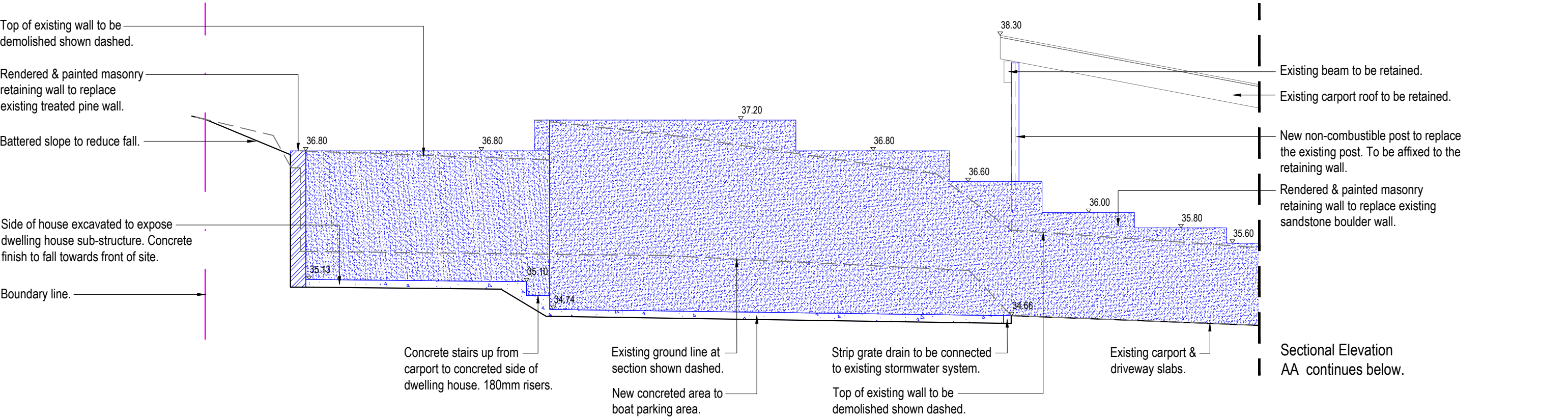

Sectional Elevation AA
Scale 1:50

Note:
- Contractors to check and verify all dimensions and all levels on site prior to any works.
- Any discrepancies should be immediately referred to Serenescapes Landscape Designs.
- All work to comply with B.C.A. Statutory Authorities and relevant Australian Standards.
- Dimensions recognised over scaling. All measurements are in millimetres.
- Copyright Serenescapes Landscape Designs 2018.

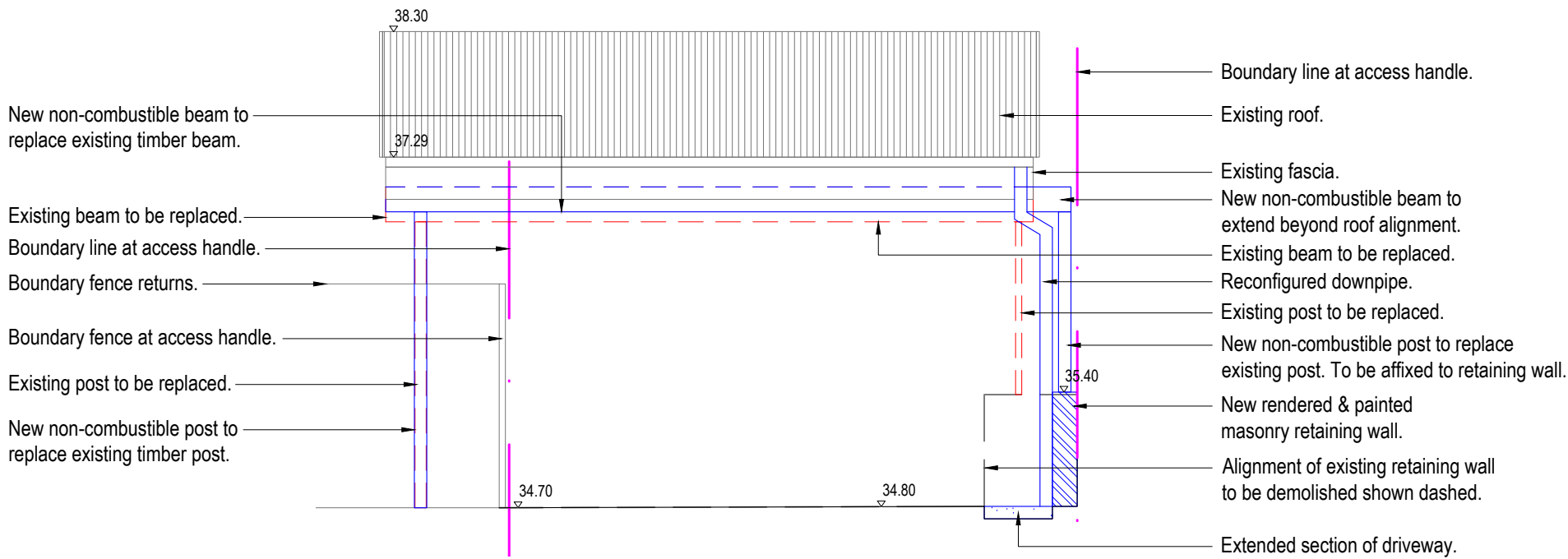

Sectional Elevation BB
Scale 1:50

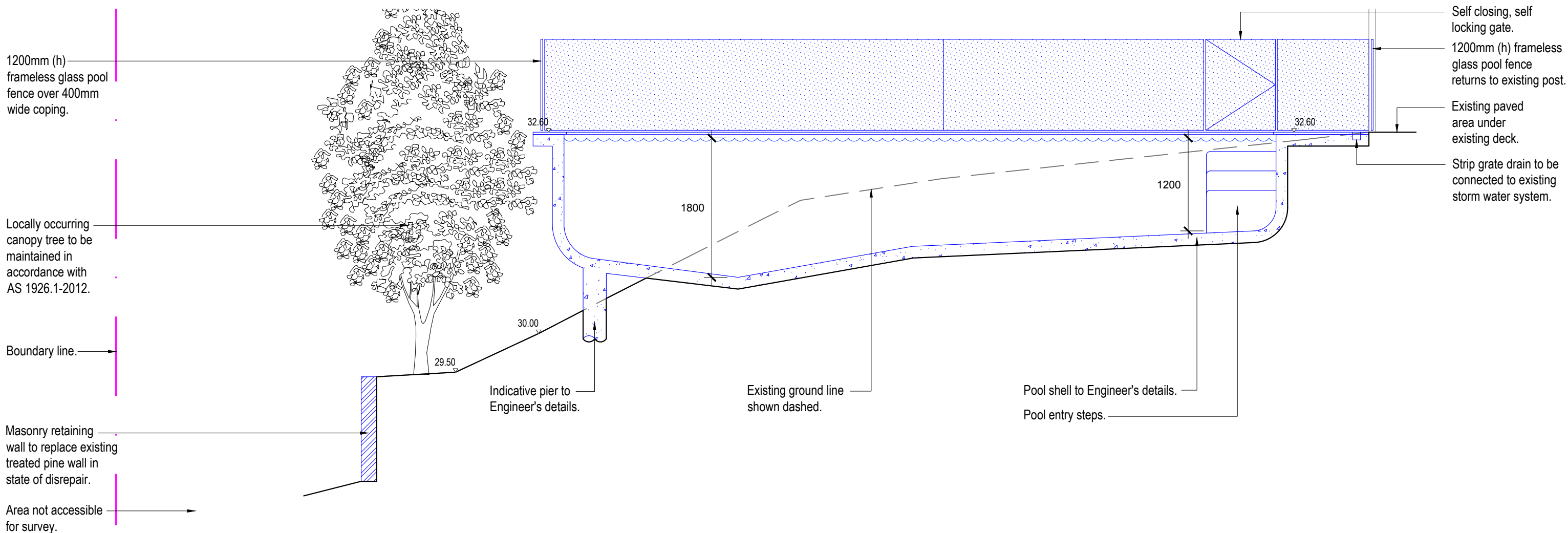

Sectional Elevation CC
Scale 1:50

Note:
- Contractors to check and verify all dimensions and all levels on site prior to any works.
- Any discrepancies should be immediately referred to Serenescapes Landscape Designs.
- All work to comply with B.C.A. Statutory Authorities and relevant Australian Standards.
- Dimensions recognised over scaling. All measurements are in millimetres.
- Copyright Serenescapes Landscape Designs 2018.



Serenescapes Landscape Designs
ABN 71 611 726 222

Suite 54, 14 Narabang Way
Belrose NSW 2085
Tel: 02 9986 2157
info@serenescapes.com.au
www.serenescapes.com.au

Client:
Jon & Alison Cutler
Site Address:
**46A Irrubel Road
Newport**

Drawing Title:
Sectional Elevation
Drawn by:
Ben Farrar
AILDM # 1179
Project Number:
18495
Scale:
1:50 @ A3
Sheet Number:
L-05 of 7

Rev:	Date:	Issue:	Checked:
A	23/11/18	Preliminary Issue	TB
B	09/01/19	DA Issue	TB



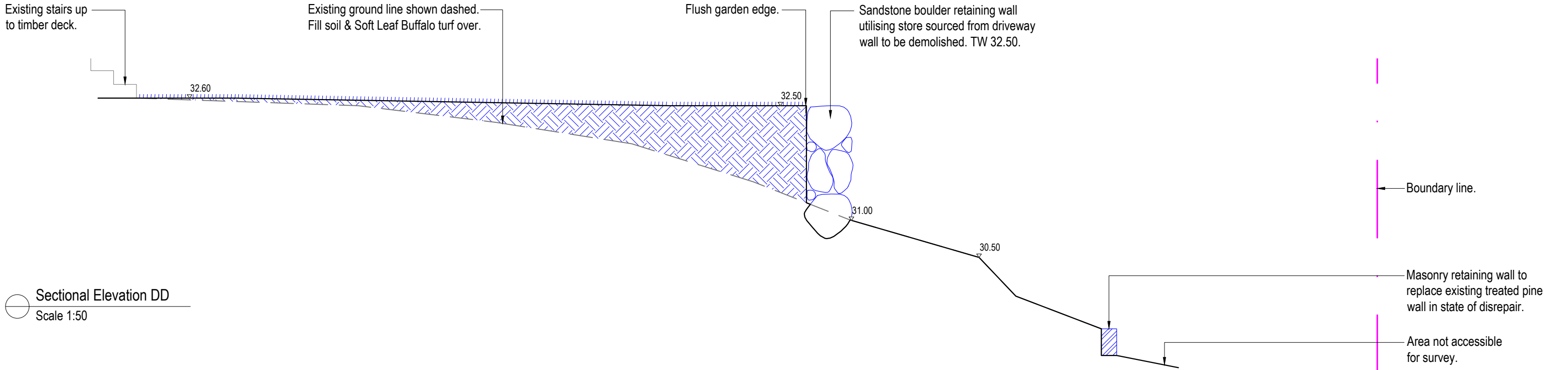

Sectional Elevation DD
Scale 1:50

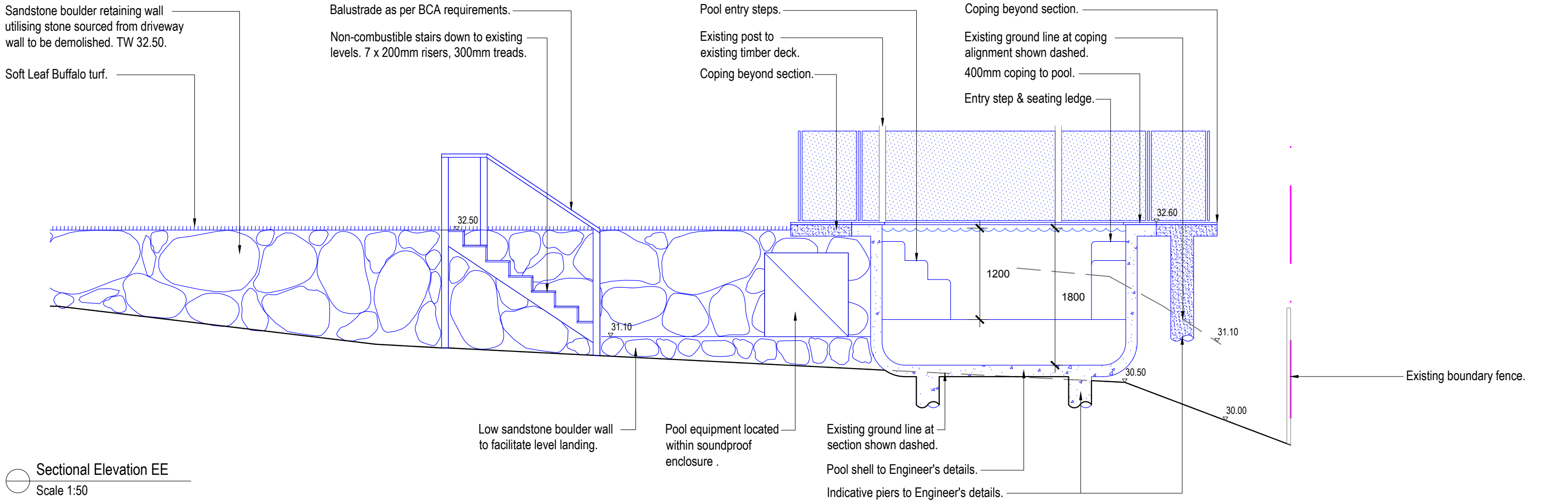

Sectional Elevation EE
Scale 1:50

Note:
- Contractors to check and verify all dimensions and all levels on site prior to any works.
- Any discrepancies should be immediately referred to Serenescapes Landscape Designs.
- All work to comply with B.C.A. Statutory Authorities and relevant Australian Standards.
- Dimensions recognised over scaling. All measurements are in millimetres.
- Copyright Serenescapes Landscape Designs 2018.



Serenescapes Landscape Designs
ABN 71 611 726 222

Suite 54, 14 Narabang Way
Belrose NSW 2085
Tel: 02 9986 2157
info@serenescapes.com.au
www.serenescapes.com.au

Client: Jon & Alison Cutler		Drawing Title: Sectional Elevation				Rev: A	Date: 23/11/18	Issue: Preliminary Issue	Checked: TB
Site Address: 46A Irrubel Road Newport		Drawn by: Ben Farrar AILDM # 1179	Project Number: 18495	Scale: 1:50 @ A3	Sheet Number: L-06 of 7	B	09/01/19	DA Issue	TB



LANDSCAPE SPECIFICATION NOTES

SITE PREPARATION

Locate any underground and overground services & ensure no damage occurs. Levels on plan are nominal only & all dimensions to be checked on site prior to commencement. Final structural integrity of all items shall be the sole responsibility of landscape contractor.

PROTECTION OF EXISTING TREES:

Prior to construction, the builder shall erect tree protection fencing to the drip line of existing trees to be retained.

The fence shall be constructed of star pickets at 2.4m spacings and connected by three strands of 2mm wire at 300mm spacings to a minimum height of 1500mm.

Protect all trees affected by demolition & construction. Take necessary precautions to protect the Critical Root Zone(CRZ) which is the area normally within 3m radius from each tree trunk.

Tree protection measures shall remain intact until the completion of all construction works.

Prohibited Works within the CRZ:

- entry of machinery or storage of building materials
- parking of any kind of vehicle
- erection or placement of site facilities
- removal or stockpiling of soil or site debris
- disposal of liquid waste including paint & concrete wash
- excavation or trenching of any kind (including irrigation or electrical connections).
- attaching any signs or any other objects to the tree
- placement of waste disposal or skip bins
- pruning and removal of branches, other than those by a qualified Arborist

Compacted Ground/Coring: Avoid compaction of the ground under trees. If compaction nevertheless occurs loosen the soil by Coring. Coring to be carried out by a qualified Arborist.

REMOVAL OF EXISTING TREES

All trees to be removed shall be carried out by a qualified arborist and work shall conform to the provisions of AS4373-2007 Australian Standards for The Pruning of Amenity Trees.

ELIMINATE WEEDS

Remove all existing weeds by hand, wiping or spraying with a glyphosate based herbicide. Weed control shall never be performed by mechanical cultivation or by scraping. Herbicide spraying is to be used to eliminate all existing weeds 30 days prior to planting.

EXCAVATION & SUB SOIL PREPARATION

Excavate garden beds to the depth required and rip or scarify base & sides of pit to a minimum depth of 150mm.

SUB SOIL DRAINAGE

Install drainage layer where there is surface water runoff draining into garden bed areas & where the existing sub-soil has more than 50% clay composition & there is a risk of subsurface water ponding. Install perforated corrugated ag. line 75-100mm Dia. with geotextile filter sock & backfill to a minimum 200mm using free draining material, reclaimed/recycled where available. Direct flows at a minimum 0.5% fall to sw system. In areas isolated from stormwater system excavate & backfill an appropriate water dispersion pit.

REUSE EXISTING TOPSOIL

Existing site topsoil should be salvaged & appropriately stockpiled where possible.

IMPORTED TOPSOIL

Quality System: AS 4419 or as specified below.

Turf Areas: 'Turf Underlay' as supplied by, ANL p: 02 9450 1444 or approved alternative.

Tree Pit and Shrub Planting: 'Premium Garden Mix' as supplied by, ANL p: 02 9450 1444 or approved alternative.

PLANTING

Health & Vigour: Supply plants with foliage size, texture & colour consistent with that shown in healthy specimens of the species.
Balance of Crown: Supply plants with max. variation in crown bulk on opposite sides of stem axis, +/- 20%.
Stock selection should be based on NATSPEC Guide *Specifying Trees: a Guide to Assessment of Tree Quality*.

STAKING

Install 2 x 1800mm 40x40 hardwood timber stakes with hessian ties to all trees. Provide appropriate support considering exposure to prevailing winds. Stakes and hessian ties to be removed as soon as the tree is self supporting.

ALUMINIUM GARDEN EDGING

Supply and install Link Edge 75mm as per Landscape Plan. Compact and level the base in the required area as indicated on Landscape Plan. Half hammer spikes into pre-punched holes (approx. 4 spikes every 3m length) starting from the first hole in the end of the Link Edge. Use spike washers supplied by manufacturer.Half hammer subsequent spikes in pivotal areas along the length. (Especially at points where a curve is required). Connect lengths together by using fish-plate connectors supplied by manufacturer. Check position of Link Edge is correct before hammering spikes firmly into ground.

IRRIGATION SYSTEM

New dripline irrigation system to be installed with backflow preventer and with timers. Irrigation system to be designed and installed to local codes.

The entire irrigation system shall be fully automated and provide drip irrigation to all tree, shrub and ground cover zones. It is the Contractor's responsibility to verify water pressure available and determine all design-built parameters prior to any installation and sizing of irrigation components. Irrigation system to be connected to water tank to supplement water from mains.

MULCHING

Quality system: AS 4454

All planting area impacted by building works to receive 50-75mm of non-combustible mulch. Keep mulch 100mm away from plant stem & form a well to stop excessive water runoff. Finish flush with adjacent surfaces.

TURFING

New turf- Sir Walter Soft Leafed Buffalo.

Excavate / grade all areas to be turfed to 120mm below finished levels. Ensure that all surface runoff is directed away from buildings. Ensure that no pooling or ponding will occur. Further rip the sub-grade to 150mm. Install 100mm of imported turf underlay. Rolls to be closely butted and laid in a brickwork pattern. Fill any small gaps with topsoil and water thoroughly.

WATERING

Water in immediately after plant installation & allow for soil settlement. For the first 2 to 4 weeks after planting, the root zone & immediate surrounds must be kept moist. Continue watering until plants have established.

STEPPING STONES

Install each stepping stone on a 75mm thick mortar bed and space according to plan. Stones to finish flush with adjoining levels. Fill gaps with groundcovers as specified.

RETAINING WALLS & PLANTER BOXES

All retaining walls & planter boxes to be constructed to Engineer's details. Ensure all internal surfaces are waterproofed. Geotextile wrapped ag. drainage line backfilled with aggregate is to be installed behind all retaining walls & connected to stormwater in accordance with Sydney Water regulations. All planter boxes are to have Atlantis drainage cell (or approved alternative) installed & connected to stormwater in accordance with Sydney Water regulations.

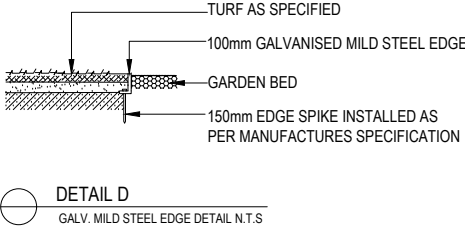
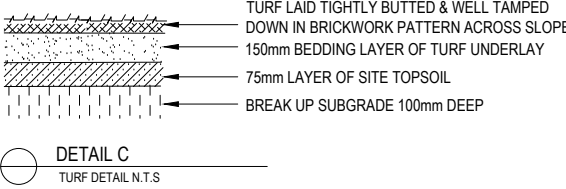
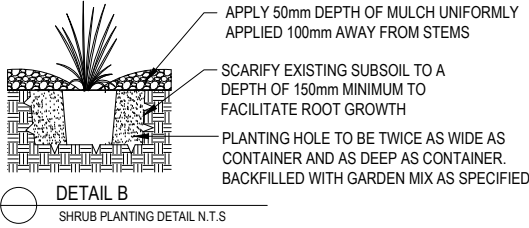
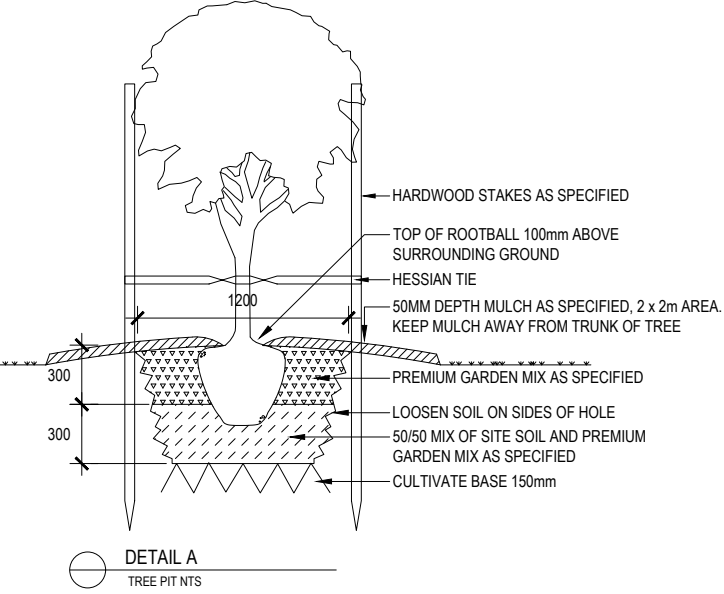

Note:
- Contractors to check and verify all dimensions and all levels on site prior to any works.
- Any discrepancies should be immediately referred to Serenescapes Landscape Designs.
- All work to comply with B.C.A. Statutory Authorities and relevant Australian Standards.
- Dimensions recognised over scaling. All measurements are in millimetres.
- Copyright Serenescapes Landscape Designs 2018.



Serenescapes Landscape Designs
ABN 71 611 726 222

Suite 54, 14 Narabang Way
Belrose NSW 2085
Tel: 02 9986 2157
info@serenescapes.com.au
www.serenescapes.com.au

Client:

Jon & Alison Cutler

Site Address:

46A Irrubel Road
Newport

Drawing Title:

Landscape Specification & Details

Drawn by:

Ben Farrar
AILDM # 1179

Project Number:

18495

Scale:

As shown @ A3

Sheet Number:

L-07 of 7

Rev:

A

Date:

23/11/18

Issue:

Preliminary Issue

B

09/01/19

DA Issue

Checked:

TB

TB

