

NORTHERN BEACHES COUNCIL

Waste Management Plan

(For development in the area of WLEP 2011 and WLEP 2000)

This plan is to be completed
in accordance with Council's

Waste Management Guidelines

(For development in the area of WLEP 2011 and WLEP 2000)

Effective Date: 25 October 2016

TABLE OF CONTENTS

Purpose of the Waste Management Plan	2
Structure of the Waste Management Plan	2
Applicant and Project Details	3
Section 1 – Demolition	5
Section 2 – Construction	7
Section 3 – On-going waste management for one or two dwellings.....	9
Section 4 – On-going waste management for three or more dwellings	10
Section 5 – On-going waste management for non-residential developments	11
Section 6 – Private roadway developments.....	12

Purpose of the Waste Management Plan

This *Waste Management Plan (WMP)* will detail the arrangements for waste management during all stages of development and occupation.

The WMP must be completed in accordance with the Waste Management Guidelines (Guidelines).

A completed WMP is a mandatory requirement for any Development Application (DA) submitted under WLEP 2011 or WLEP 2000. DAs that are submitted without a completed WMP will be rejected or refused by Council.

Structure of the Waste Management Plan

All applicants are required to complete the 'Applicant and Project Details' part of the WMP and include it with the relevant Sections that apply to their proposed development.

The WMP is divided into Sections and applicants are only required to complete the relevant Sections in accordance with the Guidelines. The table below identifies which Sections are relevant to which development types.

For example, if the proposed development was to include demolition of an existing structure and construction of a single dwelling, the relevant Sections would be Sections 1, 2 and 3.

Section	Development Type [^]
Section 1 – Demolition	All
Section 2 – Construction	All
Section 3 – On-going waste management for one or two dwellings	One or two dwelling developments Mixed-use developments containing one or two dwellings
Section 4 – On-going waste management for three or more dwellings	Three or more dwelling developments Mixed-use developments containing three or more dwellings
Section 5 – On-going waste management for non-residential and mixed use developments	Commercial developments Industrial developments Mixed-use developments
Section 6 – Private roadway developments	Private roadways

[^]Note: the definitions of the development types are provided in Section vi of the Introduction to the Guidelines

Applicant and Project Details

Complete this page and the relevant Sections that apply to your proposed development.

Applicants' Details

Name: (must be the same as the DA form)	Virginia Kerridge Architect
Address: (must be the same as the DA form)	G03/ 59 GREAT BUCKINGHAM ST, REDFERN, NSW 2016
Phone Number:	(02) 9699 3487
Email Address:	virginia@vk.com.au

Property Details

Lot No: Deposited Plan (DP) No: or Strata Plan (SP) No:	LOT 1 DP300846 LOT 2 DP7391
Unit No: House No: Street: Suburb: Postcode:	41 and 43 BEACH ROAD COLLARROY NSW 2016

Project Details

Description of proposed development:	PROPOSAL IS FOR DEMOLITION AND CONSTRUCTION OF A 2 STOREY DWELLING HOUSE, BASEMENT AND SWIMMING POOL AT 41 AND 43 BEACH ROAD, COLLARROY.
Structures to be demolished:	DEMOLITION OF EXISTING - EXTERNAL WALLS, INTERNAL WALLS, EXTERNAL GLAZING, ROOF, GARAGE, SWIMMING POOL, EXTERNAL PAVING AND LANDSCAPING.

Applicant Declaration

I declare that:

1. This plan has been completed in accordance with the Waste Management Guidelines
2. To the best of my knowledge, the details on this form are accurate and correct

I understand that:

1. All records demonstrating lawful disposal of waste will be retained and kept readily accessible for inspection by regulatory authorities such as Council, NSW Environment Protection Authority or WorkCover NSW.
2. A bond in accordance with Council's fees and charges may apply to this development and must be paid to Council prior to any works commencing.
3. The bond will only be refunded when Council is satisfied that all waste outlined in this plan has been managed as per the plan, and evidence such as photos, receipts and statutory declarations must be supplied where appropriate.

Signature of Applicant: Karen Lang Date: 10/12/2019

Section 1 – Demolition

This section must be completed in accordance with ‘Chapter 1 – Demolition’ of the Waste Management Guidelines

MATERIALS ON SITE	DESTINATION <i>Evidence such as weighbridge dockets and invoices for waste disposal or recycling must be retained on site for inspection</i>					
	REUSE AND RECYCLING (MOST FAVOURABLE)				DISPOSAL (LEAST FAVOURABLE)	
Types of Waste Material	Estimated Volume (m ³) or Weight (t)	ONSITE RE-USE ✓ Specify how material will be reused on site	OFFSITE RECYCLING ✓ Recycling Outlet (RO) ✓ Waste Transport Contractor (WTC)		OFFSITE DISPOSAL ✓ Specify landfill site (LS) ✓ Specify Waste Transport Contractor (WTC)	
			WTC	RO	WTC	LS
Excavated Material	TBA	re-use to level and fill where needed	To be nominated by builder	Kimbriki Centre	To be nominated by builder	To be nominated by builder
Garden Organics	10m3	re-use in garden where needed	To be nominated by builder	Kimbriki Centre		
Bricks	26m3		To be nominated by builder	Kimbriki Centre	OPTION NOT AVAILABLE: These materials must be re-used or separated on or off site and sent for recycling.	
Tiles	12m3		To be nominated by builder	Kimbriki Centre		
Concrete	44m3		To be nominated by builder	Kimbriki Centre		
Timber	55m3		To be nominated by builder	Kimbriki Centre		
Plasterboard	30m3		To be nominated by builder	Kimbriki Centre		
Metals	44m3		To be nominated by builder	Kimbriki Centre		
Asbestos	TBA					
Other waste (please specify)	misc. packaging etc					
Estimated Total % Recovered						

Refer to the estimation tables in ‘Chapter 1 – Demolition’ of the Guidelines for assistance in completing this table.

The applicant must submit a Site Plan showing the structures to be demolished and storage areas for waste and construction materials (if the development also includes construction).

WMP Checklist

Have you included the following:	Applicant Tick
A site plan showing: <ul style="list-style-type: none"> • The structures to be demolished. • Storage areas for waste to be reused, recycled, or disposed of. • Materials storage (if the development also includes construction) 	<input checked="" type="checkbox"/>
The table on the previous page, completed in accordance with 'Chapter 1 – Demolition' in the guidelines.	<input checked="" type="checkbox"/>

Section 2 – Construction

This section must be completed in accordance with 'Chapter 2 – Construction' of the Waste Management Guidelines

MATERIALS ON SITE	DESTINATION <i>Evidence such as weighbridge dockets and invoices for waste disposal or recycling must be retained on site for inspection</i>					
	REUSE AND RECYCLING (MOST FAVOURABLE)				DISPOSAL (LEAST FAVOURABLE)	
Types of Waste Material	Estimated Volume (m ³) or Weight (t)	ONSITE RE-USE ✓ Specify how material will be reused on site	OFFSITE RECYCLING ✓ Specify recycling outlet (RO) ✓ Specify Waste Transport Contractor (WTC)		OFFSITE DISPOSAL ✓ Specify landfill site (LS) ✓ Specify Waste Transport Contractor (WTC)	
* Please specify			WTC	RO	WTC	LS
Excavated Material	TBA	re-use to level and fill where needed	To be nominated by builder	Kimbriki Centre	To be nominated by builder	To be nominated by builder
Garden Organics	3m3	re-use in garden where needed	To be nominated by builder	Kimbriki Centre		
Bricks	4.5m3		To be nominated by builder	Kimbriki Centre	OPTION NOT AVAILABLE: These materials must be re-used or separated on or off site and sent for recycling.	
Tiles	2.5m3		To be nominated by builder	Kimbriki Centre		
Concrete	0.5m3		To be nominated by builder	Kimbriki Centre		
Timber*	2m3	Timber off cuts sent to 2nd hand supplier for re-use or mulching	To be nominated by builder	Kimbriki Centre		
Plasterboard	2m3	Builder to use on other sites or return to supplier	To be nominated by builder	Kimbriki Centre		
Metals*	2m3	sent for recycling	To be nominated by builder	Kimbriki Centre		
Asbestos	N/A					
Other waste*	misc. packaging etc		To be nominated by builder	Kimbriki Centre		
Estimated Total % Recovered						

Refer to the estimation tables in 'Chapter 2 – Construction' of the Guidelines for assistance in completing this table.

The applicant must submit a Site Plan showing the structures to be demolished and storage areas for waste and construction materials (if the development also includes construction).

WMP Checklist

Have you included the following:	Applicant Tick
A site plan showing: <ul style="list-style-type: none"> • The structures to be demolished. • Potential storage areas for waste to be reused, recycled, or disposed of. • Materials storage 	<input checked="" type="checkbox"/>
The table on the previous page, completed in accordance with 'Chapter 2 – Construction' in the guidelines.	<input checked="" type="checkbox"/>

Section 3 – On-going waste management for one or two dwellings

This section is to be completed in accordance with 'Chapter 3 – On-going waste management for one or two dwellings' of the Waste Management Guidelines.

Type of development: SINGLE DWELLING

Number of dwellings: 1

WMP Checklist

Do your architectural and landscape plans include the following:	Applicant Tick
Waste Storage Area design requirements (Chapter 3.2.)	<input checked="" type="checkbox"/>
Waste Storage Area location requirements (Chapter 3.3.)	<input checked="" type="checkbox"/>

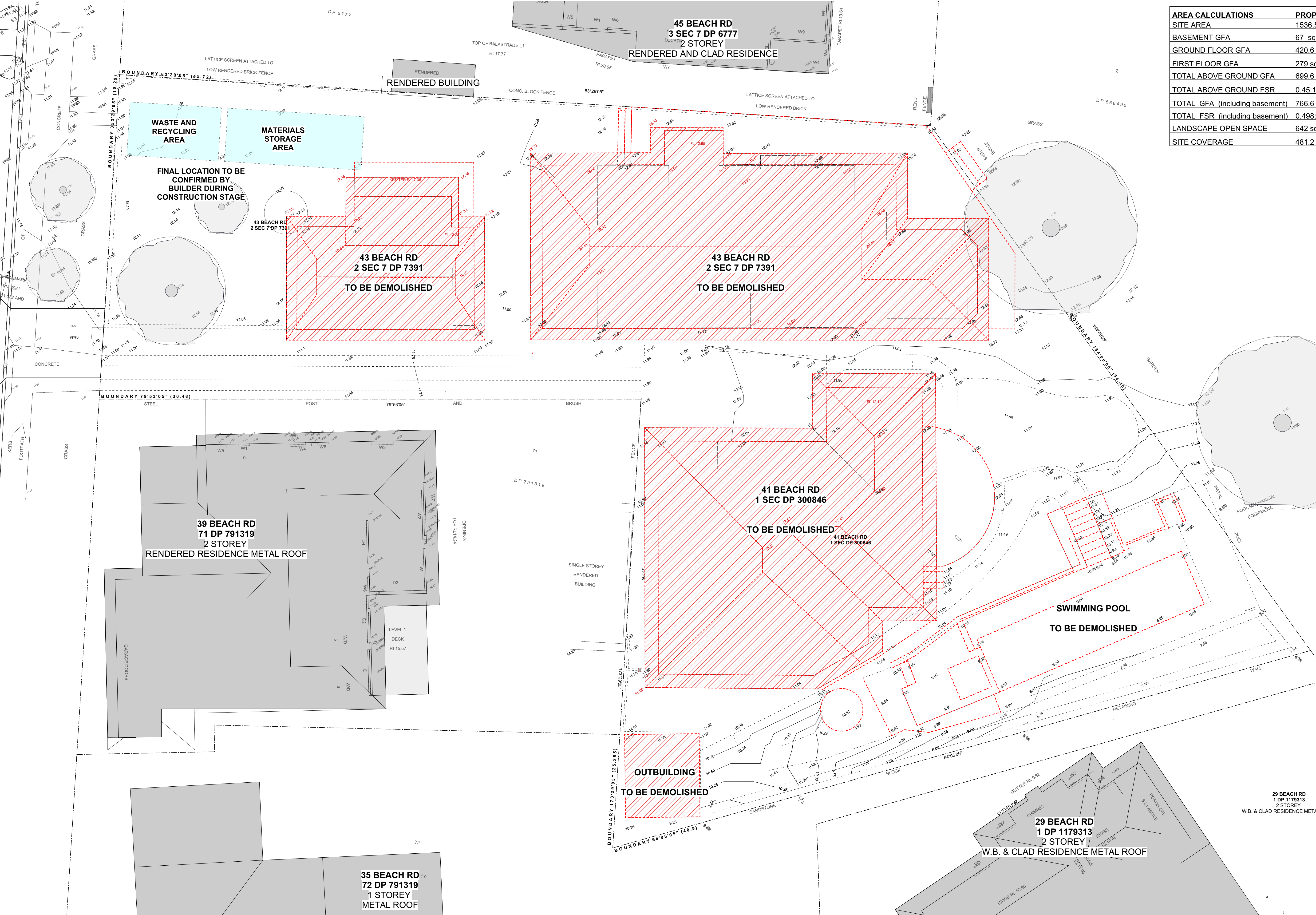

AREA CALCULATIONS	PROPOSED	ALLOWED	COMPLIES
SITE AREA	1536.5 sqm		
BASEMENT GFA	67 sqm		YES
GROUND FLOOR GFA	420.6 sqm		YES
FIRST FLOOR GFA	279 sqm		YES
TOTAL ABOVE GROUND GFA	699.6 sqm		YES
TOTAL ABOVE GROUND FSR	0.45:1	0.5:1	YES
TOTAL GFA (including basement)	766.6 sqm		
TOTAL FSR (including basement)	0.498:1	0.5:1	YES
LANDSCAPE OPEN SPACE	642 sqm= 41.7%	MIN. 40%	YES
SITE COVERAGE	481.2 sqm= 31.3%	MAX. 33.3%	YES

GENERAL NOTE:
COMPLIANCE
NCC: ALL WORK TO COMPLY WITH THE BCA AND AS REQUIREMENTS AS APPROPRIATE.
BASIX: ALL WORK TO COMPLY WITH BASIX CERTIFICATE
REFERRALS
SURVEY: REFER TO THE SURVEY PLAN FOR ALL EXISTING GROUND LEVELS.
HYDRAULIC: REFER TO THE HYDRAULIC ENGINEER'S DRAWINGS FOR ALL HYDRAULICS WORK.
LANDSCAPE: REFER TO THE LANDSCAPE DRAWINGS FOR ALL PROPOSED LANDSCAPING DETAILS.
DO NOT SCALE FROM THESE DRAWINGS.
WORK TO WRITTEN DIMENSIONS ONLY.

SHADOW KEY	
	EXISTING SHADOWS
	ADDITIONAL SHADOWS

ABBREVIATIONS	
	DOOR AT BASEMENT LEVEL
	WINDOW AT BASEMENT LEVEL
	SKYLIGHT IN LANDSCAPE ABOVE BASEMENT
	DOOR AT GF LEVEL
	SKYLIGHT ABOVE DOORS AT GF LEVEL
	WINDOW AT GF LEVEL
	SKYLIGHT ABOVE WINDOWS AT GF LEVEL
	SKYLIGHT ABOVE GF LEVEL
	DOOR AT FF LEVEL
	WINDOW AT FF LEVEL
	SKYLIGHT ABOVE FF LEVEL
RL	RELATIVE LEVEL
FFL	FINISHED FLOOR LEVEL
FCL	FINISHED CEILING LEVEL
FW	FIXED WINDOW
HD	HINGED DOOR
PD	PIVOT DOOR
PW	PIVOT WINDOW
SD	SLIDING DOOR
SW	SLIDING WINDOW

SYMBOLS KEY	
	EXISTING WALLS
	CAVITY BRICK WALLS
	TIMBER STUD WALLS
	OFF-FORM CONCRETE WALLS
	JOINERY
	TIMBER FLOORBOARDS
	TIMBER DECK
	TILED FLOORS
	GLAZING
	METAL ROOF
	TIMBER FACADE
	STEEL IN PLAN & ELEVATION
	STEEL IN SECTION
	CONCRETE IN PLAN & ELEVATION
	BRICK FACADE
	OUTDOOR PAVERS
	GREEN ROOF
	CONCRETE ROOF
	DEMOLITION
	DEMOLITION IN SECTION
	PRE-DR MEETING BUILDING LINE

NOTES:
THIS IS FOR THE PURPOSE OF DEVELOPMENT APPLICATION TO COUNCIL ONLY
REFER TO WRITTEN DIMENSIONS ONLY, DO NOT SCALE FROM DRAWINGS.
REFER TO ARCHITECTS SPECIFICATION AND SCHEDULES IN RELATION TO THESE DRAWINGS.
REFER ALL DISCREPANCIES TO THE ARCHITECT IMMEDIATELY BEFORE PROCEEDING.
REFER TO ALL CONSULTANTS DRAWINGS AND SPECIFICATIONS FOR ALL SPECIALIST INFORMATION AND DETAILS.
REFER TO SURVEY DRAWING FOR ALL EXISTING GROUND LEVELS.

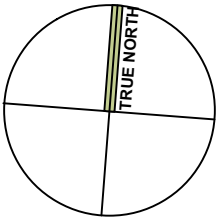

amendments:		
DATE	REV	DESCRIPTION
12/12/2019	A	DA ISSUE

PROJECT	DATE	REVISION NUMBER
41 & 43 BEACH ROAD COLLAROY LO1 1 DP300846 AND LOT 2 SEC 7 DP7391	12/12/2019	A
DRAWING TITLE	SCALE:	DRAWING NO.
DEMOLITION AND WASTE MANAGEMENT PLAN	1:100 at A1 & 1:200 at A3	DAE 130

VIRGINIA KERRIDGE ARCHITECT

g 03 / 59 great buckingham street redfern nsw 2016
ph 02 9699 3487 ph 02 9699 8527 fax 02 9699 4626
info@vk.com.au www.vk.com.au abn 12 083 17 159