

- LEGEND**
- ROOF:**
- MR COLOURBOND METAL ROOF SHEETING/CAPPINGS
 - G SELECT COLOURBOND GUTTERS
 - DP SELECT COLOURBOND DOWNPIPES
 - SK SKYLIGHT
- EXTERNAL:**
- BW MASONRY (CONC. BLOCK/BRICK)
 - RM RENDERED MASONRY
 - DW DOORS + WINDOWS - PAINTED TIMBER
- INTERNAL:**
- PB PLASTERBOARD ON TIMBER STUD FRAME
- FLOORS:**
- TF TIMBER FLOOR
 - TD TIMBER DECKING
 - T/SF TILED/STONE FLOOR
 - PC POLISHED CONCRETE
- CEILING S:**
- PB SET PLASTERBOARD

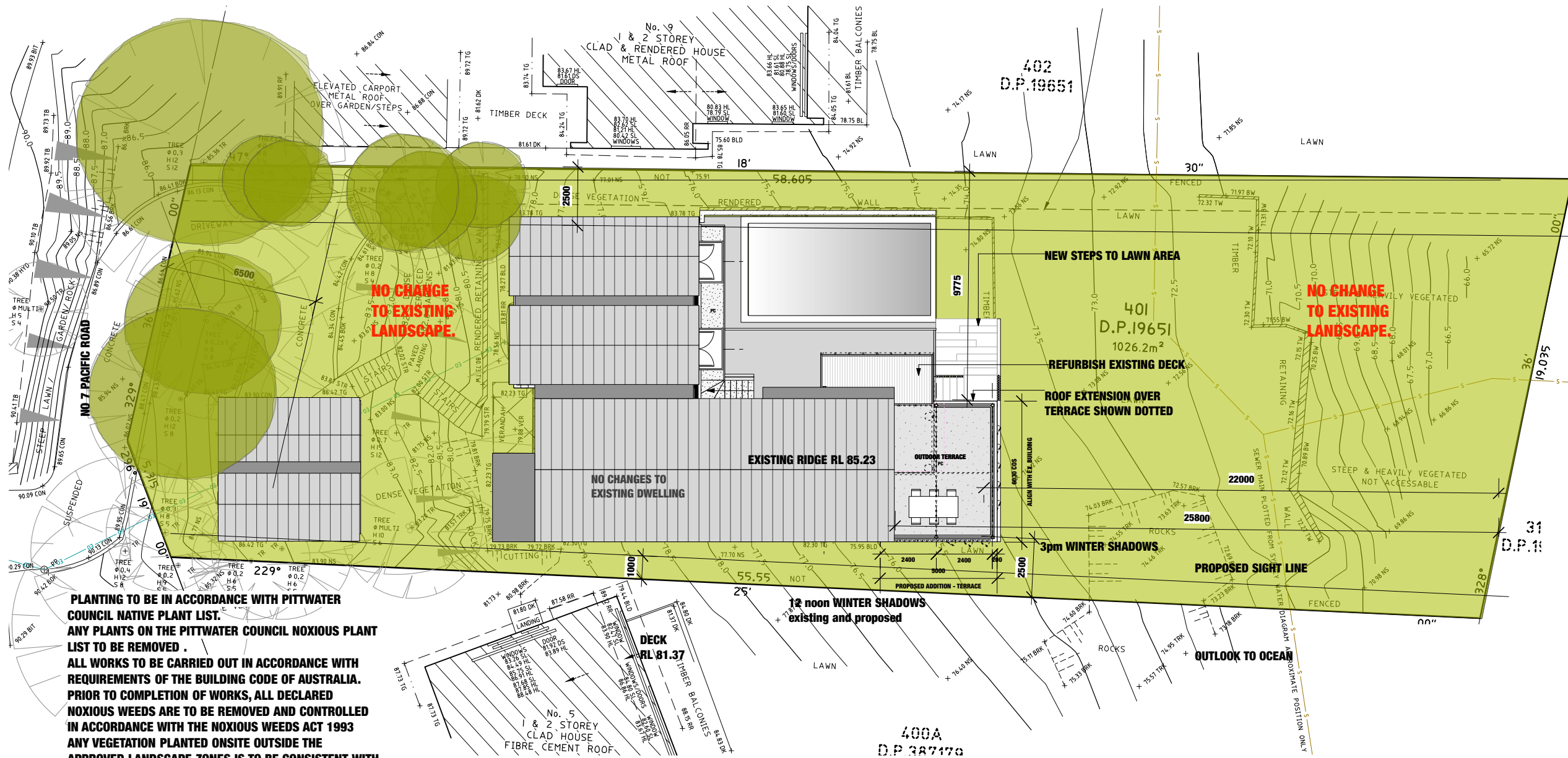

- NEW TIMBER STUD WALLS/STRUCTURE
- NEW WORKS
- METAL
- EXISTING WALLS/WINDOWS TO BE REMOVED - SHOWN AS DOTTED

| ISSUE | DESCRIPTION | DATE |
|-------|-------------------------|---------------|
| A | DEVELOPMENT APPLICATION | NOVEMBER 2016 |

DRAWING:

DWG. NO: DA

DATE: NOVEMBER 2016

SCALE:

PROJECT:

BEARD FAMILY
7 PACIFIC ROAD PALM BEACH
LOT 401 D.P. 19651

PLANTING TO BE IN ACCORDANCE WITH PITTSWATER COUNCIL NATIVE PLANT LIST. ANY PLANTS ON THE PITTSWATER COUNCIL NOXIOUS PLANT LIST TO BE REMOVED. ALL WORKS TO BE CARRIED OUT IN ACCORDANCE WITH REQUIREMENTS OF THE BUILDING CODE OF AUSTRALIA. PRIOR TO COMPLETION OF WORKS, ALL DECLARED NOXIOUS WEEDS ARE TO BE REMOVED AND CONTROLLED IN ACCORDANCE WITH THE NOXIOUS WEEDS ACT 1993 ANY VEGETATION PLANTED ONSITE OUTSIDE THE APPROVED LANDSCAPE ZONES IS TO BE CONSISTENT WITH PITTSWATER COUNCIL NATIVE PLANT LIST ALL EXISTING TREES AS APPROVED TO BE RETAINED MAY ONLY BE REMOVED WITH COUNCILS CONSENT



INDICATIVE PLANT SELECTION