

NOTE:

DETAIL AND BOUNDARY SURVEY HAVE BEEN CARRIED ON 11/01/2024.

PRIOR TO ANY DESIGN OR CONSTRUCTION WORK, WHICH RELIES ON CRITICAL SETBACKS FROM THE STREET OR BOUNDARIES, SURVEY MARKS SHOULD BE PLACED TO DEFINE THE PROPERTY BOUNDARIES.

NO INVESTIGATION OF UNDERGROUND SERVICES HAVE BEEN CONDUCTED. SERVICES SHOWN HAVE BEEN PLOTTED FROM DIA, BEFORE YOU DIG (BYD) AND ARE INDICATIVE ONLY. OTHER SERVICES MAY EXIST WHICH ARE NOT SHOWN. CONFIRMATION OF THE EXACT POSITION SHOULD BE MADE PRIOR TO ANY EXCAVATION WORK.

ORIGIN OF LEVELS ON A.H.D. IS TAKEN FROM SSM 9177 WITH RL 130.03 (AHD).

RIDGE AND GUTTER HEIGHTS HAVE BEEN OBTAINED BY INDIRECT METHOD AND ARE ACCURATE TO $\pm 0.05\text{m}$.

CONTOURS ARE INDICATIVE ONLY; EXCEPT AT SPOT LEVELS SHOWN THEY DO NOT REPRESENT THE EXACT LEVEL AT ANY PARTICULAR POINT. ONLY SPOT LEVELS SHOULD BE USED FOR ACCURATE CALCULATION.

FOR ANY POSITIVE COVENANTS AND RESTRICTIONS, NO FURTHER INVESTIGATIONS CARRIED OUT INTO CONTENT OF THE DEALING.

[A] EASEMENT TO DRAIN WATER 1.83m WIDE (DP226810)
K376439 COVENANT

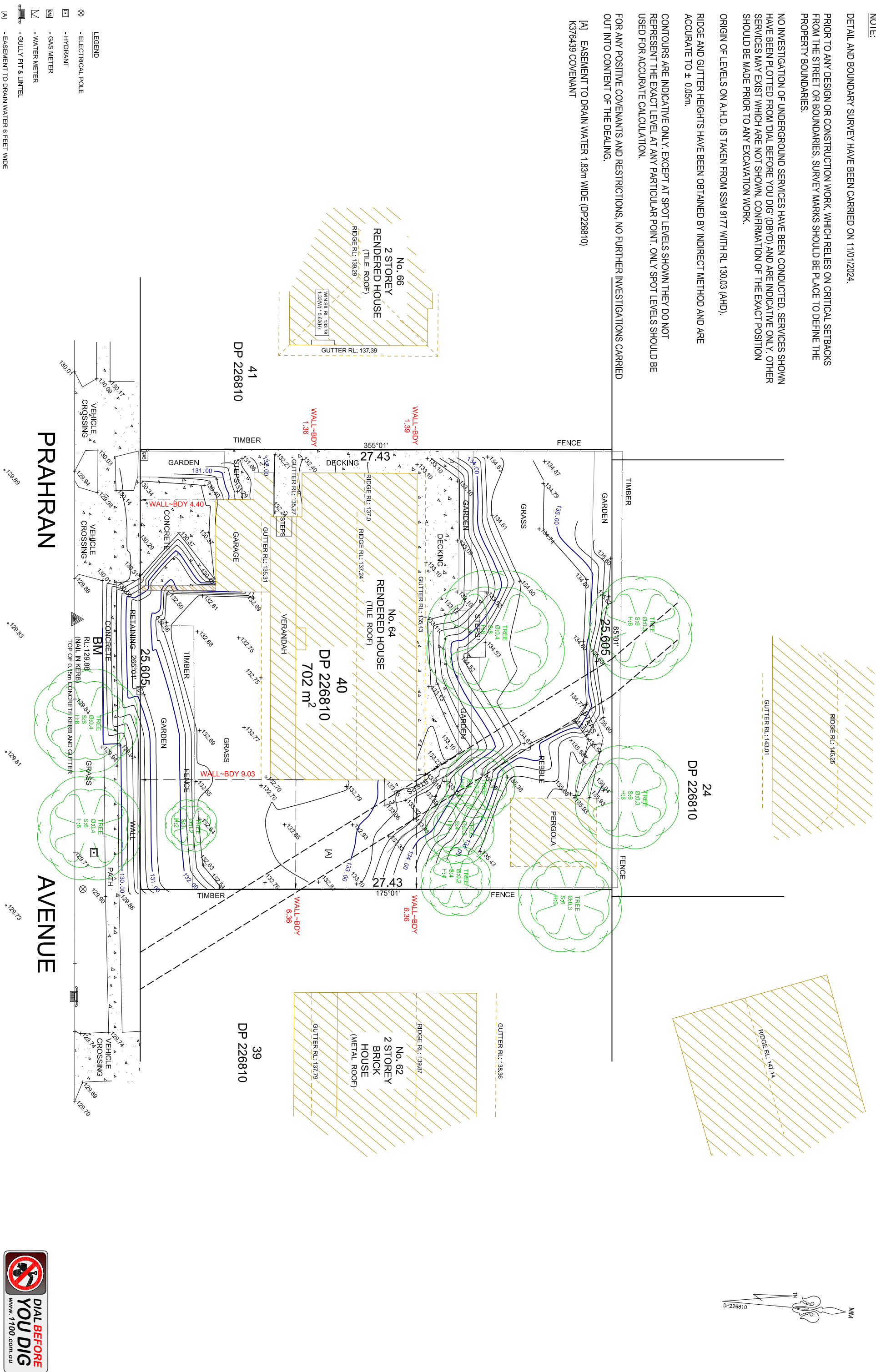

ABN: 23 671 421 408
ISA SURVEYORS PTY LTD
Email: info@isasurveyors.com.au
Mobile Number: 0426 66 88 00

NOTE: INFORMATION CONTAINED IN THIS PLAN IS THE COPYRIGHT OF ISA SURVEYORS PTY LTD. THE USE OR DUPLICATION WITHOUT THE WRITTEN CONSENT OF ISA SURVEYORS PTY LTD CONSTITUTES AN INFRINGEMENT OF COPYRIGHT.

AMENDMENT:	PLAN SHOWING DETAIL & LEVELS OVER LOT 40 IN DP 226810			
	JOB No.: 9000118	LGA: NORTHERN BEACHES		
	PLAN No.: 9000118.3	DATE: AMD		
	CLIENT: LAURA WOODFORD	DATE: 15/01/2024	SCALE: 1:200@A3	
	PROJECT: DETAIL SURVEY / FRENCHS FOREST	DRAWN: LW / PS	CONT. INTERVAL: 0.2m	
ADDRESS: PRAHRAN AVENUE, FRENCHS FOREST	CHK: LW	SHEET 1 OF 1		