

MM

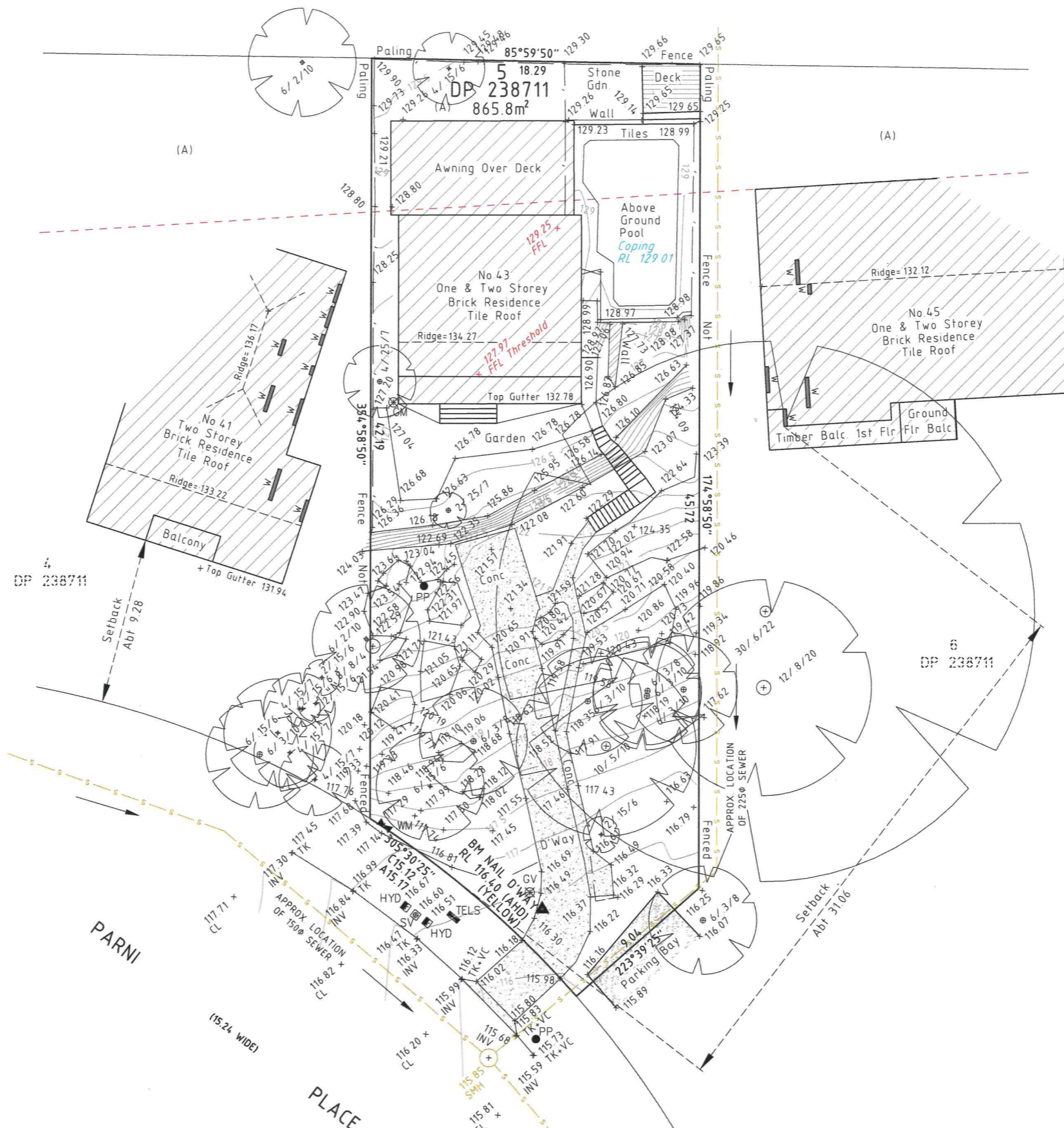

(A) - EASEMENT FOR TRANSMISSION LINE VARIABLE WIDTH (Z944756)

Brian Dewing
Brian Dewing No 918
Registered Surveyor

NOTES :-

- THIS PLAN IS FOR DA/DESIGN PURPOSES ONLY. THE BOUNDARIES HAVE BEEN SURVEYED AND ARE SHOWN ACCORDINGLY.
- RELATIONSHIP OF IMPROVEMENTS TO BOUNDARIES IS DIAGRAMMATIC ONLY. WHERE OFFSETS ARE CRITICAL THEY SHOULD BE CONFIRMED BY FURTHER SURVEY.
- CONTOURS SHOWN DEPICT THE TOPOGRAPHY. EXCEPT AT SPOT LEVELS SHOWN, THEY DO NOT NECESSARILY REPRESENT THE EXACT LEVEL AT ANY PARTICULAR POINT.
- SERVICES SHOWN HEREON HAVE BEEN DETERMINED FROM VISUAL EVIDENCE ONLY. PRIOR TO ANY DESIGN, DEMOLITION, EXCAVATION OR CONSTRUCTION ON THE SITE RELEVANT AUTHORITY SHOULD BE CONTACTED TO ESTABLISH DETAILED LOCATION AND DEPTH.
- THESE NOTES FORM AN INTEGRAL PART OF THIS PLAN & SHOULD NOT BE SEPARATED.
- LOCATION OF SEWER SUBJECT TO CONFIRMATION FROM SYDNEY WATER OR RELEVANT AUTHORITY.
- AUSTRALIAN HEIGHT DATUM (AHD) WAS ESTABLISHED FROM SSM38478 (RL=128.28)
- 8/4/7 DENOTES TREE SPREAD OF 8m, TRUNK DIAMETER OF 0.4m & APPROX HEIGHT OF 7m
- THIS SURVEY WAS DONE IN ACCORDANCE WITH CLAUSE 9 OF THE SURVEYING AND SPATIAL INFORMATION REGULATION 2017.

LEGEND

BENCH MARK	▲
TELSTRA PIT	■ TELS
WATER METER	▶ WM
POWER POLE	● PP
KERB OUTLET	○ KO
SEWER INSPECTION POINT	○ SIP
GRATED INLET PIT	■ GIP
HYDRANT	■ HYD
STOP VALVE	⊠ SV
GAS METER	⊠ GM
GAS VALVE	⊠ GV
SEWER MANHOLE	○ SMH

CLIENT REF: PRN

BURTON & FIELD
surveying & land development

All Correspondence to
Suite 202, 2 Pembroke Street Epping 2121
P.O. Box 1150, Epping 1710
Tel: (02) 9868-4660
Email: epping.reception@burtonandfield.com.au

343 Hume Highway, Liverpool 2170
P.O. Box 242 Liverpool BC 1871
Tel: (02) 9602-1199
Email: survey@burtonandfield.com.au
Web: www.burtonandfield.com.au

CAUTION:
INFORMATION CONTAINED IN THIS PLAN IS THE COPYRIGHT OF BURTON AND FIELD PTY LIMITED THE USE, DUPLICATION (WHETHER IN PART OR FULL) WITHOUT WRITTEN CONSENT OF BURTON AND FIELD PTY LIMITED CONSTITUTES AN INFRINGEMENT OF COPYRIGHT.

CLIENT: BUNGALOW HOMES	PROJECT: PLAN SHOWING DETAIL AND LEVELS OVER LOT 5 IN DP238711 No.43 PARNI PLACE, FRENCHS FOREST, 2086	
LGA: NORTHERN BEACHES	DATUM: AHD	SCALE: 1:200
COMP REF: J\86064_C_REV B		

REVISION	DRAWN: CL CHECKED: SD
B TREES REMOVED 30/05/24	
A CARPORT LEVELS ADDED 11/10/23	
DATE: 07/09/23	SIZE: A2
REF: E7145-86064	SHEET 1 OF 1