

WARILI
ROAD

LEGEND

BENCH MARK	▲
TELSTRA PIT	TEL
ELECTRIC LIGHT POLE	ELP
ELECTRICITY BOX	ELBOX
POWER POLE	PP
PIT WITH CONCRETE LID	CLID
FLAGPOLE	FP
GRADED INLET PIT	GIP
KERB INLET PIT	KIP
SEWER INSPECTION POINT	SIP
GREASE TRAP	GT
SEWER MANHOLE	SMH
IRRIGATION CONTROL BOX	ICBOX
HYDRANT	HYD
WATER METER	WM
GAS METER	GM
70mm SQUARE FENCE POST	FP
VEHICLE CROSSING	(VC)
RAILWAY CROSSING	(PC)
GAS (DBYD)	G
COMMUNICATION (DBYD)	C
WATER (DBYD)	W
STORMWATER (DBYD)	SW
SEWER (DBYD)	S
ELECTRICITY (OVERHEAD)	P
ELECTRICITY (UGROUND) (DBYD)	E

NOTES

1. THE BOUNDARIES HAVE NOT BEEN MARKED
2. THE BOUNDARY SURVEY (DIMENSIONS AND AREA) HAVE BEEN SURVEYED IN ACCORDANCE WITH SURVEYING AND SPATIAL INFORMATION REGULATION 2017 CLAUSE 10 "IDENTIFICATION SURVEYS" AND ARE SUBJECT TO FINAL SURVEY
3. ORIGIN OF LEVELS ON A.H.D. IS TAKEN FROM PM 3392 R.L. 164.23 (A.H.D.) IN BLACKBUTTS ROAD
4. CONTOUR INTERVAL 0.5 m
5. CONTOURS ARE INDICATIVE ONLY. ONLY SPOT LEVELS SHOULD BE USED FOR CALCULATIONS OF QUANTITIES WITH CAUTION
6. KERB LEVELS ARE TO THE TOP OF KERB UNLESS SHOWN OTHERWISE
7. FLOOR LEVELS SHOWN ARE THRESHOLD LEVELS. NO INVESTIGATION OF INTERNAL FLOOR LEVELS HAS BEEN UNDERTAKEN
8. NO INVESTIGATION OF UNDERGROUND SERVICES HAS BEEN MADE. SERVICES HAVE BEEN PLOTTED FROM RELEVANT AUTHORITIES INFORMATION AND HAVE NOT BEEN SURVEYED. ALL RELEVANT AUTHORITIES SHOULD BE NOTIFIED PRIOR TO ANY EXCAVATION ON OR NEAR THE SITE
9. 8/4/7 DENOTES TREE SPREAD OF 8m, TRUNK DIAMETER OF 0.4m & APPROX HEIGHT OF 7m
10. SHOWS APPROXIMATE POSITION OF ROAD LINEMARKING AND IS INDICATIVE ONLY
11. BEARINGS SHOWN ARE MGA (MAP GRID OF AUSTRALIA) ADD APPROX. 1°00' FOR TRUE NORTH

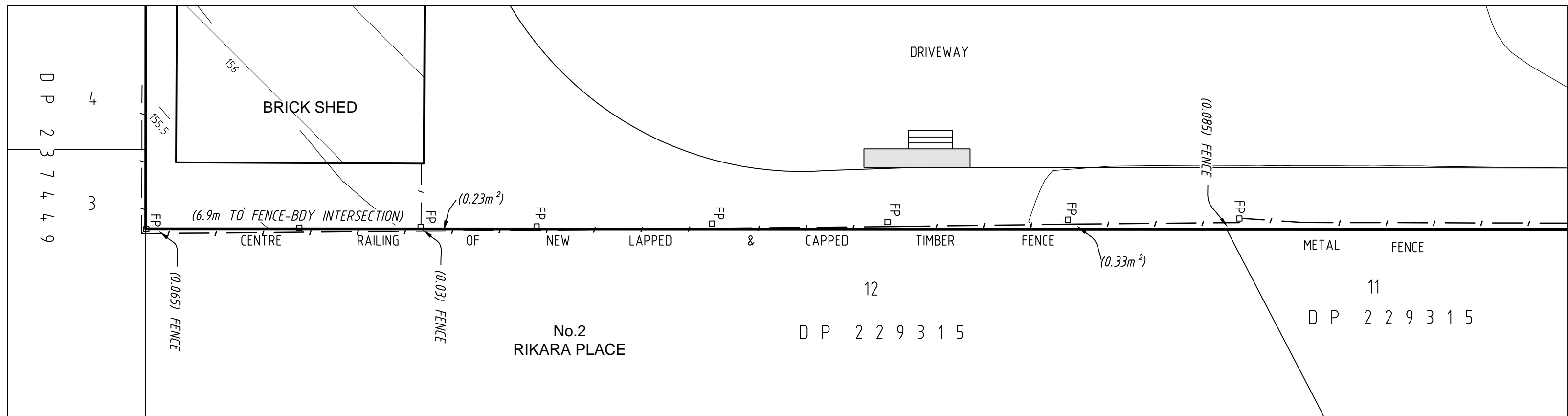

DIAGRAM
SCALE 1:50



REFER TO NOTES AND LEGEND
SCALE 1:200 @ A1

H	00/00/00	—	00	D	00/00/00	—	00
G	00/00/00	—	00	C	00/00/00	—	00
F	00/00/00	—	00	B	00/00/00	—	00
E	00/00/00	—	00	A	00/00/00	—	00
Revision	Date	Description	Reference	Revision	Date	Description	Reference



THIS IS THE PLAN REFERRED TO IN MY LETTER DATED 23-04-24
Damian Maguire SU001564
Registered Surveyor NSW

Client SEKISUI HOUSE
Drawing title
PLAN OF DETAIL AND LEVELS OVER LOT 1 DP 1298188 AND LOT 1 DP 524083 KNOWN AS 49 BLACKBUTTS ROAD, BELROSE

datum AHD
site Area 1.018ha
LGA NORTHERN BEACHES
reference number 51298 003DT
scale 1:200 @ A1
date of survey 23-04-2024
SHEET 1 OF 2

- (E) PROPOSED EASEMENT FOR ELECTRICITY AND OTHER PURPOSES 2 & 3.745 WIDE (VIDE DP 1177580)
(R) PROPOSED RIGHT OF WAY 3.83 AND VARIABLE WIDTH (VIDE DP 1177580)

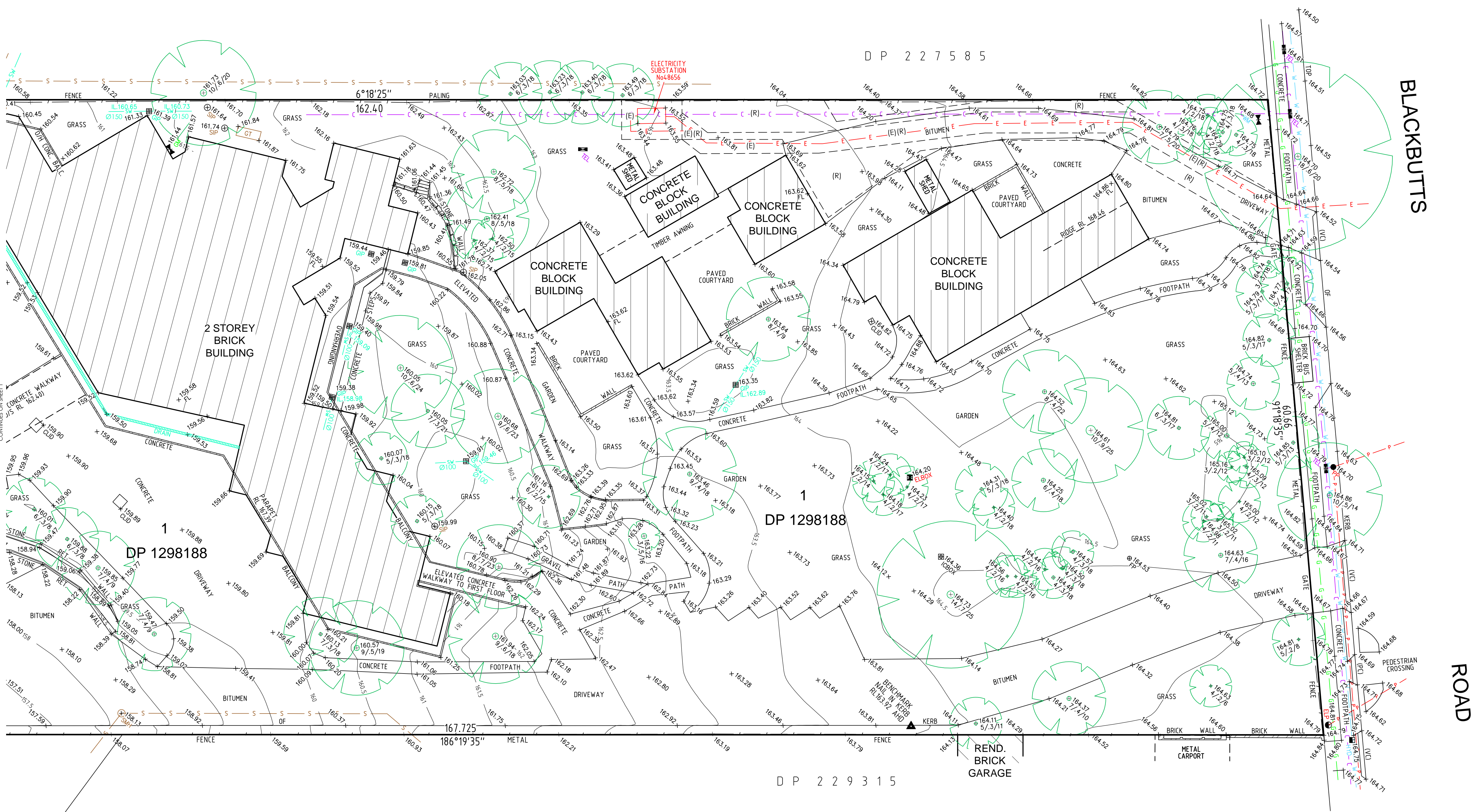
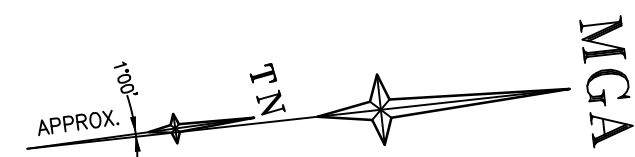

BLACKBUTTS

ROAD



REFER TO NOTES AND LEGEND

SCALE 1:200 @ A1



H	00/00/00	—	00	D	00/00/00	—	00
G	00/00/00	—	00	C	00/00/00	—	00
F	00/00/00	—	00	B	00/00/00	—	00
E	00/00/00	—	00	A	00/00/00	—	00
Revision	Date	Description	Reference	Revision	Date	Description	Reference



CONFIDENCE TOGETHER

www.lts.com.au | P 1300 587 000

THIS IS THE PLAN REFERRED TO IN MY LETTER DATED: 23-04-24

Damian Maguire S0001564 Registered Surveyor NSW

Client: SEKISUI HOUSE

Drawing title: PLAN OF DETAIL AND LEVELS OVER LOT 1 DP 1298188 AND LOT 1 DP 524083 KNOWN AS 49 BLACKBUTTS ROAD, BELROSE

datum AHD

site Area 1.018ha

LGA NORTHERN BEACHES

reference number 51298 003DT

scale 1:200 @ A1

date of survey 23-04-2024

SHEET 2

(E) PROPOSED EASEMENT FOR ELECTRICITY AND OTHER PURPOSES 2 & 3.745 WIDE (VIDE DP 1177580)

(R) PROPOSED RIGHT OF WAY 3.83 AND VARIABLE WIDTH (VIDE DP 1177580)