

01 Location Map  
- N.T.S

STATUS:  
**DA ISSUE**

MORRIS<sup>CO</sup>  
*design*

Studio 118/40 Yeo Street, Neutral Bay,  
NSW 2089 Australia  
P. 02 9380 2380 E. info@morrisco design.com.au  
MORRISCODESIGN.COM.AU

NOTES:

**DO NOT SCALE THIS DRAWING** All dimensions to be verified on site prior to construction. Any inconsistencies to be reported to morris co design immediately. If any doubt please ask morris co design for clarification. Any variations to these drawings requires approval from morris co design. This drawing has been produced to illustrate design intent. All shop drawings are to be submitted to and sanctioned by morris co design prior to manufacture or construction. Contractor to liaise with third party suppliers to confirm exact requirements

CLIENT DETAILS:

NAME  
GUZMAN Y GOMEZ  
PROJECT  
FORESTWAY, NSW  
JOB NO.  
GYG11

ISSUE DETAILS:

A 23.06.20 DA ISSUE

DRAWING DETAILS: LOCATION MAP

DRAWN BY	SCALE	START DATE
AM	NTS @ A3	22.06.20
CHECKED BY	DATE	DRAWING NO.
AM	23.06.20	

**A-100**

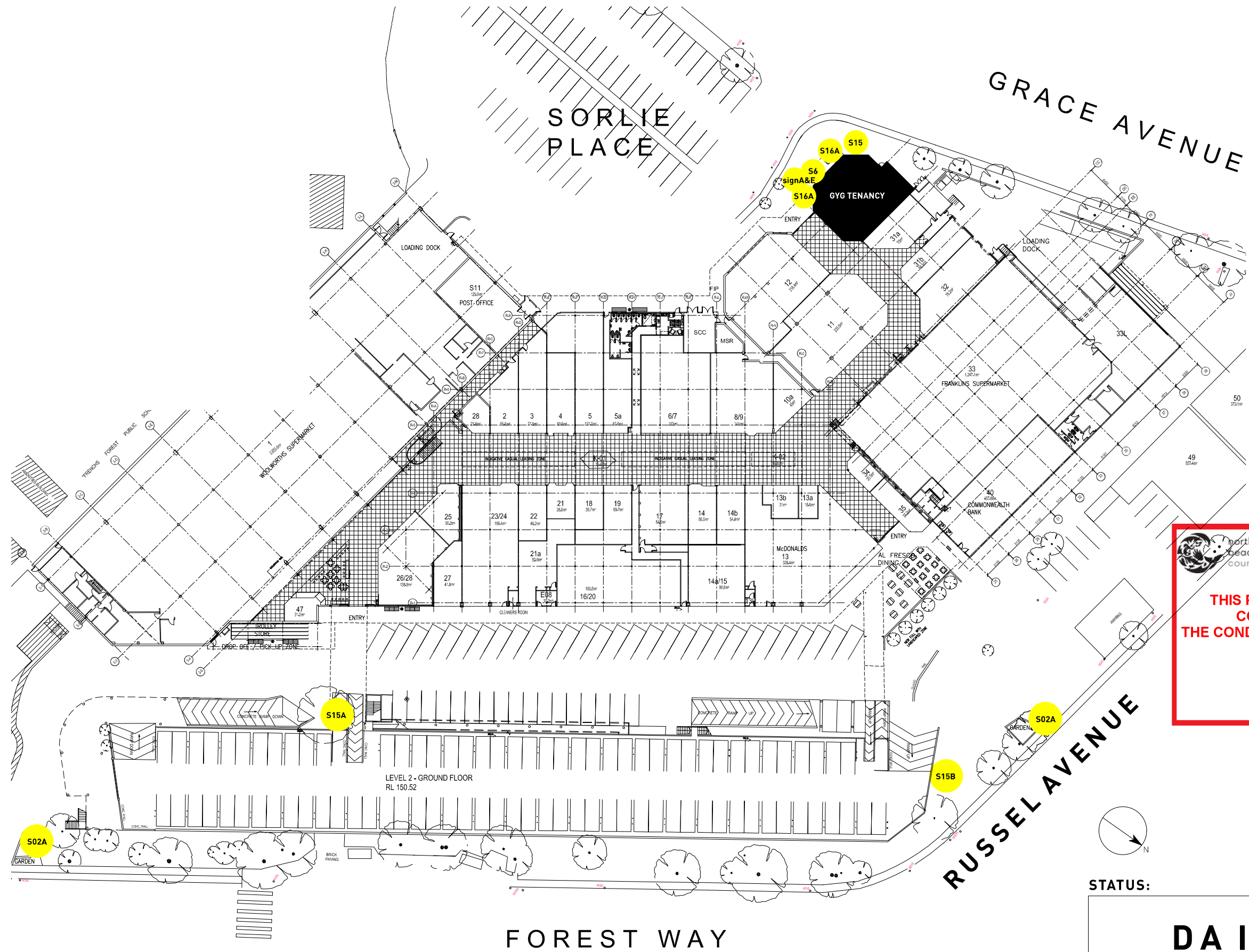

 **northern  
beaches  
council**

**THIS PLAN IS TO BE READ IN  
CONJUNCTION WITH  
THE CONDITIONS OF DEVELOPMENT  
CONSENT**

**DA2020/1586**

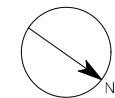

STATUS:

**DA ISSUE**

**MORRIS<sup>co</sup>**  
*design*

Studio 118/40 Yeo Street, Neutral Bay,  
NSW 2089 Australia  
P. 02 9380 2380 E. info@morriscodeign.com.au  
MORRISCODEIGN.COM.AU

**NOTES:**

**DO NOT SCALE THIS DRAWING** All dimensions to be verified on site prior to construction. Any inconsistencies to be reported to morris co design immediately. If any doubt please ask morris co design for clarification. Any variations to these drawings requires approval from morris co design. This drawing has been produced to illustrate design intent. All shop drawings are to be submitted to and sanctioned by morris co design prior to manufacture or construction. Contractor to liaise with third party suppliers to confirm exact requirements

**CLIENT DETAILS:**

**NAME**  
GUZMAN Y GOMEZ

**PROJECT**  
FORESTWAY, NSW

**JOB NO.**  
GYG11

**ISSUE DETAILS:**

A	23.06.20	DA ISSUE
B	23.06.20	REVISIONS MADE
C	24.06.20	REVISIONS MADE

**DRAWING DETAILS:** SITE PLAN & SIGNAGE LOCATION

<b>DRAWN BY</b> AM	<b>SCALE</b> NTS @ A3	<b>START DATE</b> 22.06.20
<b>CHECKED BY</b> AM	<b>DATE</b> 24.06.20	<b>DRAWING NO.</b>

**A-101**



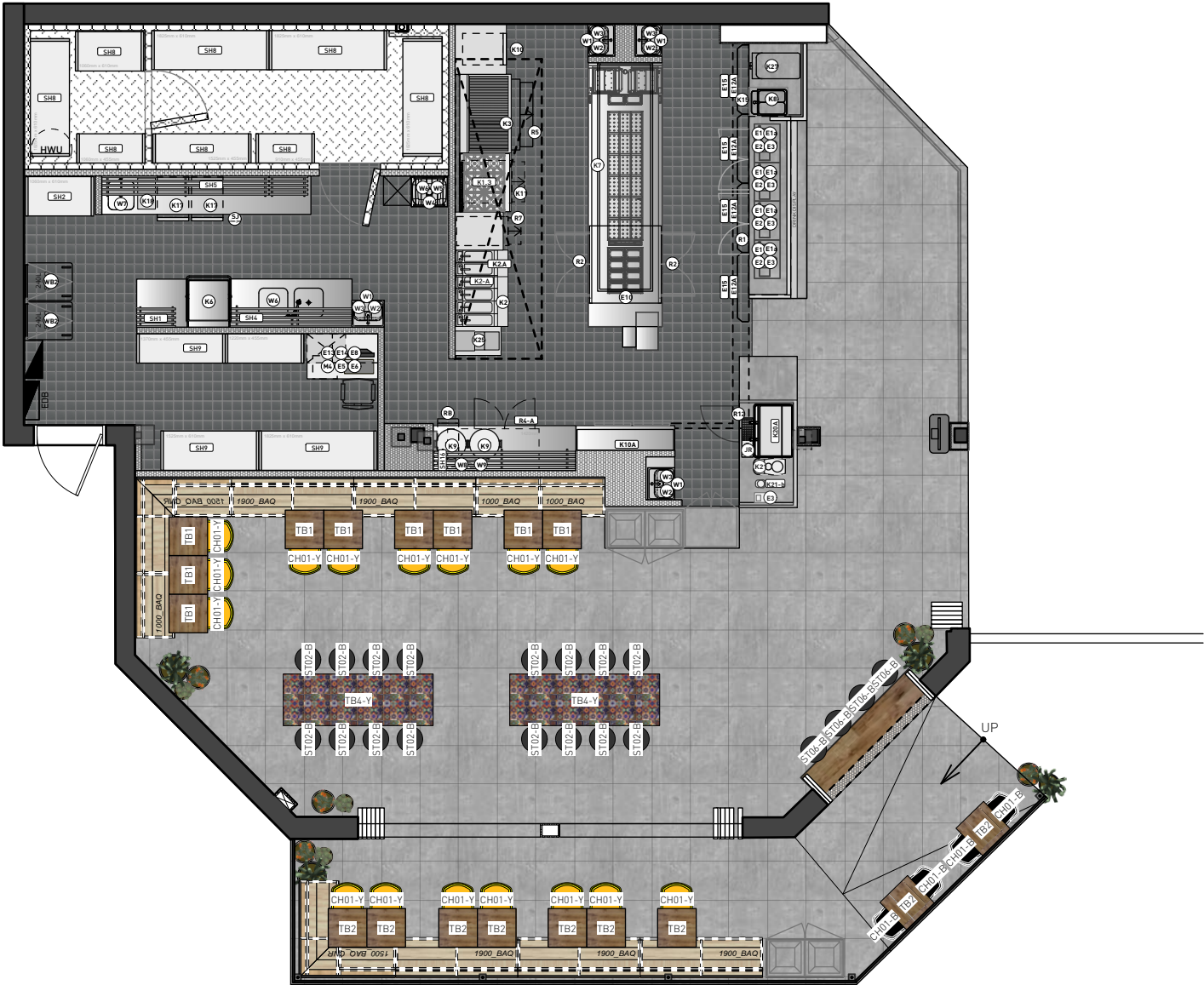

 **northern  
beaches  
council**

**THIS PLAN IS TO BE READ IN  
CONJUNCTION WITH  
THE CONDITIONS OF DEVELOPMENT  
CONSENT**

**DA2020/1586**

STATUS:

**FOR TENDER**

**MORRIS<sup>CO</sup>**  
*design*

Studio 118/40 Yeo Street, Neutral Bay,  
NSW 2089 Australia  
P. 02 9380 2380 E. info@morriscodeign.com.au  
MORRISCODEIGN.COM.AU

**NOTES:**

**DO NOT SCALE THIS DRAWING** All dimensions to be verified on site prior to construction. Any inconsistencies to be reported to morris co design immediately. If any doubt please ask morris co design for clarification. Any variations to these drawings requires approval from morris co design. This drawing has been produced to illustrate design intent. All shop drawings are to be submitted to and sanctioned by morris co design prior to manufacture or construction. Contractor to liaise with third party suppliers to confirm exact requirements

**CLIENT DETAILS:**

**NAME**  
GUZMAN Y GOMEZ

**PROJECT**  
TENANCY 29 & 30 GROUND LEVEL  
FORESTWAY SHOPPING CENTRE, NSW  
**JOB NO.**  
GYG11

**ISSUE DETAILS:**

E	31.07.20	REVISED AS REQUESTED
F	05.08.20	SERVICE DRAWINGS ISSUE
G	06.08.20	REVISED AS REQUESTED
H	10.08.20	REVISED AS REQUESTED
I	11.08.20	REVISED AS PER NEW COLUMN LOCATIONS
J	12.08.20	DELIVERY & COFFEE UPDATED AS REQ.
K	19.08.20	TENDER ISSUE
L	31.08.20	TENDER ISSUE, REVISED AS REQ.
M	22.09.20	SEAT CODES UPDATED
N	11.11.20	ANNOTATIONS TAKEN OUT

**DRAWING DETAILS:** PROPOSED LAYOUT PLAN

<b>DRAWN BY</b> LP	<b>SCALE</b> 1:100 @ A3	<b>START DATE</b> 21.08.20
<b>CHECKED BY</b> AM	<b>DATE</b> 11.11.20	<b>DRAWING NO.</b>

**A-103**