

INTERESTS RELATING TO THE SUBJECT SITE:
The Certificate of Title for Lot 15 DP222082 ordered on 3.07.2019 identified the following interests (refer to the original 888 Instrument or Dealing creating the interest for specific terms - we recommend this be undertaken prior to design or construction):

- Reservations and conditions in the Crown Grant(s) (not investigated).
- Covenant (J798336) (not investigated).
- Covenant (J423699) (not investigated).
- J423681, J423682, J423683 Rights of carriageway & easements for services affecting the row 30 ft & 36 ft wide & var width within lots 50,51,52 & 53 respect in DP212967 appurtenant to the land above described (J423680) (not shown, remote to site).
- J423685 & J423686 Rights of carriageway & easements for services affecting the row 30 ft & 36 ft wide & var width within lots 54,55 & 56 respect in DP212967 appurtenant to the land above described (J423684) (not shown, remote to site).
- Covenant (J893560) (not investigated).
- Mortgage to Australia and New Zealand Banking Group Limited (AM334571)(not investigated).

NOTES

- Do not scale from this plan.
- The purpose of this Detail Survey plan is to show detail and levels for planning and design. Do not use the information shown for any other purpose.
- Contours are an indication of the topography and should only be used for planning purposes. Spot levels only should be used for detailed design.
- Boundary locations, dimensions and areas shown are approximate only due to the age and nature of the Deposited Plan defining the boundaries of the site and if critical should be confirmed by a Boundary Survey. We strongly recommend this be undertaken prior to the construction of any significant structure on or adjacent to a boundary.
- The relationship of built form and natural features to boundaries is diagrammatic and if critical should be confirmed by a Boundary Survey. Boundary setbacks (if shown) are approximate only.
- Building and feature descriptions are to be used for general identification purposes only and may require further investigation.
- No services search has been undertaken. Only those services visible at the time of survey have been located. It is recommended to contact Dial Before You Dig and the relevant service authority prior to commencement of any work.
- Only those windows visible and unobscured from within the subject property on the date of survey have been located.
- Tree information and canopy location is approximate (and not necessarily symmetrical) and if critical may require further assessment.
- The DWG format file for this plan is integral and contains additional spatial information not able to be displayed in the PDF file.
- This drawing and the information it contains is copyright and remains the property of SurveyPlus Pty Ltd. It must not be copied, used or altered without the express authority of SurveyPlus.
- These notes and interests noted in the Certificate of Title form an integral part of this plan and must not be erased.

CLIENT
**Gordon Combe -
Woodline Constructions**

REVISION / DATE	REVISION DETAILS	SURVEY BY	DRAWN BY	CHECKED BY
B 30.08.2019	REG'D SURVEYOR SIGNATURE ADDED			JM
A 09.07.2019	AS SURVEYED ON SITE	PK	CE	GC



We make it easy.
We make it happen.
02 9651 2921
info@surveyplus.com.au
www.surveyplus.com.au

DATE OF SURVEY	05.07.2019
ORIGIN OF LEVELS	SSM 35304 RL 139.305 (AHD)
ORIGIN OF COORDS	LOCAL
CONTOUR INTERVAL	0.5m

JEREMY J MACCUE
A SURVEYOR REGISTERED UNDER THE SURVEYING AND
SPATIAL INFORMATION ACT 2002

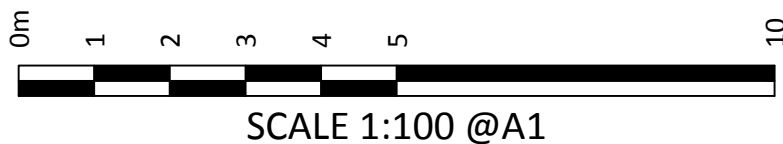

**PLAN SHOWING DETAIL AND LEVELS OVER
LOT 15 DP 222082
No. 30 TERAMA STREET, BILGOLA PLATEAU**

SCALE	1:100 @ A1
REVISION	B
SHEET	1 OF 1
REF	18047_DET_1B

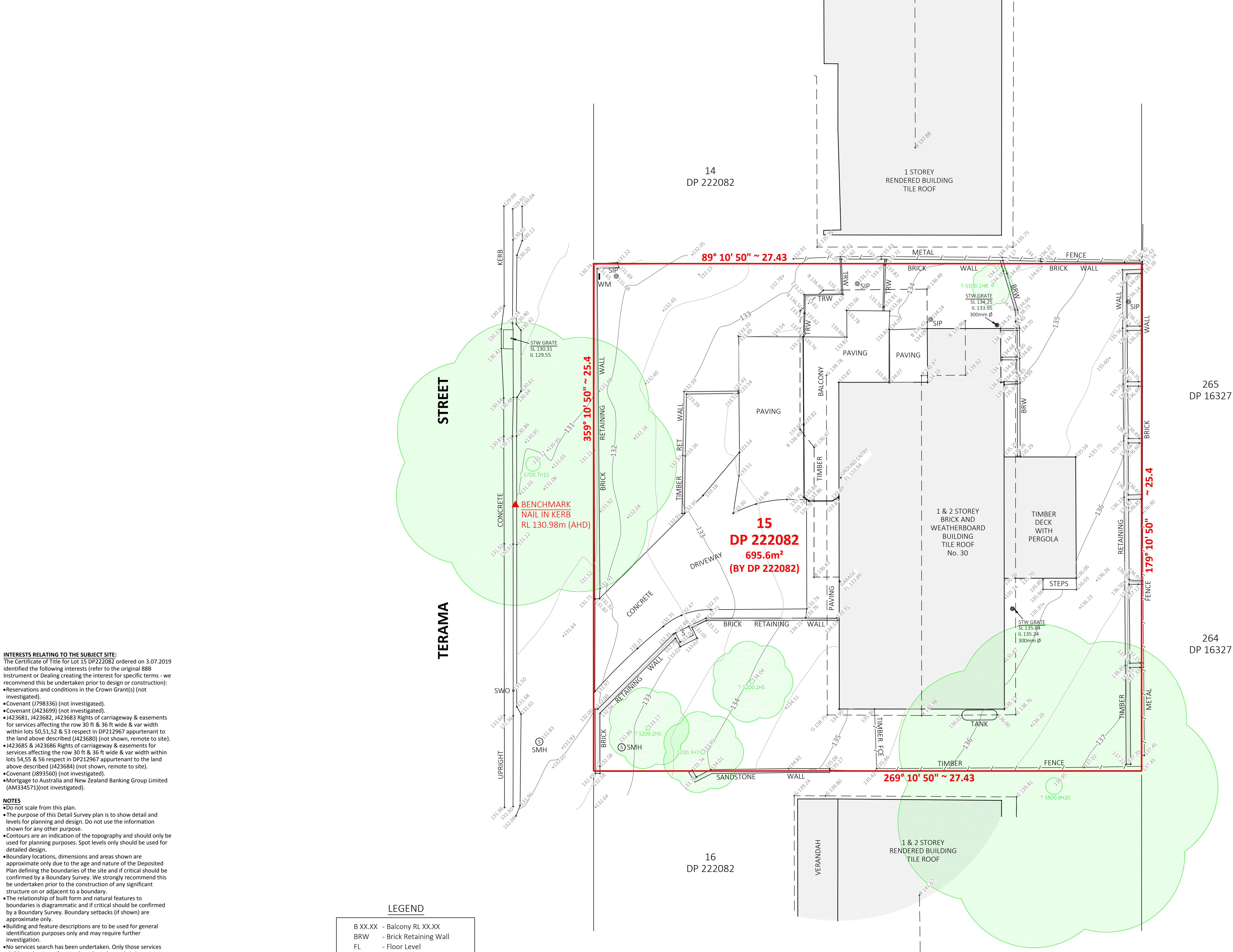

LEGEND

B XX.XX - Balcony RL XX.XX
BRW - Brick Retaining Wall
FL - Floor Level
G XX.XX - Gutter RL XX.XX
IL XX.XX - Invert Level RL XX.XX
R XX.XX - Ridge/Roof RL XX.XX
S - Steps
SL XX.XX - Surface Level RL XX.XX
SIP - Sewer Inspection Point
SMH - Sewer Manhole
STW - Stormwater
SWO - Stormwater Outlet
TRW - Timber Retaining Wall
WM - Water Meter

TREE DIAGRAM

