

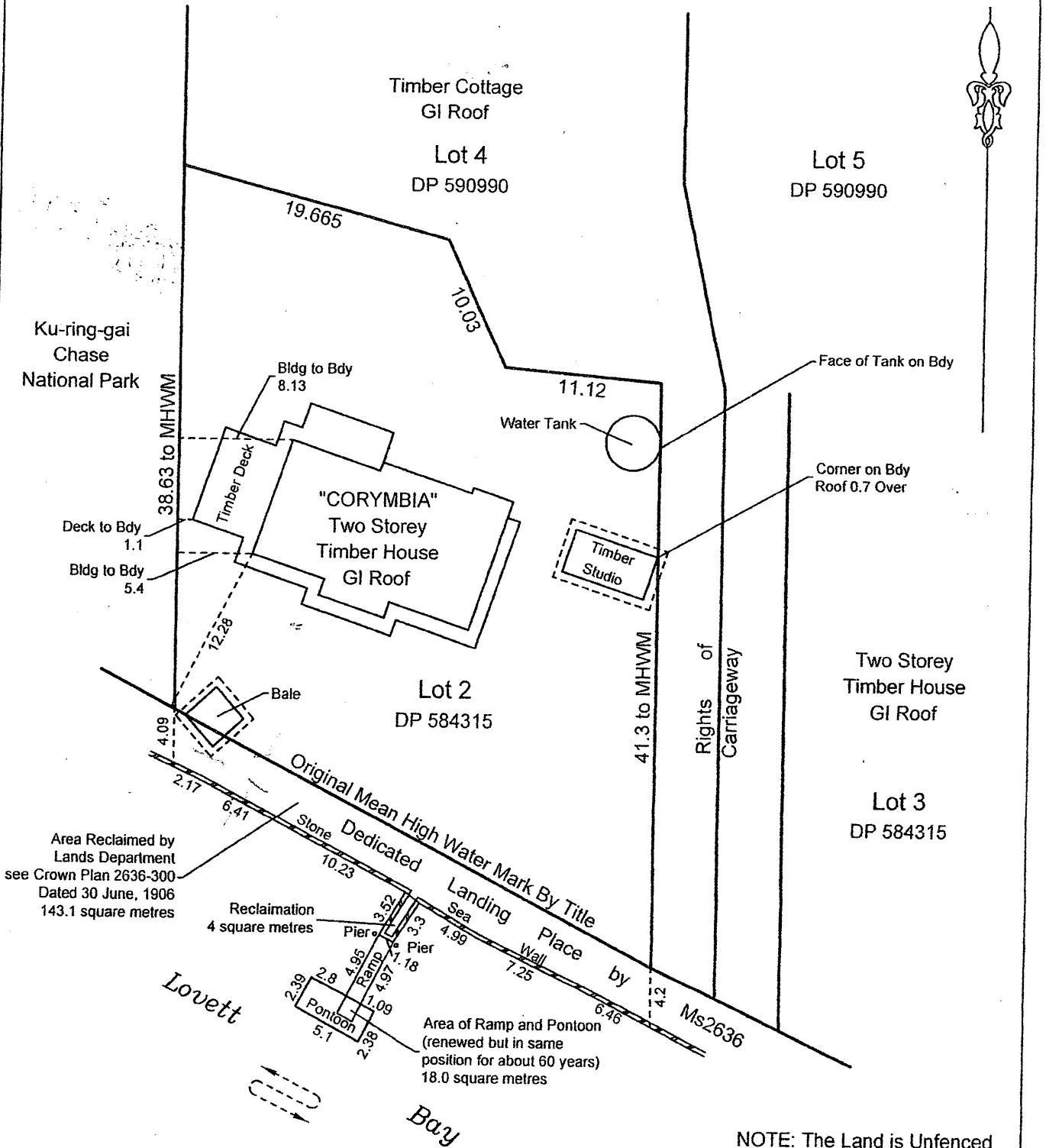

**SKETCH PLAN of Lot 2 in DP 584315 & Adjoining
 LOVETT BAY**

LGA : Northern Beaches Parish of Broken Bay County of Cumberland



NOTE: The Land is Unfenced

S. Loomes

DAVID A. LOOMES
 SURVEYOR, REGISTERED UNDER THE
 SURVEYING AND SPATIAL INFORMATION ACT 2002

NOTE
 THIS SKETCH IS TO BE USED FOR
 IDENTIFICATION PURPOSES ONLY AND
 IN CONJUNCTION WITH THE WRITTEN REPORT.