

LANDSCAPE SPECIFICATION

1. SITE PREPARATION
- Any minor levelling, either cutting or filling, shall be undertaken by the Landscape Contractor so that areas are left ready for final finishes. Adequate watering points shall be provided to enable the Landscape Contractor to maintain planted area throughout construction and the maintenance period. Weeds are to be sprayed with 'Roundup' or equal, to manufacturer's directions and must be dead before being disturbed.
2. WORKS BY OTHERS
- The following works shall be undertaken by others prior to the commencement of the landscape works:
- All trees to be removed
 - Tree protection fencing
 - Stripping & stockpiling site topsoil
 - Erosion control measures and siltation fences / devices

3. DRAINAGE WORKS
- In general the mass planted areas are to be built atop existing levels to improve drainage and to deflect water runoff around the site. If the contractor considers that certain other areas require drainage then the superintendent should be immediately notified for an inspection. Set out below are the requirements for any drainage works.

- 3.1 Materials:
- Agricultural drains to be 100mm flexible coil & filter sock.
Aggregate to be 10-20mm blue metal.
Connections to be 100mm black polyethylene stormwater pipe.
- 3.2 Installation:
- Install agricultural drains with a maximum 1:60 gradient and backfill trenches with a minimum 200mm layer of aggregate. Connect into the stormwater system for the buildings.

4. TIMBER EDGING

- 4.1 Materials
- Edging to be 100 x 38mm F7 rougher header H4 treated pine.
Tanalith® E treatment - chromium and arsenic free timber treatment that uses copper and an organic azole co-biocide as active ingredients.
Pegs to be 25 x 25 x 450mm long hardwood.
nails to be galvanised timberlock twist nails - 50mm x 3.75mm
- 4.2 Installation
- Install edging to finish flush with adjoining grass levels and secure with pegs spaced at maximum 1.2 metre intervals placed on the garden side of the edging. Pegs to be fixed to edging with 2 off nails. Top of pegs to be 25mm below top of edging. All exposed edges of timber to be bevelled to prevent future splinters.

5. PEBBLE MULCH

- 5.1 Materials:
- Pebbles for the access paths to be 10-20mm Nepean river pebbles.
- 5.2 Installation:
- Following earthworks rake all path areas and tamp lightly to give an even graded surface. Care shall be taken not to mix soil and pebble together. Pebbles to be laid to a depth of 100mm. Refer elsewhere for brick and timber garden edging.

6. MASS PLANTING

- 6.1 Materials:
- Soil mix to be suitable for improving depleted soils such as Botany Humus Mix from Australian Native Landscapes or equal. Samples to be shown to Principals and Representative for approval before installation. Also provide written breakdown of contents, pH and trace elements and suitability for improving existing soil. Soil mix to comply with AS 3743-2003: Potting mixes, AS 4419-2003: Soils for landscaping and garden use & AS 4454-2003: Composts, soil conditioners and mulches.
Water crystals to be Garden King Wettasoil Granular deep watering agent form Amgrow or equal product.
Trees and plants shall be true to name and variety. Substitutes in size or variety shall not be made without the approval of the Principals Representative. Also refer to Plant Schedule. All plants shall be true to size in well developed healthy condition, free from insects and diseases, with well established root systems. Sample of each species to be shown to Principals Representative for approval before installation.
- 6.2 Installation:
- Preparation of base levels by builder
 - After construction of the buildings apply additional gypsum at 200g/m² to the lower section of the site (if clay encountered)
 - Deep rip area below mass planted areas to a depth of 300mm
 - Place 300mm layer of imported soil mix to all garden areas
 - Apply 100g/m² of a complete native plant food to all gardens areas
 - Work fertiliser in with a rake and leave for one week prior to planting

Planting shall not be carried out in dry soil or in extreme weather conditions. The root systems must be moist before planting to ensure turgidity. The plants shall be removed from their containers with as little disturbance as possible to the root system. Plants should be planted as the same depth as the plants were in the containers and allow for a shallow saucer of soil to be formed around the plant to aid penetration of water.

Avoid hilling up of top soil around young plant stems. Firm soil around the root ball and thoroughly soak the areas after planting. On completion, cultivate, rake and leave all garden areas in a neat and tidy condition. Remove old containers and plant labels from the site.

Fertilise with an approved nine months formulation general purpose slow release fertiliser such as 'Nutricote' or 'Osmocote' that is mixed into the prepared planting space just prior to planting. Fertiliser is to be applied at the rate as specified by the manufacturer for the plant size and type. Maintain all plants and ties and provide adequate watering for the duration of the contract.

Staking - Trees as indicated in the Schedule are to be staked with four 50 x 50mm x 1800mm long hardwood stakes secured in each corner of a 1000 x 1000mm square.

7. GARDEN MULCH

- 7.1 Materials
- Mulch to be comprised of maximum 25mm fresh hardwood chips such as Eucalyptus Mulch from Australian Native Landscapes or equal. Samples to be shown to Superintendent for approval before installation. Mulch to comply with AS 4454-2003: Composts, soil conditioners and mulches.
- 7.2 Installation
- Following planting, rake all garden areas and tamp lightly to give an even graded surface. Spread 75mm layer of mulch over the surface of all garden beds and cove down to finish flush with tops of pavements and garden edging. Care shall be taken not to mix soil and mulch together.

8. NEW LAWN AREAS

- 8.1 Materials
- Turf shall be cultivated 'Greenlees Park' Couch obtained from an approved commercial grower. It shall be weed and disease free.
Topsoil to be a turf topdressing with a high performance turf top-dressing such as Nitro-Top from Australian Native Landscapes or equal. Samples to be shown to Superintendent for approval before installation. Also provide written breakdown of contents, pH and trace elements and suitability for improving existing soil.
Topsoil to comply with AS 4419-2003: Soils for landscaping and garden use.
- 8.2 Installation:
- Preparation of base levels by builder
 - After construction of the buildings apply additional gypsum at 200g/m² to the lower section of the site
 - Deep rip area below lawn areas to a depth of 300mm
 - Place 100mm layer of imported topsoil mix to all garden areas
 - Level and lightly compact topsoil to ensure a smooth surface. Prior to final raking add fertiliser such as Dynamic Lifter to manufacturer's directions. Turf to finish flush with adjoining pavements and edgings. Topdress edges or low areas to ensure even surface.

SCHEDULE OF PLANT MATERIAL

CODE	BOTANICAL NAME	COMMON NAME	QUANTITY	MATURE HEIGHT	CONTAINER SIZE	STAKES
AAm	<i>Acmena smithii</i> 'Allyn Magic'	Dwarf Lilli Pilli	13	1m	200mm	-
BE	<i>Banksia ericifolia</i>	Heath Banksia	8	3m	200mm	-
CR	<i>Correa reflexa</i>	Correa	4	1.5m	200mm	-
CA	<i>Cupaniopsis anacardioides</i>	Tuckeroo	1	10m	45 litre	2
DC	<i>Dianella caerulea</i>	Paroo Lily	26	0.4m	140mm	-
DV	<i>Dodonaea viscosa</i> 'Purpurea'	Purple Hop Bush	5	3m	200mm	-
TL	<i>Tristaniopsis laurina</i>	Water Gum	2	8m	45 litre	2
VH	<i>Viola hederacea</i>	Native Violet	13	0.1m	140mm	-
WFz	<i>Westringia fruticosa</i> 'Zena'	Dwarf Coastal Rosemary	7	1m	200mm	-

BASIX CALCULATIONS

RESIDENCES GARDEN AREAS	AREA
Lawn	158.11m²
Low Water Use Planting	58.10m²
Lawn/LWUP Total	216.21m² (min 278.2m² from BASIX)
Permeable pebble mulch	48.49m²
Total	264.70m² (=45.80%)

LEGEND

- 13.4
- + 52.28
- EXISTING & ARCHITECTS LEVELS
- + 65.20
- PROPOSED LANDSCAPE LEVELS
- EXISTING TREES TO BE RETAINED
- NEW TURF AREAS
- GRAVEL PATHS
- TIMBER GARDEN EDGING
- STEPPING STONES

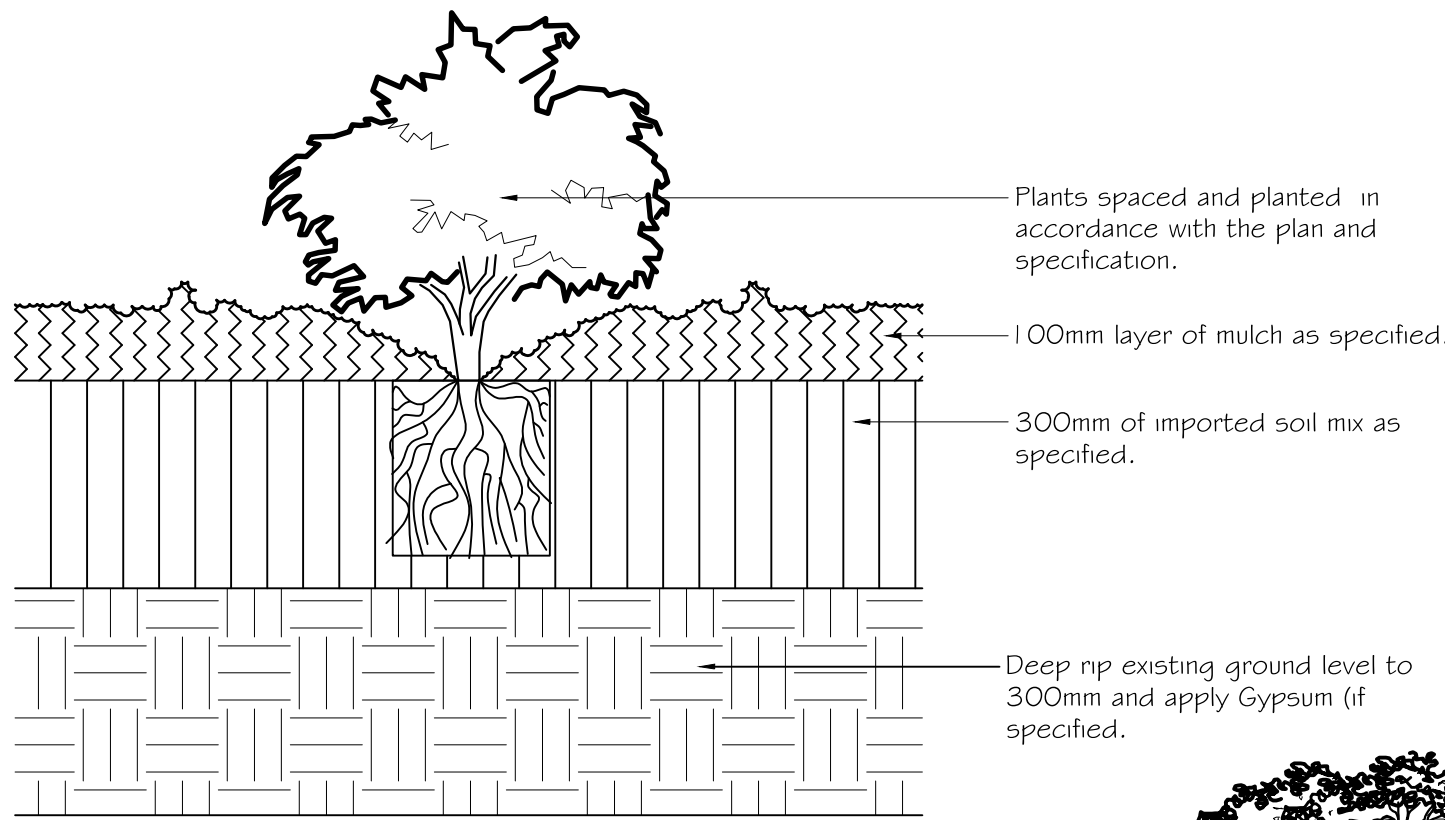
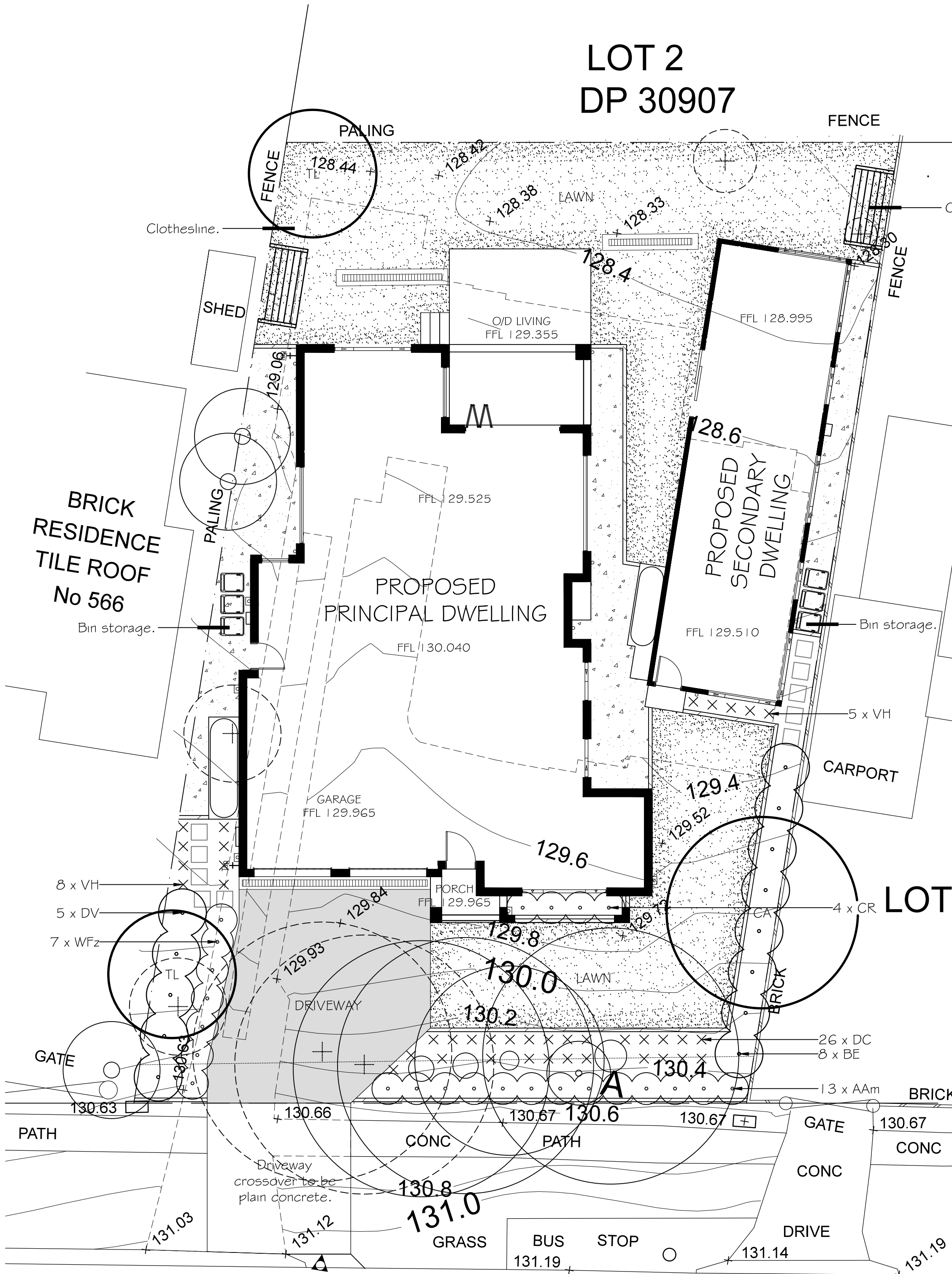

2 MASS PLANTING

SCALE 1:10
TYPICAL SECTION.

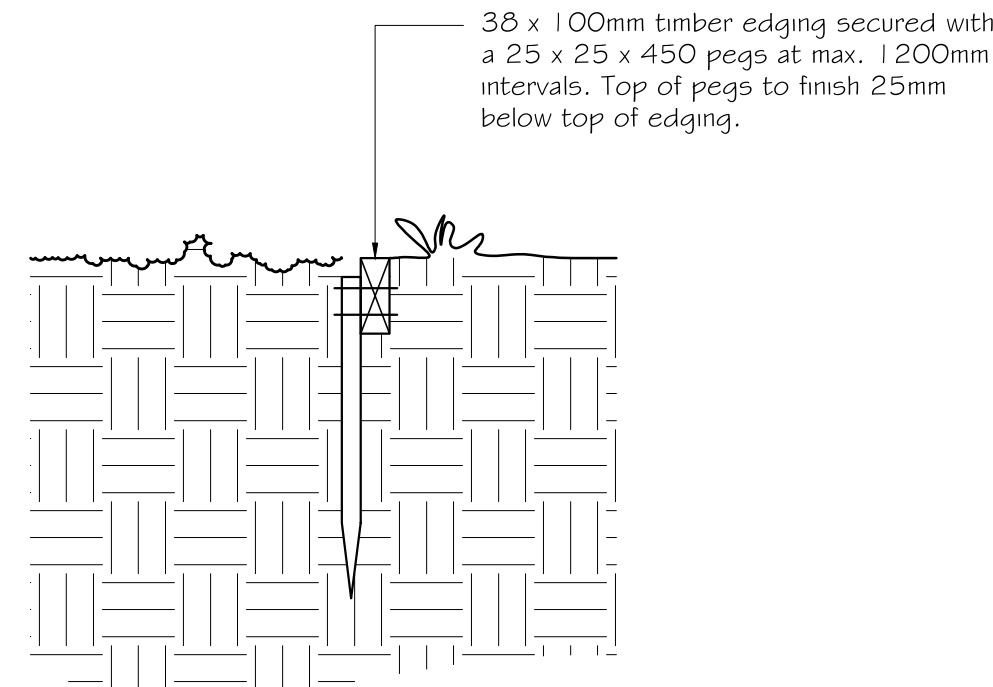

3 TIMBER EDGING

SCALE 1:10
TYPICAL SECTION.

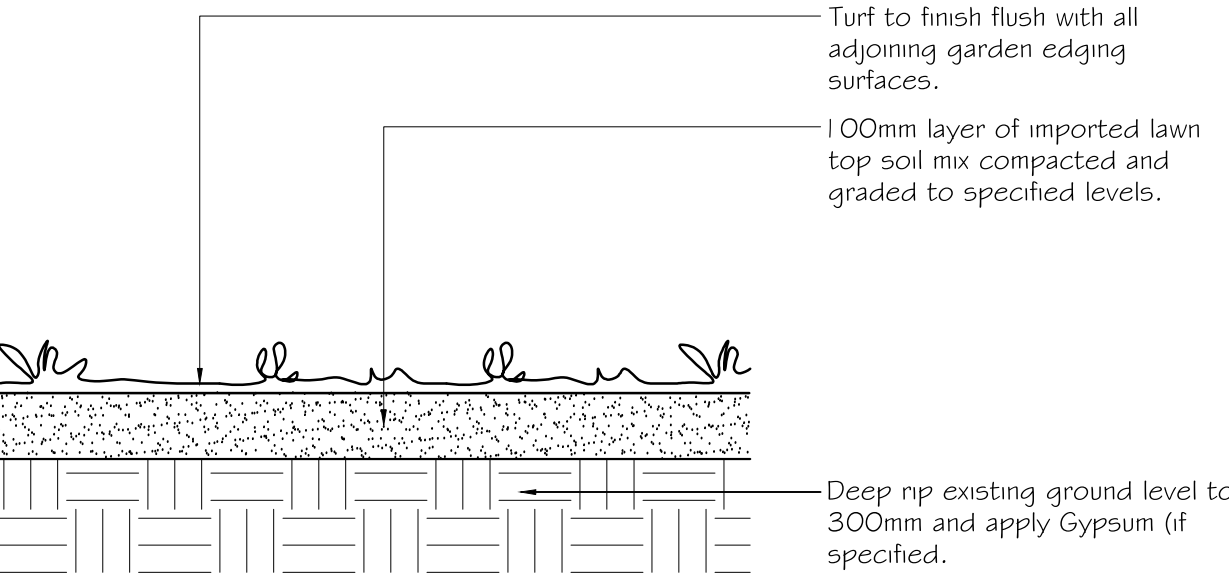

4 LAWN AREAS

SCALE 1:10
TYPICAL SECTION.

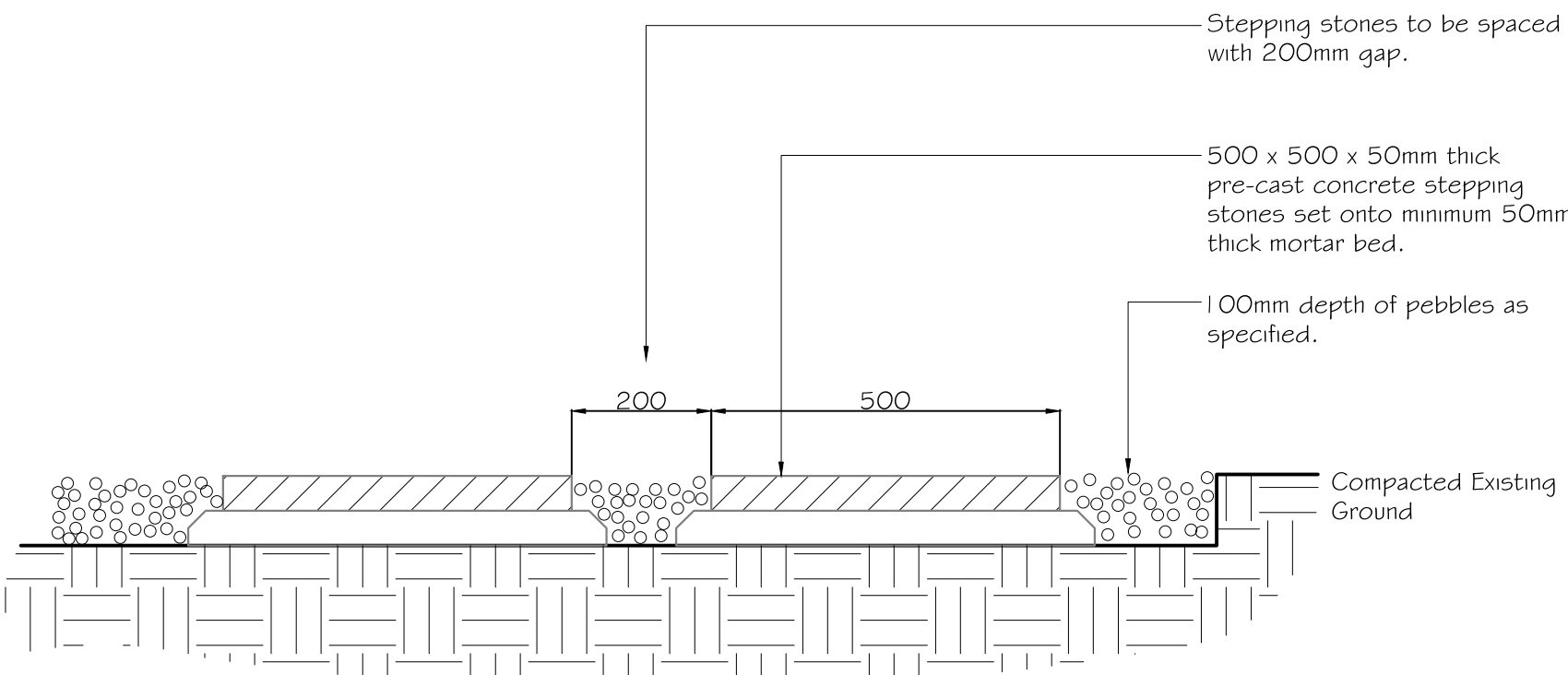

5 STEPPING STONES

SCALE 1:10
TYPICAL SECTION.

WARRINGAH REQUIREMENTS:
SITE AREA: 578.0m²
PRIVATE OPEN SPACE: REQUIRED: 95m²
(Principal = 60m² / Secondary 35m²)
ACHIEVED: 114.53m²
LANDSCAPE AREA: (MIN 2m WIDE)
REQUIRED: 40% OR 231.24m²
ALLOWED: 60m²
ACHIEVED: 58.83m²
SECONDARY DWELLING FLOOR AREA:
ALLOWED: 60m²
ACHIEVED: 58.83m²

NOTES

This plan is to be read in conjunction with all documentation prepared by Champion Homes.

Job no. 4353N



office. 16/303 pacific highway
lindfield nsw 2070
postal. 25 bent street
lindfield nsw 2070
ph 9416 4290 fax 9416 4735
A.C.N 097 328 580
email ijla@netspace.net.au

project

Proposed Residence

Lot 1 (No. 564) Warringah Road,
Forestville

drawing

Landscape Plan

client

M. Kulkarni & S. Kulkarni

date

March 2021

job.dwg no.

42.21/074

designed by

IJ

scale

1:100 @ A1

1:200 @ A3

no. in set

ONE/ONE

drawn by

HL