

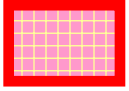
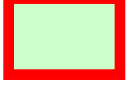

**COPYRIGHT**  
 All rights reserved. This work has copyright and cannot be reproduced or copied in any form or by any means (graphic, electronic or mechanical, including photocopying) without the written permission of Paul Kelly Design.  
 All license, expressed or implied, to use this document for any purpose whatsoever is restricted to the terms and agreement or implied agreement between Paul Kelly Design and the instructing party.

**NOTE**  
 Only use written dimensions. Do not scale. If in doubt, consult with Paul Kelly Design. Check all dimensions on site before fabrication or set out.

-  **Core Club**  
(Operated by Mounties)
-  **Core Club**  
(Operated by Mounties / or to a 3rd Party under a Management Agreement)
-  **Restaurants / Cafe**  
(Tenant Area)
-  **Member Services**  
(Tenant Area)

**Legend**

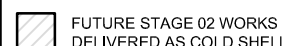
-  NOT IN SCOPE
-  FUTURE STAGE 02 WORKS DELIVERED AS COLD SHELL

**Reviewed**  
 21/03/2017 10:00:29 PM

**cerno**  
 Grant Harding  
 Senior Project Manager

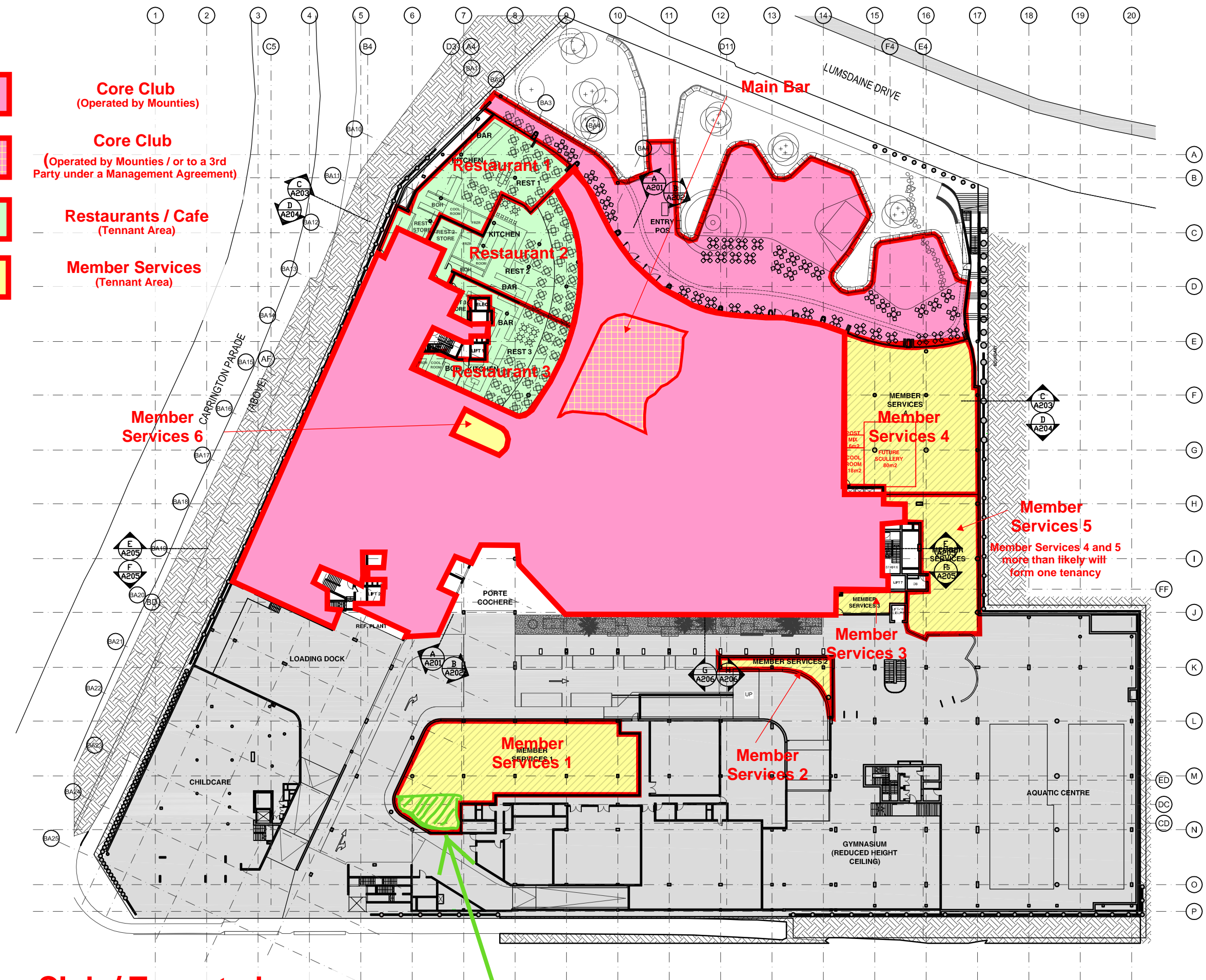

Rev	Date	Description	Checked
P17	20.03.17	PRELIMINARY ISSUE	PK
P16	16.03.17	PRELIMINARY ISSUE	PK
P15	06.03.17	PRELIMINARY ISSUE	PK
P14	23.02.17	PRELIMINARY ISSUE	PK
P13	17.02.17	PRELIMINARY ISSUE	PK
P12	16.02.17	PRELIMINARY ISSUE	PK
P11	13.02.17	PRELIMINARY ISSUE	PK
P10	10.02.17	PRELIMINARY ISSUE	PK
P9	03.02.17	PRELIMINARY ISSUE	PK
P8	01.02.17	PRELIMINARY ISSUE	PK
P7	30.01.17	PRELIMINARY ISSUE	PK
P6	27.01.17	PRELIMINARY ISSUE	PK
P5	20.01.17	PRELIMINARY ISSUE	PK
P4	21.12.16	PRELIMINARY ISSUE	PK
P3	16.12.16	PRELIMINARY ISSUE	PK
P2	14.12.16	PRELIMINARY ISSUE	PK
P1	09.12.16	PRELIMINARY ISSUE	PK

**HARBORD DIGGERS**  
 80 EVANS STREET  
 FRESHWATER

**LOWER GROUND FLOOR:  
 PROPOSED PLAN**

Status: PRELIMINARY  
 Scale: AS SHOWN  
 Drawn: SD  
 Project No.: 481

Drawing No.: **A LG 1 00 B P17**

Discipline Code	Level	Type	No.	Revision

77 Bay Street  
 Glebe NSW 2037  
 phone: 02 9660 8299  
 fax: 02 9660 8499  
 www.paulkellydesign.com.au



**Club / Tenanted  
 Hospitality Area Plan**

1:600@A3

Proposed medical tenancy - Tenancy MS9

**PRELIMINARY ISSUE**