

THIS POOL WAS DESIGNED BY OTHERS. RIGHT ANGLE DRAFTING ACCEPT NO RESPONSIBILT FOR THE DESIGN OR ITS DETERMINATION AT COUNCIL.

- NOTES
- CONFIRM ALL DIMENSIONS, SERVICES AND LEVELS ON SITE PRIOR TO STARTING WORK.
 - ALL BUILDING WORKS SHALL COMPLY WITH THE BUILDING CODE OF AUSTRALIA, THE RELEVANT AUSTRALIAN STANDARDS AND THE LOCAL GOVERNMENT AUTHORITY.
 - TIMBER FRAMING AS PER AS1684 AND THE NSW TIMBER FRAMING CODE.
 - BOUNDARY FENCING TO BE UPGRADED AS NECESSARY AND ALL POOL FENCING TO COMPLY WITH THE NSW SWIMMING POOL ACT 1992, AS1926.1-2012-SAFETY BARRIERS FOR SWIMMING POOLS AND AS1926.2-2012 LOCATION OF SAFETY BARRIERS FOR SWIMMING POOLS.
 - THIS POOL IS NOT DESIGNED FOR DIVING.
 - EL = EXISTING LEVEL
 - FL = FLOOR LEVEL
 - RL = REDUCED LEVEL
 - +1.05 = EXISTING LEVEL
 - COS = CHECK ON SITE
 - UNO = UNLESS NOTED OTHERWISE

TOTAL POOL VOLUME = 56,000 LITRES

BASIX REQUIREMENTS

RAINWATER TANK

1. a rainwater tank of 1782 litres must be installed on the property in accordance with the applicable regulatory authorities.
2. The rainwater tank must collect runoff from at least 51square metres of roof area.
3. The rainwater tank must be connected to a tap located within 10m of the edge of the pool and spa area.

POOL

4. the swimming pool must be located outdoors.
5. the swimming pool must not have a capacity of greater than 56 kilolitres.
6. the swimming pool must have a pool cover.
7. a pool pump timer must be installed.
8. the pool must have an electric heat pump heating system installed as part of this development.

SYMBOL LEGEND

- NEIGHBOURING PRIVATE OPEN SPACE
- PREVAILING WINDS
- VIEWS
- NOISE SOURCE

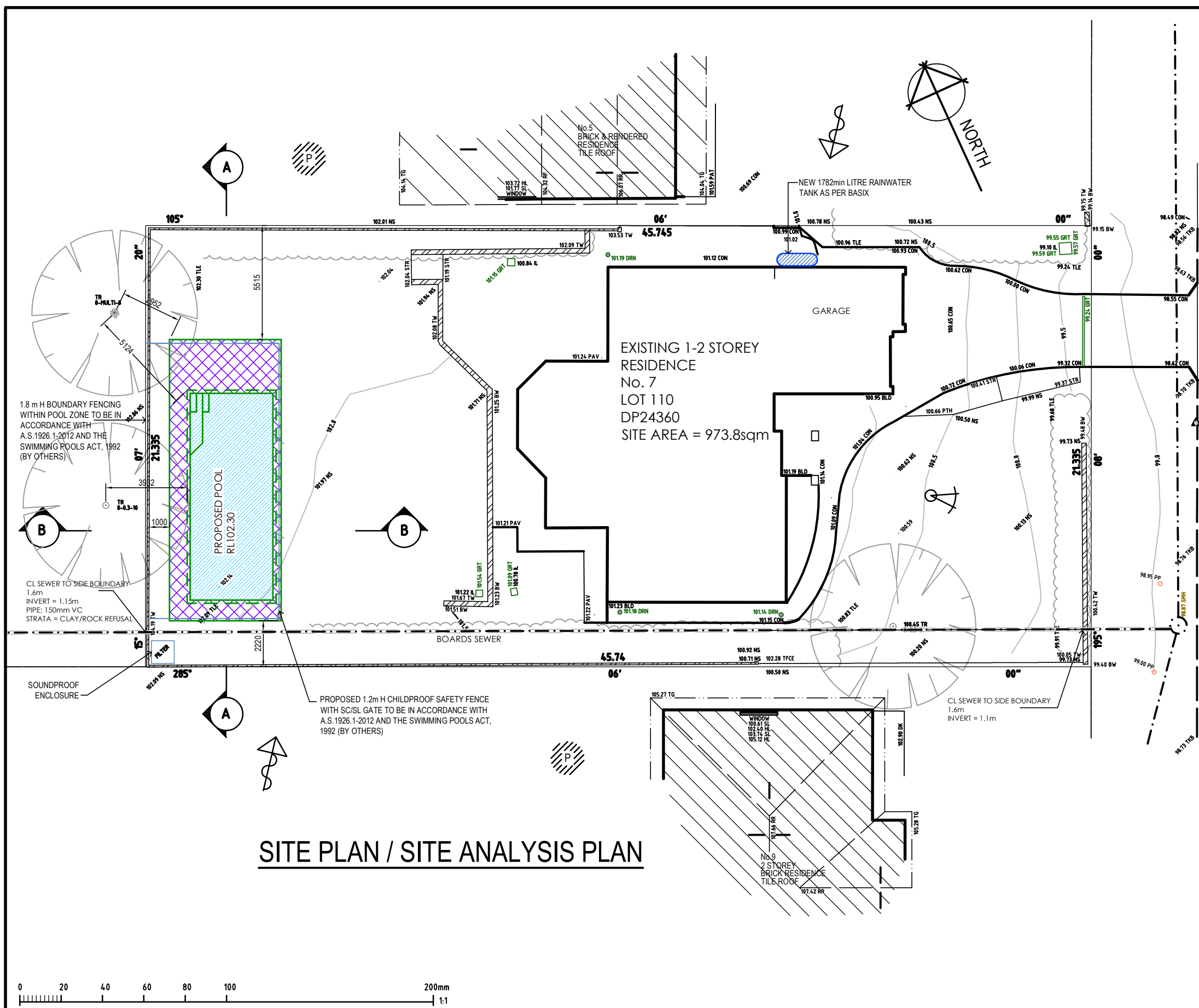

SITE PLAN / SITE ANALYSIS PLAN

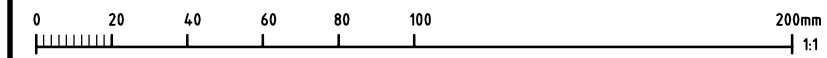

<div><div><div>RIGHT ANGLE DESIGN & DRAFTING PTY LTD</div><div>ROBYN GOOD HORTICULTURE CERT III ASSOC. DIPLOMA STRUCTURAL ENGINEERING NZCO ARCHITECTURAL DRAFTING</div><div>P.O. Box 1049 SURRY HILLS 2010 PH: 8399-0072 EMAIL: info@rightangledesign.com.au ABN: 70 150 745 556</div></div></div>	REVISIONS:		PROPOSED POOL & ASSOCIATED WORKS LOT 110 DP24360 No. 7 LUMEAH AVENUE ELANORA HEIGHTS 2101	DWG NAME			
	SITE PLAN / SITE ANALYSIS PLAN						
	DATE			SCALE AT A3	JOB NUMBER	DWG NUMBER	
JUL 19	1:200	RADD19044	P1				

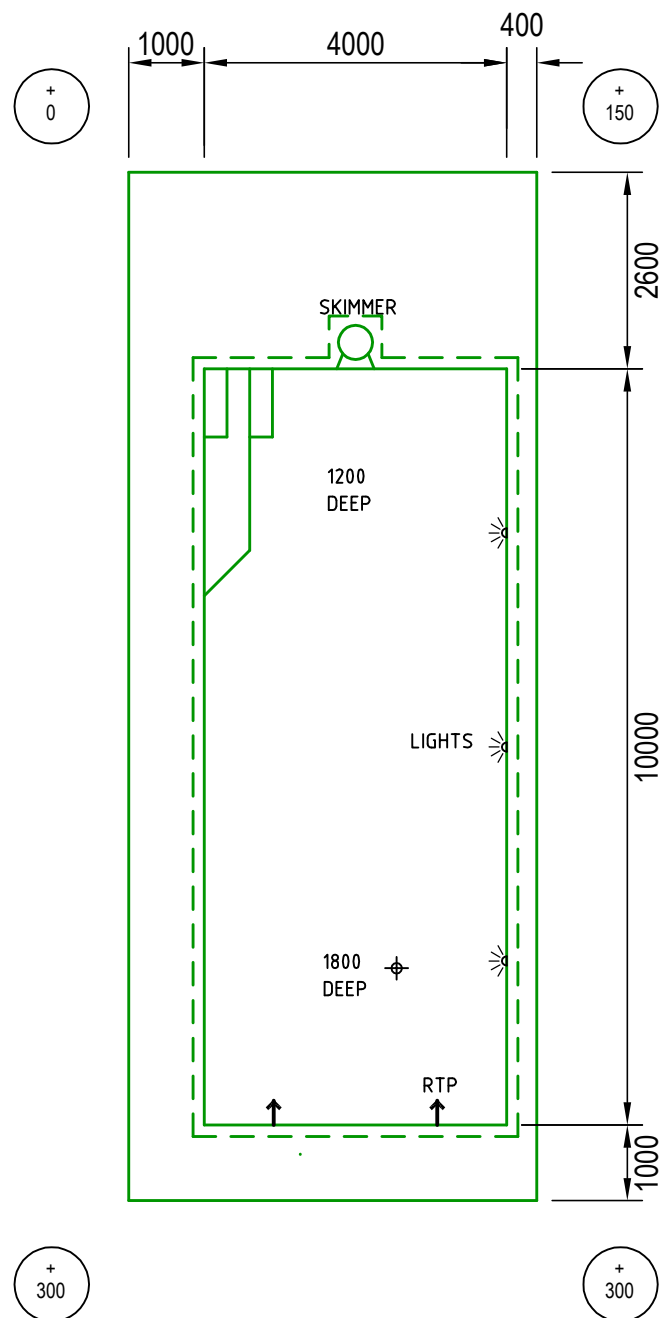

POOL PLAN

↑ DENOTES TOP OF POOL RELATIVE TO NATURAL GROUND LEVEL

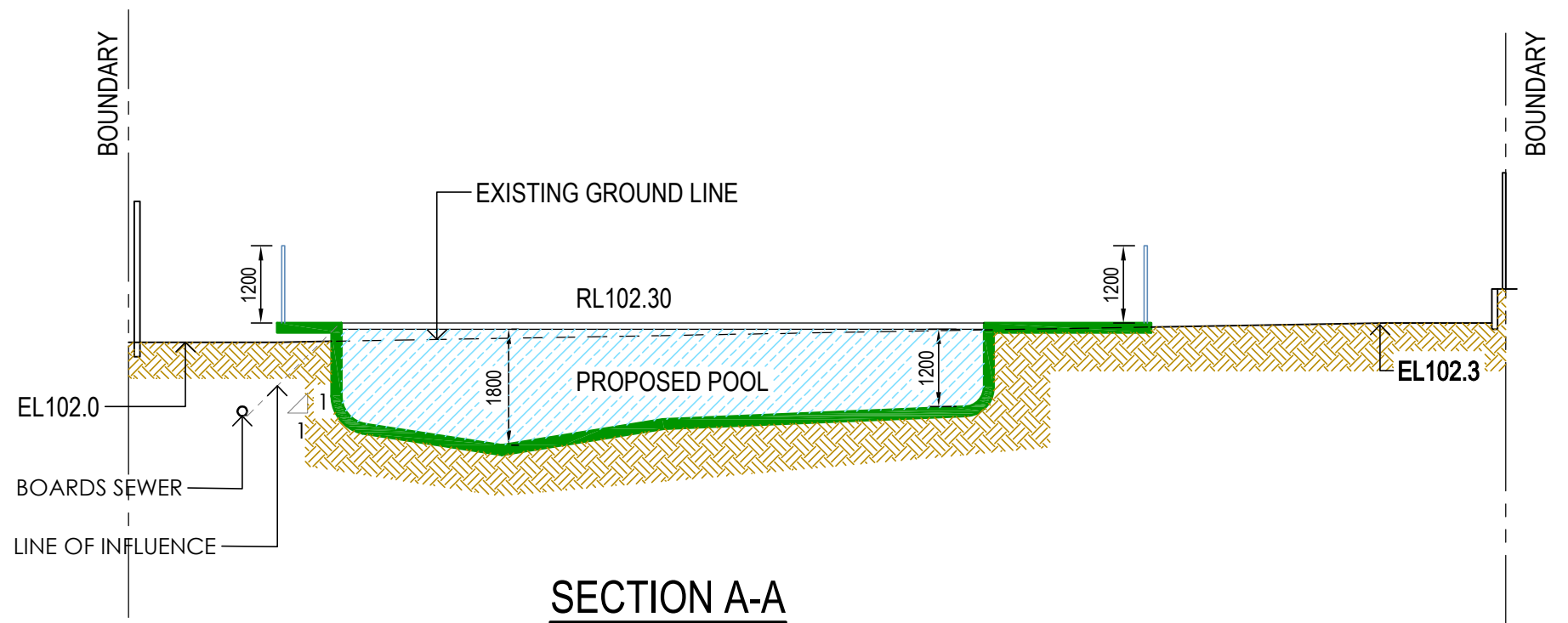

SECTION A-A

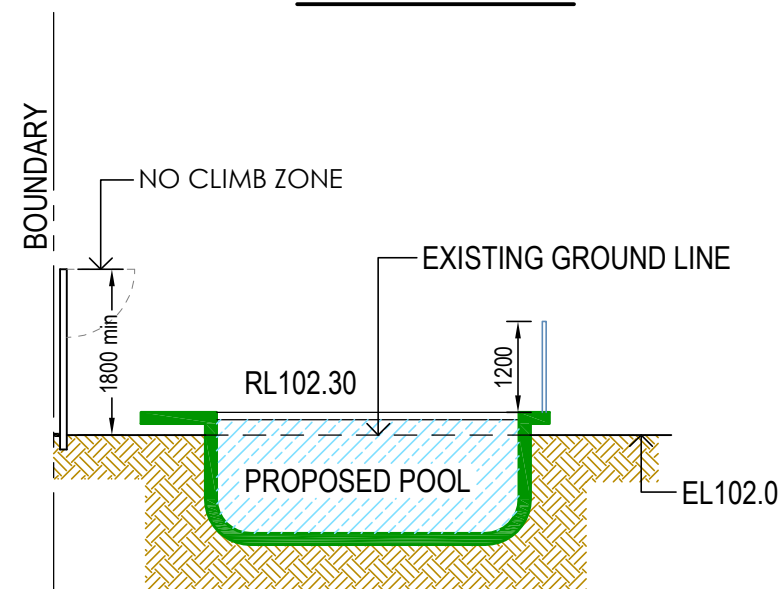

SECTION B-B

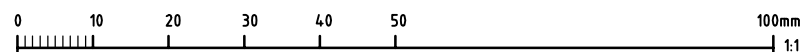

**RIGHT ANGLE DESIGN
& DRAFTING PTY LTD**

ROBYN GOOD
HORTICULTURE CERT III
ASSOC. DIPLOMA STRUCTURAL ENGINEERING
NZCO ARCHITECTURAL DRAUGHTING
P.O. Box 1049 SURRY HILLS 2010
PH: 8399-0072
EMAIL: info@rightangledesign.com.au
ABN: 70 150 745 556

REVISIONS:

PROPOSED POOL & ASSOCIATED WORKS
LOT 110 DP24360
No. 7 LUMEAH AVENUE
ELANORA HEIGHTS 2101

DWG NAME

POOL PLAN AND SECTIONS

DATE

SCALE AT A3

JOB NUMBER

DWG NUMBER

JUL 19

1:100

RADD19044

P3