

ARBORIST KEY:

- TREES TO BE RETAINED
- TREES THAT REQUIRE REMOVAL TO FACILITATE THE PROPOSED DEVELOPMENT
- TREES THAT FAIL THE VISUAL TREE ASSESSMENT AND ARE RECOMMENDED FOR REMOVAL
- TREES THAT ARE LISTED AS EXEMPT SPECIES AND RECOMMENDED FOR REMOVAL
- TREE PROTECTION ZONE
- STRUCTURAL ROOT ZONE
- TREE PROTECTION ZONE INTRUSION
- GROUND PROTECTION
- TRUNK ARMOUR
- TREE PROTECTION FENCING

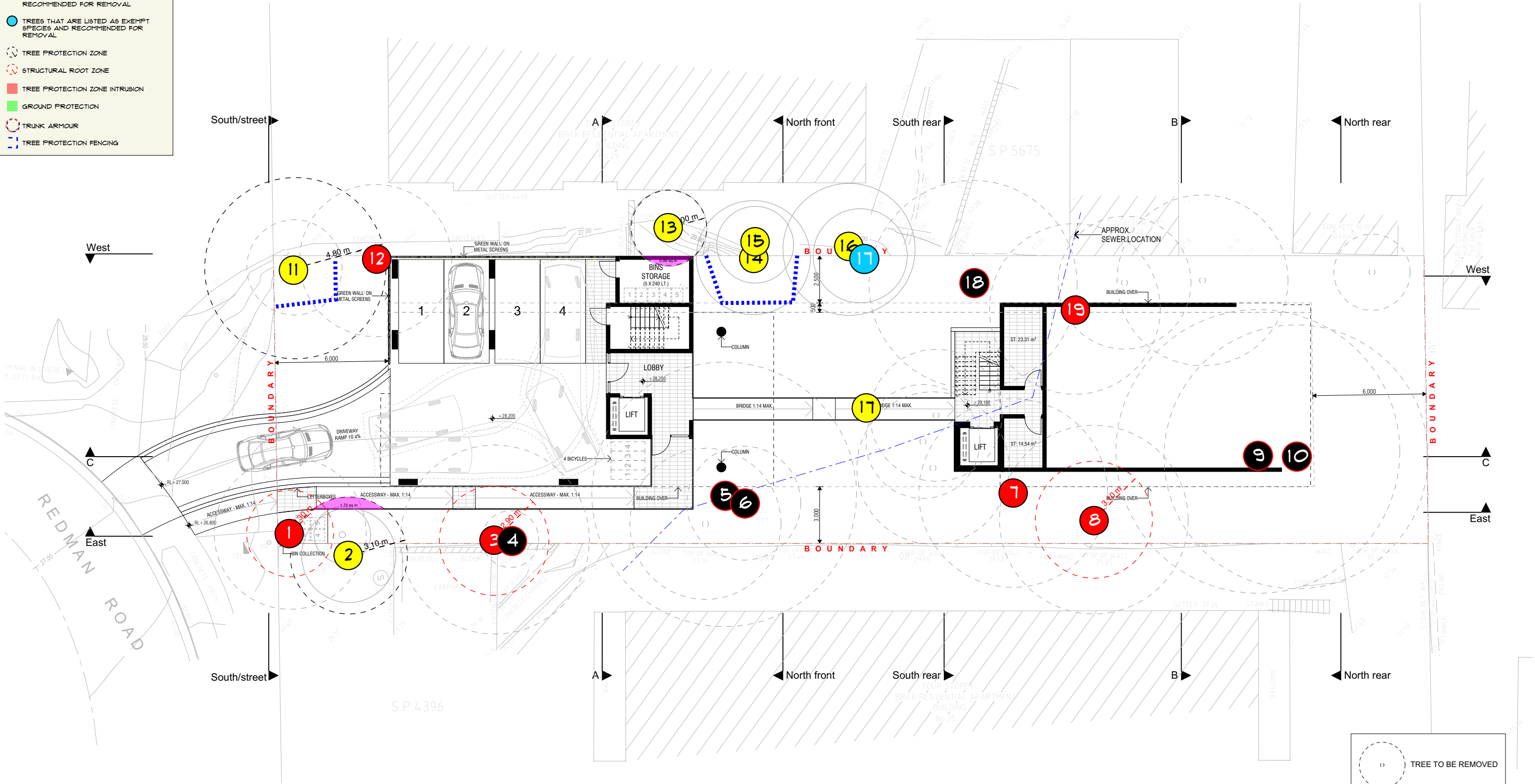

TREE TO BE REMOVED

TREE TO BE RETAINED