

NORTH

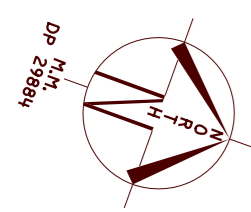

© COPYRIGHT . COPYRIGHT OF THIS PLAN AND THE ACCOMPANYING CAD FILE(S) WHERE APPLICABLE VESTS WITH ASPECT DEVELOPMENT & SURVEY Pty. Ltd. THE PLAN AND CAD FILE SHALL ONLY BE USED BY THE ADDRESSED CLIENT FOR THE PURPOSE FOR WHICH THE SURVEY WAS CARRIED OUT.

LOCALITY SKETCH

UBD AREA: SYD REVISION: 54
MAP: 176 REF: G6
S
GPS E

D - DENOTES GROUND FLOOR DOOR



HOW TO PROTECT SURVEY MARKS BEFORE WORKS COMMENCE

For details refer to: https://www.spatial.nsw.gov.au/data/assets/pdf/file/0003/221736/Protecting_Survey_Marks_June2018_Final.pdf
Find out if there are survey marks located in the area of interest by:

1. Viewing the Permanent survey mark layer on SIX Maps - maps.six.nsw.gov.au and print the map showing location of survey marks.
2. Download the Permanent Survey Mark Locality Sketches.
3. Inspecting the site, paying particular attention to survey marks located in the footpath, kerb or gutter.

IF NO SURVEY MARKS ARE AFFECTED COMMENCE WORKS IF SURVEY MARKS ARE IN THE AREA & COULD BE AFFECTED BY THE WORKS, eg. disturbed or removed

1. Apply for Surveyor General Approval - Survey Mark(s) Removal.
2. Where required contact a Registered Surveyor to assist with the conditions of approval.

PENALTIES FOR DISTURBING SURVEY MARKS

The unauthorised removal, disturbance or destruction of survey marks is costly to the community. Section 24(1) of the Surveying and Spatial Information Act, 2002 states a person must not remove, damage, destroy, displace, obliterate or deface any survey mark unless authorised to do so by the Surveyor-General. Penalties such as \$10,000 towards the cost of reinstatement and up to \$10,000 towards loss or damage may apply.

(E) NOTE: BUILDER TO CONFIRM WITH RELEVANT ENERGY/TELECOMMUNICATIONS PROVIDER THAT THE ZONE OF OVERHEAD LINES WILL NOT AFFECT HOUSE DESIGN & CONSTRUCTION. IF POSITION OF OVERHEAD LINES IS CRITICAL, EXTRA SURVEY MAY BE REQUIRED.

APPROXIMATE POSITION OF SEWER MAIN (BY DBYD) REFER TO DBYD DIAGRAM FOR DETAILS. NOTE: PRIOR TO ANY DESIGN AND CONSTRUCTION, A SEWER PEGOUT MUST BE UNDERTAKEN TO DETERMINE THE EXACT LOCATION OF THE SEWER LINE.

NOTE: THIS CONTOUR & DETAIL SURVEY IS FOR TENDER PURPOSES ONLY & IS CARRIED OUT UNDER CLAUSE 9 OF THE SURVEYING & SPATIAL INFORMATION REGULATION 2017. IT MAY NOT FULFIL ALL THE REQUIREMENTS OF A DEVELOPMENT APPLICATION (DA) OR A COMPLYING DEVELOPMENT CONSENT (CDC). THE POSITION OF STRUCTURES & IMPROVEMENTS SHOWN ARE APPROXIMATE ONLY. IF A DA OR CDC IS TO BE LODGED, IT IS RECOMMENDED THE BOUNDARIES BE SURVEYED MORE ACCURATELY & THE CONTOUR & DETAIL SURVEY BE UPDATED TO REFLECT THIS ACCURACY. IF THE POSITION OF THE PROPOSED RESIDENCE IS CRITICAL TO EXISTING STRUCTURES, ADDITIONAL SURVEY WORK MAY BE REQUIRED TO ENSURE FINAL DESIGN SATISFIES THE CLIENT. FOR ANY PROPOSED STRUCTURES IN RELATION TO A BOUNDARY, A REGISTERED SURVEYOR MUST CARRY OUT A BOUNDARY SURVEY, SETOUT SURVEY OR IDENTIFICATION SURVEY FOR THE PROPOSED WORKS.

ALL TREE HEIGHTS AND SPREAD ARE APPROXIMATE ONLY AND ARE SHOWN FOR TENDER PURPOSES ONLY. ALL TREE RELATED ISSUES TO BE REFERRED TO AN ARBORIST

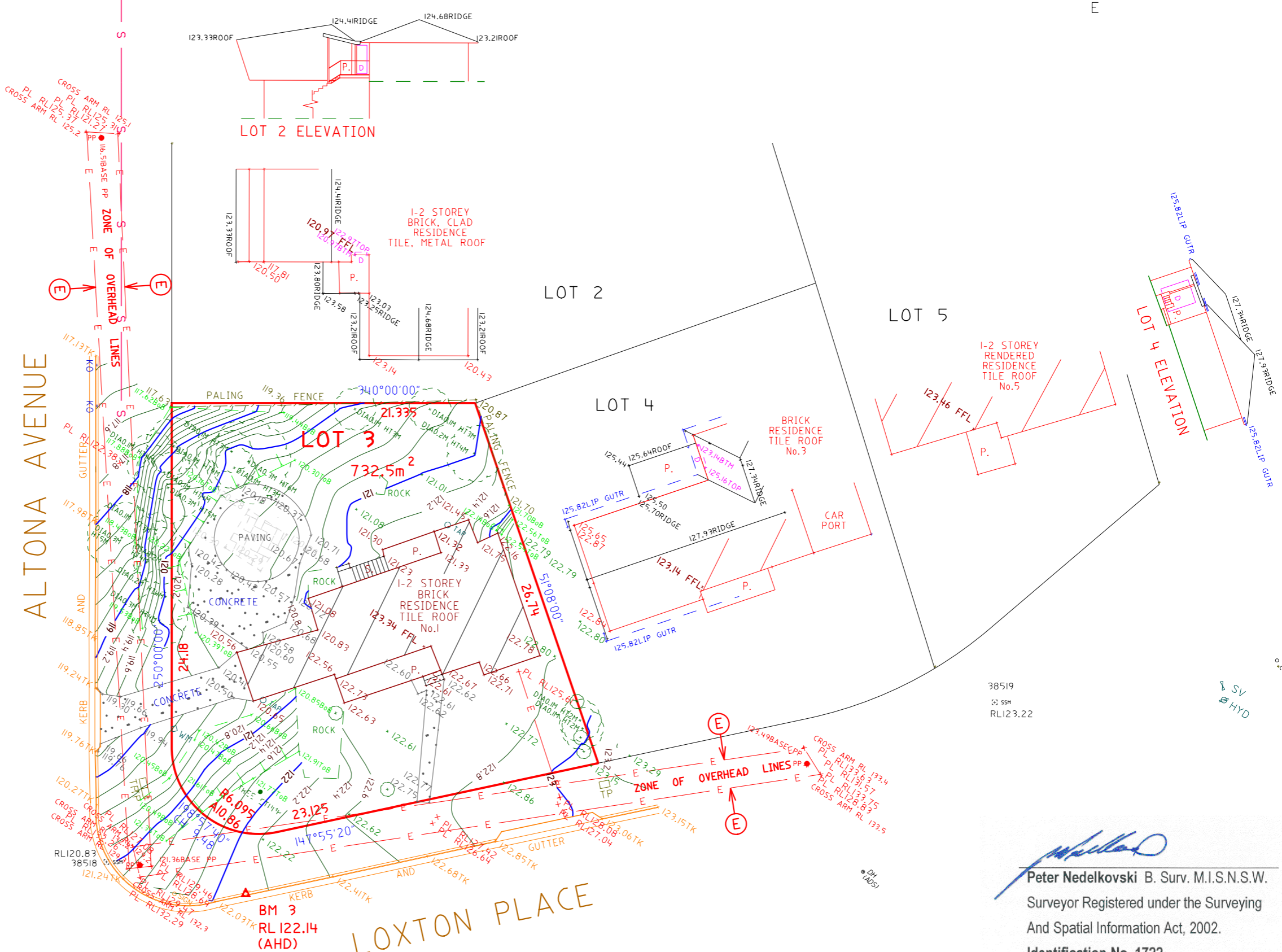

38519
SSM
RL123.22
SV
HYD

(Signature)
Peter Nedelkovski B. Surv. M.I.S.N.S.W.
Surveyor Registered under the Surveying
And Spatial Information Act, 2002.
Identification No. 1722

GENERAL NOTES
A) THIS SURVEY IS SPECIFICALLY FOR CONTOUR PURPOSES ONLY. THE BOUNDARIES OF THE SUBJECT PROPERTY HAVE NOT BEEN INVESTIGATED AND THE POSITION SHOWN IS APPROXIMATE ONLY.
B) AREAS AND DIMENSIONS ARE SUBJECT TO SURVEY.
C) PITS AND SERVICES SHOWN HAVE BEEN DERIVED FROM VISUAL EVIDENCE APPARENT AT THE TIME OF SURVEY. THE RELEVANT SERVICE AUTHORITY SHALL BE CONTACTED TO VERIFY THE EXISTENCE AND POSITION OF ALL SERVICES PRIOR TO DA & THE COMMENCEMENT OF ANY CONSTRUCTION OR EXCAVATION WORKS. CONTOURS ARE INDICATIVE OF SURFACE TOPOGRAPHY ONLY. SURVEYED SPOT LEVELS ARE THE ONLY VALUES TO BE RELIED ON FOR REDUCED LEVELS ON PARTICULAR FEATURES.
D) THIS SURVEY HAS BEEN CARRIED OUT UNDER CLAUSE 9 OF THE SURVEYING AND SPATIAL INFORMATION REGULATION 2017.
E) THIS SURVEY MAY NOT FULFIL ALL THE REQUIREMENTS OF A DEVELOPMENT APPLICATION (DA) OR A COMPLYING DEVELOPMENT CONSENT (CDC).

SYMBOLS & ABBREVIATIONS:		
GP	GULLY PIT	-E- OVERHEAD ELEC LINE
SIP	SURFACE INLET PIT	-S- SEWER LINE
SIC	SEWER INSPECTION COVER	PP POWER POLE
MH	SEWER MANHOLE	LP LIGHT POLE
SWMH	STORMWATER MANHOLE	EC ELECTRICITY CONDUIT
WM	WATER METER	ECT ELEC & TELE CONDUIT
EL	ELECTRICITY BOX	TC TELECOM CONDUIT
TP	TELECOMMUNICATIONS PIT	WC WATER CONDUIT
TD	TELECOMMUNICATIONS DOME	G GAS CONDUIT
HYD	WATER HYDRANT	GM GAS METER
R/W	RECYCLED WATER HYDRANT	GD GAS DISC
SV	STOP VALVE	
		TK TOP OF KERB
		RTK ROLL TOP KERB
		VC VEHICLE CROSSING
		INV INVERT
		KO KERB OUTLET
		TTTT TOP OF BANK
		BOB BOTTOM OF BANK
		OPSP PRESSURE SEWER PUMP PIT
		OPSPV PRESSURE SEWER VALVE PIT
		FP FLUSHING POINT
		OL OVERHEAD LINE

ASPECT DEVELOPMENT & SURVEY Pty. Ltd.
CONSULTING REGISTERED SURVEYORS
ABN 60 078 649 000
SUITE 1
103 VANESSA STREET
KINGSGROVE NSW 2208
PHONE (02) 9554 8388
FAX (02) 9554 8588
admin@aspectsurvey.com.au
PO BOX 161
KINGSGROVE NSW 1480
DX 11392
HURSTVILLE

PROJECT		
OUR REFERENCE	21/1069431/397427	
LOT 3	DP 29884	SECTION
DATUM AHD		SOURCE 22/07/24
ORIGIN OF LEVELS	SSM 38518	REDUCED LEVEL 120.83
SURVEYED MS/AL		DATE 30/07/2024
DRAWN NP		DATE 02/08/2024
SCALE 1: 300	A3 SHEET	

CLIENT: CLARENDON HOMES Pty. Ltd.
REF: 29917284
REF:
ADDRESS: 1 LOXTON PLACE
SUBURB: FORESTVILLE