

DEPOSITED PLAN ADMINISTRATION SHEET

Office Use Only	Office Use Only
Registered: Title System:	<p><i>THIS IS A DRAFT SUBDIVISION PLAN ONLY. ALL BOUNDARIES, LAYOUTS, DIMENSIONS, AREAS, EASEMENTS & LEVELS ARE SUBJECT TO SURVEY</i></p>
<p>PLAN OF SUBDIVISION OF THE LAND IN S.P.32071 & S.P.32072</p>	LGA: NORTHERN BEACHES Locality: DEE WHY Parish: MANLY COVE County: CUMBERLAND
<p style="text-align: center;">Survey Certificate</p> I, CHRISTOPHER THOMAS NORTON of NORTON SURVEY PARTNERS PTY LTD P.O. BOX 289 ROZELLE NSW 2039 a surveyor registered under the <i>Surveying and Spatial Information Act 2002</i> , certify that: *(a) The land shown in the plan was surveyed in accordance with the <i>Surveying and Spatial Information Regulation 2017</i> , is accurate and the survey was completed on _____, or *(b) The part of the land shown in the plan (*being/*excluding** _____) was surveyed in accordance with the <i>Surveying and Spatial Information Regulation 2017</i>, the part surveyed is accurate and the survey was completed on _____ the part not surveyed was compiled in accordance with that Regulation, or *(c) The land shown in this plan was compiled in accordance with the <i>Surveying and Spatial Information Regulation 2017</i>. Datum Line: A - B Type: *Urban/*Rural The terrain is *Level-Undulating / *Steep Mountainous. Signature: Dated: _____ Surveyor Identification No: 1761 Surveyor registered under the <i>Surveying and Spatial Information Act 2002</i> *Strike out inappropriate words. **Specify the land actually surveyed or specify any land shown in the plan that is not the subject of the survey.	<p style="text-align: center;">Crown Lands NSW/Western Lands Office Approval</p> I, (Authorised Officer) in approving this plan certify that all necessary approvals in regard to the allocation of the land shown herein have been given. Signature: Date: File Number: Office: _____
Plans used in the preparation of survey/compilation.	<p style="text-align: center;">Subdivision Certificate</p> I, *Authorised Person/*General Manager/*Accredited Certifier, certify that the provisions of s.6.15 of the <i>Environmental Planning and Assessment Act 1979</i> have been satisfied in relation to the proposed subdivision, new road or reserve set out herein. Signature: Accreditation number: Consent Authority: Date of endorsement: Subdivision Certificate number: File number: *Strike through if inapplicable.
Statements of intention to dedicate public roads create public reserves and drainage reserves, acquire/resume land.	Statements of intention to dedicate public roads create public reserves and drainage reserves, acquire/resume land.
Surveyor's Reference: 53046 DP Issue A 2.12.21	Signatures, Seals and Section 88B Statements should appear on PLAN FORM 6A

Office Use Only	Office Use Only
Registered:	<p><i>THIS IS A DRAFT SUBDIVISION PLAN ONLY. ALL BOUNDARIES, LAYOUTS, DIMENSIONS, AREAS, EASEMENTS & LEVELS ARE SUBJECT TO SURVEY</i></p>
PLAN OF SUBDIVISION OF THE LAND IN S.P.32071 & S.P.32072	
Subdivision Certificate number:	<p>This sheet is for the provision of the following information as required:</p> <ul style="list-style-type: none"> • A schedule of lots and addresses - See 60(c) SSI Regulation 2017 • Statements of intention to create and release affecting interests in accordance with section 88B Conveyancing Act 1919 • Signatures and seals- see 195D Conveyancing Act 1919 • Any information which cannot fit in the appropriate panel of sheet 4 of the administration sheets.
Date of Endorsement:	

SCHEDULE OF STREET ADDRESSES

LOT	STREET No.	STREET NAME	STREET TYPE	LOCALITY
1	4	DELMAR	PARADE	DEE WHY
2	812	PITWATER	ROAD	DEE WHY

PURSUANT TO SECTION 88B OF THE CONVEYANCING ACT 1919, IT IS INTENDED TO CREATE:

1. RIGHT OF VEHICLE ACCESS LIMITED IN STRATUM (RVA1)
2. RIGHT OF VEHICLE ACCESS LIMITED IN STRATUM (RVA2)
3. RIGHT OF VEHICLE ACCESS LIMITED IN STRATUM (RVA3)
4. RIGHT OF ACCESS LIMITED IN STRATUM (RA1)
5. RIGHT OF ACCESS LIMITED IN STRATUM (RA2)
6. RIGHT OF ACCESS LIMITED IN STRATUM (RA3)
7. EASEMENT TO DRAIN WATER 3 WIDE (E1)
8. EASEMENT FOR DRAINAGE OF WATER & RISING MAIN LIMITED IN STRATUM (E2)
9. EASEMENT FOR DRAINAGE OF WATER & RISING MAIN LIMITED IN STRATUM (E3)
10. EASEMENT FOR DRAINAGE OF WATER & PUMP OUT LIMITED IN STRATUM (E4)
11. EASEMENT FOR DRAINAGE OF WATER LIMITED IN STRATUM (E5)
12. EASEMENT FOR DRAINAGE OF WATER & RISING MAIN LIMITED IN STRATUM (E6)
13. EASEMENT FOR DRAINAGE OF WATER LIMITED IN STRATUM (E7)
14. EASEMENT FOR DRAINAGE OF WATER & OSD LIMITED IN STRATUM (E8)
15. EASEMENT TO USE LIFT LIMITED IN STRATUM (E9)
16. EASEMENT TO USE LOADING DOCK LIMITED IN STRATUM (E10)
17. EASEMENT FOR RECREATION LIMITED IN STRATUM (E11)
18. EASEMENT FOR RECREATION LIMITED IN STRATUM (E12)
19. EASEMENT FOR MAIL BOX LIMITED IN STRATUM (E13)
20. EASEMENT FOR GARBAGE COLLECTION LIMITED IN STRATUM (E14)
21. EASEMENT FOR EMERGENCY EGRESS (E15)

(CONTINUED ON SHEET 3)

If space is insufficient use additional annexure sheet

Office Use Only

Office Use Only

Registered:**PLAN OF SUBDIVISION OF THE LAND IN
S.P.32071 & S.P.32072***THIS IS A DRAFT SUBDIVISION PLAN ONLY.
ALL BOUNDARIES, LAYOUTS, DIMENSIONS, AREAS,
EASEMENTS & LEVELS ARE SUBJECT TO SURVEY*

Subdivision Certificate number:

Date of Endorsement:

This sheet is for the provision of the following information as required:

- A schedule of lots and addresses - See 60(c) SSI Regulation 2017
- Statements of intention to create and release affecting interests in accordance with section 88B *Conveyancing Act 1919*
- Signatures and seals- see 195D *Conveyancing Act 1919*
- Any information which cannot fit in the appropriate panel of sheet 4 of the administration sheets

(CONTINUED FROM SHEET 2)

22. EASEMENT FOR ELECTRICITY & OTHER PURPOSES (E16)
23. RIGHT OF CARRIAGEWAY (E17)
24. EASEMENT FOR ELECTRICITY & OTHER PURPOSES (E18)
25. RIGHT OF CARRIAGEWAY (E19)
26. POSITIVE COVENANT (OSD)
27. RESTRICTION ON THE USE OF LAND (OSD)

PURSUANT TO SECTION 88B OF THE CONVEYANCING ACT 1919, IT IS INTENDED TO RELEASE:

1. EASEMENT FOR ELECTRICITY SUPPLY 1 WIDE (DP638872)
2. RIGHT OF CARRIAGEWAY 7 WIDE & 5.78 WIDE (DP710661)
3. RIGHT OF CARRIAGEWAY 1.22 WIDE (DP710661)
4. EASEMENT TO DRAIN WATER 3 WIDE (DP710661)
5. EASEMENT TO DRAIN WATER 2 WIDE (DP710661)

If space is insufficient use additional annexure sheet

Surveyor's Reference: 53046 DP **Issue A 2.12.21**

Office Use Only

Office Use Only

Registered:

PLAN OF SUBDIVISION OF THE LAND IN S.P.32071 & S.P.32072

THIS IS A DRAFT SUBDIVISION PLAN ONLY. ALL BOUNDARIES, LAYOUTS, DIMENSIONS, AREAS, EASEMENTS & LEVELS ARE SUBJECT TO SURVEY

Subdivision Certificate number:

Date of Endorsement:

- This sheet is for the provision of the following information as required:
- A schedule of lots and addresses - See 60(c) SSI Regulation 2017
 - Statements of intention to create and release affecting interests in accordance with section 88B Conveyancing Act 1919
 - Signatures and seals- see 195D Conveyancing Act 1919
 - Any information which cannot fit in the appropriate panel of sheet 1 of the administration sheets.

Execution by Prescribed Authority:

.....
Signature of Delegate

.....
(Name and Position of Delegate)

as a Delegate of Northern Beaches Council pursuant to Sec.378 of the Local Government Act 1993 and I hereby certify that I have no notice of revocation of such delegation.

.....
Signature of Witness

.....
Name of Witness

.....
.....
Address of Witness

If space is insufficient use additional annexure sheet

Office Use Only

Office Use Only

Registered:

**PLAN OF SUBDIVISION OF THE LAND IN
S.P.32071 & S.P.32072**

*THIS IS A DRAFT SUBDIVISION PLAN ONLY.
ALL BOUNDARIES, LAYOUTS, DIMENSIONS, AREAS,
EASEMENTS & LEVELS ARE SUBJECT TO SURVEY*

Subdivision Certificate number:

Date of Endorsement:

- This sheet is for the provision of the following information as required:
- A schedule of lots and addresses - See 60(c) *SSI Regulation 2017*
 - Statements of intention to create and release affecting interests in accordance with section 88B *Conveyancing Act 1919*
 - Signatures and seals- see 195D *Conveyancing Act 1919*
 - Any information which cannot fit in the appropriate panel of sheet 1 of the administration sheets.

Execution by Registered Proprietor:

Execution by Mortgagee:

If space is insufficient use additional annexure sheet

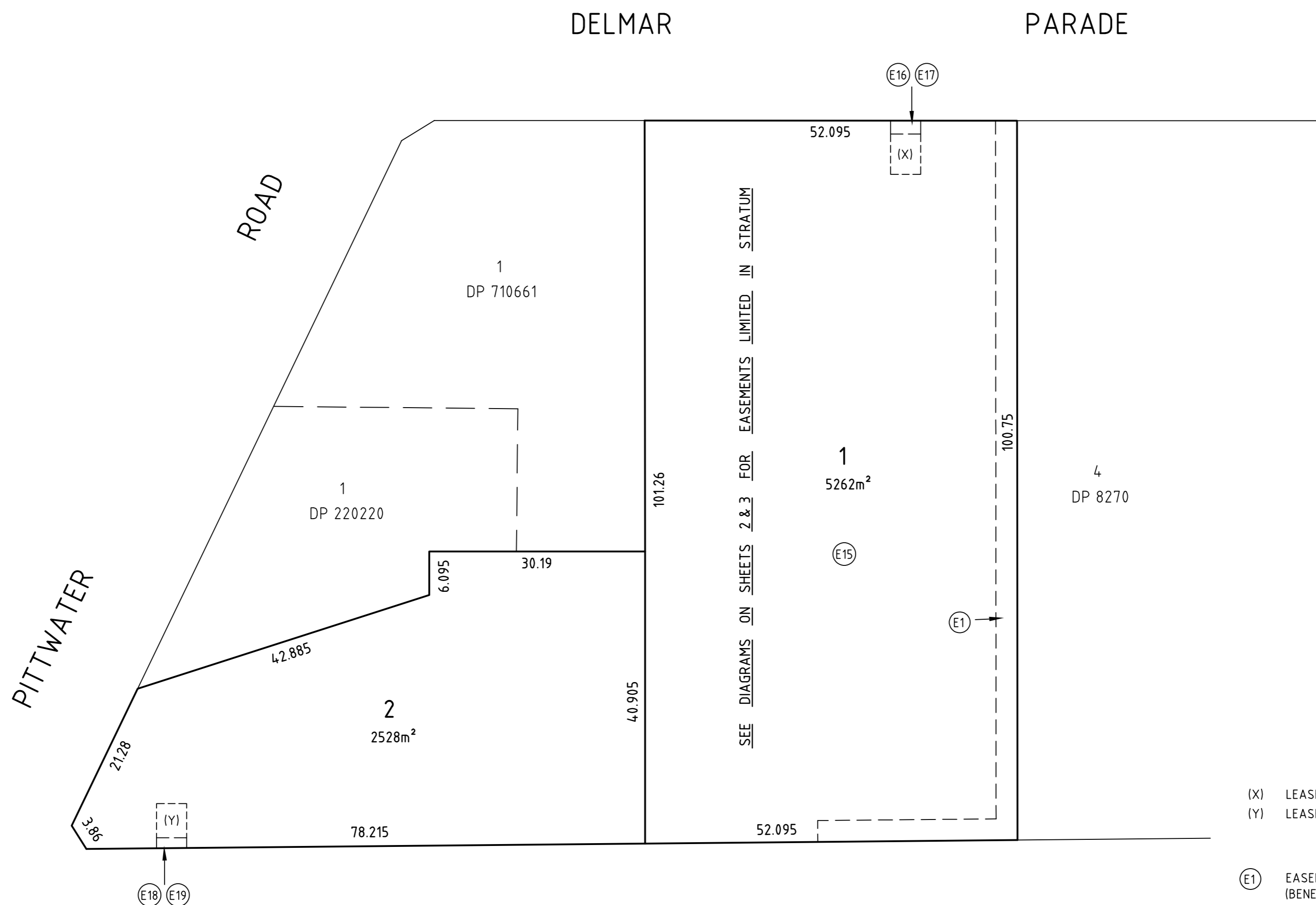
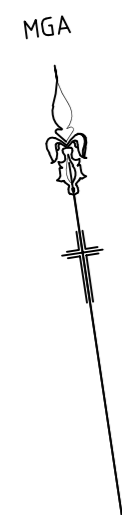

- (X) LEASE FOR CHAMBER SUBSTATION (AUSGRID)
- (Y) LEASE FOR CHAMBER SUBSTATION (AUSGRID)
- (E1) EASEMENT TO DRAIN WATER 3 WIDE (BENEFITS NORTHERN BEACHES COUNCIL)
- (E15) EASEMENT FOR EMERGENCY EGRESS AFFECTS THE WHOLE OF LOT 1 (BENEFITS LOT 2)
- (E16) EASEMENT FOR ELECTRICITY & OTHER PURPOSES (BENEFITS AUSGRID)
- (E17) RIGHT OF CARRIAGEWAY (BENEFITS AUSGRID)
- (E18) EASEMENT FOR ELECTRICITY & OTHER PURPOSES (BENEFITS AUSGRID)
- (E19) RIGHT OF CARRIAGEWAY (BENEFITS AUSGRID)

THIS IS A DRAFT PLAN ONLY. ALL BOUNDARIES, DIMENSIONS, AREAS, LEVELS AND EASEMENTS ARE SUBJECT TO FINAL SURVEY. THE FINAL PLAN WILL INCLUDE ADDITIONAL DETAILS & SECTIONS.

<p>Surveyor: CHRISTOPHER THOMAS NORTON Date of Survey: Surveyor's Ref: 53046 DP</p>	<p>PLAN OF SUBDIVISION OF THE LAND IN S.P.32071 & S.P.32072</p>	<p>LGA: NORTHERN BEACHES Locality: DEE WHY Subdivision No: Lengths are in metres. Reduction Ratio 1:500</p>	<p>Registered:</p>	<p>DRAFT DP Issue: A Date: 2.12.21</p>
---	--	--	--------------------	---

MGA

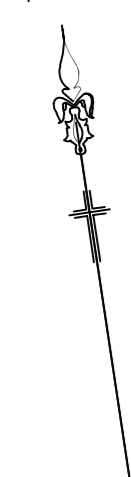

DIAGRAM No.1
EASEMENTS AT BASEMENT 2

- (E2) EASEMENT FOR DRAINAGE OF WATER & RISING MAIN LIMITED IN STRATUM (BENEFITS LOT 1)
- (E3) EASEMENT FOR DRAINAGE OF WATER & RISING MAIN LIMITED IN STRATUM (BENEFITS LOT 2)
- (E4) EASEMENT FOR DRAINAGE OF WATER & PUMP OUT LIMITED IN STRATUM (BENEFITS LOT 2)
- (E5) EASEMENT FOR DRAINAGE OF WATER LIMITED IN STRATUM (BENEFITS LOT 2)
- (RVA1) RIGHT OF VEHICLE ACCESS LIMITED IN STRATUM (BENEFITS LOT 2)

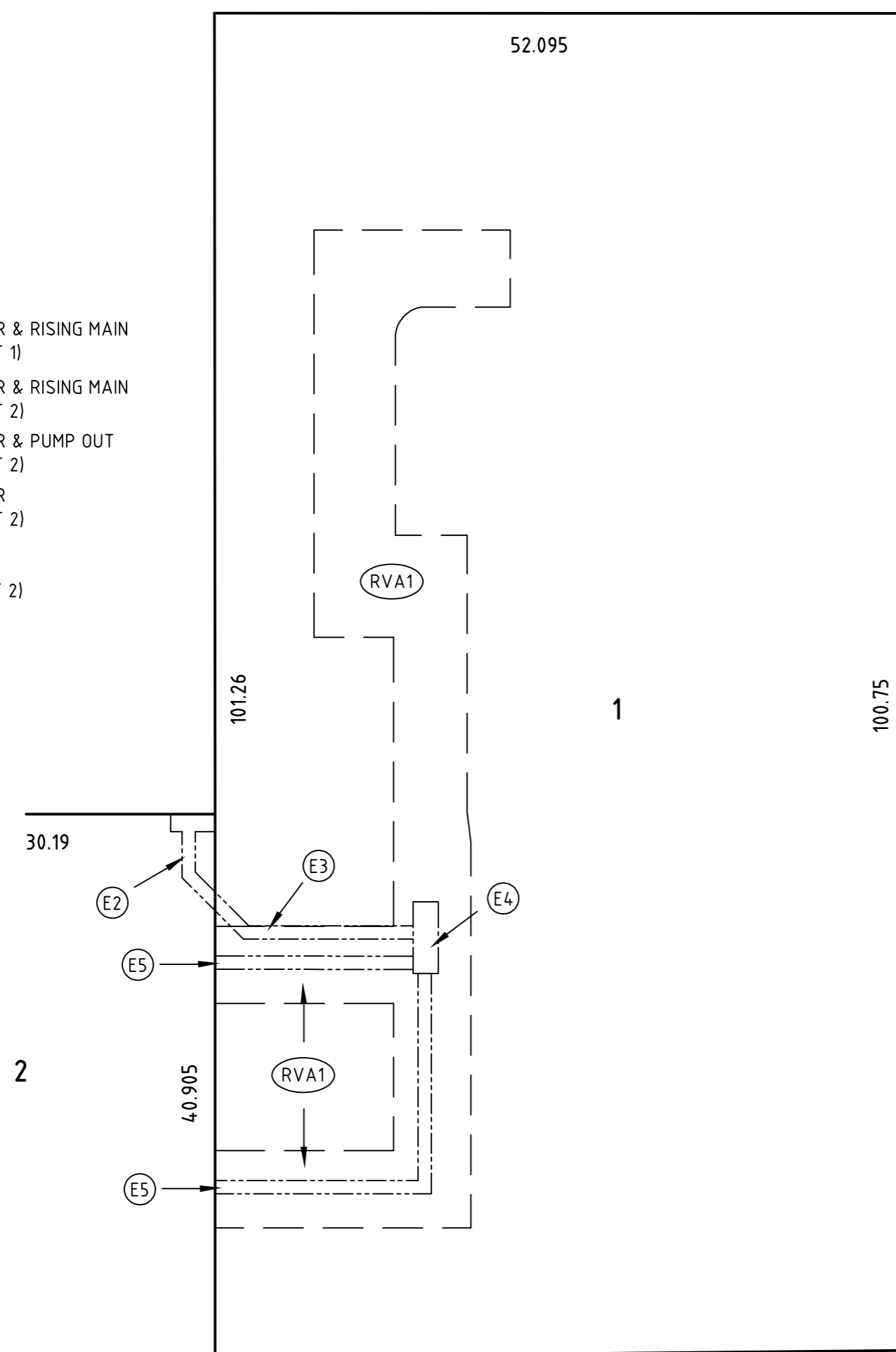
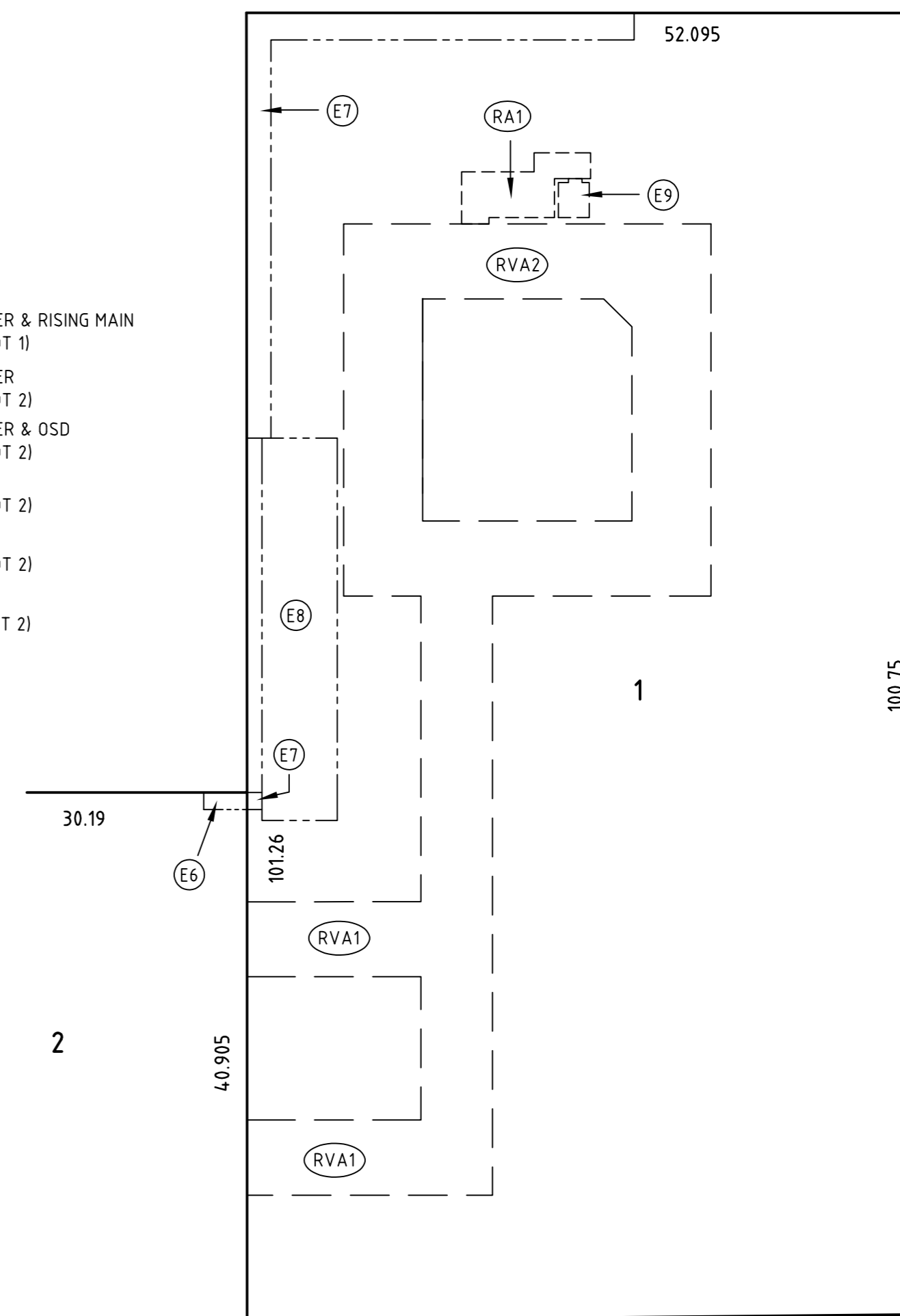

DIAGRAM No.2
EASEMENTS AT BASEMENT 1

- (E6) EASEMENT FOR DRAINAGE OF WATER & RISING MAIN LIMITED IN STRATUM (BENEFITS LOT 1)
- (E7) EASEMENT FOR DRAINAGE OF WATER LIMITED IN STRATUM (BENEFITS LOT 2)
- (E8) EASEMENT FOR DRAINAGE OF WATER & OSD LIMITED IN STRATUM (BENEFITS LOT 2)
- (E9) EASEMENT TO USE LIFT LIMITED IN STRATUM (BENEFITS LOT 2)
- (RA1) RIGHT OF ACCESS LIMITED IN STRATUM (BENEFITS LOT 2)
- (RVA2) RIGHT OF VEHICLE ACCESS LIMITED IN STRATUM (BENEFITS LOT 2)



THIS IS A DRAFT PLAN ONLY. ALL BOUNDARIES, DIMENSIONS, AREAS, LEVELS AND EASEMENTS ARE SUBJECT TO FINAL SURVEY. THE FINAL PLAN WILL INCLUDE ADDITIONAL DETAILS & SECTIONS.

<p>Surveyor: CHRISTOPHER THOMAS NORTON Date of Survey: Surveyor's Ref: 53046 DP</p>	<p>PLAN OF SUBDIVISION OF THE LAND IN S.P.32071 & S.P.32072</p>	<p>LGA: NORTHERN BEACHES Locality: DEE WHY Subdivision No: Lengths are in metres. Reduction Ratio 1:400</p>	<p>Registered:</p>	<p>DRAFT DP Issue: A Date: 2.12.21</p>
---	---	---	--------------------	---

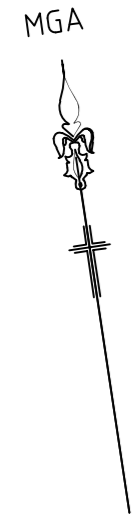
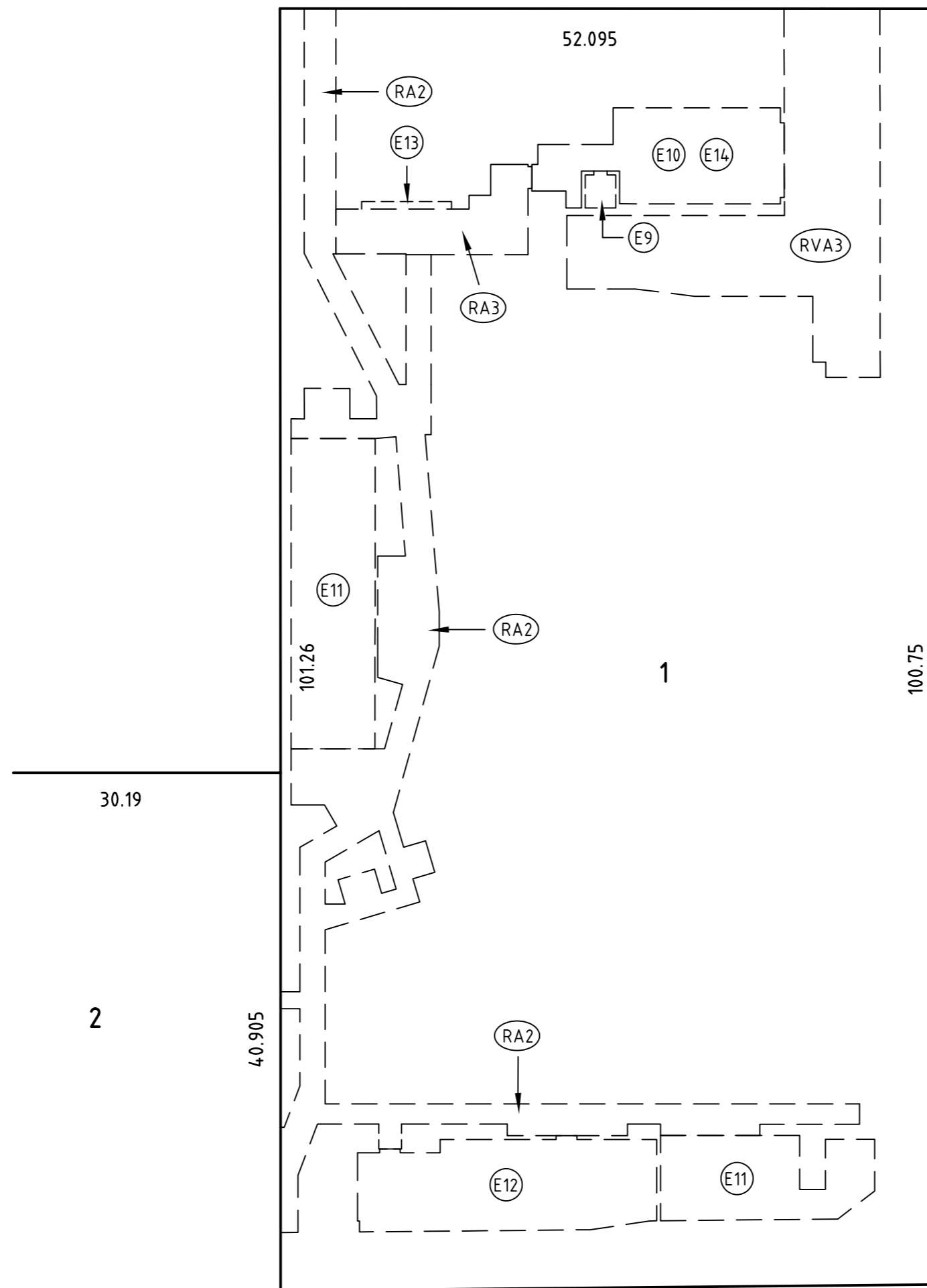

DIAGRAM No.3
EASEMENTS AT GROUND FLOOR

- (E9) EASEMENT TO USE LIFT
LIMITED IN STRATUM (BENEFITS LOT 2)
- (E10) EASEMENT TO USE LOADING DOCK
LIMITED IN STRATUM (BENEFITS LOT 2)
- (E11) EASEMENT FOR RECREATION
LIMITED IN STRATUM (BENEFITS LOT 2)
- (E12) EASEMENT FOR RECREATION
LIMITED IN STRATUM (BENEFITS LOT 2)
- (E13) EASEMENT FOR MAIL BOX
LIMITED IN STRATUM (BENEFITS LOT 2)
- (E14) EASEMENT FOR GARBAGE COLLECTION
LIMITED IN STRATUM (BENEFITS LOT 2)
- (RA2) RIGHT OF ACCESS
LIMITED IN STRATUM (BENEFITS LOT 2)
- (RA3) RIGHT OF ACCESS
LIMITED IN STRATUM (BENEFITS LOT 2)
- (RVA3) RIGHT OF VEHICLE ACCESS
LIMITED IN STRATUM (BENEFITS LOT 2)



THIS IS A DRAFT PLAN ONLY. ALL BOUNDARIES, DIMENSIONS, AREAS, LEVELS AND EASEMENTS ARE SUBJECT TO FINAL SURVEY. THE FINAL PLAN WILL INCLUDE ADDITIONAL DETAILS & SECTIONS.

Surveyor: CHRISTOPHER THOMAS NORTON
Date of Survey:
Surveyor's Ref: 53046 DP

PLAN OF SUBDIVISION OF THE LAND IN
S.P.32071 & S.P.32072

LGA: NORTHERN BEACHES
Locality: DEE WHY
Subdivision No:
Lengths are in metres. Reduction Ratio 1:400

Registered:

DRAFT DP
Issue: A
Date: 2.12.21