

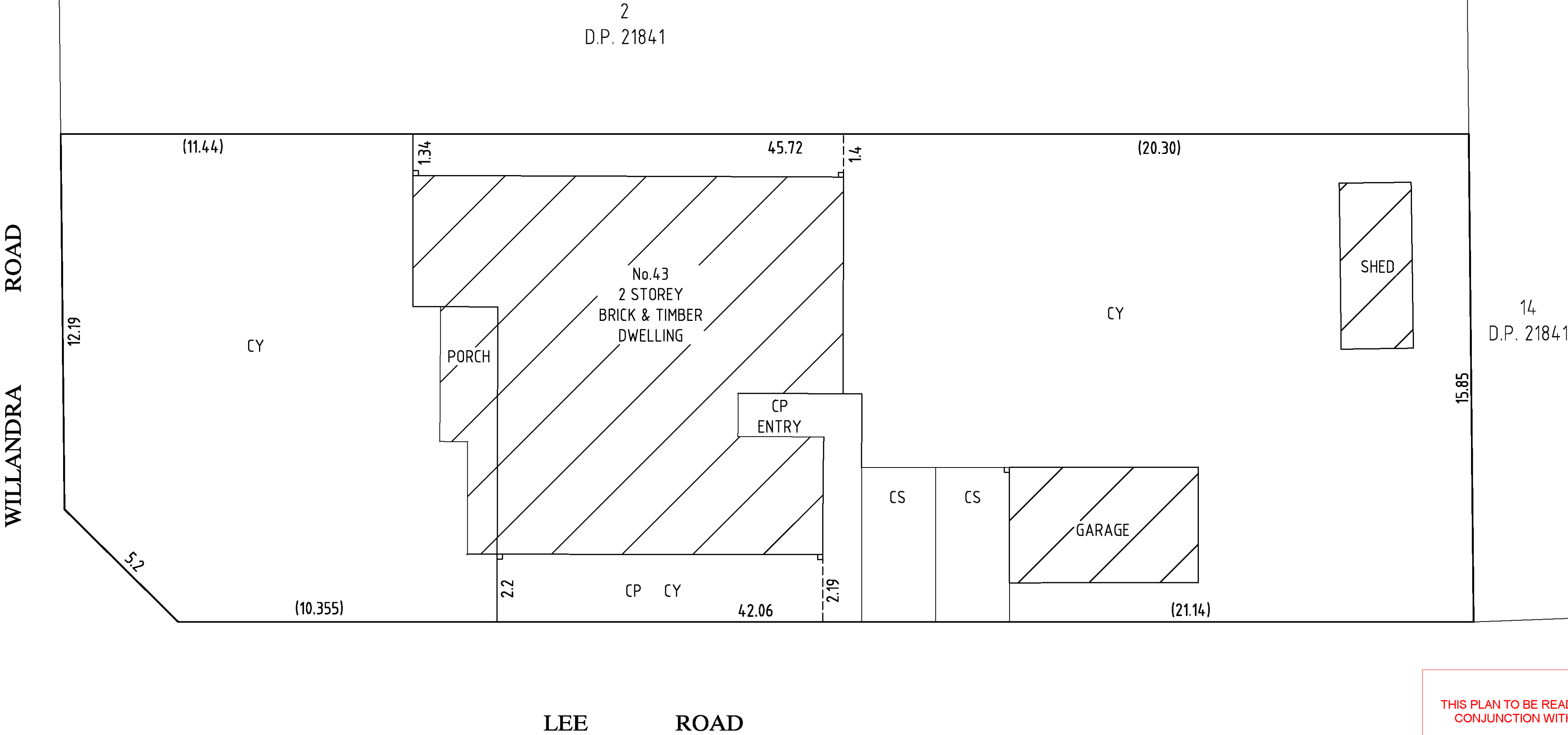

LOCATION PLAN

CP denotes COMMON PROPERTY
CS denotes CARSPACE
LDY denotes LAUNDRY
CY denotes COURTYARD



THIS PLAN TO BE READ IN CONJUNCTION WITH
DA2018/1919
NORTHERN BEACHES COUNCIL

CP denotes COMMON PROPERTY
CS denotes CARSPACE
S denotes STAIRS
LDY denotes LAUNDRY

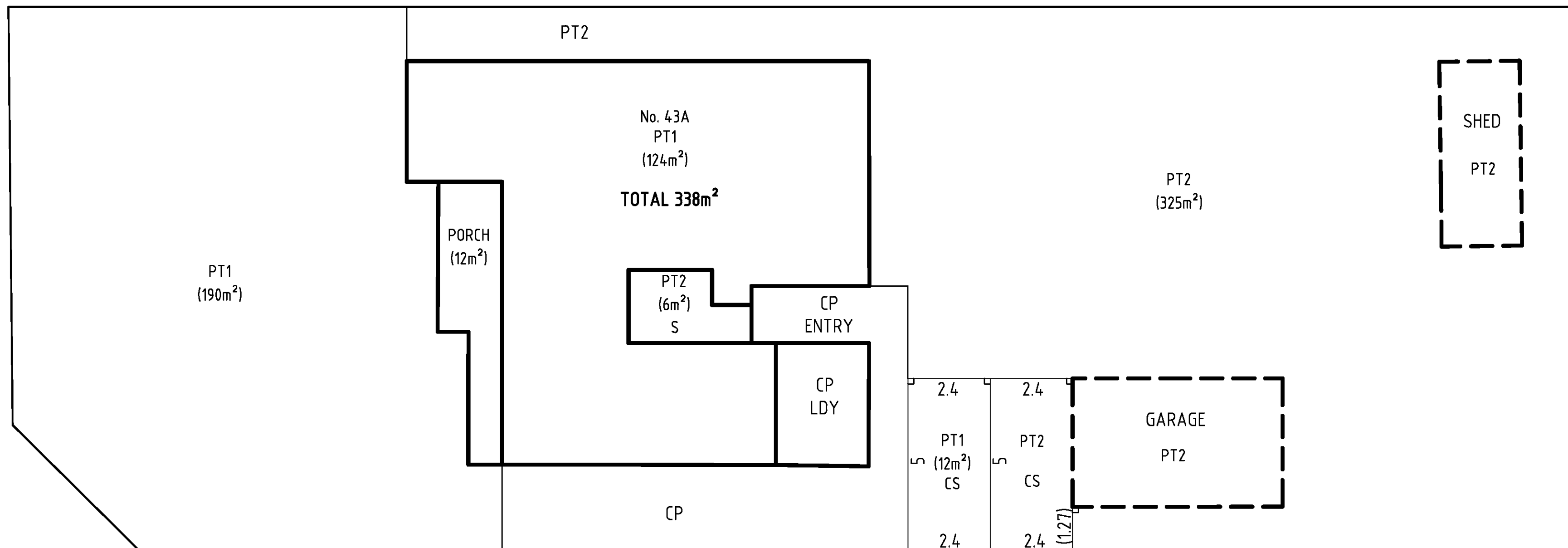

THE WHOLE OF THE STRUCTURAL CUBIC SPACE OF THE SHED AND GARAGE (SHOWN IN DASHED LINE WORK), STANDING ON LOT 2, INCLUDING THE MATERIALS OF WALLS, FLOORS, FOUNDATIONS, CEILING & ROOFS WITHIN LOT 2 FORMS PART OF THAT LOT AND IS NOT COMMON PROPERTY.

LOTS 1 AND 2 ARE LIMITED IN HEIGHT TO 20 METRES ABOVE AND IN DEPTH TO 5 METRES BELOW THE UPPER SURFACE OF THE RESPECTIVE COURTYARD WITHIN EACH OF THOSE LOTS.

ALL COMMON SERVICE LINES ARE COMMON PROPERTY.

ANY COMMON SERVICE LINE, POWER POLES AND METERING DEVICES WITHIN ONE LOT SERVICING ANOTHER LOT IS COMMON PROPERTY.

MATERIALS OF STORMWATER DRAINAGE SYSTEM SERVICING WITHIN EACH LOT ARE NOT COMMON PROPERTY.

 DENOTES RIGHT ANGLE (90°)

AREAS SHOWN ARE APPROXIMATE AND ARE SUBJECT TO FINAL SURVEY

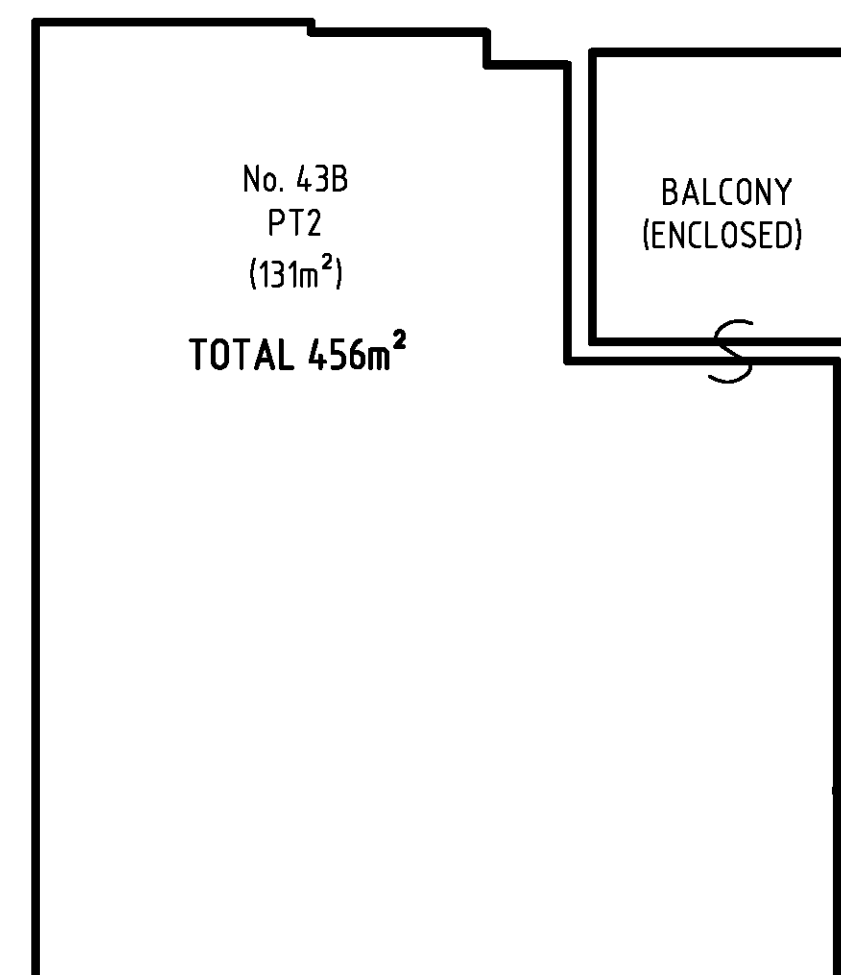

THIS PLAN TO BE READ IN
CONJUNCTION WITH
DA2018/1919
NORTHERN BEACHES COUNCIL

Surveyor : SIMON PAK YAN HO
Date of Survey : 01/06/2018
Surveyor's Ref : 3363
Lengths are in metres. Reduction Ratio 1:100

Registered

DRAFT