



NO WORK SHALL COMMENCE UNTIL ALL TREE PROTECTION & SEDIMENT CONTROL MEASURES AS DETAILED AND AS REQUIRED BY THE NOTICE OF DETERMINATION ARE INSTALLED AND APPROVED BY THE PRINCIPAL CERTIFYING AUTHORITY.

EXISTING CONCRETE AREA SHALL REMAIN UNTOUCHED DURING CONSTRUCTION.
VEHICLE MOVEMENT & DELIVERIES VIA EXISTING CROSSING SEALED SURFACE WILL ENSURE SOIL & SILT WILL NOT BE TRACKED OUT TO LONDONDERRY DRIVE. NO EROSION CONTROL IS REQUIRED TO THE STREET ACCESS

Building material stockpiles shall be covered at all times with building grade plastic sheet such as 'Fortecon"

Silt Fence Specification:
SF 1500 by Geofabrics Australasia P/L
or of Equal quality & performance

SF 1500 by Geofabrics Australasia P/L
or of Equal quality & performance

SILT FENCE

During demolition & rock excavation site areas are to be well watered to reduce dust generation

1. The Contractor shall install & maintain soil erosion measures in accordance

1. The Contractor shall install & maintain soil erosion measures in accordance with the guidelines of: "Managing Urban Stormwater – Soils and Construction" 2004 Published by the NSW Government. Also known as the "Blue Book".
2. Grade finished surface to shed water evenly without channelling.
3. All disturbed areas & stockpiles to be stabilised within 48 hours.
4. Trucks & vehicles leaving the site shall not spread dirt on to the external road.
5. No disturbance of site permitted other than the immediate area of the works.
6. Erosion Control measures to be inspected & maintained after every storm or heavy rain event

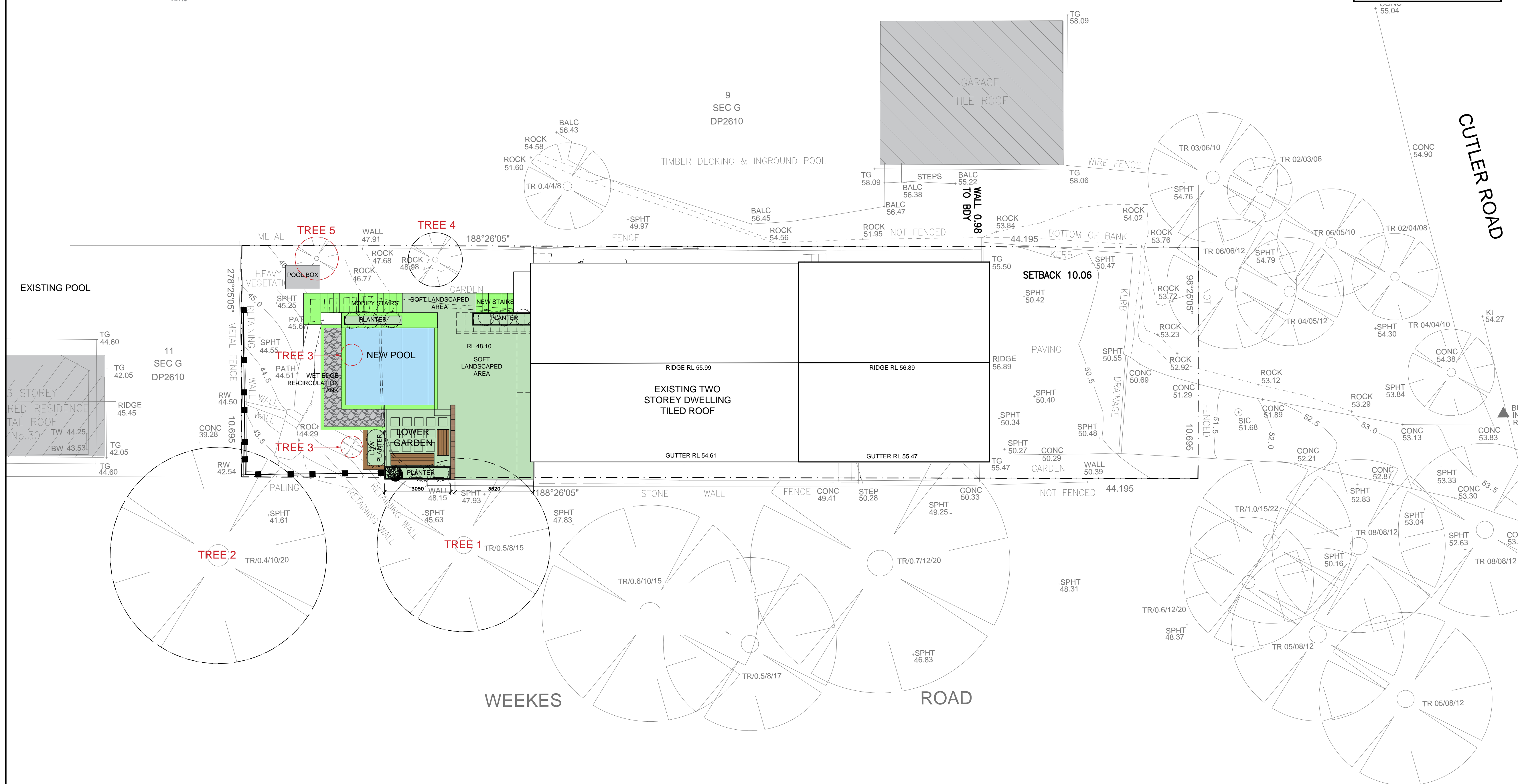
[illegible]

EROSION & SEDIMENT CONTROL PLAN

Project:
ALTERATIONS TO EXISTING RESIDENCE
47 CUTLER ROAD, CLONTARF

Applicant/Client:
RICHARD POLGLASE & ISABELLE DURRENBERGER

Drawing:
**EROSION & SEDIMENT
CONTROL PLAN**

Stage: DEVELOPMENT APPLICATION

Date: OCTOBER 2020	Drawn By: JYS
Scale: 1:100@A1	Checked By: JJJ

Job No: 2008

Drawing No.	GA.02	Issue:	A
-------------	-------	--------	---

Architect:
Leung Architects

ABN 67 001 790 512
25 KILLARNEY DRIVE
KILLARNEY HEIGHTS
NSW 2087 AUSTRALIA
TEL (02) 9453 5020
E info@leungarchitects.com

Structural Engineer:

Surveyor:
TRUE NORTH
SURVEYS

16/9 NARABANG WAY,
BELROSE 2085
NSW AUSTRALIA

TEL (02) 9450 0868
FAX (02) 9450 0268

Hydraulic Engineer:

Geotech.Engineer:

Heritage Consultant:







COPYRIGHT

Copyright in all documents and drawings prepared by JKC Leung Design & Construction Pty. Ltd and in any works executed from those documents and drawings shall, unless otherwise agreed in writing, remain the property of JKC Leung Design & Construction Pty. Ltd.

DRAWINGS AND DIMENSIONS

Figured dimensions shown on the drawings shall be followed in preference to scaled dimensions. Check and verify dimensions with prevailing conditions on the site and progressively on the site before commencing any work, before ordering, supplying or fabricating any item. Any discrepancies on site shall be reported to the Architect prior to the commencement of any works.

Legend:

-  Existing Wall
-  Existing Wall to be demolished
-  Double brick wall 230mm
-  Single brick wall 110mm
-  Cavity brick wall 270mm
-  Concrete block wall

	Precast concrete wall
	Reinforced concrete block wall
	Internal plasterboard wall
	Insulation
	Concrete
	Filled earth
	Waterproof membrane

TRUE
NORTH

NOTES
All structural foundations, beams, walls, slabs and columns shall be to the Structural Engineer's specification and documentation.

All construction work to comply with current relevant Australian Standards and the Building Code of Australia

Nominated Architect: Jeffrey Leung Reg. No. 6196

Job No: 2008

Drawing No.	GA.02	Issue:	A
-------------	-------	--------	---