

DIMENSIONS INCLUDE CLADDING THICKNESS

DRAWING REVISION SCHEDULE			
No.	AMENDMENTS	DATE	BY
A	PRELIMINARY - FIRST ISSUE	13/10/2023	DJH
B	PRELIMINARY - SECOND ISSUE	19/10/2023	DJH
C	FIRST ISSUE - CONCEPT STAGE	29/11/2023	DJH
D	FIRST ISSUE - DA SET	06/02/2025	DJH
E	ADDED SHADOW DIAGRAM FOR SUMMER; CHANGED SLIDING DOOR TO DINING; ADDED STONE CLADDING TO PORCH POST; ADJUSTED RAINWATER TANKS; ADDED SINK TO KITCHEN; ADDED 1700 HIGH WALL TO BBQ AREA ON ALFRESCO.	27/02/2025	DJH

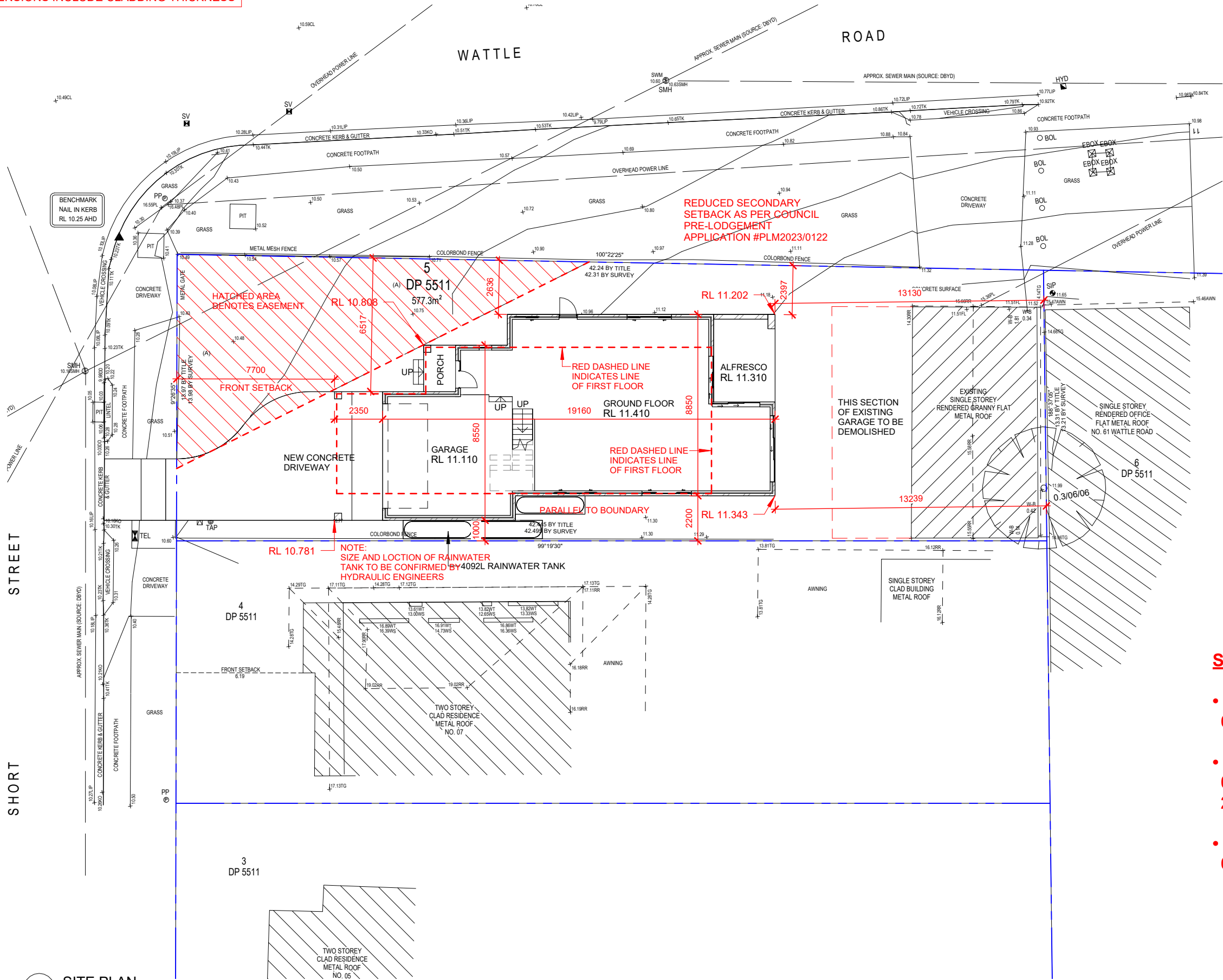

GROSS FLOOR AREAS (GFA)	
GROSS FLOOR AREA	207 m ²
GRANNY FLAT	69 m ²
GARAGE	35 m ²
TOTAL GFA:	311 m ²

SITE AREA	FSR
577.3 m ²	0.54

SETBACK NOTES:

- FRONT SETBACK IS TO BE AT LEAST: 6.5m
- SIDE SETBACK IS TO BE AT LEAST: 0.9m TO ONE SIDE 2.0m TO THE OTHER SIDE
- REAR SETBACK IS TO BE AT LEAST: 6.0m

1 SITE PLAN
1 : 200

DA APPLICATION - NOT FOR CONSTRUCTION

0m 1m 2m 3m 4m 5m 10m
SCALE BAR 1:200

© COPYRIGHT. THIS DRAWING REMAINS THE PROPERTY OF WATTLE COURT HOMES & IS PROVIDED FOR THE USE AS DESCRIBED & MAY NOT BE USED OR REPRODUCED IN WHOLE OR IN PART WITHOUT WRITTEN PERMISSION. ANY LANDSCAPING (WHEN SHOWN) ARE FOR ILLUSTRATIVE PURPOSES ONLY AND DO NOT FORM PART OF ANY CONTRACT

WATTLE COURT
HOMES BUILT FOR LIFE

CUSTOM DESIGN
RESORT FACADE

© COPYRIGHT EXCLUSIVE
TO WATTLE COURT HOMES

DRAFTERS:
KJR
PO BOX 6840
NORWEST NSW 2153
ABN 15 078 937 238
(02) 8883 4344
kjrdrfting@kjr.net.au

CLIENT: DOUBLE STOREY DWELLING
ENTWISTLE & GARDINER
DRAWING TITLE:
SITE PLAN

PROJECT:
**9 SHORT STREET
NORTH MANLY NSW 2100**
SCALE: 1 : 200

SHEET SIZE: **A3** SHEET No: **A03** REVISION: **E**
DATE: **27/02/2025**
JOB NO: **NSN0043** APPLICATION: **DA**
DRAWN: **DJH** GJGN229

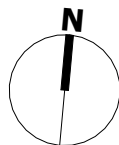

IWE HAVE CHECKED THE PLANS AND AGREE THEY ACCURATELY
DEPICT THE HOUSE FOR CONSTRUCTION. ANY VARIATIONS
REQUESTED AFTER SIGNING WILL INCUR A PROCESSING FEE IN
ADDITION TO THE COST OF THE VARIATION ITEM/S AND ANY
FURTHER PLANS TO BE PREPARED.
OWNER SIGNED: DATE:
OWNER SIGNED: DATE:
BUILDER SIGNED: DATE: