

1 Existing Site
Scale: 1:200

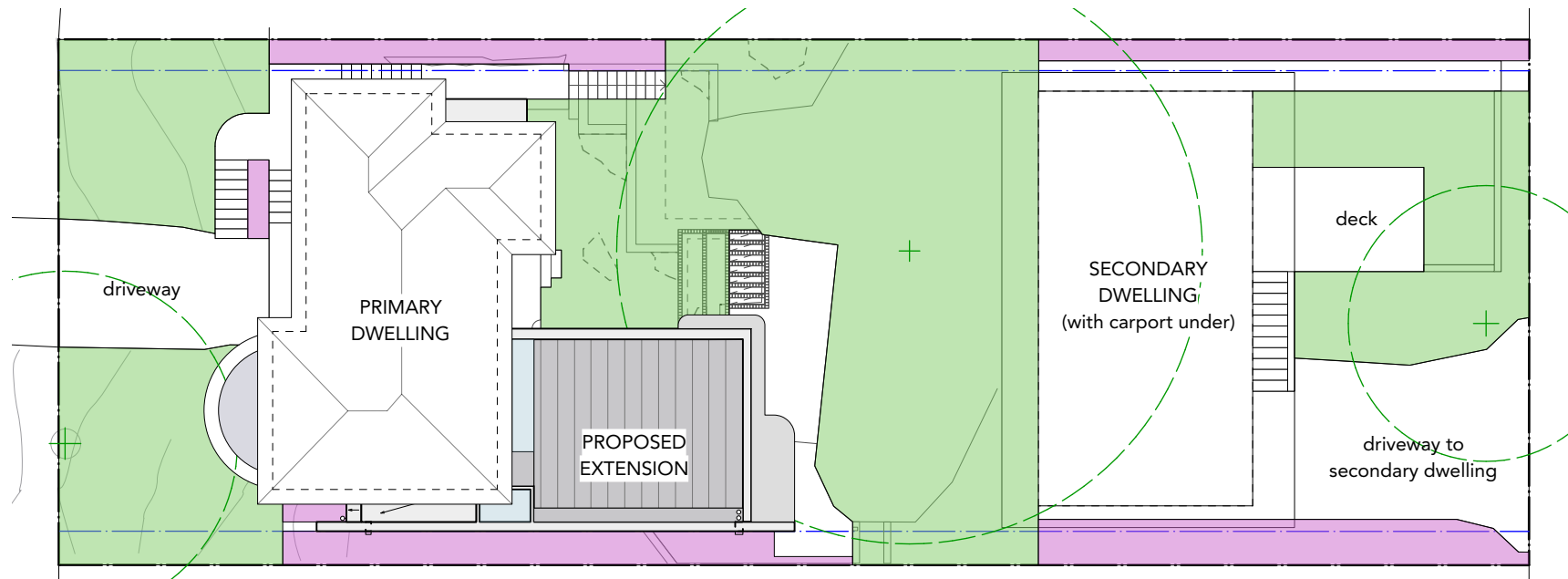

2 Proposed Site
Scale: 1:200

KEY

LANDSCAPED AREA (as defined by the DCP)	PLANTED AREA ($<2\text{m}$ dimensionally, disqualifying inclusion in 'Landscaped Area')
PRIMARY OPEN SPACE (as defined by the DCP)	

AREA CALCULATIONS m^2 (NB SITE AREA 645m^2)

	Landscaped Area	Primary Open Space (Primary Dwelling)	Planted Area
EXISTING	263 (41% of site)	0	52
PROPOSED	253 (39% of site)	63	54

note due to constraints of steep topography, the Primary Open Space is across multiple levels but directly accessible and connected to both upper and lower living spaces

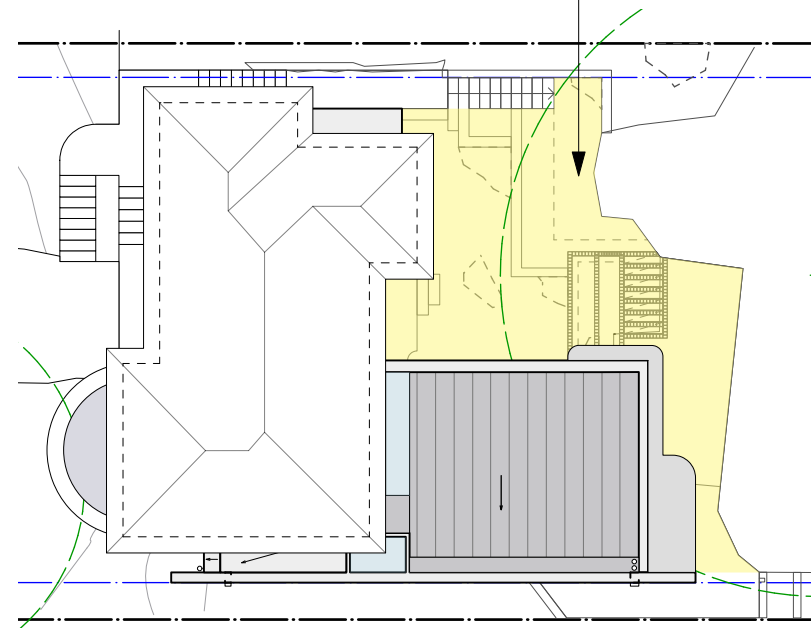

3 Proposed Dwelling
Scale: 1:200

